

Site Location / Drawing Title  
DARLEY GREEN ROAD DORRIDGE  
B93 8PN

Client: **OPENREACH**

Contract No	254-S008316
Date	27/09/2021
Drawn by	RS/802
Approved By	DH/254
Purpose of works	TELECOM WORKS
Version Number	01
Amended by	XXXXXXXXXX
Amendment Date	XXXXXXXXXX
Scale	NOT TO SCALE
Sheet No	1 of 1
SPEED OF ROAD MPH	30 60
DISTANCE FROM MIN	20M 275M
FIRST SIGN TO START OF SITE(D)	MAX 45M 450M
SIDEWAYS SAFETY ZONE (S)	0.5M 1.2M
LONGWAYS CLEARANCE (L)	0.5M 60M
END OF WORKS (E)	10M TO 30M FROM TO 45M
OS Licence No	01 - 00000000000

- KEY**
- Traffic sign
  - Traffic cone
  - No Parking cone
  - Temp Traffic signals
  - Temp Ped Crossing
  - Working Space
  - Controlled area
  - Pedestrian Barrier
  - Perm signal head
  - Bus Stop

	PHASE 1	PHASE 2
R	15	05
G	40	35
PHASE 3		
R	10	
G	35	

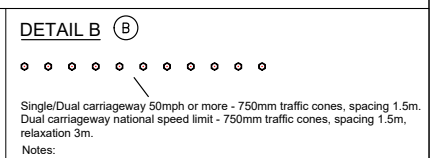
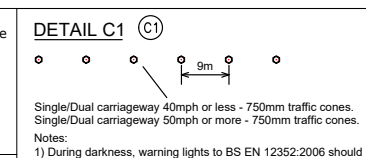
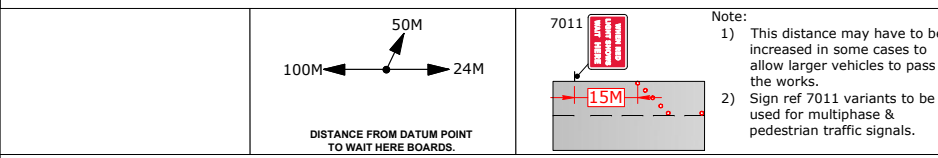

The information in this drawing may not be copied or used by third parties without written consent from Sunbelt Rentals Ltd (Traffic Management). This layout is for installation by NRSWA, Lantra 12A,12B,12C,12D qualified persons.

**All works shall be in accordance with Safety at Street Works and Road Works, A Code of Practice 2013 & Chapter 8**

**THIS DOCUMENT IS UNCONTROLLED WHEN PRINTED**

The electronic version of this document is the approved and most current. Any printed version is uncontrolled and may not be current.