



THIS DRAWING IS TO BE USED ONLY FOR THE PURPOSE OF ISSUE THAT IT WAS ISSUED FOR AND IS SUBJECT TO AMENDMENT. EXCEPTIONAL RISKS RELATING TO THE WORKS ASSOCIATED WITH THIS DRAWING ARE IDENTIFIED BELOW.

CONSTRUCTION
RISK: XXX

GRID REFERENCE FOR WORKS AREA

X: 420781
Y: 280673

NOTES

- Access to residents will need to be maintained on site by operatives
- Letters to warn residents required
- No parking cones to be installed 24 hours prior
- TUSC Required
- Footboards and ramps required on site
- Pedestrians to use alternative crossing point

30 Bellemere Road

Minimum P.P.E requirements to be worn during installation: Hard Hats, Glasses, Gloves, Boots, High Visibility Clothing
 Minimum requirements for ALL sign placement please follow instructions below without exception

- Minimum height 2.2m over footpath
- Minimum height 2.5m over cyclepath
- Minimum sideways clearance
- carriageway/footpath 450mm
- Frames keep 1m clearance on footpath
- All frames must be sandbagged

Any issues not allowing you to follow regulations please contact the office or out of hours.

REVISION DETAILS	By	Check	Date	Suffix



CHEVRON
A WORK-ZONE SAFETY COMPANY
 Chevron
 3 Thame Business Park
 Wenman Road
 Thame
 OX9 3XA
 Tel: 01844 354666
 www.chevrontm.com

Project Title
 Bellemere Road
 Hampton in Arden
 B92 0AN

Drawing Title
 60453166
 Plan 1 of 1
 Road Closure

Designed CM	Drawn CM	Checked CM	Approved AM	Date 13.07.2022
----------------	-------------	---------------	----------------	--------------------

Scale @ A3
 NOT TO SCALE

Volume
 TRAFFIC MANAGEMENT

THIS DOCUMENT HAS BEEN PREPARED PURSUANT TO AND SUBJECT TO THE TERMS OF CHEVRON'S APPOINTMENT BY ITS CLIENT. CHEVRON ACCEPTS NO LIABILITY FOR ANY USE OF THIS DOCUMENT OTHER THAN BY ITS ORIGINAL CLIENT OR FOLLOWING CHEVRON'S EXPRESS AGREEMENT TO SUCH USE, AND ONLY FOR THE PURPOSES FOR WHICH IT WAS PREPARED AND PROVIDED.

Drawing Number	Project Code/PIN	Originator	Volume	Rev

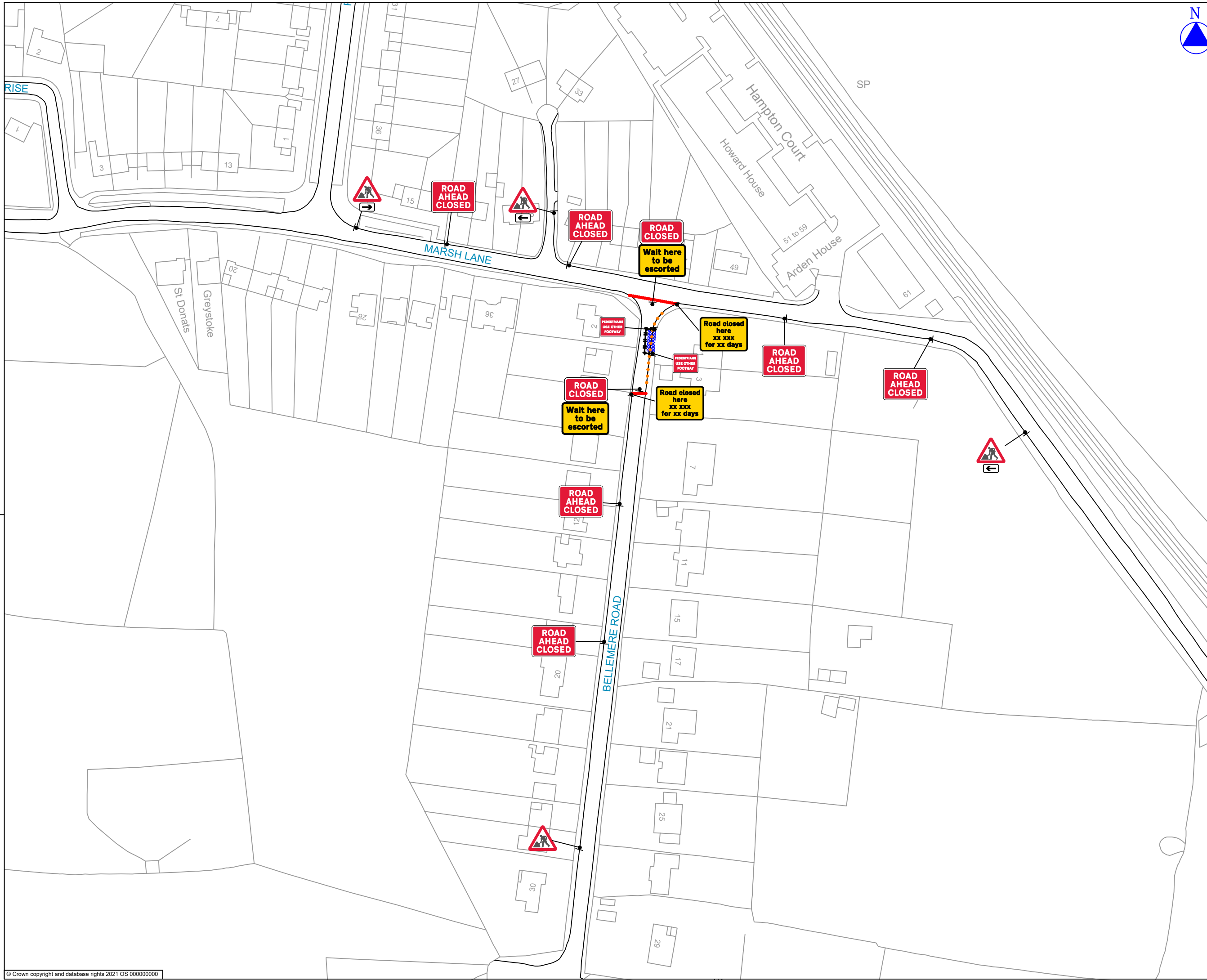



THIS DRAWING IS TO BE USED ONLY FOR THE PURPOSE OF ISSUE THAT IT WAS ISSUED FOR AND IS SUBJECT TO AMENDMENT.
EXCEPTIONAL RISKS RELATING TO THE WORKS ASSOCIATED WITH THIS DRAWING ARE IDENTIFIED BELOW.

CONSTRUCTION
RISK: XXX

GRID REFERENCE FOR WORKS AREA

X: 420781
Y: 280673

NOTES

- Access to residents will need to be maintained on site by operatives
- Letters to warn residents required
- No parking cones to be installed 24 hours prior
- TUSC Required
- Footboards and ramps required on site
- Pedestrians to use alternative crossing point

Qty: 2 Ref: 2704 VP01 Direction of temporary diversion route - 05-08-2017-10#30#07	
Qty: 2 Ref: 2704 VP01 Direction of temporary diversion route - 05-08-2017-10#30#07	
Qty: 1 Ref: 573 Direction to hazard right	
Qty: 2 Ref: 573 Direction to hazard left	
Qty: 4 Ref: 7001 Road works ahead	
Qty: 6 Ref: 7010-FP-13-9 Nature of temporary hazard ahead - Road Ahead Closed	
Qty: 2 Ref: 7010.1 Nature of temporary hazard ahead - Road Closed	
Qty: 2 Ref: 7018 Pedestrians Use Other Footway	

30 Bellemere Road

Minimum P.P.E requirements to be worn during installation:
Hard Hats, Glasses, Gloves, Boots, High Visibility Clothing
Minimum requirements for ALL sign placement please follow instructions below without exception

- Minimum height 2.2m over footpath
- Minimum height 2.5m over cyclepath
- Minimum sideways clearance
- carriageway/Footpath 450mm
- Frames keep 1m clearance on footpath
- All frames must be sandbagged

Any issues not allowing you to follow regulations please contact the office or out of hours.

REVISION DETAILS	By	Check	Date	Suffix

Purpose of issue

Client
SEVERN TRENT

CHEVRON
A WORK-ZONE SAFETY COMPANY
Chevron
3 Thame Business Park
Wenman Road
Thame
OX9 3XA
Tel: 01844 354666 www.chevrontm.com

Project Title
Bellemere Road
Hampton in Arden
B92 0AN

Drawing Title
60453166
Plan 1 of 1
Road Closure

Designed	Drawn	Checked	Approved	Date
CM	CM	CM	AM	13.07.2022

Internal Project No. Suitability
Scale @ A3 Volume
NOT TO SCALE TRAFFIC MANAGEMENT

THIS DOCUMENT HAS BEEN PREPARED PURSUANT TO AND SUBJECT TO THE TERMS OF CHEVRON'S APPOINTMENT BY ITS CLIENT. CHEVRON ACCEPTS NO LIABILITY FOR ANY USE OF THIS DOCUMENT OTHER THAN BY ITS ORIGINAL CLIENT OR FOLLOWING CHEVRON'S EXPRESS AGREEMENT TO SUCH USE, AND ONLY FOR THE PURPOSES FOR WHICH IT WAS PREPARED AND PROVIDED.

Drawing Number	Project Code/PIN	I Originator	I Volume	Rev