

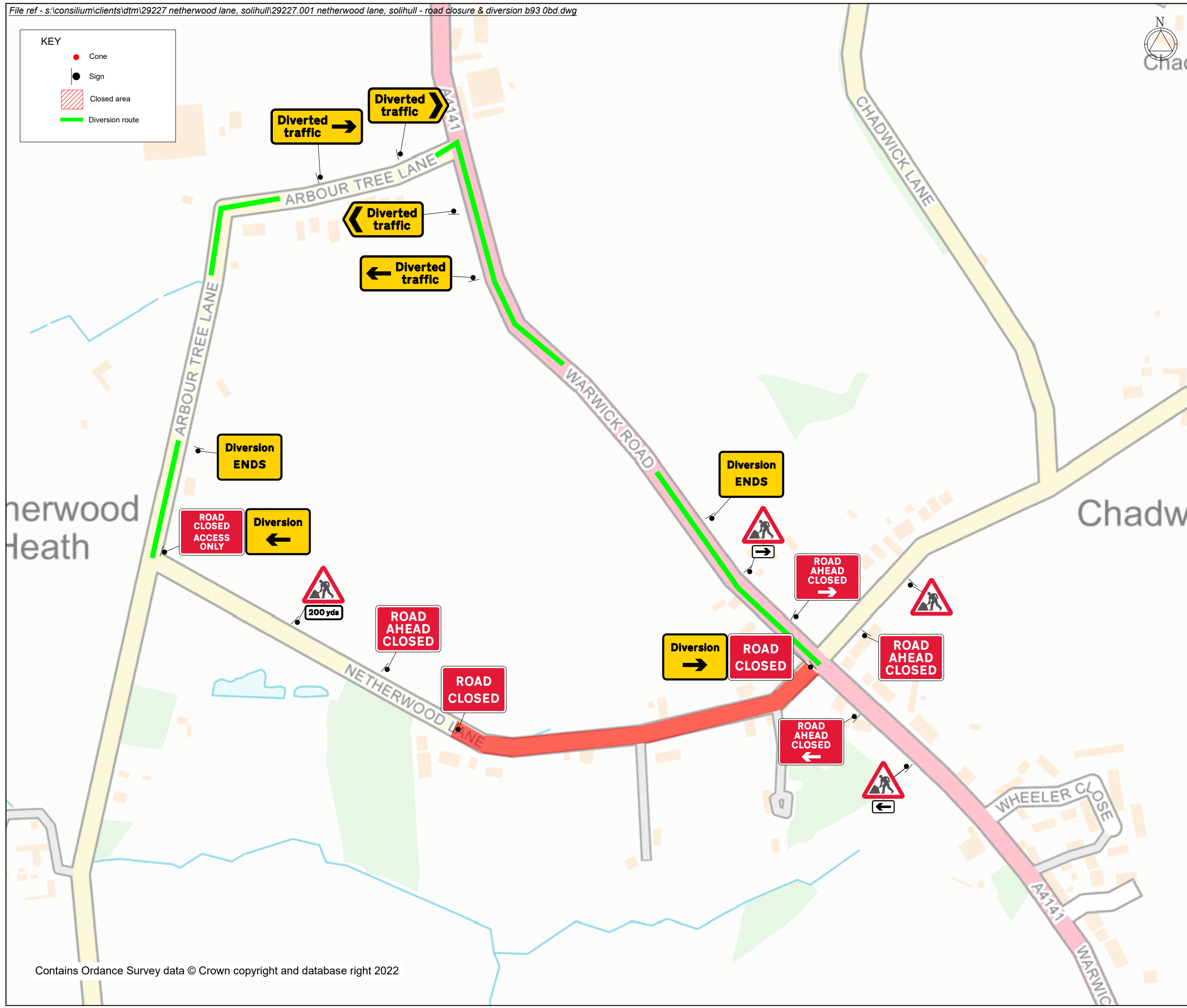

**KEY**

- Cone
- Sign
- Closed area
- Diversion route



**KIT LIST**

Qty: 1 Ref: 13-9-RCAD Road Closed Access Only	
Qty: 1 Ref: 13-9-7010 ROAD AHEAD CLOSED LEFT	
Qty: 1 Ref: 13-9-7010 ROAD AHEAD CLOSED RIGHT	
Qty: 1 Ref: 2702 Start of temporary diversion route	
Qty: 1 Ref: 2702 Start of temporary diversion route	
Qty: 2 Ref: 2702 End of temporary diversion route	
Qty: 1 Ref: 2703 Direction of temporary diversion route from junction ahead	
Qty: 1 Ref: 2703 Direction of temporary diversion route from junction ahead	
Qty: 1 Ref: 2704 Direction of temporary diversion route	
Qty: 1 Ref: 2704 Direction of temporary diversion route	
Qty: 1 Ref: 572 Distance ahead to hazard	
Qty: 1 Ref: 573 Direction to hazard left	
Qty: 1 Ref: 573 Direction to hazard right	
Qty: 4 Ref: 7001 Road works ahead	
Qty: 2 Ref: 7010-FP-13-9 Nature of temporary hazard ahead - Road Closed	
Qty: 2 Ref: 7010-FP-13-9 Nature of temporary hazard ahead - Road Ahead Closed	

Rev	Description	By	Chkd	Date
Revisions				

Client

**WESTERN POWER DISTRIBUTION**  
*Serving the Midlands, South West and Wales*

Project

Netherwood Lane  
Solihull, B93 0BD  
Grid Ref: 420407 , 273150

Title

Road closure and diversion



Design: SD	Drawn: JM	Chkd: SD
Date: 27/05/22	Date: 27/05/22	Date: 27/05/22
Scale: NTS @ A3	Status: PROPOSED	
Drawing No		Rev:
29227.001		