

Key:

	Line of Works		Temporary Traffic Signal
	Works Area		Stop & Go Board
	Road Closure		Permanent Traffic Signal
	Diversion Route		Temporary Ped Signal
	Cone		Existing Bus Stop
	Pedestrian Barrier		3.5T Van
	Temporary Sign		

Notes:

Min width of sideways safety zone (S)	0.5m
Min length of longways clearance (L)	15m
Stratford Road	

WORKS ACCESS
Signs to be positioned as required to suit site conditions

TEMP BUS STOP SUSPENSION
Signs to be located as necessary to suit site conditions

Rev	Date	Comments	By	Chk

ERRIS
Working in Partnership with
traffix
total traffic & event management solutions
Old Arden Brickworks | Bickenhill | Solihull | West Midlands | B92 0DY
t +44 (0)800 819 9001 | f +44 (0)1875 442507
info@traffixuk.com | www.traffixuk.com

Project title:
Traffic Management

Drawing title:
Proposed Road Closure
A34 Stratford Road
Solihull
B90 4AY

Date: 01/03/2022	Scale: NTS	Paper: A2
Drawn: CM	Checked: BN	Approved: PW
Project Number: TFX D7386	Drawing Number: 003	Revision: -

This drawing is copyright & the property of Traffix & must not be copied in whole or in part without their written permission. Copyright is reserved. © This drawing must not be scaled.
The Contractor is to report all discrepancies & errors to the Contract Manager prior to works commencing.

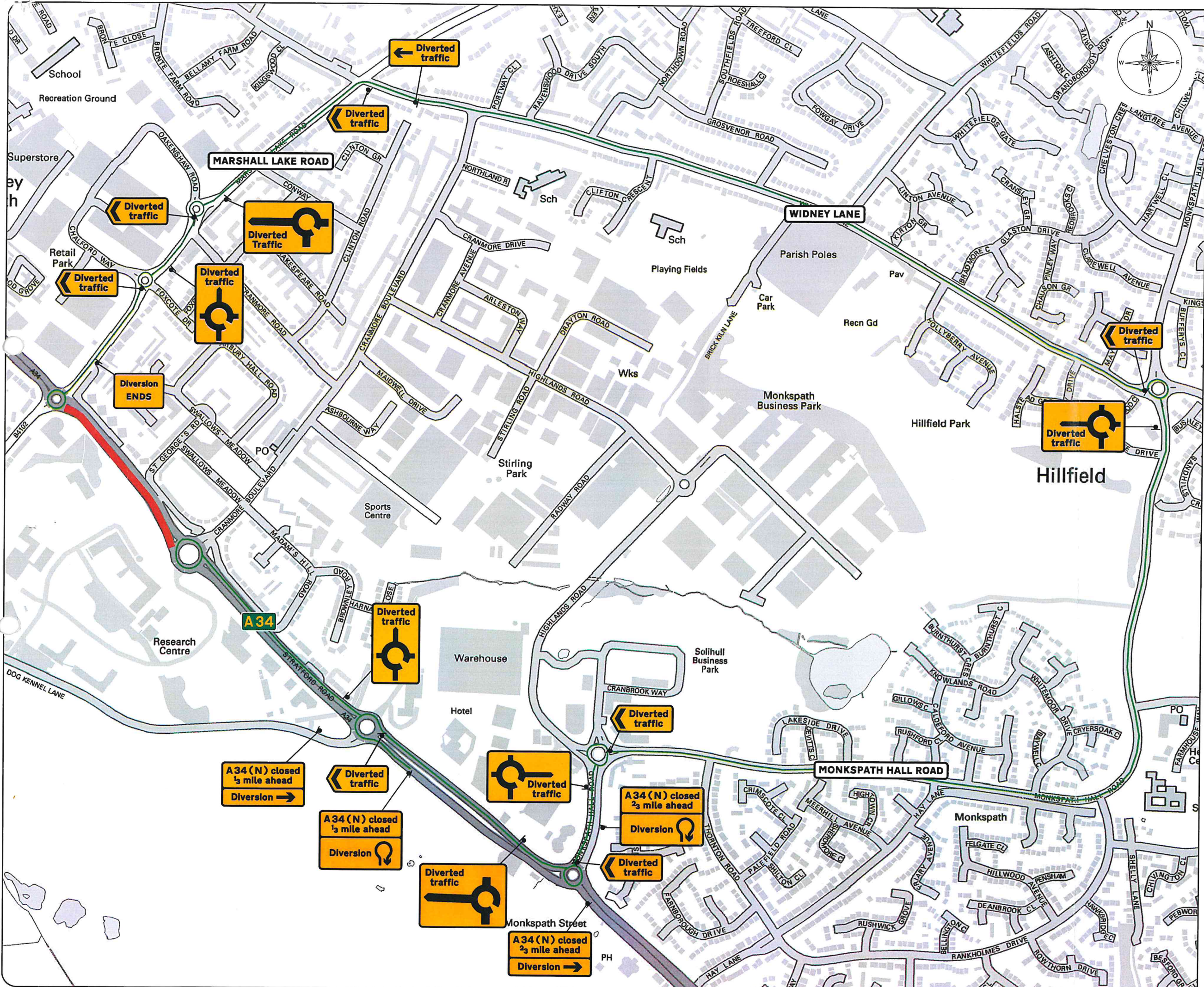

Key:

	Line of Works		Temporary Traffic Signal
	Works Area		Stop & Go Board
	Road Closure		Permanent Traffic Signal
	Diversion Route		Temporary Ped Signal
	Cone		Existing Bus Stop
	Pedestrian Barrier		3.5T Van
	Temporary Sign		

Notes:

Min width of sideways safety zone (S)	0.5m
Min length of longways clearance (L)	15m
Stratford Road	

Rev	Date	Comments	By	Chk

ERRIS
Working in Partnership with
traffix
total traffic & event management solutions
Old Arden Brickworks | Bickenhill | Solihull | West Midlands | B92 0DY
t +44 (0)800 819 9001 | f +44 (0)1675 442507
info@traffixuk.com | www.traffixuk.com

Project title:
Traffic Management

Drawing title:
Proposed Diversion Route
A34 Stratford Road
Solihull
B90 4AY

Date: 01/03/2022	Scale: NTS	Paper: A2
Drawn: CM	Checked: BN	Approved: PW
Project Number: TFX D7386	Drawing Number: 004	Revision: -

This drawing is copyright & the property of Traffic & must not be copied in whole or in part without their written permission. Copyright is reserved. © This drawing must not be scaled. The Contractor is to report all discrepancies & errors to the Contract Manager prior to works commencing.

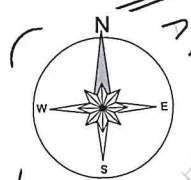
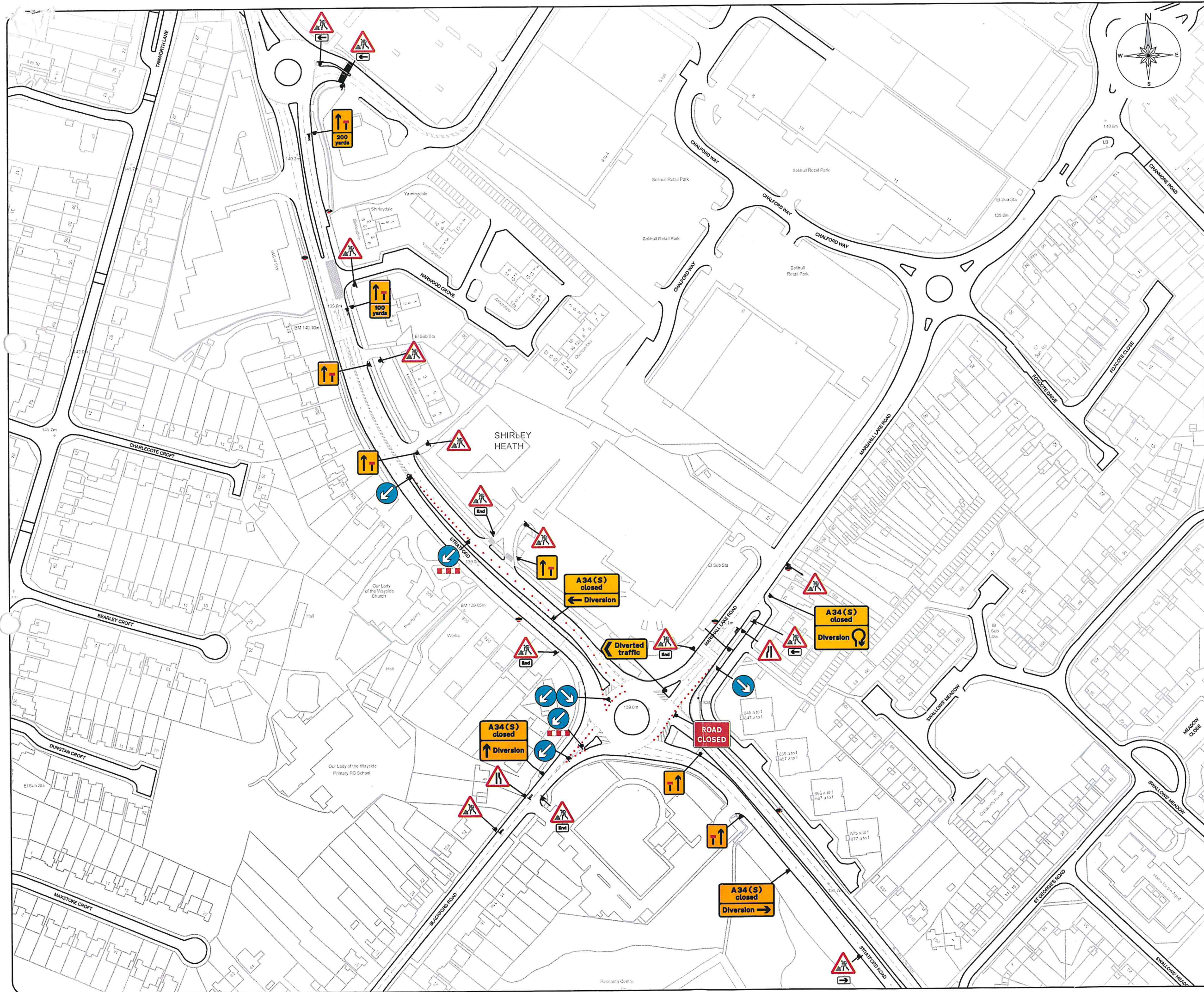

Key:	
	Line of Works
	Works Area
	Road Closure
	Diversion Route
	Cone
	Pedestrian Barrier
	Temporary Sign
	Temporary Traffic Signal
	Stop & Go Board
	Permanent Traffic Signal
	Temporary Ped Signal
	Existing Bus Stop
	3.5T Van

Notes:	
Min width of sideways safety zone (S)	0.5m
Min length of longways clearance (L)	15m
Stratford Road	40

WORKS ACCESS
Signs to be positioned as required to suit site conditions

TEMP BUS STOP SUSPENSION
Signs to be located as necessary to suit site conditions

Rev	Date	Comments	By	Chk

ERRIS
Working in Partnership with
traffix
total traffic & event management solutions
Old Arden Brickworks | Bickenhill | Solihull | West Midlands | B92 0DY
t +44 (0)800 819 9001 | f +44 (0)1675 442507
info@traffixuk.com | www.traffixuk.com

Project title: Traffic Management		
Drawing title: Proposed Road Closure A34 Stratford Road Solihull B90 4AY		
Date: 01/03/2022	Scale: NTS	Paper: A2
Drawn: CM	Checked: BN	Approved: PW
Project Number: TFX D7386	Drawing Number: 005	Revision: -

This drawing is copyright & the property of Traffic & must not be copied in whole or in part without their written permission. Copyright is reserved. © This drawing must not be scaled. The Contractor is to report all discrepancies & errors to the Contract Manager prior to works commencing.

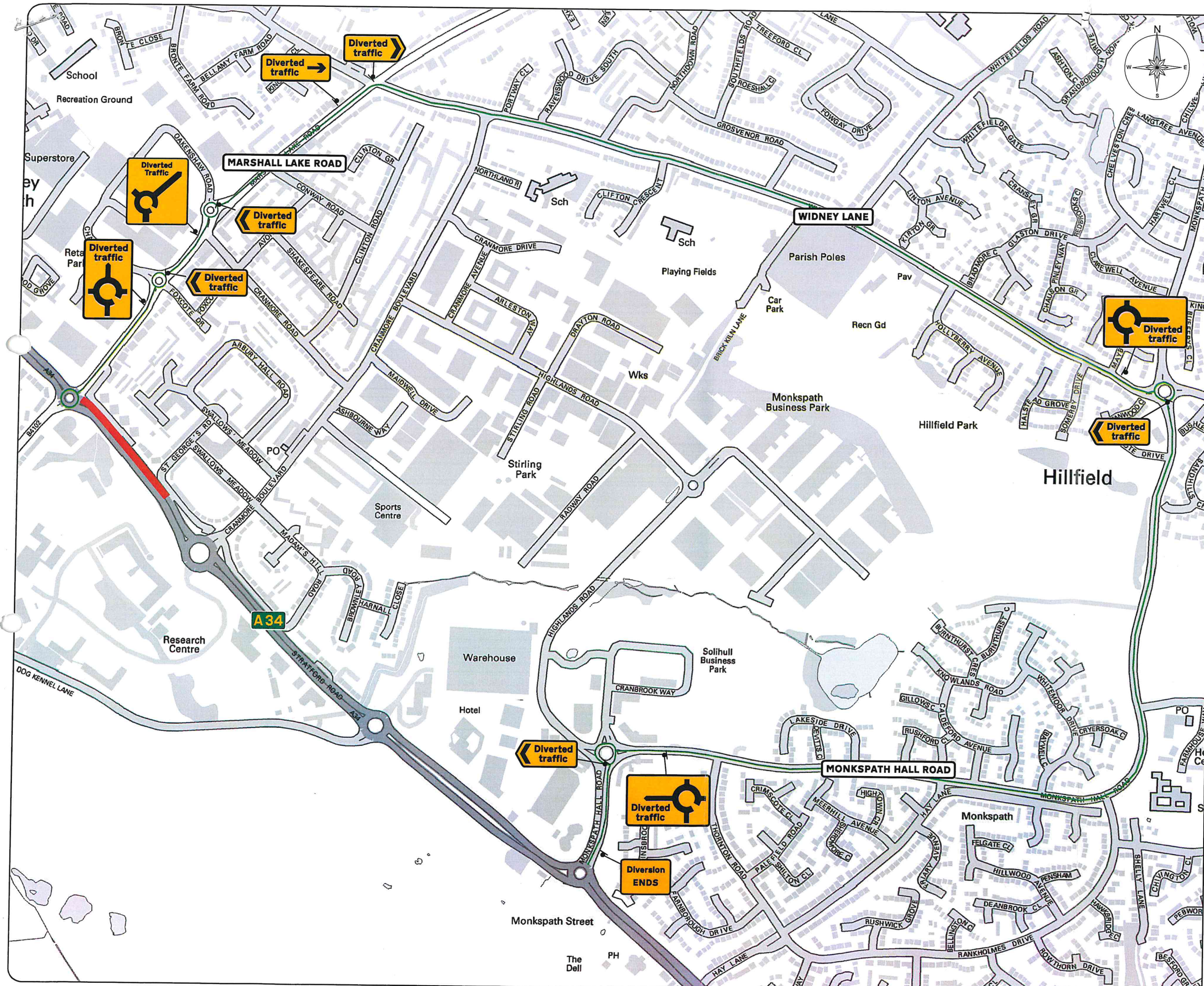

Key:

	Line of Works		Temporary Traffic Signal
	Works Area		Stop & Go Board
	Road Closure		Permanent Traffic Signal
	Diversion Route		Temporary Ped Signal
	Cone		Existing Bus Stop
	Pedestrian Barrier		3.5T Van
	Temporary Sign		

Notes:

Min width of sideways safety zone (S)	0.5m
Min length of longways clearance (L)	15m
Stratford Road	

Rev	Date	Comments	By	CHK

ERRIS
Working in Partnership with
traffix
total traffic & event management solutions
Old Arden Brickworks | Bickenhill | Solihull | West Midlands | B92 0DY
+44 (0)800 819 9001 | +44 (0)1675 442507
info@traffixuk.com | www.traffixuk.com

Project title:
Traffic Management

Drawing title:
Proposed Diversion Route
A34 Stratford Road
Solihull
B90 4AY

Date:	01/03/2022	Scale:	NTS	Paper:	A2
Drawn:	CM	Checked:	BN	Approved:	PW
Project Number:	TFX D7386	Drawing Number:	006	Revision:	-

This drawing is copyright & the property of Traffix & must not be copied in whole or in part without their written permission. Copyright is reserved. ©
The Contractor is to report all discrepancies & errors to the Contract Manager prior to works commencing.