

ISO A1 250mm x 841mm
 Drawn: RS
 Approved: AC
 Checked: PBM
 Designer: RS
 Project Management / Issue: RPH
 Lead issued by: PATRICK MILL (25/04/2024) Lead Review: 20/05/24
 File name: C:\PWORKING\AECOM_ISSUE_1\CLT\TR\HARD.GARDNER@AECOM.COM\043483240\2224\ACM-HAC-SMBC-DR-TR-2600001

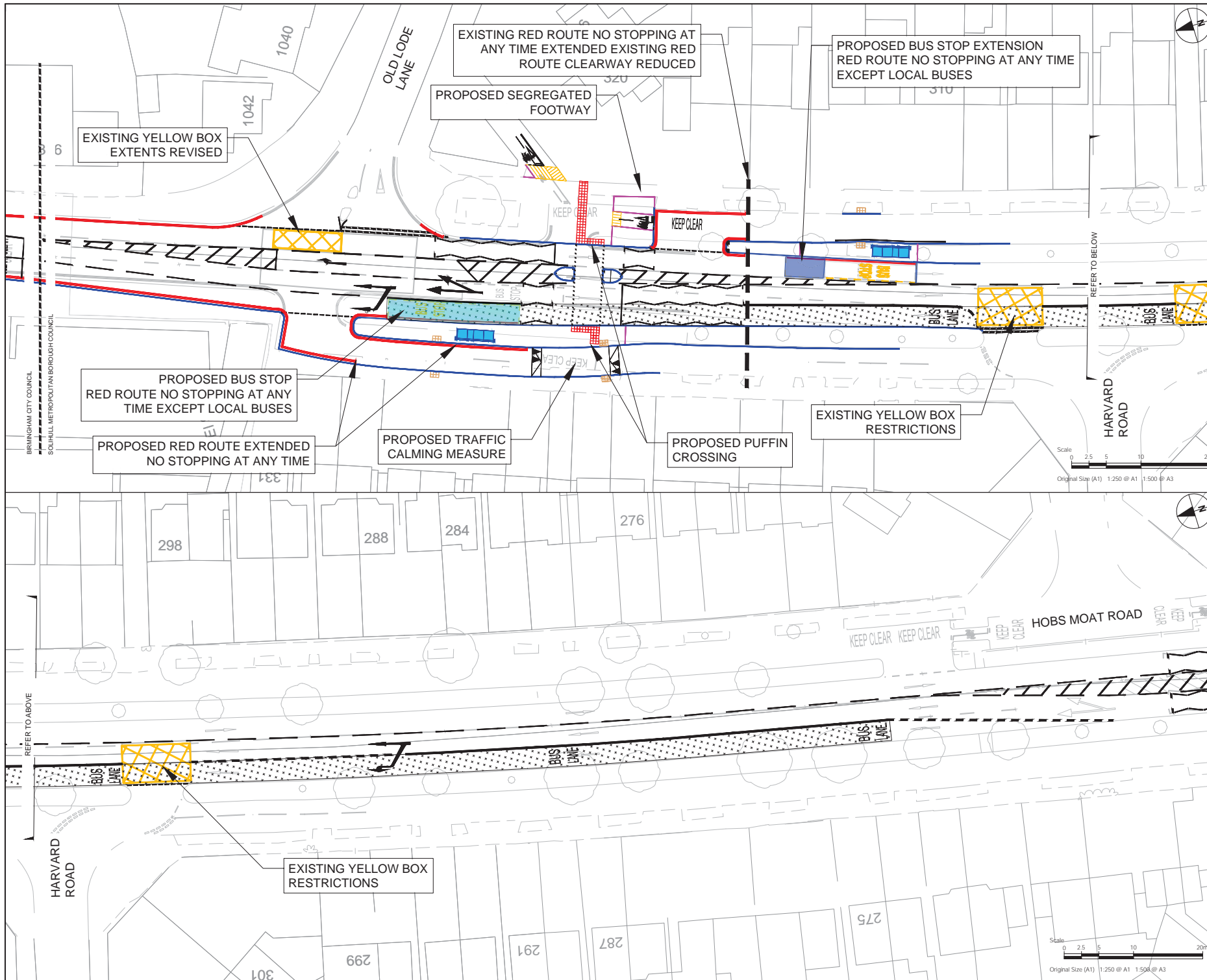

PROJECT
 Sprint Phase 2
 Package F



CONSULTANT
 AECOM
 The Colmore Building
 Colmore Circus Queensway
 Birmingham
 +44 (0) 121 262 1900
 www.aecom.com

REGISTRATION
 Reproduced from the Ordnance Survey map with the permission of H.M. Stationery Office. © Crown copyright reserved. Licence no. 100031673.

NOTES
 1. ALL WORKS SHALL BE CARRIED OUT IN ACCORDANCE WITH THE CONTRACT SPECIFICATION AND THE MANUAL OF CONTRACT DOCUMENTS FOR HIGHWAY WORKS INCLUDING REVISIONS/AMENDMENTS AND ANY CLIENT SPECIFIC ADDITIONAL OR SUBSTITUTE CLAUSES.
 2. ANY DISCREPANCIES, ERRORS OR OMISSIONS TO BE BROUGHT TO THE ATTENTION OF THE PROJECT MANAGER.
 3. ALL DIMENSIONS TO BE CHECKED BEFORE COMMENCEMENT OF WORK ON SITE.
 4. ALL DIMENSIONS IN METRES UNLESS OTHERWISE STATED.

- KEY**
- PROPOSED KERBLINE
 - PROPOSED BACK OF FOOTWAY/CYCLEWAY
 - PROPOSED ROAD MARKING
 - PROPOSED BUS STOP
 - PROPOSED BUS STOP EXTENSION
 - EXISTING ROAD MARKINGS
 - PROPOSED BUS LANE

UNLESS OTHERWISE STATED EXISTING RESTRICTIONS WILL REMAIN

REVISION / APPROVAL DATE
P04 30/05/24

ISSUE/REVISION	DATE	DESCRIPTION
P01	04/10/23	First Issue
P02	12/01/24	TRO Update
P03	06/03/24	TRO Update
P04	30/05/24	TRO Updates
IR	DATE	DESCRIPTION

ISSUE PURPOSE / SUITABILITY

Suitable for review & comment

PROJECT NUMBER
 60688007F
SHEET TITLE

PACKAGE F
 TRO CONSULTATION PLANS
 HOBBS MOAT ROAD/
 OLD LODE LANE
SHEET NUMBER

Project Number	Originator	Volume		
401222	-ACM	-HAC-		
Location	Type	Role	IMCHW	Number
SMBC-DR-TR	-2600	001		



This drawing has been prepared for the use of AECOM's client. It may not be used, modified, reproduced or relied upon by third parties, without the prior written consent of AECOM. AECOM accepts no responsibility, and disclaims any liability, whatsoever, to any party for use of this drawing without AECOM's express written consent. Do not scale this document. All measurements must be taken from the issued dimensions.