

**NOTE**

1.2 or 1m minimum footway will be maintained at all times.





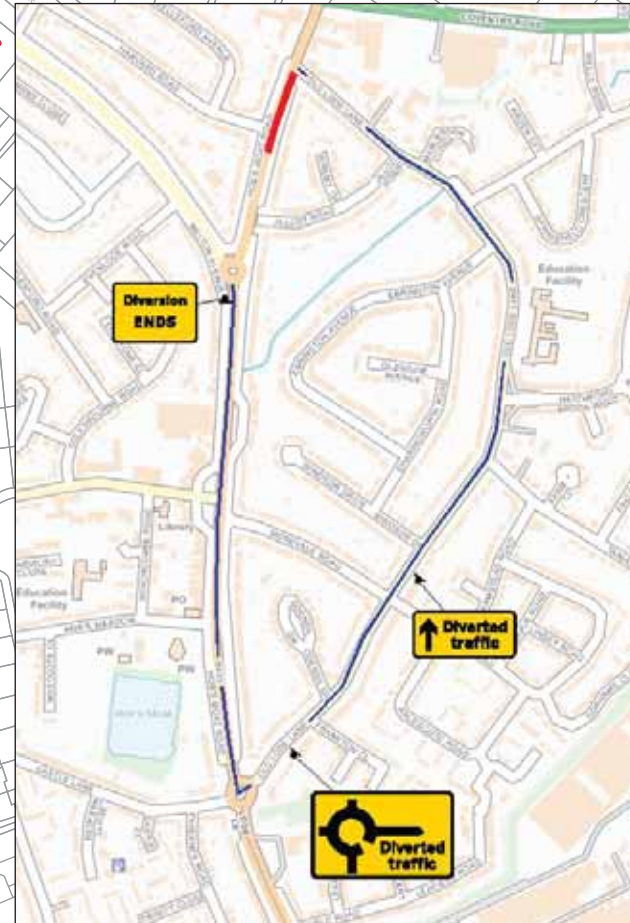
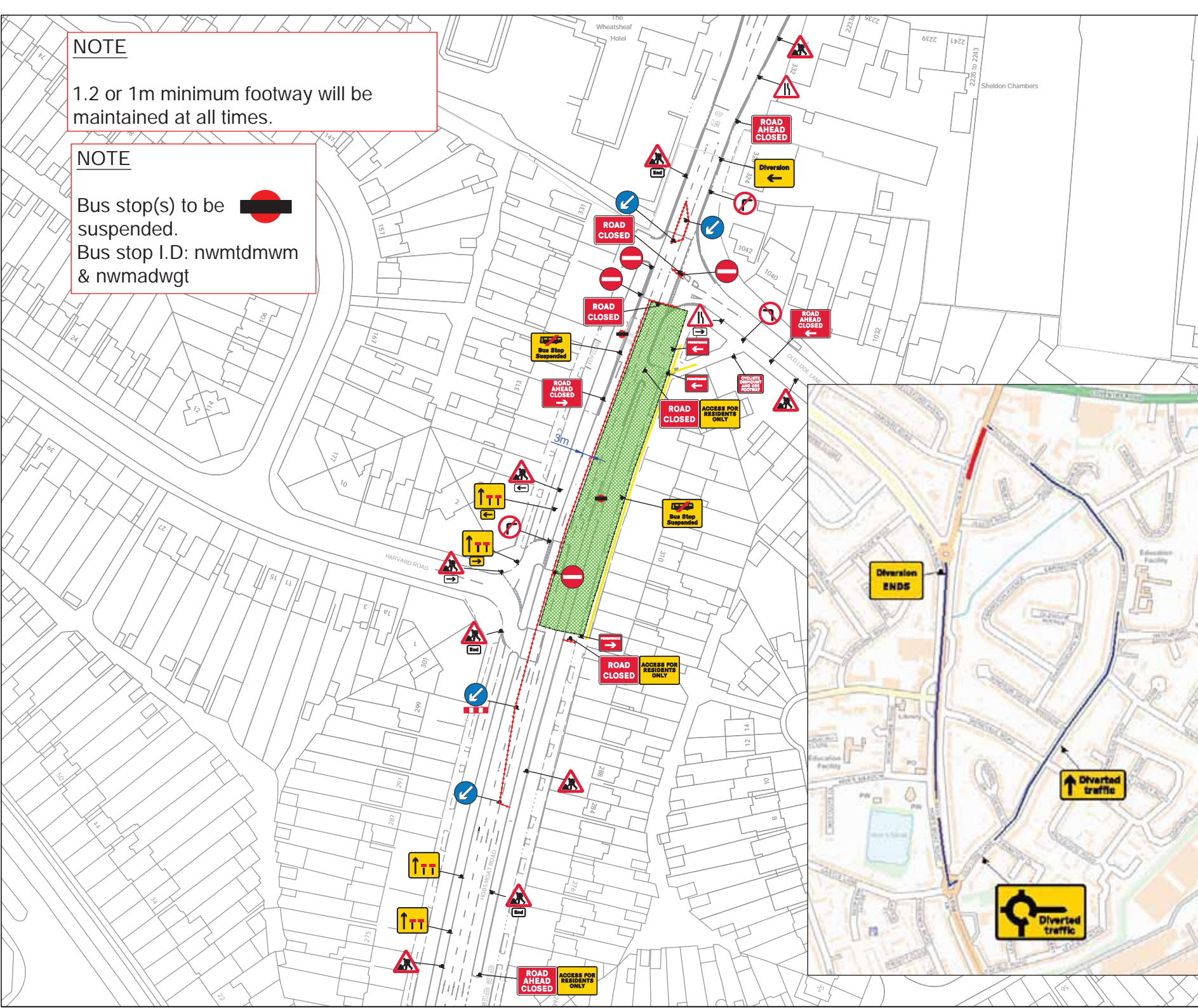

**NOTE**

Bus stop(s) to be suspended.   
 Bus stop I.D: nwmtmwm & nwmadwgt

Notes



Key

-  Traffic Cones
-  Pedestrian Barrier
-  Traffic Signal
-  Pedestrian Traffic Signal
-  Work Area
-  Pedestrian Diversion Route
-  Kerb Ramp

Crown Copyright. All rights reserved.

HOBBS MOAT RD CIVILS - PHASE 1A OB

401222-TWR-HGN-ZZ-DR-SU-0160001

Unauthorised reproduction infringes Crown Copyright and may lead to prosecution or civil proceedings.

Scale: NTS | Drawn by: SB | Approved by: MB