

Desktop survey undertaken from google street view with imagery dated: XX XXXX

All traffic management shall comply with all current legislation and guidance including Chapter 8, Safety at Street Works and Road Works (A Code of Practice).

Pedestrian management to be installed and managed to suit site conditions in accordance with current legislation & codes of practice by the contractor unless otherwise stated.

All signage and road markings shall conform with the Traffic Signs Regulations and General Directions (TSRGD).

Sign locations are indicative only, exact location to be determined on site.

Suitably qualified operative to assess site to ensure the installation complies with all current legislation. Any issues and/or changes from the original design should be immediately reported to the relevant contracts manager/designer.

This design is only valid for 12months from date of production and should be re-evaluated if installation is to take place after this period.

Size of signage:

40kmph	750mm	900mm
--------	-------	-------

Single carriageway permanent speed limit as shown below or less)

40	45	50 or more
----	----	------------

SIGN SCHEDULE

Qty 2 Ref: 573 Direction to hazard right	
Qty 1 Ref: 574 Direction to hazard left	
Qty 3 Ref: 610 Ahead left	
Qty 2 Ref: 610 Ahead right	
Qty 4 Ref: 645 End cycle	
Qty 3 Ref: 7001 Road works ahead	
Qty 2 Ref: 7004.1 Cycle Disruption and Lane Footway	
Qty 3 Ref: 7105 Lane closure barrier	
Qty 4 Ref: 7202.1 Temporary lane availability	
Qty 1 Ref: 7202.1 Temporary lane availability	
Qty 2 Ref: 7202.1 Temporary lane availability	
Qty 1 Ref: 721.13-B-CLAC Cycle lane ahead closed	
Qty 2 Ref: 721.13-B-CLC Cycle lane closed	

Key:

	Works Area		Temporary Traffic Signal
	Closure		Stop & Go Board
	Vehicular Diversion Route		Temporary Ped Signal
	Ped Diversion Route		Existing Bus Stop
	Cone		Temporary Sign
	Datum Point		Pedestrian Barrier

Safety information:

Min width of sideways safety zone (S)	0.5m
Min length of longways clearance (L)	0.5m
Blossomfield Road	

Site information:

NSG	BLOSSOMFIELD ROAD, SOLIHULL		
Local Authority	SOLIHULL		
USRN	35005020		
Road Type	Multilane carriageway	Road Width	Varies
Works Location	X:413120	Y:278416	
Surveyed	<input checked="" type="checkbox"/>	Bus Stop(s)	<input checked="" type="checkbox"/>
Perm Signals	<input checked="" type="checkbox"/>	Controlled Crossing	<input checked="" type="checkbox"/>
	<input checked="" type="checkbox"/>	Cycle Lanes	<input checked="" type="checkbox"/>

Chapter 8 details:

Detail B

Single/Dual carriageway 40mph or less - 450mm traffic cones.
Single/Dual carriageway 50mph or more - 750mm traffic cones.
Dual carriageway national speed limit - 750mm traffic cones.
relaxation 3m.

Notes:
1) During darkness, warning lights to BS EN 12352:2006 should be provided in accordance with Table A1.3 (Appendix 1).
2) 45° tapers have 1.2m spacing, no relaxations.
3) On motorways and NSL AP duals with hard shoulders, 1m cones will be required for both standard and relaxation works for lead tapers and the facing wall of lane changes.

Detail C1

Single/Dual carriageway 40mph or less - 450mm traffic cones.
Single/Dual carriageway 50mph or more - 750mm traffic cones.

Notes:
1) During darkness, warning lights to BS EN 12352:2006 should be provided in accordance with Table A1.3 (Appendix 1).
2) For relaxation to Detail C1 see Table A1.3 (Appendix 1).

Detail C2

Single carriageway 40mph or less - 450mm traffic cones.
Single/Dual carriageway 50mph or more - 750mm traffic cones.

Notes:
1) During darkness, warning lights to BS EN 12352:2006 should be provided in accordance with Table A1.3.

Rev	Date	Comments	By	City
A	17-09-2024	Taper adjusted to suit request to minimise impact on cycle lane	CM	PW

ERRIS
Working in Partnership with
traffix

total traffic & event management solutions
Old Arden Brickworks | Bickenhill | Solihull | West Midlands | B92 0DY
t +44 (0)800 819 9001 | f +44 (0)1875 442507
info@traffix.com | www.traffix.com

Project title:
Traffic Management

Drawing title:
Proposed Contraflow Blossomfield Road Solihull B91 1TF

Date:	20/08/2024	Scale:	NTS	Paper:	A2
Drawn:	CM	Checked:	PW	Approved:	PW
Project Number:	TFX D9398	Drawing Number:	002	Revision:	A

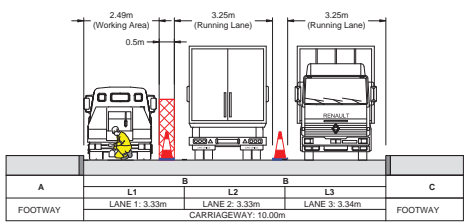

1- Safety zone
2- Carriageway width taken from Ordnance Survey data and should be confirmed on site
3- Existing lane widths have been assumed
4- Size of any plant/vehicles to be assessed to ensure they can operate safely in the area shown. Any vehicles shown are indicative only

This drawing is copyright & the property of Traffix & must not be copied in whole or in part without their written permission. Copyright is reserved. © This drawing must not be scaled. The Contractor is to report all discrepancies & errors to the Contract Manager prior to works commencing.