



Note:
20 Signs or below.

Go Traffic Management
This drawing has been produced for a specific client & project identified below and is not intended for use by any other person or for any other purpose. © Go Traffic Management

Risks

- Design completed from information provided + google maps desktop risk assessment
- Cone lamps must be used on all road with a speed limit of 40mph or more.

Notes

- All signs as per Chapter 8. Distances between cones to be 9m maximum unless otherwise noted.
- Distances between signs NOT to scale for purpose of clarity.
- All sign placement subject to available safe working space.
- The purpose of the Traffic Management Plan is for it to be used only as a guide and all traffic management equipment should be put out according to the "Safety of Street Works and Road Works - Code of Practice", i.e. Red Book & the "Traffic Signs Manual Chapter 8", i.e. Yellow Book.
- Signs must be placed in accordance with TSM and the scheme RAMS pack.
- Site conditions may have changed since the design of the drawing was produced which subsequently affect the design. Any changes reported by the Traffic Management Operative & any changes implemented must comply with Chapter 8.

Key

	Sign position and aspect of vision		Working Space
	Cones		Diversion Route 1
			Diversion Route 2

WRITTEN DIVERSION ROUTE: Hanbury Road, Poplar Road.

9m REMAINING CARRIAGEWAY WIDTH REMAINS. VULNERABLE ROAD USERS MUST FOLLOW DIVERSION

MINIMUM 5L SAFETY ZONE OF 0.5M MUST BE ADHERED TO

WORK AREA GREATER/LESS THAN 0.5 MILES

Traffic Management must comply with The Safety at Street Works and Road Works Code of Practice

ROAD SPEED

30

CROSS SECTION

DO NOT SCALE FROM THIS DRAWING

Road Closure	
A	09/09/24
REV.	DATE
	AS DRAWN
	DESCRIPTION

GTM
Go Traffic Management

Head Office: Go Traffic Management, Chaddock Lane, Worsley, Manchester, M28 1XW
Tel: 0161 351 5370
www.gtm.co.uk

TRAFFIC MANAGEMENT PLAN

Client: **SEVERN TRENT WATER**

Drawing Number: 13767898.0001

Drawing Title: Hanbury Road, Dorridge, B93 8DN

Design:	Technical Officer:	REV:
Name: D.Smith	M.Gardiner	A
Signature:		
Date: 09/09/24	09/09/24	

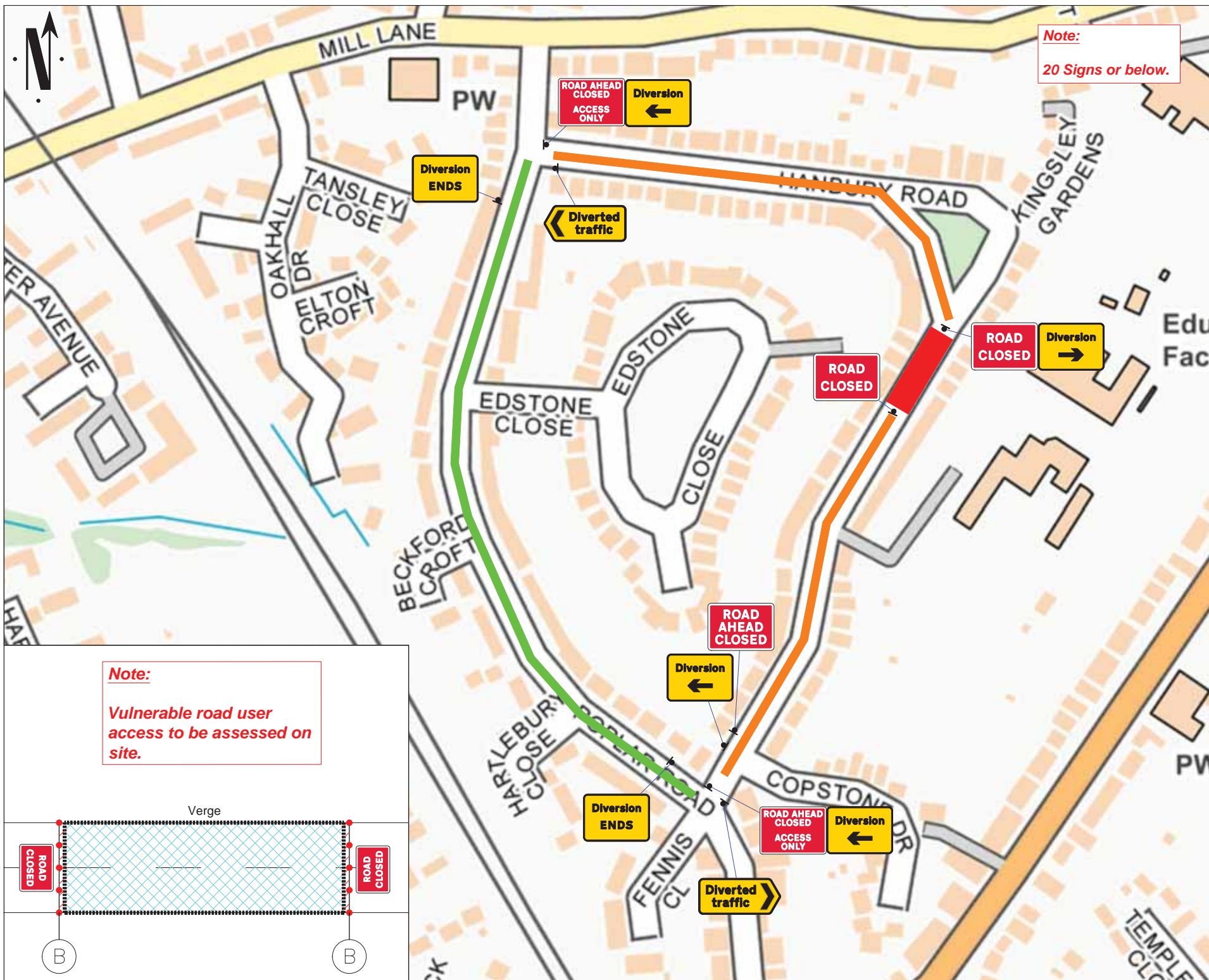

Note:
Vulnerable road user access to be assessed on site.

