

**NOTES:**

	Traffic sign		Diversion
	Cone		Diversion
	Work Area		WORKS ACCESS
	Safety Zone		WORKS EXIT

Works access/works exit to be risk assessed on site for suitability of location

Qty: 5 Ref: 7001 Road works ahead	
Qty: 5 Ref: 7010.1 Nature of temporary hazard ahead - Footpath Closed	
Qty: 8 Ref: 7018 Pedestrian diversion Left	
Qty: 10 Ref: 7018 Pedestrian diversion Right	

DIVERSION APPROX 300m

A		A	
B		B	
C		C	
D		D	

CLIENT:



**SITE:**  
1 Holly Lodge Walk, Fordbridge, Birmingham  
B37 5HG  
**GRID REF:** -----

**TITLE:** FOOTPATH CLOSURE

<b>SCALE AT 13:</b> NTS	<b>DATE:</b>	<b>DRAWN:</b> JB	<b>CHECKED:</b> LS
<b>DWG NO:</b> WMGA240249	<b>REV NO:</b>	001	

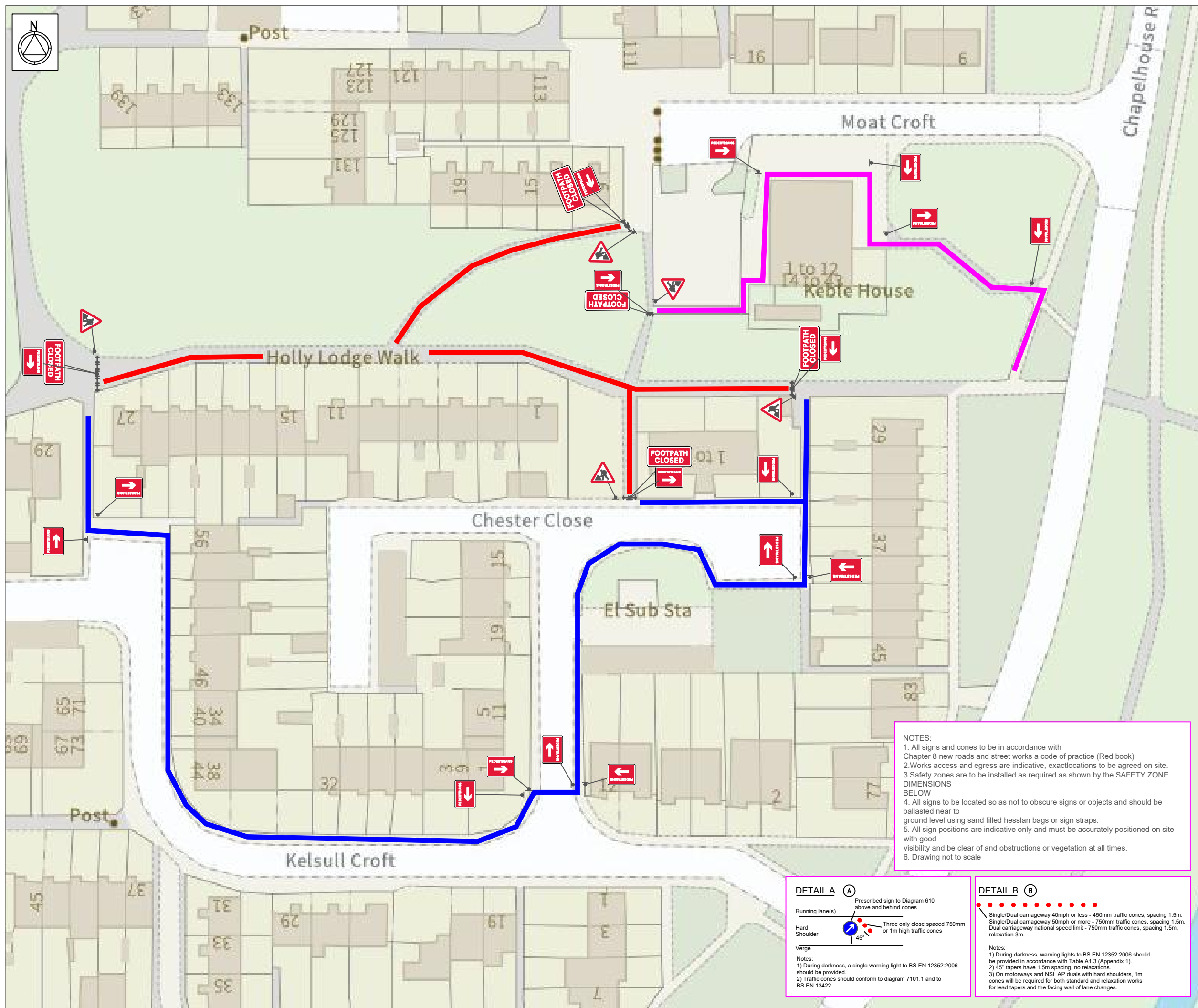

**NOTES:**  
 1. All signs and cones to be in accordance with Chapter 8 new roads and street works a code of practice (Red book)  
 2. Works access and egress are indicative, exact locations to be agreed on site.  
 3. Safety zones are to be installed as required as shown by the SAFETY ZONE DIMENSIONS BELOW  
 4. All signs to be located so as not to obscure signs or objects and should be ballasted near to ground level using sand filled hessian bags or sign straps.  
 5. All sign positions are indicative only and must be accurately positioned on site with good visibility and be clear of and obstructions or vegetation at all times.  
 6. Drawing not to scale

