

NOTES:
 1. All signs and cones to be in accordance with Chapter 8 new roads and street works a code of practice (Red book)
 2. Works access and egress are indicative, exact locations to be agreed on site.
 3. Safety zones are to be installed as required as shown by the SAFETY ZONE DIMENSIONS BELOW
 4. All signs to be located so as not to obscure signs or objects and should be ballasted near to ground level using sand filled hessian bags or sign straps.
 5. All sign positions are indicative only and must be accurately positioned on site with good visibility and be clear of and obstructions or vegetation at all times.
 6. Drawing not to scale

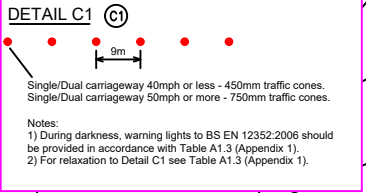
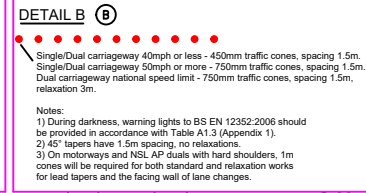
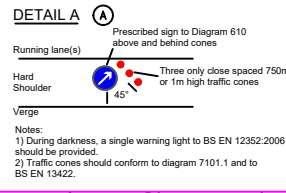
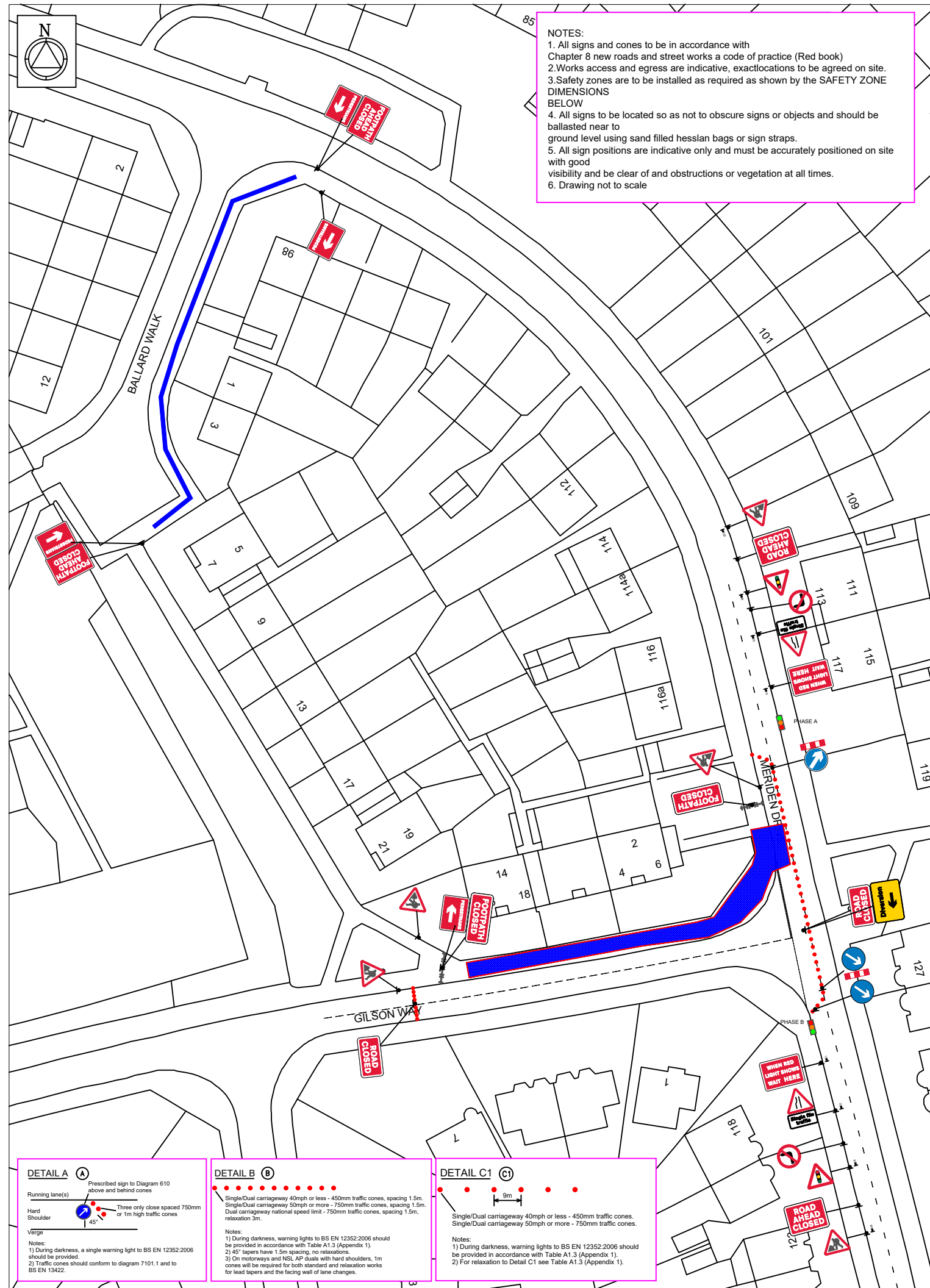

Qty: 1 Ref: 13-9 Schedule 13 : Temporary Sign		Qty: 2 Ref: 610 Keep right	
Qty: 2 Ref: 13-9 Schedule 13 : Temporary Sign		Qty: 1 Ref: 610 Keep left	
Qty: 3 Ref: 2702 Start of temporary diversion route		Qty: 5 Ref: 7001 Road works ahead	
Qty: 5 Ref: 2702 Start of temporary diversion route		Qty: 2 Ref: 7010.1 Nature of temporary hazard ahead - Road Closed	
Qty: 2 Ref: 2702 End of temporary diversion route		Qty: 7 Ref: 7010.1 Nature of temporary hazard ahead - Road Ahead Closed	
Qty: 1 Ref: 2703 Direction of temporary diversion route from junction ahead		Qty: 2 Ref: 7010.1 Nature of temporary hazard ahead - Footpath Closed	
Qty: 1 Ref: 2703 Direction of temporary diversion route from junction ahead		Qty: 2 Ref: 7011 When Red Light Shows Wait Here	
Qty: 1 Ref: 517 Road narrows on one side only ahead - left		Qty: 3 Ref: 7018 Pedestrian diversion Left	
Qty: 1 Ref: 517 Road narrows on one side only ahead - right		Qty: 1 Ref: 7018 Pedestrian diversion Right	
Qty: 2 Ref: 518 Single file traffic		Qty: 2 Ref: 7105 Lane closure barrier	
Qty: 2 Ref: 543 Traffic signals ahead			

NOTES:
 Traffic sign
 Cone
 Work Area
 Safety Zone
 Diversion
 Diversion
 WORKS ACCESS
 WORKS EXIT
 Works access/ works exit to be risk assessed on site for suitability of location

TRAFFIC MANAGEMENT NOTES

2 WAY TRAFFIC SIGNALS:
 NOTES
 1 All traffic signs shall comply with Chapter 8 of the Traffic Signs Manual
 2 Maximum distance between any two temporary traffic signals to be 249m. Minimum distance between any two temporary traffic signals to be 30m.
 3 Temporary traffic signals shall not occur within 150m of an existing level crossing. Pelican crossing or signalised junction without the consent of the Engineer. The Engineer shall consult with the authority responsible for any of these types of facility prior to traffic management being installed in adjacent areas.
 4 Coning shall be installed at 45° to the edge of carriageway, as generally indicated.
 5 Cable crossing protectors and P7010/P7013 signs shall be provided whenever control cables cross a section of carriageway open to traffic.
 6 The signal control mechanism shall normally be placed in a location from which it is possible to view all approaches to the site.
 7 Duplicate primary signal to be installed as instructed.
 8 Lane width past the works to be 3.7m maximum, 3.25m desirable minimum, 3.0m absolute minimum.

SPEED OF ROAD:
 LONGWAYS: 0.5m
 SIDEWAYS: 0.5m

DIVERSION ROUTE:
 FORDBRIDGE ROAD

A	35	A	10
B	35	B	10
C		C	
D		D	

CLIENT:

 Your Gas Network

SITE:
 123 Meriden Dr, Birmingham B37 6BH

GRID REF: -----

TITLE: TWO WAY SIGNALS + ROAD CLOSURE

SCALE AT 13: NTS	DATE:	DRAWN: JB	CHECKED: LS
DWG NO: WMGA250031	REV NO:	001	

