

Desktop survey undertaken from google street view with imagery dated:

All traffic management shall comply with all current legislation and guidance including Chapter 8, Safety at Street Works and Road Works (A Code of Practice).

Pedestrian management to be installed and managed to suit site conditions in accordance with current legislation & codes of practice by the contractor unless otherwise stated.

All signage and road markings shall conform with the Traffic Signs Regulations and General Directions (TSRGD).

Sign locations are indicative only, exact location to be determined on site.

Suitably qualified operative to assess site to ensure the installation complies with all current legislation. Any issues and/or changes from the original design should be immediately reported to the relevant contracts manager/designer.

This design is only valid for 12months from date of production and should be re-evaluated if installation is to take place after this period.

Key:

	Works Area		Temporary Traffic Signal
	Closure		Stop & Go Board
	Vehicular Diversion Route		Temporary Ped Signal
	Ped Diversion Route		Existing Bus Stop
	Cone		Temporary Sign
	Datum Point		Pedestrian Barrier

Safety information:

Min width of sideways safety zone (S)	
Min length of longways clearance (L)	

Site information:

NSG	RUMBUSH LANE, EARLSWOOD, SOLIHULL		
Local Authority	SOLIHULL		
USRN	35005322		
Road Type	Single lane carriageway	Road Width	Varies
Works Location	X409755	Y	274523
Surveyed	<input checked="" type="checkbox"/> Bus Stop(s)	Parked Vehicles	
Perm Signals	<input type="checkbox"/> Controlled Crossing	Cycle Lanes	

SIGN SCHEDULE

Qty: 3 Ref: 159 Schedule 15: Temporary Sign	
Qty: 3 Ref: 159 Schedule 15: Temporary Sign	
Qty: 1 Ref: 159 Schedule 15: Temporary Information	
Qty: 1 Ref: 159 Schedule 15: Temporary Information	
Qty: 1 Ref: 159 Schedule 15: Temporary Information	
Qty: 1 Ref: 202 Start of temporary diversion route	
Qty: 1 Ref: 202 End of temporary diversion route	
Qty: 1 Ref: 202 Direction of temporary diversion route from junction ahead	
Qty: 1 Ref: 202 Direction of temporary diversion route from junction ahead	
Qty: 1 Ref: 202 Direction of temporary diversion route from junction ahead	
Qty: 1 Ref: 202 Direction of temporary diversion route from junction ahead	
Qty: 1 Ref: 573 Direction to hoard left	
Qty: 1 Ref: 573 Direction to hoard right	
Qty: 1 Ref: 701 Road works ahead	
Qty: 1 Ref: 701FP-159 Notice of temporary hoard ahead - Road Closed	
Qty: 1 Ref: 701FP-159 Notice of temporary hoard ahead - Road Ahead Closed	

Chapter 8 details:

Detail B

Single/Dual carriageway 40mph or less - 450mm traffic cones.
Single/Dual carriageway 50mph or more - 750mm traffic cones.
Dual carriageway national speed limit - 750mm traffic cones.
relaxation 3m.

Notes:
1) During darkness, warning lights to BS EN 12352:2006 should be provided in accordance with Table A1.3 (Appendix 1).
2) 45° tapers have 1.2m spacing, no relaxations.
3) On motorways and NSL AP ducts with hard shoulders, 1m cones will be required for both standard and relaxation works for lead tapers and the facing wall of lane changes.

Detail C1

Single/Dual carriageway 40mph or less - 450mm traffic cones.
Single/Dual carriageway 50mph or more - 750mm traffic cones.

Notes:
1) During darkness, warning lights to BS EN 12352:2006 should be provided in accordance with Table A1.3 (Appendix 1).
2) For relaxation to Detail C1 see Table A1.3 (Appendix 1).

Detail C2

Single carriageway 40mph or less - 450mm traffic cones.
Single/Dual carriageway 50mph or more - 750mm traffic cones.

Notes:
1) During darkness, warning lights to BS EN 12352:2006 should be provided in accordance with Table A1.3.

Rev	Date	Comments	By	Chy

Working in Partnership with

traffix

total traffic & event management solutions

Old Arden Brickworks | Bickenhill | Solihull | West Midlands | B92 0DY
t +44 (0)853 819 9011 | f +44 (0)1875 442507
info@traffixuk.com | www.traffixuk.com

Project title:
Traffic Management

Drawing title:
Proposed Road Closure
Rumbush Lane
Earlswood
B94 5JR

Date:	Scale:	Paper:
23/01/2025	NTS	A2
Drawn:	Checked:	Approved:
BN	CM	MB
Project Number:	Drawing Number:	Revision:
TFX MB1112	001	-

This drawing is copyright & the property of Traffix & must not be copied in whole or in part without their written permission. Copyright is reserved. © This drawing must not be scaled.
The Contractor is to report all discrepancies & errors to the Contract Manager prior to works commencing.

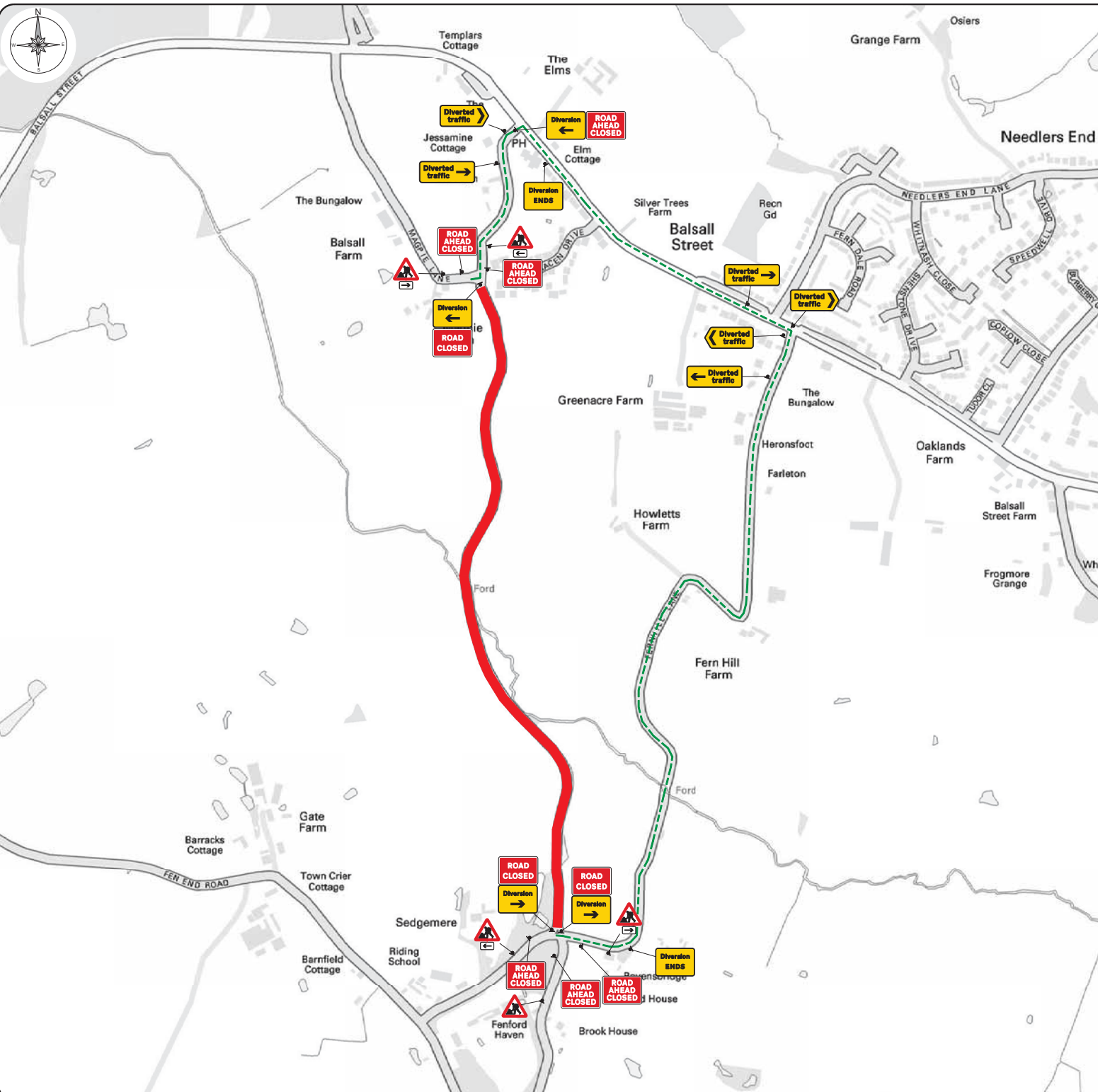

Desktop survey undertaken from google street view with imagery dated: June 2023

All traffic management shall comply with all current legislation and guidance including Chapter 8, Safety at Street Works and Road Works (A Code of Practice).

Pedestrian management to be installed and managed to suit site conditions in accordance with current legislation & codes of practice by the contractor unless otherwise stated.

All signage and road markings shall conform with the Traffic Signs Regulations and General Directions (TSRGD).

Sign locations are indicative only, exact location to be determined on site.

Suitably qualified operative to assess site to ensure the installation complies with all current legislation. Any issues and/or changes from the original design should be immediately reported to the relevant contracts manager/designer.

This design is only valid for 12 months from date of production and should be re-evaluated if installation is to take place after this period.

Div. 2 Ref: 2010 Start of temporary diversion route	
Div. 3 Ref: 2010 Start of temporary diversion route	
Div. 4 Ref: 2010 End of temporary diversion route	
Div. 1 Ref: 2010 Direction of temporary diversion route from junction ahead	
Div. 5 Ref: 2010 Direction of temporary diversion route from junction ahead	
Div. 1 Ref: 2014 Direction of temporary diversion route	
Div. 2 Ref: 2014 Direction of temporary diversion route	
Div. 3 Ref: 2015 Direction to forward sign	
Div. 4 Ref: 2015 Direction to forward sign	
Div. 5 Ref: 2011 Road works ahead	
Div. 3 Ref: 2014P-1.3.4 Nature of temporary hazard ahead - Road Closed	
Div. 6 Ref: 2014P-1.3.4 Nature of temporary hazard ahead - Road Ahead Closed	

Key:

	Works Area		Temporary Traffic Signal
	Closure		Stop & Go Board
	Vehicular Diversion Route		Temporary Ped Signal
	Ped Diversion Route		Existing Bus Stop
	Cone		Temporary Sign
	Datum Point		Pedestrian Barrier

Safety information:

Min width of sideways safety zone (S)	
Min length of longways clearance (L)	

Site information:

NSG	LONGBROOK LANE, FEN END, SOLIHULL		
Local Authority	SOLIHULL		
USRN	35005830		
Road Type	Single lane carriageway	Road Width	Varies
Works Location	X-422286	Y-276184	
Surveyed	<input checked="" type="checkbox"/>	Bus Stop(s)	<input type="checkbox"/>
Perm Signals	<input checked="" type="checkbox"/>	Controlled Crossing	<input type="checkbox"/>
		Parked Vehicles	<input type="checkbox"/>
		Cycle Lanes	<input type="checkbox"/>

Chapter 8 details:

Detail B

Single/Dual carriageway 40mph or less - 450mm traffic cones.
Single/Dual carriageway 50mph or more - 750mm traffic cones.
Dual carriageway national speed limit - 750mm traffic cones.
relaxation 3m.

Notes:
1) During darkness, warning lights to BS EN 12352:2006 should be provided in accordance with Table A1.3 (Appendix 1).
2) 45° tapers have 1.2m spacing, no relaxations.
3) On motorways and NSL AP duals with hard shoulders, 1m cones will be required for both standard and relaxation works for lead tapers and the facing wall of lane changes.

Detail C1

Single/Dual carriageway 40mph or less - 450mm traffic cones.
Single/Dual carriageway 50mph or more - 750mm traffic cones.

Notes:
1) During darkness, warning lights to BS EN 12352:2006 should be provided in accordance with Table A1.3 (Appendix 1).
2) For relaxation to Detail C1 see Table A1.3 (Appendix 1).

Detail C2

Single carriageway 40mph or less - 450mm traffic cones.
Single/Dual carriageway 50mph or more - 750mm traffic cones.

Notes:
1) During darkness, warning lights to BS EN 12352:2006 should be provided in accordance with Table A1.3.

Rev	Date	Comments	By	Chk

Balfour Beatty
Living Places
Working in Partnership with
traffix

total traffic & event management solutions
Old Arden Brickworks | Bickenhill | Solihull | West Midlands | B92 0DY
t+44 (0)853 819 9001 | f+44 (0)1875 442507
info@traffixuk.com | www.traffixuk.com

Project title:
Traffic Management

Drawing title:
Proposed Road Closure
Longbrook Lane
Fen End
CV8 1NU

Date:	21/01/2025	Scale:	NTS	Paper:	A2
Drawn:	BN	Checked:	CM	Approved:	MB
Project Number:	TFX MB1121	Drawing Number:	002	Revision:	-

This drawing is copyright & the property of Traffix & must not be copied in whole or in part without their written permission. Copyright is reserved. © This drawing must not be scaled.
The Contractor is to report all discrepancies & errors to the Contract Manager prior to works commencing.

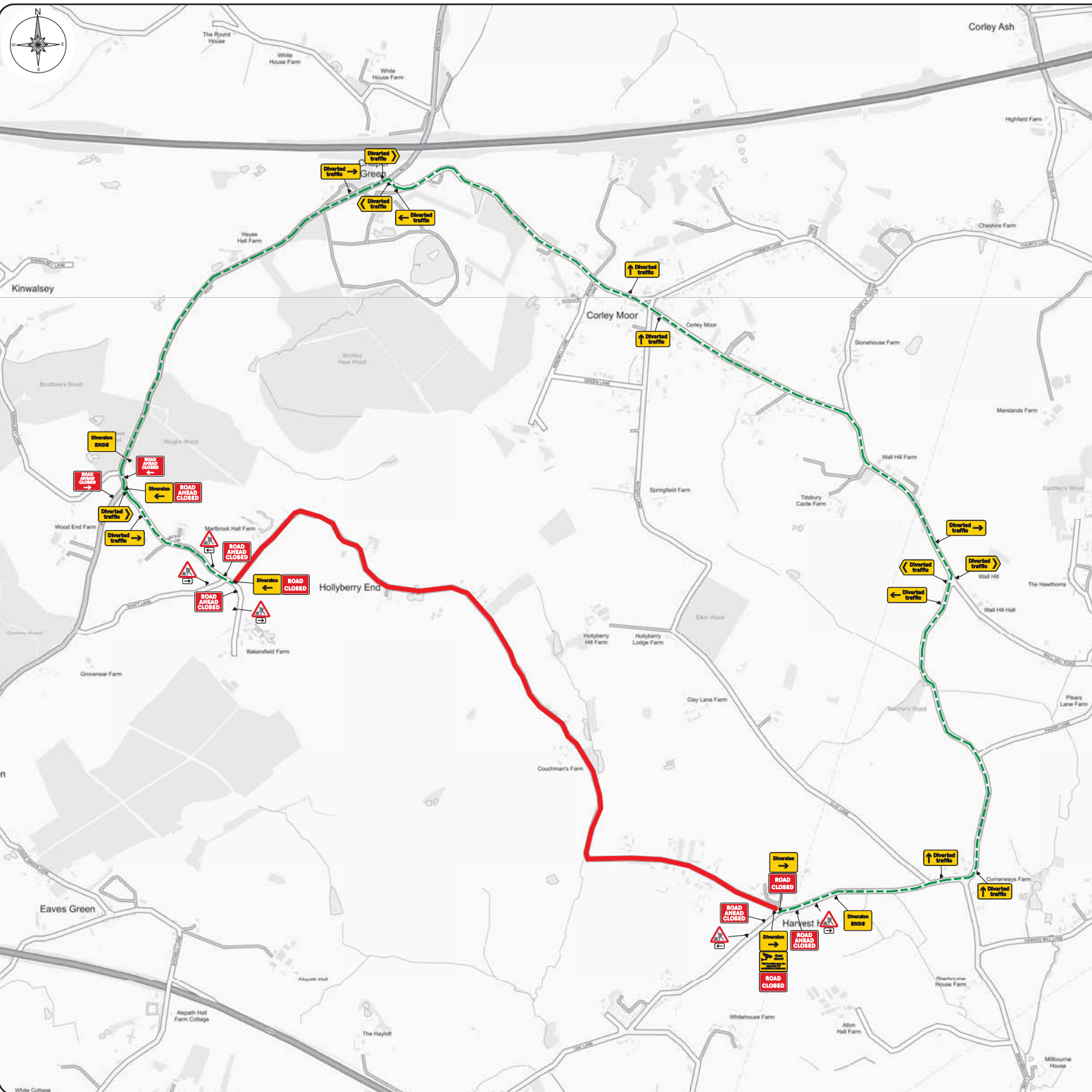

Desktop survey undertaken from google street view with imagery dated: October 2022
 All traffic management shall comply with all current legislation and guidance including Chapter 8, Safety at Street Works and Road Works (A Code of Practice).
 Pedestrian management to be installed and managed to suit site conditions in accordance with current legislation & codes of practice by the contractor unless otherwise stated.
 All signage and road markings shall conform with the Traffic Signs Regulations and General Directions (TSRGD).
 Sign locations are indicative only, exact location to be determined on site.
 Suitably qualified operative to assess site to ensure the installation complies with all current legislation. Any issues and/or changes from the original design should be immediately reported to the relevant contracts manager/designer.
 This design is only valid for 12 months from date of production and should be re-evaluated if installation is to take place after this period.

SIGN SCHEDULE

Qty 1 Ref 104 Schedule 10 - Temporary Sign	
Qty 1 Ref 104 Schedule 11 - Temporary Sign	
Qty 3 Ref 104 Schedule 10 - Temporary Sign	
Qty 2 Ref 202 Div of temporary diversion route	
Qty 2 Ref 202 Div of temporary diversion route	
Qty 2 Ref 202 Div of temporary diversion route	
Qty 4 Ref 203 Direction of temporary diversion route from junction ahead	
Qty 3 Ref 203 Direction of temporary diversion route from junction ahead	
Qty 3 Ref 203 Direction of temporary diversion route from junction ahead	
Qty 3 Ref 204 Direction of temporary diversion route	
Qty 3 Ref 204 Direction of temporary diversion route	
Qty 3 Ref 204 Direction of temporary diversion route	
Qty 5 Ref 205 Road works ahead	
Qty 5 Ref 205 Road works ahead	
Qty 3 Ref 205 Road works ahead	

Key:

	Work Area		Temporary Traffic Signal
	Closure		Stop & Go Board
	Vehicular Diversion Route		Temporary Ped Signal
	Ped Diversion Route		Existing Bus Stop
	Cone		Temporary Sign
	Datum Point		Pedestrian Barrier

Safety information:

Min width of sideways safety zone (S)	
Min length of longways clearance (L)	

Site information:

NSG	HARVEST HILL LANE, MERIDEN, SOLIHULL		
Local Authority	SOLIHULL		
USRN	35004837		
Road Type	Single lane carriageway	Road Width	Varies
Works Location	X-427750	Y-283097	
Surveyed	<input checked="" type="checkbox"/>	Bus Stop(s)	<input type="checkbox"/>
Perm Signals	<input type="checkbox"/>	Controlled Crossing	<input type="checkbox"/>
		Parked Vehicles	<input type="checkbox"/>
		Cycle Lanes	<input type="checkbox"/>

- Chapter 8 details:**
- Detail B**
-
- Single/Dual carriageway 40mph or less - 450mm traffic cones.
 - Single/Dual carriageway 50mph or more - 750mm traffic cones.
 - Dual carriageway national speed limit - 750mm traffic cones, relaxation 3m.
- Notes:
- 1) During darkness, warning lights to BS EN 12352:2006 should be provided in accordance with Table A1.3 (Appendix 1).
 - 2) 45° tapers have 1.2m spacing, no relaxations.
 - 3) On motorways and NSL/AP duals with hard shoulders, 1m cones will be required for both standard and relaxation works for lead tapers and the facing wall of lane changes.
- Detail C1**
-
- Single/Dual carriageway 40mph or less - 450mm traffic cones.
 - Single/Dual carriageway 50mph or more - 750mm traffic cones.
- Notes:
- 1) During darkness, warning lights to BS EN 12352:2006 should be provided in accordance with Table A1.3 (Appendix 1).
 - 2) For relaxation to Detail C1 see Table A1.3 (Appendix 1).
- Detail C2**
-
- Single carriageway 40mph or less - 450mm traffic cones.
 - Single/Dual carriageway 50mph or more - 750mm traffic cones.
- Notes:
- 1) During darkness, warning lights to BS EN 12352:2006 should be provided in accordance with Table A1.3.

Rev	Date	Comments	By	Chy

Balfour Beatty
 Living Places
 Working in Partnership with

traffix

total traffic & event management solutions
 Old Arden Brickworks | Bickenhill | Solihull West Midlands | B92 0DY
 t+44 (0)248 819 9001 | f+44 (0)1875 442507
 info@traffixuk.com | www.traffixuk.com

Project title:
 Traffic Management

Drawing title:
 Proposed Road Closure
 Harvest Hill Lane
 Meriden
 CV5 9DE

Date:	17/01/2024	Scale:	NTS	Paper:	A2
Drawn:	BN	Checked:	MB	Approved:	MB
Project Number:	TFX MB1162	Drawing Number:	002	Revision:	-

This drawing is copyright & the property of Traffic & must not be copied in whole or in part without their written permission. Copyright is reserved. © This drawing must not be scaled. The Contractor is to report all discrepancies & errors to the Contract Manager prior to works commencing.



Challenge Adventure Group

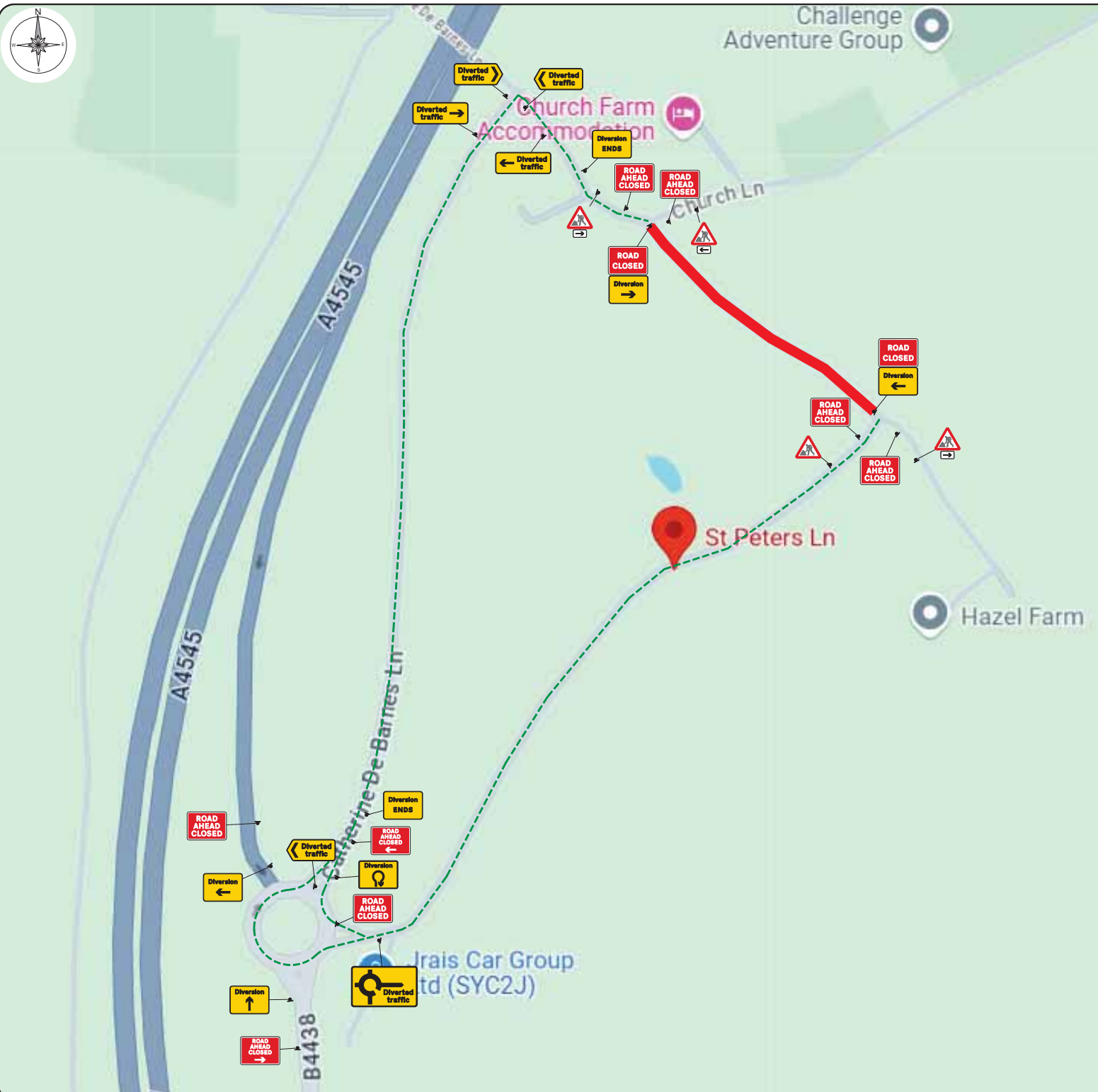

Desktop survey undertaken from google street view with imagery dated: June 2023

All traffic management shall comply with all current legislation and guidance including Chapter 8, Safety at Street Works and Road Works (A Code of Practice).

Pedestrian management to be installed and managed to suit site conditions in accordance with current legislation & codes of practice by the contractor unless otherwise stated.

All signage and road markings shall conform with the Traffic Signs Regulations and General Directions (TSRGD).

Sign locations are indicative only, exact location to be determined on site.

Suitably qualified operative to assess site to ensure the installation complies with all current legislation. Any issues and/or changes from the original design should be immediately reported to the relevant contracts manager/designer.

This design is only valid for 12months from date of production and should be re-evaluated if installation is to take place after this period.

Key:	
	Works Area
	Closure
	Vehicular Diversion Route
	Ped Diversion Route
	Cone
	Datum Point
	Temporary Traffic Signal
	Stop & Go Board
	Temporary Ped Signal
	Existing Bus Stop
	Temporary Sign
	Pedestrian Barrier

Safety information:	
Min width of sideways safety zone (S)	
Min length of longways clearance (L)	

Site information:	
NSG	ST. PETERS LANE, BICKENHILL, SOLIHULL
Local Authority	SOLIHULL
USRN	35005690
Road Type	Single lane carriageway
Road Width	Varies
Works Location	X:418781 Y:282304
Surveyed	<input checked="" type="checkbox"/> Bus Stop(s) <input type="checkbox"/> Parked Vehicles
Perm Signals	<input checked="" type="checkbox"/> Controlled Crossing <input type="checkbox"/> Cycle Lanes

SIGN SCHEDULE

Qty: 1 Ref: 154 Schedule 13: Temporary Sign	
Qty: 1 Ref: 154 Schedule 13: Temporary Sign	
Qty: 1 Ref: 154 Schedule 13: Temporary Sign	
Qty: 2 Ref: 202 End of temporary diversion route	
Qty: 1 Ref: 202 End of temporary diversion route	
Qty: 2 Ref: 202 Start of temporary diversion route	
Qty: 1 Ref: 202 Start of temporary diversion route	
Qty: 1 Ref: 202 Diversion of temporary diversion route from junction ahead	
Qty: 1 Ref: 202 Diversion of temporary diversion route from junction ahead	
Qty: 1 Ref: 204 Diversion of temporary diversion route	
Qty: 1 Ref: 204 Roundabout ahead leading to temporary diversion route	
Qty: 2 Ref: 573 Direction to tapered right	
Qty: 1 Ref: 573 Direction to tapered left	
Qty: 4 Ref: 7001 Road works ahead	
Qty: 2 Ref: 7016-FP-13.6 Notice of temporary hazard ahead - Road Closed	
Qty: 6 Ref: 7016-FP-13.6 Notice of temporary hazard ahead - Road Ahead Closed	

Chapter 8 details:

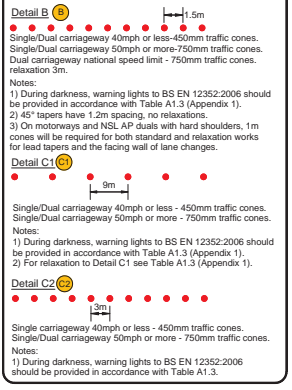

Rev	Date	Comments	By	Chk

Balfour Beatty
Living Places
Working in Partnership with
traffix

total traffic & event management solutions
Old Arden Brickworks | Bickenhill | Solihull West Midlands | B92 0DY
t: +44 (0)850 819 9001 | f: +44 (0)1875 442507
info@traffix.com | www.traffix.com

Project title:		
Traffic Management		
Drawing title:		
Proposed Road Closure St Peters Lane Bickenhill, Solihull B92 0ED		
Date:	Scale:	Paper:
17/01/2025	NTS	A2
Drawn:	Checked:	Approved:
BN	MB	MB
Project Number:	Drawing Number:	Revision:
TFX MB1162	001	-

This drawing is copyright & the property of Traffix & must not be copied in whole or in part without their written permission. Copyright is reserved. © This drawing must not be scaled.
The Contractor is to report all discrepancies & errors to the Contract Manager prior to works commencing.