

HS2 FORM TM1

Highway Authority	Highways England
Street(s)/USRN(s)	A446/Biddles Loop REV2
HS2 Consent Reference	THW.AN.HE.LMJV.376
Contractor document reference	
Submission Date (to Highway Authority)	23/12/2019
Proposed start date of works	03/02/2020
Proposed end date of works	13/03/2020
Consultation end/ requested response date	13/01/2020
Deemed consent date (if required)	20/01/2020

Temporary Interference with the Highway

In accordance with the powers set out in the **High Speed Rail (London - West Midlands) Act 2017**, the Contractor, acting on behalf of and, as agent for the Nominated Undertaker, hereby consults the highway authority and/or requests highway authority consent under Schedule 2, 4 and/or 33 as identified below:

Consultation with the highway authority:	
The temporary interference / works is on a street or location that <u>is listed</u> in Table 3 of Schedule 4 to the Act (Schedule 4 Part 2 paragraph 6)	<input type="checkbox"/>
Consent of the highway authority:	
The temporary interference / works is on a street or location <u>not listed</u> in Table 3 of Schedule 4 of the Act (Schedule 4 Part 2 paragraph 6)	<input checked="" type="checkbox"/>
Trial holes (Schedule 2 only)	<input type="checkbox"/>
Protective provisions (Schedule 33) [mark as appropriate]	
Works to a bridge requiring temporary interference, (Schedule 33 para 6)	<input type="checkbox"/>
Alteration/disturbance to apparatus of the highway authority affixed to or placed under any highway or, access to the apparatus of the Highway Authority, (Schedule 33 Para 9)	<input type="checkbox"/>
Depositing soil or materials or storing plant on the highway (Schedule 33 Para 12)	<input type="checkbox"/>
Erection of scaffolding or screening (or hoarding) in the highway (Schedule 33 Para 12)	<input type="checkbox"/>

Error! Reference source not found.

Schedule 4 Part 2 paragraph 6 – Temporary Interference

Schedule 33 Part 1, Schedule 2 Part 1

Form TM 1 - PH1-HS2-CL-TEM-000-000001 [Revision Po4]



Table 1. High level summary <i>(mark as appropriate)</i>	Alteration to apparatus of the highway authority	<input type="checkbox"/>	Deposit of material on the highway	<input type="checkbox"/>	Footway Works only	<input type="checkbox"/>	Peak hours	<input type="checkbox"/>	Works to PRow	<input type="checkbox"/>	Give and Take	<input type="checkbox"/>	Contra - flow	<input type="checkbox"/>	Lane Closure	<input checked="" type="checkbox"/>	Portable temporary traffic signals <i>(delete as required)</i>	<input type="checkbox"/>	Priority working	<input type="checkbox"/>	Narrowing of Lane	<input type="checkbox"/>
	Trial holes	<input type="checkbox"/>	Erection of scaffolding/ hoarding	<input type="checkbox"/>	Works in the carriageway	<input type="checkbox"/>	Off Peak	<input checked="" type="checkbox"/>	Street works (NRSWA)	<input type="checkbox"/>	Stop / Go	<input type="checkbox"/>	Signage only	<input checked="" type="checkbox"/>	Road Closure	<input type="checkbox"/>	Works to existing or new traffic signals infrastructure	<input type="checkbox"/>	Associated utility works	<input type="checkbox"/>	Other.	<input type="checkbox"/>

Table 2. Detailed works description, traffic management phasing and intended programme

Row No.	Road name	Extent of Temporary Interference	Consent or Consultation	USRN	Grid Ref	EToN reference	TM Phase	TM drawing reference	Description of works	Description of associated traffic management	TM operational hours	Proposed Works Start Date	Estimated Works End Date
1.	Biddles Loop/A446	M6J4 island to A452	Consent	28400839	SP200864 to SP205842	N/A	Phase 1	4001	Vegetation clearance	Lane 2 closure on Biddles Loop SB Lane 1 closure on Biddles Loop NB Lane 1 closure A446 NB/SB Associated signage	0930-1530	03/02/2020	13/03/2020
2.	Biddles Loop/A446	M6J4 island to 100m south of Biddles Loop bridge	Consent	28400839	SP200864 to SP201853	N/A	Phase 2	4002	Vegetation clearance	Lane 1 closure Biddles Loop SB Lane 1 closure A446 SB Associated signage	0930-1530	03/02/2020	13/03/2020
3.	A446	M6J4 island to A452	Consent	28400839	SP200864 to SP205842	N/A	Phase 3	4003	Vegetation clearance	Lane 1 closure A446 SB Lane 2 closure A446 NB Associated signage	0930-1530	03/02/2020	13/03/2020
4.	Biddles Loop/A446	Biddles Loop/A446 filter to A452	Consent	28400839	SP201855 to SP205842	N/A	Phase 4	4004	Vegetation clearance	Lane 1 closure Biddles Loop NB Lane 1 closure A446 NB Associated signage	0930-1530	03/02/2020	13/03/2020
5.	Biddles Loop/A446	M6J4 island to A452	Consent	28400839	SP200864 to SP205842	N/A	Phase 5	HMW(TM)-C2440-2502	Vegetation clearance	Lane 2 closure on Biddles Loop SB Associated signage	0930-1530	03/02/2020	13/03/2020

Note: These phases will not run at the same time, changes to TM will be made based on on site progress

Error! Reference source not found.

Schedule 4 Part 2 paragraph 6 – Temporary Interference

Schedule 33 Part 1, Schedule 2 Part 1

Form TM 1 - PH1-HS2-CL-TEM-000-000001 [Revision Po4]

HS2

Details of pre-application discussions with the Highway Authority and stakeholders

Date	Details
14/11/2019	WP70 discussed in TLG's with HE present

Details of associated consents/approvals

THW.AN.SMBC.LMJV.377 – Northway Island ring management
NOMS - TBC

Document references and supporting information

Title	Phase (from Table 2)	Reference	Version
Proposed Lane closure Biddles Loop	1	TFX SC0043 4001	-
Proposed Lane closure Biddles Loop	2	TFX SC0043 4002	-
Proposed Lane closure Biddles Loop	3	TFX SC0043 4003	-
Proposed Lane closure Biddles Loop	4	TFX SC0043 4004	-
Cluster E	5	HMW(TM)-C2440-2502	-

Contractor Signature

This submission is made by the Contractor on behalf of and as agent for the Nominated Undertaker.
HS2 Ltd authorises the contractor to submit the application for consultation or, as required, consent of the highway authority
[Contractor must obtain acceptance from HS2 before submitting the form to the highway authority]

Contractor	LM-JV Cornerblock, Two Cornwall Street, Birmingham, B3 2DX
Contractor Authorised Signatory	
Contractor Site Contact Details	HS2 helpdesk – 08081 434 434

Highway Authority Response Sheet

To be completed by the Highway Authority and provided as a response to the application

HS2 Consent Reference:	
Street(s):	
Submission Date:	
Response Date:	

Local Highway Authority Response

Highway Authority:	
---------------------------	--

Decision on the application by the highway authority, if consent is required:

Consent granted <input type="checkbox"/>	<i>If consent withheld or consent with comments, state ground(s) below:</i>
Consent granted with comments <input type="checkbox"/>	
Consent withheld <input type="checkbox"/>	
Consultation <input type="checkbox"/>	<i>[Insert comments on consultation]</i>

Signature: _____ Date: _____

Name of highway authority's authorised representative: _____

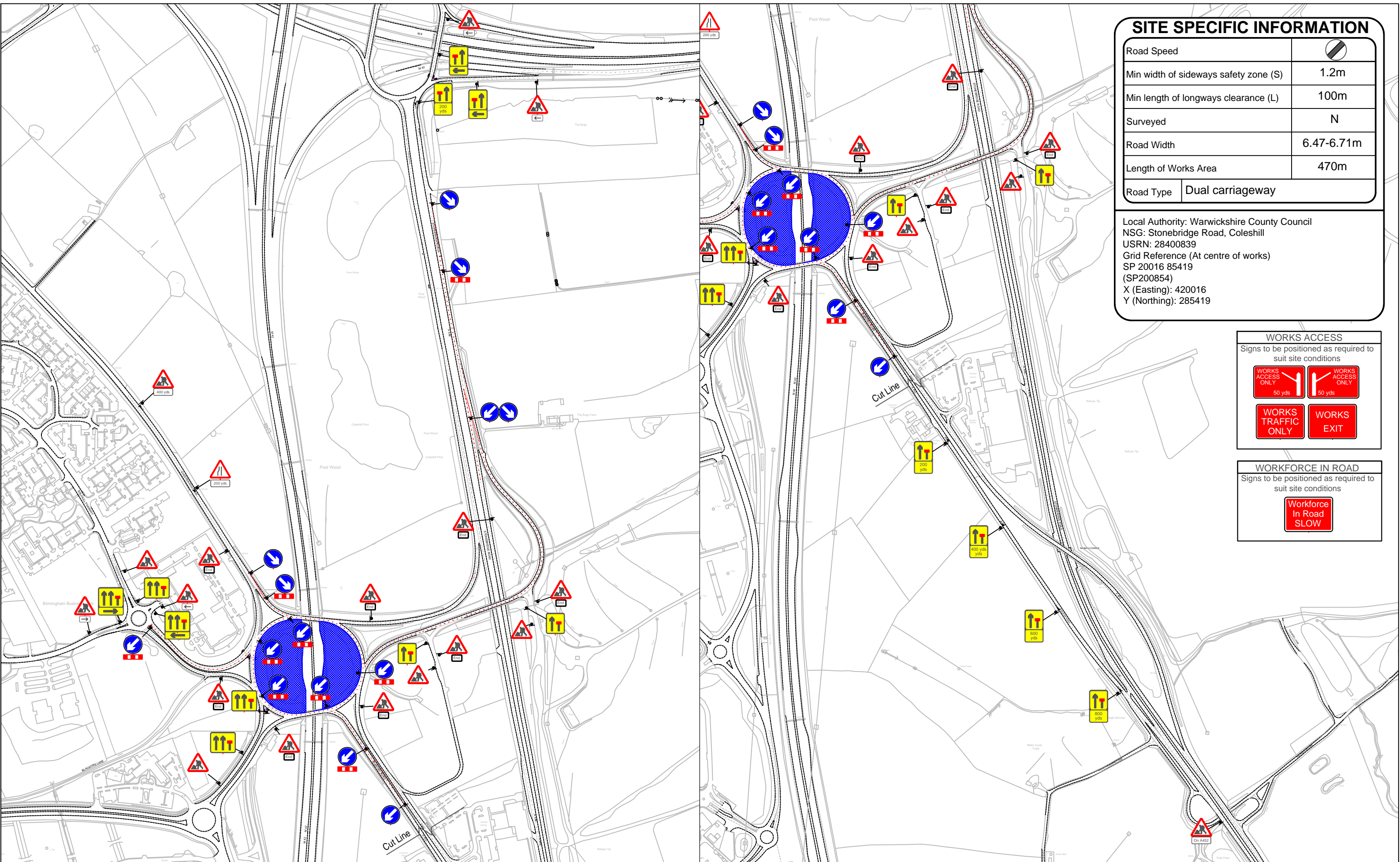

SITE SPECIFIC INFORMATION	
Road Speed	
Min width of sideways safety zone (S)	1.2m
Min length of longways clearance (L)	100m
Surveyed	N
Road Width	6.47-6.71m
Length of Works Area	470m
Road Type	Dual carriageway
Local Authority: Warwickshire County Council NSG: Stonebridge Road, Coleshill USRN: 28400839 Grid Reference (At centre of works) SP 20016 85419 (SP200854) X (Easting): 420016 Y (Northing): 285419	

WORKS ACCESS
Signs to be positioned as required to suit site conditions

WORKFORCE IN ROAD
Signs to be positioned as required to suit site conditions

OVERHEAD STRUCTURES The overhead hazard may not be visible, particularly at night. Mark the extent of the hazard with blue cones and a white sleeve.		WORKS ACCESS Signs face oncoming traffic, workers cannot see them and will be un-aware of the works access location. Place green cones with white sleeves on either side of the works access point, inside the works, not as part of the site boundary cone line		OVERHEADCABLES The overhead hazard may not be visible, particularly at night. Mark the extent of the risk zone with blue cones and a yellow sleeve, carrying an electrical hazard symbol and message.		RESTRICTION ON STOPPING IN A DECLARED ZONE WITHIN AREA OF WORKS Vehicles stopping in any part of a deceleration zone just inside the works access or on a haul route increase the risk of work vehicle collisions. Place yellow cones with white sleeves inside the works throughout the no stopping zone as a reminder for drivers.	
--	--	--	--	---	--	--	--

 HW Martin Traffic Management Fordbridge Lane Blackwell Derbyshire DE55 5JY Tel: 01773 813213 Email: traffic@hwmartin.com www.hwmartin.com	Client: 	Contractor: HW Martin Fencing	Project Title: WP70: Winter Clearance Works	Drawing Title: Cluster E - Map 20 Lane Closure Biddles Loop Solihull B37 7BF	Drawn by: C Metcalf Date: Nov-2019	Drawing No: HMW(TM)-C2440-2502
					Checked by: R Coy Date: Nov-2019	Status: <input checked="" type="checkbox"/> For Comment <input type="checkbox"/> For Issue <input type="checkbox"/> As Built
					Approved by: R Coy Date: Nov-2019	Sheet No: 1 of 1 Original size: A3
					©2019 HW Martin (Traffic Management) Ltd. This drawing may not be copied, modified or used for any other purpose other than that for which it is intended without the written permission of HW Martin (Traffic Management) Ltd.	HE Pin: N/A Scale: NTS
Rev No	Details	Date				