

HS2 FORM TM1

Highway Authority	Solihull Metropolitan Borough Council
Street(s)/USRN(s)	A452 Kenilworth Road 35010030
HS2 Consent Reference	THW.AN.LMJV.SMBC.355 REV 2
Contractor document reference	TBC
Submission Date (to Highway Authority)	10/12/2019
Proposed start date of works	12/01/2020
Proposed end date of works	12/10/2020
Consultation end/ requested response date	20/12/2019
Deemed consent date (if required)	07/01/2020

Temporary Interference with the Highway

In accordance with the powers set out in the **High Speed Rail (London - West Midlands) Act 2017**, the Contractor, acting on behalf of and, as agent for the Nominated Undertaker, hereby consults the highway authority and/or requests highway authority consent under Schedule 2, 4 and/or 33 as identified below:

Consultation with the highway authority:	
The temporary interference / works is on a street or location that is listed in Table 3 of Schedule 4 to the Act (Schedule 4 Part 2 paragraph 6)	<input checked="" type="checkbox"/>
Consent of the highway authority:	
The temporary interference / works is on a street or location not listed in Table 3 of Schedule 4 of the Act (Schedule 4 Part 2 paragraph 6)	<input checked="" type="checkbox"/>
Trial holes (Schedule 2 only)	<input type="checkbox"/>
Protective provisions (Schedule 33) [mark as appropriate]	
Works to a bridge requiring temporary interference, (Schedule 33 para 6)	<input type="checkbox"/>
Alteration/disturbance to apparatus of the highway authority affixed to or placed under any highway or, access to the apparatus of the Highway Authority, (Schedule 33 Para 9)	<input type="checkbox"/>
Depositing soil or materials or storing plant on the highway (Schedule 33 Para 12)	<input type="checkbox"/>
Erection of scaffolding or screening (or hoarding) in the highway (Schedule 33 Para 12)	<input type="checkbox"/>

Table 1. High level summary <i>(mark as appropriate)</i>	Alteration to apparatus of the highway authority	<input type="checkbox"/>	Deposit of material on the highway	<input type="checkbox"/>	Footway Works only	<input type="checkbox"/>	Peak hours	<input checked="" type="checkbox"/>	Works to PRow	<input type="checkbox"/>	Give and Take	<input type="checkbox"/>	Contra - flow	<input type="checkbox"/>	Lane Closure	<input checked="" type="checkbox"/>	Portable temporary traffic signals (<i>delete as required</i>)	<input type="checkbox"/>	Priority working	<input type="checkbox"/>	Narrowing of Lane	<input type="checkbox"/>
	Trial holes	<input type="checkbox"/>	Erection of scaffolding/hoarding	<input type="checkbox"/>	Works in the carriageway	<input type="checkbox"/>	Off Peak	<input checked="" type="checkbox"/>	Street works (NRSWA)	<input type="checkbox"/>	Stop / Go	<input type="checkbox"/>	Signage only	<input checked="" type="checkbox"/>	Road Closure	<input type="checkbox"/>	Works to existing or new traffic signals infrastructure	<input type="checkbox"/>	Associated utility works	<input checked="" type="checkbox"/>	Other: Layby closure	<input checked="" type="checkbox"/>

Table 2. Detailed works description, traffic management phasing and intended programme

Row No.	Road name	Extent of Temporary Interference	Consent or Consultation	USRN	Grid Ref	ETo N reference	TM Phase	TM drawing reference	Description of works	Description of associated traffic management	TM operational hours	Proposed Works Start Date	Estimated Works End Date
1.	A452 NB	200m north of Mercote Hall Lane (AKA Dale Road) to Bradnocks Marsh Island (AKA Aston Martin Island)	Consent	35010030	SP235780 to SP222794	N/A	1	602-1 602-2	NB closure to install barrier on lane 1 NB	Night time NB closure and associated diversion route	20:00 12 th - 06:00 13 th	12/01/2020	13/01/2020
2.	A452 NB	200m north of Mercote Hall Lane (AKA Dale Road) to Bradnocks Marsh Island (AKA Aston Martin Island)	Consent	35010030	SP219805 to SP224793	N/A	2	202	NB static lane closure to facilitate barrier in lane 1	NB Lane 1 closure	24/7	13/01/2020	24/02/2020
3.	A452 SB	200m north of Mercote Hall Lane (AKA Dale Road) to Bradnocks Marsh Island (AKA Aston Martin Island)	Consent	35010030	SP235780 to SP222794	N/A	3	601-1 601-2	SB closure to install barrier on lane 1 SB	Night time SB closure and associated diversion route	20:00 13 th - 06:00 14 th	13/01/2020	14/01/2020
4.	A452 SB	200m north of Mercote Hall Lane (AKA Dale Road) to Bradnocks Marsh Island (AKA Aston Martin Island)	Consent	35010030	SP219805 to SP224793	N/A	4	202	SB static lane closure to facilitate barrier in lane 1	SB Lane 1 closure	24/7	14/01/2020	10/02/2020
5.	A452 SB	200m north of Mercote Hall Lane (AKA Dale Road) to Bradnocks Marsh Island (AKA Aston Martin Island)	Consent	35010030	SP235780 to SP222794	N/A	5	601-1 601-2	SB closure to facilitate utility trenching	Night time SB closure and associated diversion route	20:00-06:00	03/02/2020	10/02/2020
6.	A452 NB	200m north of Mercote Hall Lane (AKA Dale Road) to Bradnocks	Consent	35010030	SP235780 to SP222794	N/A	6	602-1 602-2	NB closure to facilitate utility trenching	Night time NB closure and associated diversion route	20:00 12 th - 06:00 13 th	17/02/2020	24/02/2020

		Marsh Island (AKA Aston Martin Island)											
7.	A452 NB	200m north of Mercote Hall Lane (AKA Dale Road) to Bradnocks Marsh Island (AKA Aston Martin Island)	Consent	35010030	SP219805 to SP224793	N/A	7	301	NB static lane closure to facilitate barrier in lane 2	NB Lane 2 closure	24/7	24/02/2020	24/04/2020
8.	A452 SB	200m north of Mercote Hall Lane (AKA Dale Road) to Bradnocks Marsh Island (AKA Aston Martin Island)	Consent	35010030	SP219805 to SP224793	N/A	8	301	SB static lane closure to facilitate barrier in lane 2	SB Lane 2 closure	24/7	24/02/2020	24/04/2020
9.	A452	200m north of Mercote Hall Lane (AKA Dale Road) to Bradnocks Marsh Island (AKA Aston Martin Island)	Consent	35010030	SP235780 to SP222794	N/A	9	602-1 602-2	NB closure to install central reserve running lane	Night time NB closure and associated diversion route	20:00 27 th - 06:00 28 th	27/04/2020	28/04/2020
10.	A452	200m north of Mercote Hall Lane (AKA Dale Road) to Bradnocks Marsh Island (AKA Aston Martin Island)	Consent	35010030	SP219805 to SP224793	N/A	10	401	Central reserve running lane, single lane each direction to roundabout facilitate build	Central reserve running	24/7	28/04/2020	07/09/2020
11.	A452	200m north of Mercote Hall Lane (AKA Dale Road) to Bradnocks Marsh Island (AKA Aston Martin Island)	Consent	35010030	SP235780 to SP222794	N/A	11	602-1 602-2	NB closure to remove central reserve running lane	Night time NB closure and associated diversion route	20:00 8 th - 06:00 9 th	08/09/2020	09/09/2020
12.	A452	200m north of Mercote Hall Lane (AKA Dale Road) to Bradnocks Marsh Island (AKA Aston Martin Island)	Consent	35010030	SP219805 to SP224793	N/A	12	501	Lane 1 running SB and NB around new roundabout to facilitate build	Lane 1 running NB and SB	24/7	09/09/2020	12/10/2020
13.	A452 SB Layby	Layby opposite Manor Nurseries on the SB	Consent	35010030	SP221798	N/A	1a	202 301 401 501	Layby closure	Layby closure	24/7	12/01/2020	12/10/2020
14.	A452	Barncroft to Stonebridge House	Consent	35010030	SP226792 to SP219821	N/A	13	HMW(TM)-C2440-2102	Veg clearance	NB lane 1 closure	0930-1530	03/02/2020	28/02/2020

Error! Reference source not found.

Schedule 4 Part 2 paragraph 6 – Temporary Interference

Schedule 33 Part 1, Schedule 2 Part 1

Form TM 1 - PH1-HS2-CL-TEM-000-000001 [Revision Po4]



15.	A452	Barncroft to Stonebridge House	Consent	35010030	SP226792 to SP219821	N/A	14	HMW(TM)-C2440-2103	Veg clearance	SB lane 1 closure	0930-1530	03/02/2020	28/02/2020
-----	------	--------------------------------	---------	----------	----------------------	-----	----	--------------------	---------------	-------------------	-----------	------------	------------

Error! Reference source not found.

Schedule 4 Part 2 paragraph 6 – Temporary Interference

Schedule 33 Part 1, Schedule 2 Part 1

Form TM 1 - PH1-HS2-CL-TEM-000-000001 [Revision Po4]

HS2

Details of pre-application discussions with the Highway Authority and stakeholders

Date	Details
2 nd Thursday every month	Various TLGs through the year

Details of associated consents/approvals

Park Lane closure sch4 – THW.AN.LMJV.SMBC.0242
WCC diversion sch4 – THW.AN.LMJV.WCC.356
HE diversion sch4 – THW.AN.LMJV.HE.357

Document references and supporting information

Title	Phase (from Table 2)	Reference	Version
TFXSC0030 202	2,4,1a		A
TFXSC0030 301	7,8,1a		A
TFXSC0030 401	10,1a		B
TFXSC0030 501	12,1a		-
TFXSC0030 601-1	3,5		A
TFXSC0030 601-2	3,5		A
TFXSC0030 602-1	1,6,9		A
TFXSC0030 602-2	1,6,11		A
HMW(TM)-C2440-2102	13		-
HMW(TM)-C2440-2103	14		-

Contractor Signature

This submission is made by the Contractor on behalf of and as agent for the Nominated Undertaker.
HS2 Ltd authorises the contractor to submit the application for consultation or, as required, consent of the highway authority
[Contractor must obtain acceptance from HS2 before submitting the form to the highway authority]

Contractor	LM-JV Cornerblock, Two Cornwall Street, Birmingham, B3 2DX
Contractor Authorised Signatory	
Contractor Site Contact Details	HS2 Helpdesk – 08081 434 434

Highway Authority Response Sheet

To be completed by the Highway Authority and provided as a response to the application

HS2 Consent Reference:	
Street(s):	
Submission Date:	
Response Date:	

Local Highway Authority Response

Highway Authority:	
---------------------------	--

Decision on the application by the highway authority, if consent is required:

Consent granted <input type="checkbox"/>	<i>If consent withheld or consent with comments, state ground(s) below:</i>
Consent granted with comments <input type="checkbox"/>	
Consent withheld <input type="checkbox"/>	
Consultation <input type="checkbox"/>	<i>[Insert comments on consultation]</i>

Signature: _____ Date: _____

Name of highway authority's authorised representative: _____

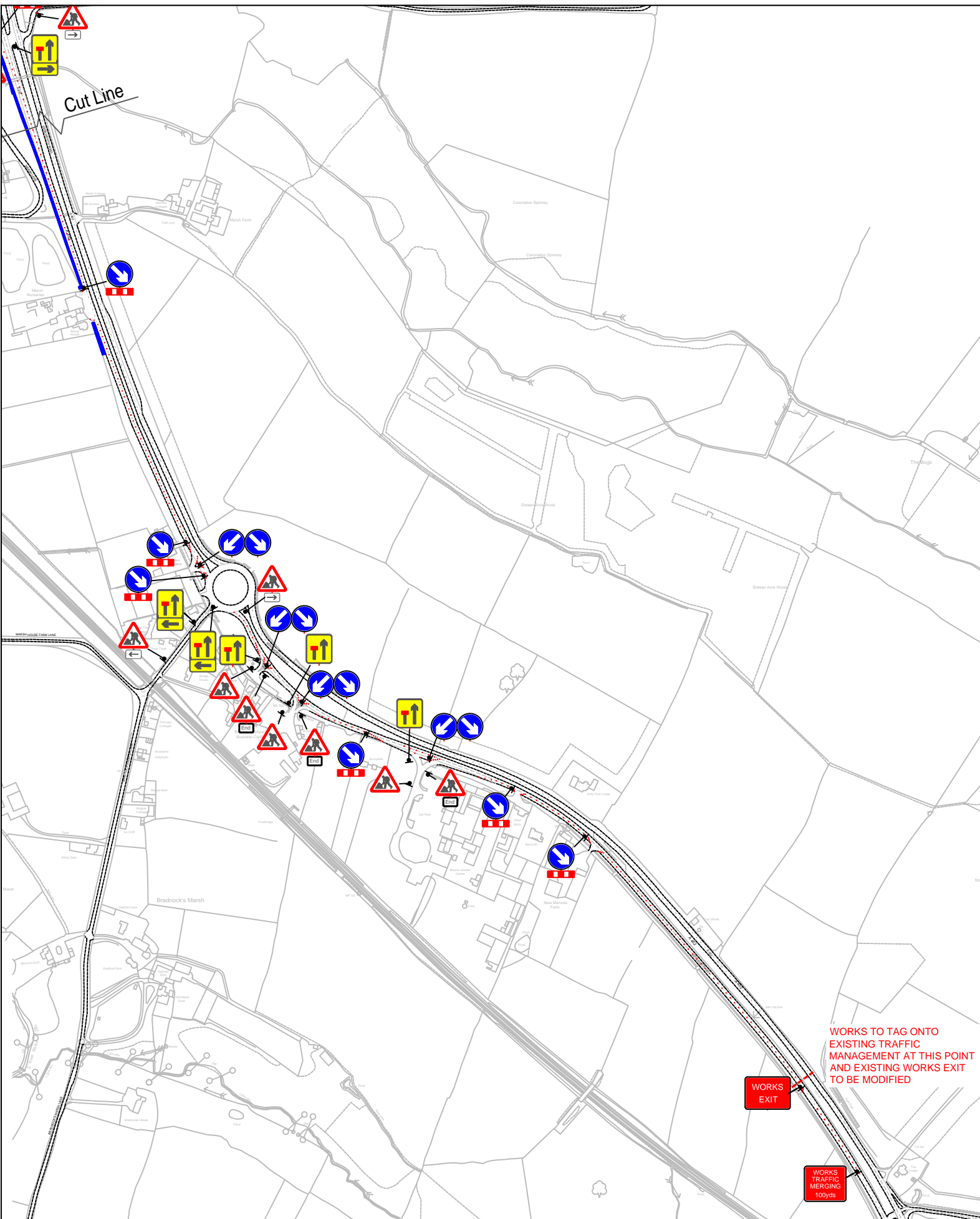

SITE SPECIFIC INFORMATION	
Road Speed	50
Min width of sideways safety zone (S)	1.2m
Min length of longways clearance (L)	100m
Surveyed	N
Road Width	7.17-7.64m
Length of Works Area	1900m
Road Type	Dual carriageway
Local Authority: Solihull Metropolitan Council NSG: Kenilworth Road, Balsall Common, Solihull USRN: 35010030 Grid Reference (At centre of works) SP 21973 80853 (SP219808) X (Easting): 421973 Y (Northing): 280853	

WORKS ACCESS
Signs to be positioned as required to suit site conditions

WORKFORCE IN ROAD
Signs to be positioned as required to suit site conditions

CONTRACTOR TO LIASE ON SITE WITH THE TSCO FOR EXISTING WORKS AND ANY CONFLICTING SIGNAGE TO BE STOOD DOWN ACCORDINGLY

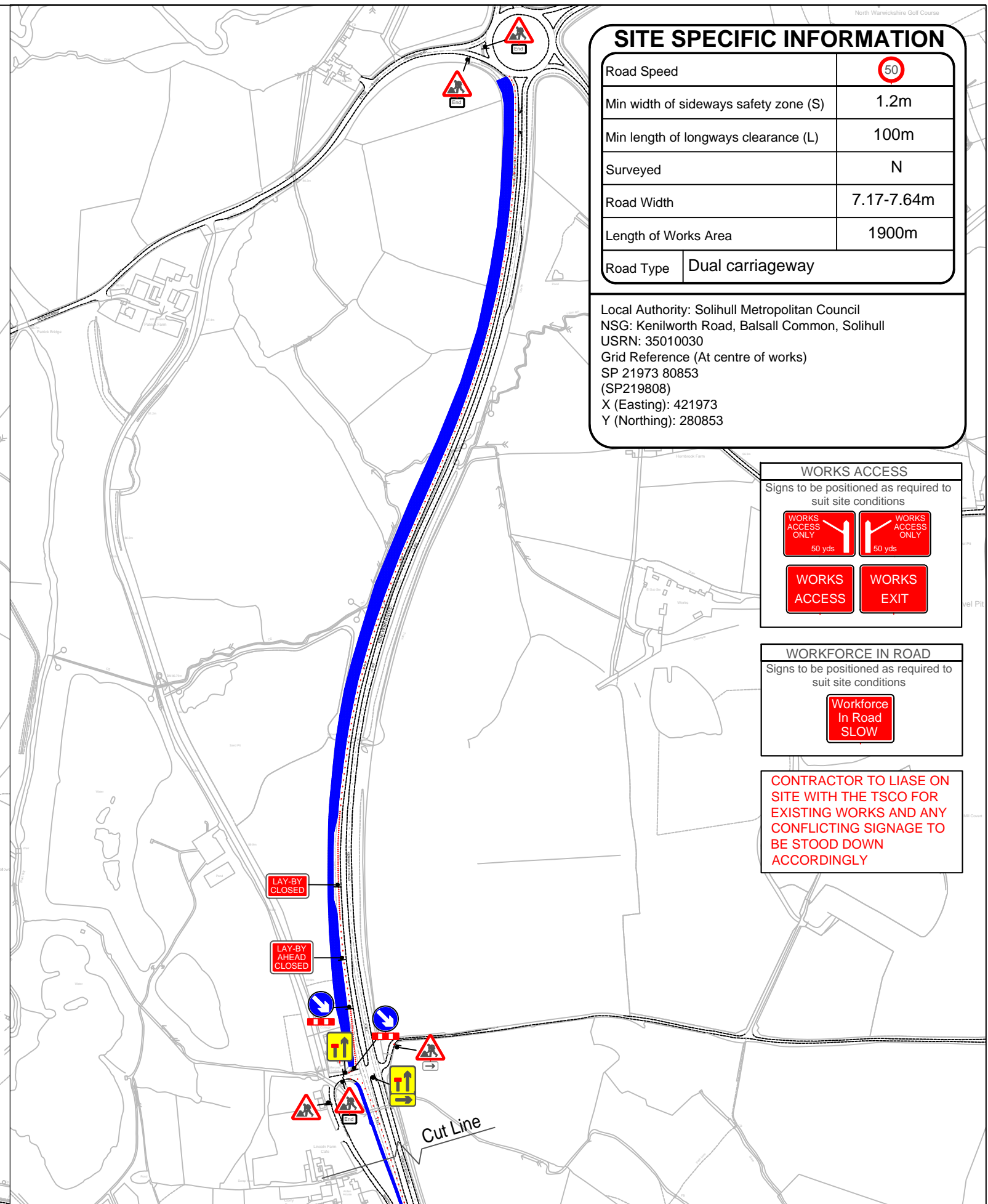

WORKS TO TAG ONTO EXISTING TRAFFIC MANAGEMENT AT THIS POINT AND EXISTING WORKS EXIT TO BE MODIFIED

WORKS EXIT

WORKS TRAFFIC MERGING 100yds

OVERHEAD STRUCTURES The overhead hazard may not be visible, particularly at night. Mark the extent of the hazard with blue cones and a white sleeve.	WORKS ACCESS Signs face oncoming traffic, workers cannot see them and will be un-aware of the works access location. Place green cones with white sleeves on either side of the works access point, inside the works, not as part of the site boundary cone line	OVERHEADCABLES The overhead hazard may not be visible, particularly at night. Mark the extent of the risk zone with blue cones and a yellow sleeve, carrying an electrical hazard symbol and message.	RESTRICTION ON STOPPING IN A DECLARED ZONE WITHIN AREA OF WORKS Vehicles stopping in any part of a deceleration zone just inside the works access or on a haul route increase the risk of work vehicle collisions. Place yellow cones with white sleeves inside the works throughout the no stopping zone as a reminder for drivers.
---	---	--	---

<p>HW Martin Traffic Management Fordbridge Lane Blackwell Derbyshire DE55 5JY Tel: 01773 813213 Email: traffic@hwmartin.com www.hwmartin.com</p>	<p>Client:</p>	<p>Contractor:</p> <p>HW Martin Fencing</p>	<p>Project Title:</p> <p>WP70: Winter Clearance Works</p>	<p>Drawing Title:</p> <p>Cluster H - Map 15 Lane Closure Kenilworth Road Berkswell CV7 7BP</p>	<p>Drawn by: C Metcalf</p>	<p>Date: Nov-2019</p>	<p>Drawing No:</p> <p>HMW(TM)-C2440-2102</p>		
					<p>Checked by: R Coy</p>	<p>Date: Nov-2019</p>		<p>Status: <input checked="" type="checkbox"/> For Comment <input type="checkbox"/> For Issue <input type="checkbox"/> As Built</p>	
<p>Approved by: R Coy</p>					<p>Date: Nov-2019</p>	<p>Sheet No: 1 of 1</p>			
<p>©2019 HW Martin (Traffic Management) Ltd. This drawing may not be copied, modified or used for any other purpose other than that for which it is intended without the written permission of HW Martin (Traffic Management) Ltd.</p>					<p>A</p>	<p>TM Revised to suit existing works on site</p>	<p>20-01-2020</p>	<p>HE Pin: N/A</p>	
					<p>Rev No</p>	<p>Details</p>	<p>Date</p>	<p>Original size: A3</p>	<p>Scale: NTS</p>

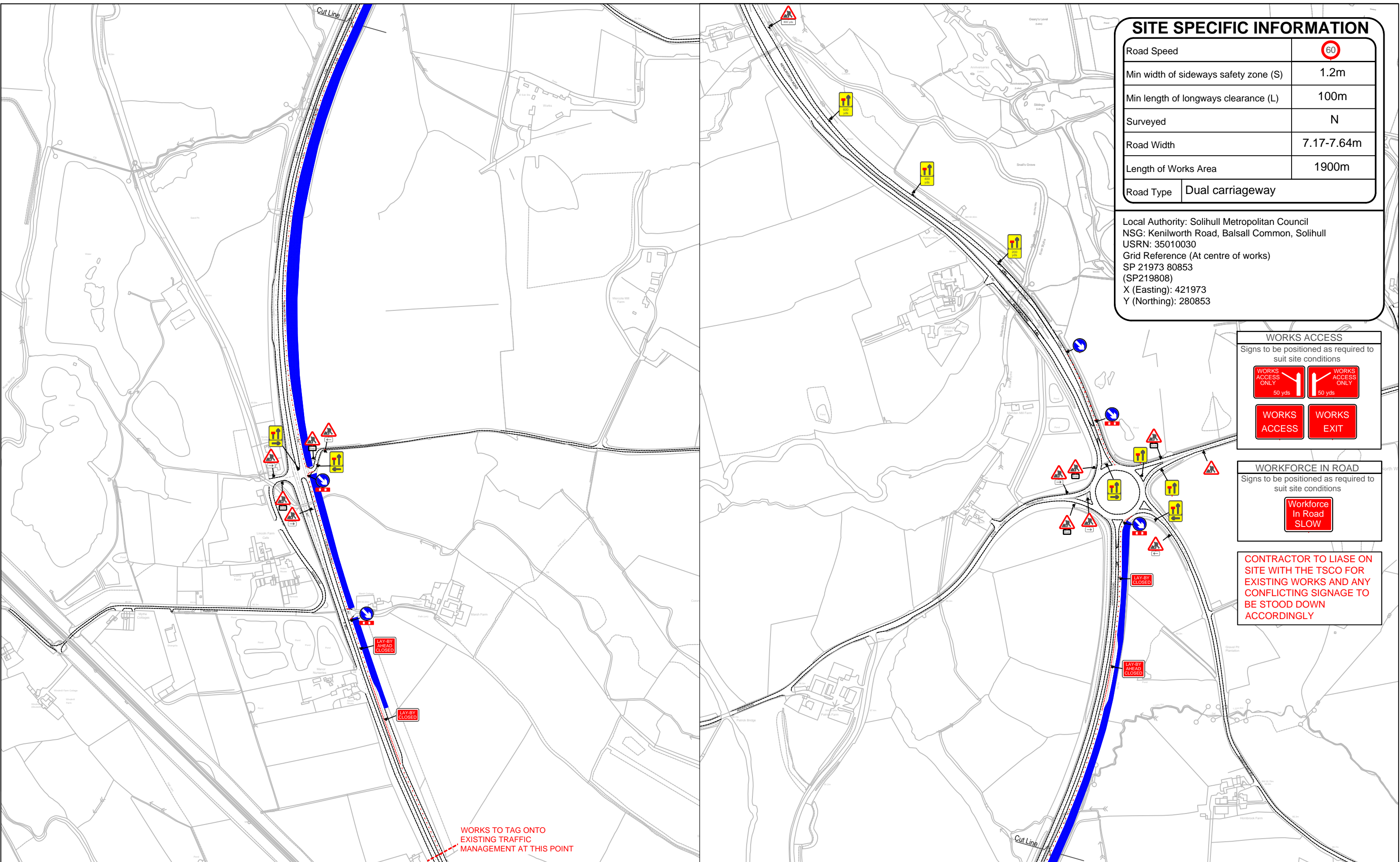

SITE SPECIFIC INFORMATION	
Road Speed	60
Min width of sideways safety zone (S)	1.2m
Min length of longways clearance (L)	100m
Surveyed	N
Road Width	7.17-7.64m
Length of Works Area	1900m
Road Type	Dual carriageway
Local Authority: Solihull Metropolitan Council NSG: Kenilworth Road, Balsall Common, Solihull USRN: 35010030 Grid Reference (At centre of works) SP 21973 80853 (SP219808) X (Easting): 421973 Y (Northing): 280853	

WORKS ACCESS
Signs to be positioned as required to suit site conditions

WORKFORCE IN ROAD
Signs to be positioned as required to suit site conditions

CONTRACTOR TO LIASE ON SITE WITH THE TSCO FOR EXISTING WORKS AND ANY CONFLICTING SIGNAGE TO BE STOOD DOWN ACCORDINGLY

WORKS TO TAG ONTO EXISTING TRAFFIC MANAGEMENT AT THIS POINT

OVERHEAD STRUCTURES	The overhead hazard may not be visible, particularly at night. Mark the extent of the hazard with blue cones and a white sleeve.		WORKS ACCESS	Signs face oncoming traffic, workers cannot see them and will be un-aware of the works access location. Place green cones with white sleeves on either side of the works access point, inside the works, not as part of the site boundary cone line		OVERHEADCABLES	The overhead hazard may not be visible, particularly at night. Mark the extent of the risk zone with blue cones and a yellow sleeve, carrying an electrical hazard symbol and message.		RESTRICTION ON STOPPING IN A DECLARED ZONE WITHIN AREA OF WORKS	Vehicles stopping in any part of a deceleration zone just inside the works access or on a haul route increase the risk of work vehicle collisions. Place yellow cones with white sleeves inside the works throughout the no stopping zone as a reminder for drivers.	
----------------------------	--	--	---------------------	---	--	-----------------------	--	--	--	--	--

 HW Martin Traffic Management Fordbridge Lane Blackwell Derbyshire DE55 5JY Tel: 01773 813213 Email: traffic@hwmartin.com www.hwmartin.com	Client: 	Contractor: HW Martin Fencing	Project Title: WP70: Winter Clearance Works	Drawing Title: Cluster H - Map 15 Lane Closure Kenilworth Road Berkswell CV7 7BP	Drawn by: C Metcalf Date: Nov-2019	Drawing No: HMW(TM)-C2440-2103
					Checked by: R Coy Date: Nov-2019	Status: <input checked="" type="checkbox"/> For Comment <input type="checkbox"/> For Issue <input type="checkbox"/> As Built
Approved by: R Coy Date: Nov-2019					©2019 HW Martin (Traffic Management) Ltd. This drawing may not be copied, modified or used for any other purpose other than that for which it is intended without the written permission of HW Martin (Traffic Management) Ltd.	Sheet No: 1 of 1 Original size: A3
Rev No: A Details		Date: 13-01-2020 TM Revised to suit existing works on site		Date:		HE Pin: N/A Scale: NTS