

HS2 FORM TM1

Highway Authority	Solihull Metropolitan Borough Council
Street(s)/USRN(s)	Waste Lane, Hob Lane, A452 Kenilworth Road
HS2 Consent Reference	THW.AN.SMBC.LMJV.0082
HS2 Ltd document reference (version)	1EW04-LMJ-HW-SCH-N001-106000 C03
Submission Date	30/10/2018
Proposed start date of works	26/11/2018
Consultation end date <i>[mark as appropriate]</i>	25/11/2018
Deemed consent date <i>[mark as appropriate]</i>	Click here to enter a date.

Temporary Highway Interference

In accordance with the powers set out in the High-Speed Rail (London - West Midlands) Act 2017, the Nominated Undertaker hereby consults the highway authority and/or requests highway authority consent under Schedule 2, 4 and/or 33 as identified below:

Consultation with the highway authority:	
The temporary interference/works is on a street or location listed in Table 3 of Schedule 4 to the Act	<input checked="" type="checkbox"/>
Consent of the highway authority:	
The temporary interference/works is at a location, not listed in Table 3 of Schedule 4 of the Act	<input type="checkbox"/>
Trial holes (Schedule 2 only)	<input type="checkbox"/>
Protective provisions (Schedule 33) <i>[mark as appropriate]</i>	<input type="checkbox"/>
Works to a bridge requiring temporary interference, (Schedule 33 para 6)	<input type="checkbox"/>
Alteration/disturbance to apparatus of the highway authority affixed to or placed under any highway. or, access to the apparatus of the Highway Authority, (Schedule 33 Para 9)	<input type="checkbox"/>
Depositing soil or materials or storing plant on the highway (Schedule 33 Para 12)	<input type="checkbox"/>
Erection of scaffolding or screening (or hoarding) in the highway (Schedule 33 Para 12)	<input type="checkbox"/>

Table 1. Summary <i>(mark as appropriate)</i>	Alteration to apparatus of the highway authority	<input type="checkbox"/>	Deposit of material on the highway	<input type="checkbox"/>	Footway Works only	<input type="checkbox"/>	Peak hours	<input type="checkbox"/>	Give and Take	<input type="checkbox"/>	Lane Closure	<input checked="" type="checkbox"/>	Portable temporary traffic signals (delete as required) 2-way multiphase	<input checked="" type="checkbox"/>	Priority working	<input type="checkbox"/>
	Trial holes	<input type="checkbox"/>	Erection of scaffolding/hoarding	<input type="checkbox"/>	Works in the carriageway	<input checked="" type="checkbox"/>	Off Peak	<input type="checkbox"/>	Stop /Go	<input type="checkbox"/>	Road Closure	<input checked="" type="checkbox"/>	Works to existing or new signal installations	<input type="checkbox"/>	Associated utility works	<input type="checkbox"/>
	Temporary signs	<input checked="" type="checkbox"/>	Verge works	<input type="checkbox"/>		<input type="checkbox"/>		<input type="checkbox"/>		<input type="checkbox"/>		<input type="checkbox"/>		<input type="checkbox"/>		<input type="checkbox"/>

Road name	Extent of Temporary Interference	USRN	Grid Ref	EToN reference	TM Phase	TM drawing reference	Description of works	Description of associated traffic management	TM operational hours	Proposed Start Date	Estimated End Date
Waste Lane	250m NE of Old Waste Lane	35006276	SP 25667 76593		Single Phase	9969.072 9969.047	Utility Trial Holes 07,08,09,10	Road Closure and diversion Portable Traffic Signals	24/7	26/11/2018	30/11/2018
Hob Lane	Hob, Cromwell, Red Lane Junction	35006267	SP 26809 75647		Single Phase	9969.045	Utility Trial Holes 14,16	Multi-phase Portable Traffic Signals	9.30am to 3.30pm	03/12/2018	06/12/2018
A452 Kenilworth Road	A452/Park Lane Junction	35010030	SP 23246 78621		Single Phase	9969.048 9969.049	Utility Trial Holes 29, 30, 31, 32	Lane Closure	9.30am to 3.30pm	19/11/2018	21/11/2018

Details of pre-application discussions	
Date	Details
12/07/2018	Utility Trial Hole Locations tabled at SMBC TLG
08/11/2018	Waste Lane discussed at TLG. Agreement between WS, PT & LP to change from Full Road closure to portable traffic signals
Click here to enter a date.	
Details of associated consents/approvals	
<i>{provide details as necessary}</i>	

Document references and supporting information			
Title	Phase (from Table 1)	reference	Version
Hob, Red, Cromwell Lane 3 way lights		9969.045	
Waste Lane Road Closure and Diversion		9969.072	
A452 Kenilworth Road Lane closure		9969.048	
A452 Kenilworth Road Right turn diversion		9969.049	

Contractor Signature	
This submission is made by the Contractor on behalf of the Nominated Undertaker HS2 Ltd authorises the contractor to submit the application for consultation or, as required, consent of the highway authority <i>The Contractor must obtain a Code 1 authorisation from the HS2 Area Traffic Manager before submitting this form.</i>	
Contractor	LM-JV Cornerblock, Two Cornwall Street, Birmingham, B3 2DL
Contractor Authorised Signatory	 Wayne Skells, Traffic Manager
Highway Authority Response Sheet	

HS2 Consent Reference:	
Street(s):	
Submission Date:	
Response Date:	

Local Highway Authority Response	
Highway Authority:	



- NOTES**
- All traffic signs shall comply with Chapter 8 of the Traffic Signs Manual.
 - Maximum distance between any two temporary traffic signals to be 249m. Minimum distance between any two temporary traffic signals to be 30m.
 - Temporary traffic signals shall not occur within 150m of an existing level crossing, Pelican crossing or signalised junction without the consent of the Engineer. The Engineer shall consult with the authority responsible for any of these types of facility prior to traffic management being installed in adjacent areas.
 - Coning shall be installed at 45° to the edge of carriageway, as generally indicated.
 - Cable crossing protectors and P7010/P7013 signs shall be provided whenever control cables cross a section of carriageway open to traffic.
 - The signal control mechanism shall normally be placed in a location from which it is possible to view all approaches to the site.
 - Duplicate primary signal to be installed as instructed.
 - Lane width past the works to be 3.7m maximum, 3.25m desirable minimum, 3.0m absolute minimum.



To be agreed on site

KEY

- Work area
- Cone
- Sign
- Safety zone
- Traffic light head
- Work space

DETAIL B

- Single/Dual carriageway 40mph or less - 400mm traffic cones, spacing 1.5m.
- Single/Dual carriageway 50mph or more - 750mm traffic cones, spacing 1.5m.
- Dual carriageway national speed limit - 750mm traffic cones, spacing 1.5m, relaxation 3m.

- Notes:**
- During darkness, warning lights to BS EN 12352:2006 should be provided in accordance with Table A1.3 (Appendix 1).
 - 40° tapers have 1.5m spacing, no relaxations.
 - On motorways and NSL AP duals with hard shoulders, 1m cones will be required for both standard and relaxation works for lead tapers and the facing wall of lane changes.

DETAIL C2

- Single carriageway 40mph or less - 450mm traffic cones.
- Single/Dual carriageway 50mph or more - 750mm traffic cones.

- Notes:**
- During darkness, warning lights to BS EN 12352:2006 should be provided in accordance with Table A1.3.

B	Note added.	AG	JW	21.08.18
A	Hatched area added, block board removed and dimensions added.	AG	JW	20.08.18
Rev	Description	By	Chkd	Date

Revisions

Client



Project

WASTE LANE
BALSALL COMMON
GRID REF: 425645, 276586

Title

2 WAY TEMPORARY
TRAFFIC LIGHTS

WORK PACK 4B



409 Tyburn Road, Birmingham, B24 8HJ - 0121 328 7266
info@consilium-ts.co.uk - www.consilium-ts.co.uk

Design: KL	Drawn: JB	Chkd: KL
Date: 09/08/18	Date: 09/08/18	Date: 09/08/18
Scale: NTS @ A3	Status: PROPOSED	

Drawing No	9969.047	Rev:	B
------------	----------	------	---

The Cottage

Dragonflies

Maple

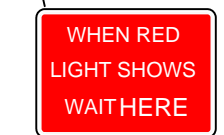
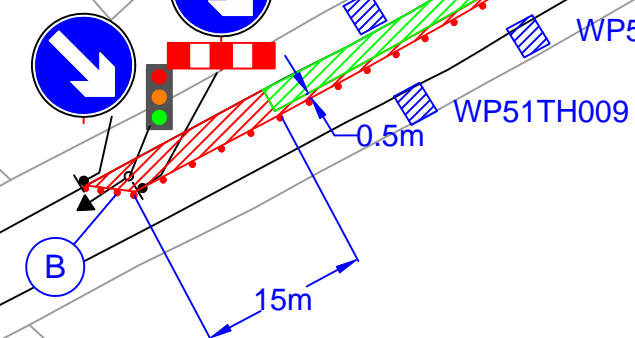
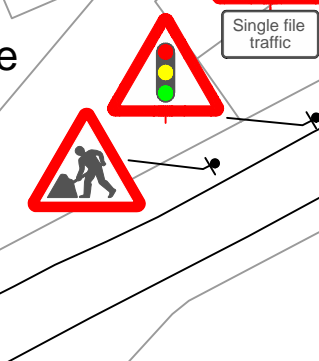

NOTE
Closure to be switched to suit ongoing works.

NOTE
Minimum 3m running lane to be maintained at all times.

WP51TH006

WP51TH008

WP51TH007

WP51TH010

WP51TH009

0.5m

15m



For exact location download the Highways Toolbox from App store.



Longacre

High Close

HS2 FORM TM1

Highway Authority	Solihull Metropolitan Borough Council
Street(s)/USRN(s)	Waste Lane, Hob Lane, A452 Kenilworth Road
HS2 Consent Reference	THW.AN.SMBC.LMJV.0082
HS2 Ltd document reference (version)	1EW04-LMJ-HW-SCH-N001-106000 C03
Submission Date	30/10/2018
Proposed start date of works	26/11/2018
Consultation end date <i>[mark as appropriate]</i>	25/11/2018
Deemed consent date <i>[mark as appropriate]</i>	Click here to enter a date.

Temporary Highway Interference

In accordance with the powers set out in the High-Speed Rail (London - West Midlands) Act 2017, the Nominated Undertaker hereby consults the highway authority and/or requests highway authority consent under Schedule 2, 4 and/or 33 as identified below:

Consultation with the highway authority:	
The temporary interference/works is on a street or location listed in Table 3 of Schedule 4 to the Act	<input checked="" type="checkbox"/>
Consent of the highway authority:	
The temporary interference/works is at a location, not listed in Table 3 of Schedule 4 of the Act	<input type="checkbox"/>
Trial holes (Schedule 2 only)	<input type="checkbox"/>
Protective provisions (Schedule 33) <i>[mark as appropriate]</i>	<input type="checkbox"/>
Works to a bridge requiring temporary interference, (Schedule 33 para 6)	<input type="checkbox"/>
Alteration/disturbance to apparatus of the highway authority affixed to or placed under any highway. or, access to the apparatus of the Highway Authority, (Schedule 33 Para 9)	<input type="checkbox"/>
Depositing soil or materials or storing plant on the highway (Schedule 33 Para 12)	<input type="checkbox"/>
Erection of scaffolding or screening (or hoarding) in the highway (Schedule 33 Para 12)	<input type="checkbox"/>

Table 1. Summary (mark as appropriate)										
Alteration to apparatus of the highway authority	Deposit of material on the highway	Footway Works only	Peak hours	Give and Take	Lane Closure	Portable temporary traffic signals (delete as required)	Priority working	2-way multiphase	Works to existing or new signal installations	Associated utility works
<input type="checkbox"/>	<input type="checkbox"/>	<input type="checkbox"/>	<input type="checkbox"/>	<input type="checkbox"/>	<input type="checkbox"/>	<input type="checkbox"/>	<input type="checkbox"/>	<input checked="" type="checkbox"/>	<input type="checkbox"/>	<input type="checkbox"/>
Trial holes	Erection of scaffolding/hoarding	Works in the carriageway	Off Peak	Stop/Go	Road Closure					
Temporary signs	Verge works									

Road name	Extent of Temporary Interference	USRN	Grid Ref	EToN reference	TM Phase	TM drawing reference	Description of works	Description of associated traffic management	TM operational hours	Proposed Start Date	Estimated End Date
Waste Lane	250m NE of Old Waste Lane	35006276	SP 25667 76593		Single Phase	9969.072 9969.047	Utility Trial Holes 07,08,09,10	Read Closure and diversion Portable Traffic Signals	24/7	26/11/2018	30/11/2018
Hob Lane	Hob, Cromwell, Red Lane Junction	35006267	SP 26809 75647		Single Phase	9969.045	Utility Trial Holes 14,16	Multi-phase Portable Traffic Signals	9:30am to 3:30pm	03/12/2018	06/12/2018
A452 Kenilworth Road	A452/Park Lane Junction	35010030	SP 23246 78621		Single Phase	9969.048 9969.049	Utility Trial Holes 29, 30, 31, 32	Lane Closure	9:30am to 3:30pm	19/11/2018	21/11/2018

Details of pre-application discussions	
Date	Details
12/07/2018	Utility Trial Hole Locations tabled at SMBC TLG
08/11/2018	Waste Lane discussed at TLG. Agreement between WS, PT & LP to change from Full Road closure to portable traffic signals
Click here to enter a date.	
Details of associated consents/approvals	
<i>{provide details as necessary}</i>	

Document references and supporting information			
Title	Phase (from Table 1)	reference	Version
Hob, Red, Cromwell Lane 3 way lights		9969.045	
Waste Lane Road Closure and Diversion		9969.072	
A452 Kenilworth Road Lane closure		9969.048	
A452 Kenilworth Road Right turn diversion		9969.049	

Contractor Signature	
<p>This submission is made by the Contractor on behalf of the Nominated Undertaker HS2 Ltd authorises the contractor to submit the application for consultation or, as required, consent of the highway authority <i>The Contractor must obtain a Code 1 authorisation from the HS2 Area Traffic Manager before submitting this form.</i></p>	
Contractor	LM-JV Cornerblock, Two Cornwall Street, Birmingham, B3 2DL
Contractor Authorised Signatory	 Wayne Skells, Traffic Manager
Highway Authority Response Sheet	

HS2 Consent Reference:	
Street(s):	
Submission Date:	
Response Date:	

Local Highway Authority Response	
Highway Authority:	

Decision on the application by the highway authority, if consent is required:	
Consent <input type="checkbox"/>	If consent withheld or consent with comments, state ground(s) below:
Consent with comments <input type="checkbox"/>	
Consent withheld <input type="checkbox"/>	
Consultation <input checked="" type="checkbox"/>	<i>[Insert comments on consultation]</i>
Signature: <u></u> Date: <u>23.11.18</u>	
Name of highway authority's authorised representative: <u>LISA PARRY</u>	

HS2 FORM TM1

Highway Authority	Solihull Metropolitan Borough Council
Street(s)/USRN(s)	Waste Lane, Hob Lane, A452 Kenilworth Road
HS2 Consent Reference	THW.AN.SMBC.LMJV.0082
HS2 Ltd document reference (version)	1EW04-LMJ-HW-SCH-N001-106000 Co4
Submission Date	30/10/2018
Proposed start date of works	26/11/2018
Consultation end date <i>[mark as appropriate]</i>	25/11/2018
Deemed consent date <i>[mark as appropriate]</i>	Click here to enter a date.

Temporary Highway Interference

In accordance with the powers set out in the High-Speed Rail (London - West Midlands) Act 2017, the Nominated Undertaker hereby consults the highway authority and/or requests highway authority consent under Schedule 2, 4 and/or 33 as identified below:

Consultation with the highway authority:	
The temporary interference/works is on a street or location listed in Table 3 of Schedule 4 to the Act	<input checked="" type="checkbox"/>
Consent of the highway authority:	
The temporary interference/works is at a location, not listed in Table 3 of Schedule 4 of the Act	<input type="checkbox"/>
Trial holes (Schedule 2 only)	<input type="checkbox"/>
Protective provisions (Schedule 33) <i>[mark as appropriate]</i>	<input type="checkbox"/>
Works to a bridge requiring temporary interference, (Schedule 33 para 6)	<input type="checkbox"/>
Alteration/disturbance to apparatus of the highway authority affixed to or placed under any highway. or, access to the apparatus of the Highway Authority, (Schedule 33 Para 9)	<input type="checkbox"/>
Depositing soil or materials or storing plant on the highway (Schedule 33 Para 12)	<input type="checkbox"/>
Erection of scaffolding or screening (or hoarding) in the highway (Schedule 33 Para 12)	<input type="checkbox"/>

Table 1. Summary <i>(mark as appropriate)</i>	Alteration to apparatus of the highway authority	<input type="checkbox"/>	Deposit of material on the highway	<input type="checkbox"/>	Footway Works only	<input type="checkbox"/>	Peak hours	<input type="checkbox"/>	Give and Take	<input type="checkbox"/>	Lane Closure	<input checked="" type="checkbox"/>	Portable temporary traffic signals (delete as required) 2-way multiphase	<input checked="" type="checkbox"/>	Priority working	<input type="checkbox"/>
	Trial holes	<input type="checkbox"/>	Erection of scaffolding/hoarding	<input type="checkbox"/>	Works in the carriageway	<input checked="" type="checkbox"/>	Off Peak	<input type="checkbox"/>	Stop /Go	<input type="checkbox"/>	Road Closure	<input checked="" type="checkbox"/>	Works to existing or new signal installations	<input type="checkbox"/>	Associated utility works	<input type="checkbox"/>
	Temporary signs	<input checked="" type="checkbox"/>	Verge works	<input type="checkbox"/>		<input type="checkbox"/>		<input type="checkbox"/>		<input type="checkbox"/>		<input type="checkbox"/>		<input type="checkbox"/>		<input type="checkbox"/>

Road name	Extent of Temporary Interference	USRN	Grid Ref	EToN reference	TM Phase	TM drawing reference	Description of works	Description of associated traffic management	TM operational hours	Proposed Start Date	Estimated End Date
Waste Lane	250m NE of Old Waste Lane	35006276	SP 25667 76593		Single Phase	9969.072 9969.047	Utility Trial Holes 07,08,09,10	Road Closure and diversion Portable Traffic Signals	24/7	26/11/2018	30/11/2018
Hob Lane	Hob, Cromwell, Red Lane Junction	35006267	SP 26809 75647		Single Phase	9969.045	Utility Trial Holes 14,16	Multi-phase Portable Traffic Signals, not including the weekend	9.30am to 3.00pm	13/12/2018	17/12/2018
A452 Kenilworth Road	A452/Park Lane Junction	35010030	SP 23246 78621		Single Phase	9969.048 9969.049	Utility Trial Holes 29, 30, 31, 32	Lane Closure	9.30am to 3.30pm	10/12/2018	12/12/2018

Details of pre-application discussions	
Date	Details
12/07/2018	Utility Trial Hole Locations tabled at SMBC TLG
08/11/2018	Waste Lane discussed at TLG. Agreement between WS, PT & LP to change from Full Road closure to portable traffic signals
Click here to enter a date.	
Details of associated consents/approvals	
<i>{provide details as necessary}</i>	

Document references and supporting information			
Title	Phase (from Table 1)	reference	Version
Hob, Red, Cromwell Lane 3 way lights		9969.045	
Waste Lane Road Closure and Diversion		9969.072	
A452 Kenilworth Road Lane closure		9969.048	
A452 Kenilworth Road Right turn diversion		9969.049	

Contractor Signature	
This submission is made by the Contractor on behalf of the Nominated Undertaker HS2 Ltd authorises the contractor to submit the application for consultation or, as required, consent of the highway authority <i>The Contractor must obtain a Code 1 authorisation from the HS2 Area Traffic Manager before submitting this form.</i>	
Contractor	LM-JV Cornerblock, Two Cornwall Street, Birmingham, B3 2DL
Contractor Authorised Signatory	 Wayne Skells, Traffic Manager

Highway Authority Response Sheet

HS2 Consent Reference:	
Street(s):	
Submission Date:	
Response Date:	

Local Highway Authority Response	
Highway Authority:	

Decision on the application by the highway authority, if consent is required:	
Consent <input type="checkbox"/>	If consent withheld or consent with comments, state ground(s) below:
Consent with comments <input type="checkbox"/>	
Consent withheld <input type="checkbox"/>	
Consultation <input type="checkbox"/>	<i>[Insert comments on consultation]</i>
Signature: _____ Date: _____	
Name of highway authority's authorised representative: _____	