

HS2 FORM TM1

Highway Authority	Solihull Metropolitan Borough Council
Street(s)/USRN(s)	Park Lane – 35005842 A452 Kenilworth Road – 35010030 Northway Island – 35010156 A452 Chester Road – 35006662 A452 Chester Road – 35006281 Solihull Parkway – 35002856 B4438 Bickenhill Parkway - 35006577
HS2 Consent Reference	THW.AN.SMBC.LMJV.0120
Contractor document reference	1EW04-LMJ-HW-SCH-NS01-047001 C07
Submission Date (to Highway Authority)	31/01/2019
Proposed start date of consent	20/03/2019
Proposed end date of consent	22/03/2019
Consultation end date	08/02/2019
Deemed consent date (if required)	Click here to enter a date.

Temporary Highway Interference

In accordance with the powers set out in the **High Speed Rail (London - West Midlands) Act 2017**, the Contractor, acting on behalf of and, as agent for the Nominated Undertaker, hereby consults the highway authority and/or requests highway authority consent under Schedule 2, 4 and/or 33 as identified below:

Consultation with the highway authority:	
The temporary interference / works is on a street or location that is listed in Table 3 of Schedule 4 to the Act (Schedule 4 Part 2 paragraph 6)	<input checked="" type="checkbox"/>
Consent of the highway authority:	
The temporary interference / works is on a street or location not listed in Table 3 of Schedule 4 of the Act (Schedule 4 Part 2 paragraph 6)	<input type="checkbox"/>
Trial holes (Schedule 2 only)	<input type="checkbox"/>
Protective provisions (Schedule 33) [mark as appropriate]	
Works to a bridge requiring temporary interference, (Schedule 33 para 6)	<input type="checkbox"/>
Alteration/disturbance to apparatus of the highway authority affixed to or placed under any highway or, access to the apparatus of the Highway Authority, (Schedule 33 Para 9)	<input type="checkbox"/>
Depositing soil or materials or storing plant on the highway (Schedule 33 Para 12)	<input type="checkbox"/>
Erection of scaffolding or screening (or hoarding) in the highway (Schedule 33 Para 12)	<input type="checkbox"/>

Table 1. Summary <i>(mark as appropriate)</i>	Alteration to apparatus of the highway authority	<input type="checkbox"/>	Deposit of material on the highway	<input type="checkbox"/>	Footway Works only	<input type="checkbox"/>	Peak hours	<input type="checkbox"/>	Works to PRow	<input type="checkbox"/>	Give and Take	<input type="checkbox"/>	Contra-flow	<input type="checkbox"/>	Lane Closure	<input checked="" type="checkbox"/>	Portable temporary traffic signals <i>(delete as required)</i> 2-way multiphase	<input checked="" type="checkbox"/>	Priority working	<input type="checkbox"/>
	Trial holes	<input type="checkbox"/>	Erection of scaffolding/hoarding	<input type="checkbox"/>	Works in the carriageway	<input checked="" type="checkbox"/>	Off Peak	<input checked="" type="checkbox"/>	Street works (NRSWA)	<input type="checkbox"/>	Stop /Go	<input type="checkbox"/>	Signing	<input checked="" type="checkbox"/>	Road Closure	<input checked="" type="checkbox"/>	Works to existing or new signal installations	<input type="checkbox"/>	Associated utility works	<input type="checkbox"/>

Table 2. Works description, traffic management phasing and intended programme

Road name	Extent of Temporary Interference	USRN	Grid Ref	EToN reference	TM Phase	TM drawing reference	Description of works	Description of associated traffic management	TM operational hours	Proposed Works Start Date	Estimated Works End Date
Park Lane	Park Lane/Lavender Hall Lane junction to Park Lane/A452 junction	35005842	SP 24100 78351 to SP 23255 78622	N/A	Single Phase	1004	WP47 Vegetation clearance on sections of carriageway of Park Lane	Park Lane Road Closure and associated diversion route	9:30am to 3:30pm	04/03/2019	08/03/2019
A452 Kenilworth Road	Beefeater George in the Tree to Bibury House	35010030	SP 23526 78018 to SP 22071 80006	N/A	Single Phase	1101 1102 1103 1104	WP47 Vegetation clearance	Lane closures and associated temporary signage. N&SB L2 closures NB L1 closure SB L1 closure	9:30am to 3:30pm	04/03/2019	08/03/2019
Northway Island	Northway Island	35010156	SP 19770 85337	N/A	Single Phase	2810	Vegetation clearance	Lane closures, temporary signage	9pm to 6am	25/02/2019	02/03/2019
B4438 Bickenhill Parkway	Northway Island to Premier Inn Birmingham NEC Airport	35006577	SP 19714 85237 to SP 18960 85006	N/A	Single Phase	2811	Vegetation clearance	Lane closures, temporary signage and contraflow system	9pm to 6am	25/02/2019	02/03/2019
A452 Chester Road	Northway Island to Stonebridge Island	35006662	SP 19857 85276 to SP 20672 84093	N/A	Single Phase	2812 2806	Vegetation clearance	Lane closures and temporary signage	9pm to 6am	25/02/2019	02/03/2019
Solihull Parkway	Solihull Parkway	35002856	SP 19663 85327 to SP 19030 85642	N/A	Single Phase	2810 2811 2812 2806	Vegetation clearance	Temporary signage	9pm to 6am	25/02/2019	02/03/2019
Lavender Hall Lane	Hallmeadow Road to 100m North of Park Lane	35005828	SP 23837 77961 to SP 24146 78451	N/A	Single Phase	2502	Vegetation clearance	2-way portable traffic signals	9:30am to 3:30pm	20/03/2019	22/03/2019
Park Lane	Lavender Hall Lane to A452	35005842	SP 24100 78351 to SP 23255 78622	N/A	Single Phase	1002	Vegetation clearance	2-way portable traffic signals	9:30am to 3:30pm	20/03/2019	22/03/2019

NOTE: Roadspace occupation will be for a series of days within the given dates, programme will be confirmed closer to the start date

Details of pre-application discussions with the Highway Authority and stakeholders			
Date	Details		
08/11/2018	Locations tabled at SMBC TLG		
09/11/2018	Pre-application meeting held at LM offices with David Keaney and Lisa Pardy		
30/01/2019	Pre-application 2 held at SMBC with Lisa Pardy, Paul Tovey and David Keaney		
Details of associated consents/approvals			
Document references and supporting information			
Title	Phase (from Table 2)	Reference	Version
<i>Road closure Park Lane West</i>	<i>Single</i>	<i>1004</i>	<i>A</i>
<i>Proposed lane one closure (SB) A452 Kenilworth Road Berkswell CV7 7FB</i>	<i>1</i>	<i>1101</i>	<i>A</i>
<i>Proposed lane two closure (SB) A452 Kenilworth Road Berkswell CV7 7FB</i>	<i>2</i>	<i>1102</i>	<i>A</i>
<i>Proposed lane two closure (NB) A452 Kenilworth Road Berkswell CV7 7FB</i>	<i>2</i>	<i>1103</i>	<i>A</i>
<i>Proposed lane one closure (NB) A452 Kenilworth Road Berkswell CV7 7FB</i>	<i>3</i>	<i>1104</i>	<i>A</i>
<i>Northway Island</i>	<i>Single</i>	<i>2810</i>	<i>-</i>
<i>B4438 Bickenhill Parkway</i>	<i>Single</i>	<i>2811</i>	<i>-</i>
<i>A452</i>	<i>Single</i>	<i>2806</i>	<i>-</i>

Contractor Signature	
This submission is made by the Contractor on behalf of and as agent for the Nominated Undertaker. HS2 Ltd authorises the contractor to submit the application for consultation or, as required, consent of the highway authority <i>[Contractor must obtain acceptance from HS2 before submitting the form to the highway authority]</i>	
Contractor	LM-JV Comerblock, Two Cornwall Street, Birmingham, B3 2DLX
Contractor Authorised Signatory	 Wayne Skells, Traffic Manager
Contractor Site Contact Details	HS2 Helpdesk: 08081434434

Highway Authority Response Sheet

To be completed by the Highway Authority and provided as a response to the application

HS2 Consent Reference:	
Street(s):	Park Lane/Lavender Hall Lane
Submission Date:	
Response Date:	13/03/2019

Local Highway Authority Response

Highway Authority:	SMBC
--------------------	------

Decision on the application by the highway authority, if consent is required:

Consent granted <input type="checkbox"/>	If consent withheld or consent with comments, state ground(s) below:
Consent granted with comments <input type="checkbox"/>	
Consent withheld <input type="checkbox"/>	
Consultation <input checked="" type="checkbox"/>	<i>Please be aware there are patching works planned in for 21/03/19 under a Road Closure, and the junction of Park Lane/Kenilworth Road is part of the diversion route, although this should not have a huge effect on your works and 2 way TL.</i>

Signature: 

Date: 13.3.19

Name of highway authority's authorised representative: Lisa Pardy

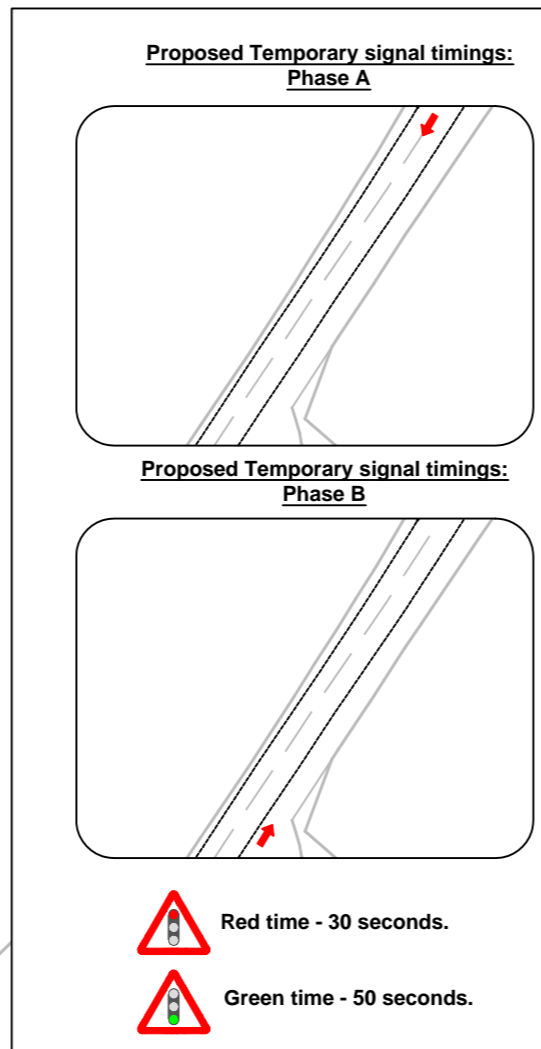
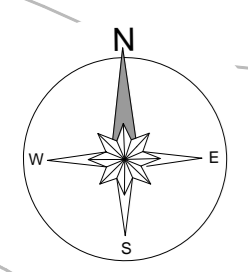
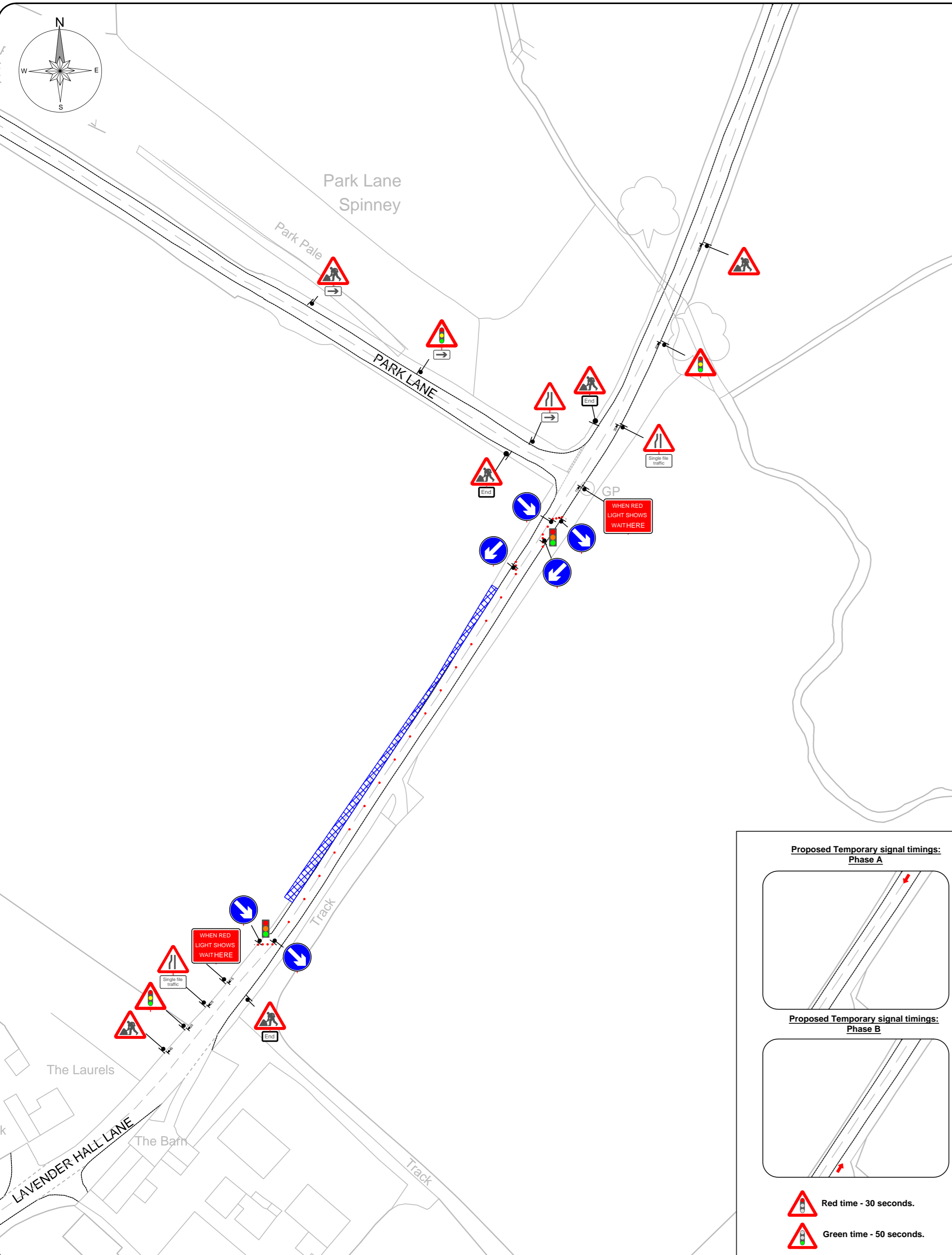

LOCATION MAP

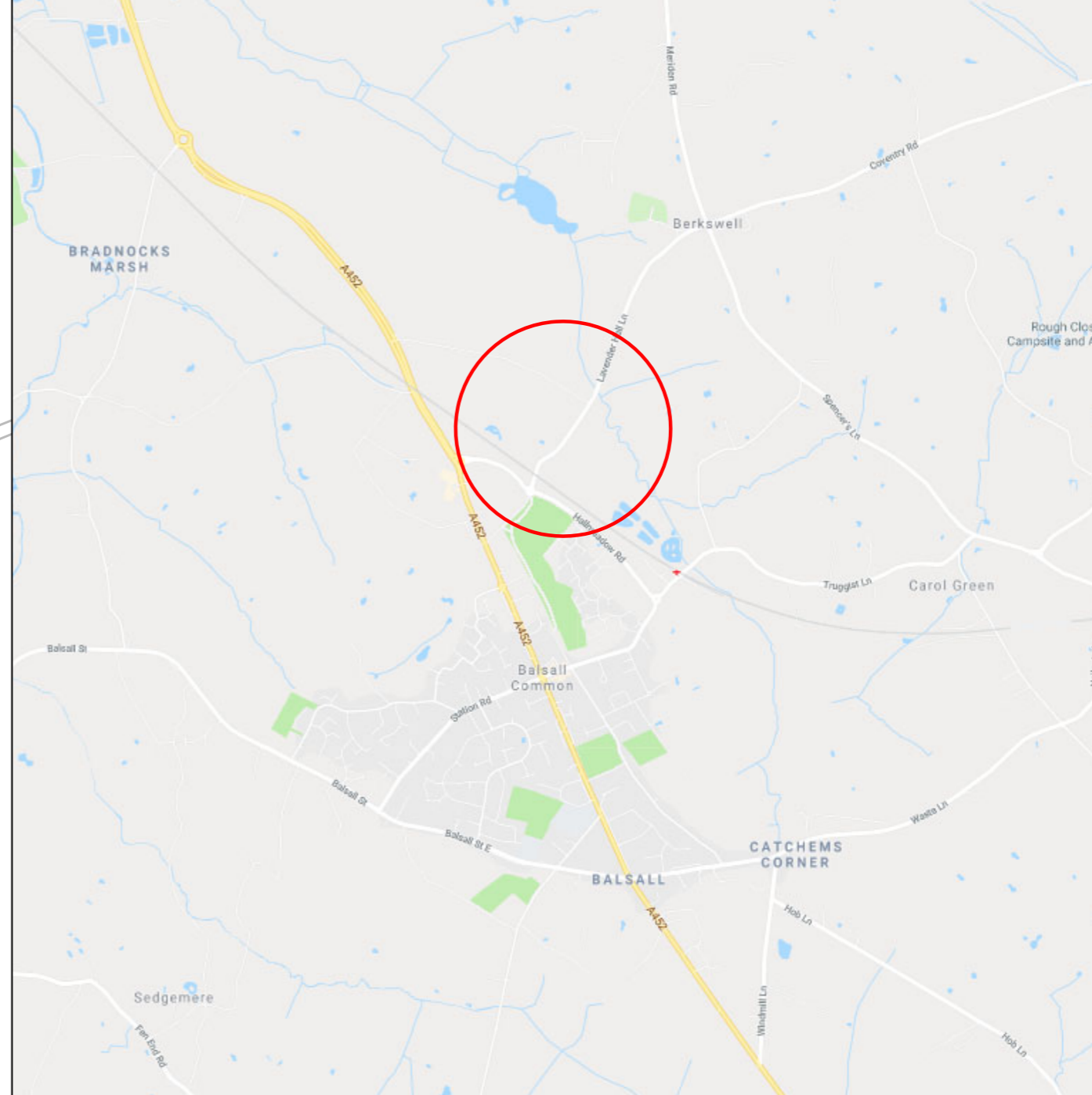

EXTENT OF SITE CLEARANCE WORKS

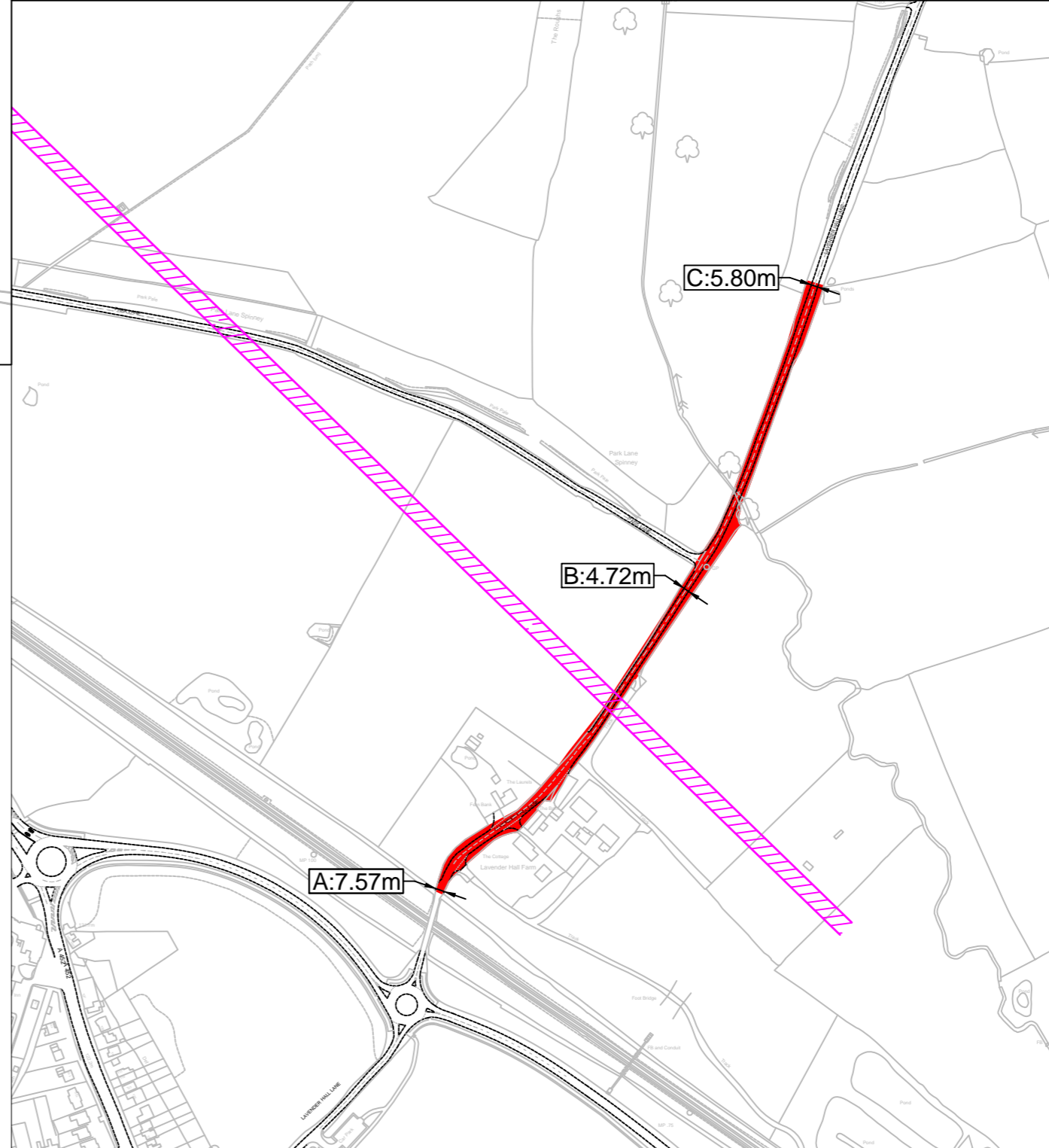

Key:

	Works Area		Temporary Traffic Signal
	Road Closure		Stop & Go Board
	Diversion Route		Permanent Traffic Signal
	Cone		Temporary Ped Signal
	Pedestrian Barrier		Existing Bus Stop
	Temporary Sign		3.5T Van
	Site/compound access		Indicative HS2 route

Site Information:

Road Speed	30 40
Min width of sideways safety zone (S)	0.5m
Min length of longways clearance (L)	0.5m / 15m
Surveyed	N
Road Width	4.72-7.57m
Site Length	640m
Bus Route	N
Road Type	Single lane carriageway

Notes:

Desktop survey undertaken from google street view with imagery dated July 2018

Overhead power lines within site

Part of the route is tree lined

There is a speed change from 30 - 40 mph

There are multiple accesses properties within the works area.

Refer to design risk assessment and photo schedule for additional information

Timings are indicative only. Operative on site to adjust accordingly to suit traffic flows

Shuttle lane should ideally be between 3.25 & 3.5m or 3.0m as an absolute minimum

Where there is a private road/business and/or side approach within the works, contractor is to refer to drawing TFX SC0025 Detail A to determine a suitable method of control

Traffic Management to be switched for works on the opposite side of the carriageway

Rev	Date	Comments	By	Chk

Working in Partnership with

total traffic & event management solutions

Old Arden Brickworks | Bickenhill | Solihull | West Midlands | B92 0DY
 t +44 (0)800 819 9001 | f +44 (0)1675 442507
 info@traffix.com | www.traffix.com

Project title:
Traffic Management Works Package 47 - Site 25

Drawing title:
Proposed Two Way Traffic Lights
Lavender Hall Lane
Balsall Common
CV7 7BN

Date: 23/11/2018	Scale: 1:1250	Paper: A2
Drawn: CM	Checked: BNH	Approved: MO
Project Number: TFX SC0025	Drawing Number: 2502	Revision: -

This drawing is copyright & the property of Traffix & must not be copied in whole or in part without their written permission. Copyright is reserved. © This drawing must not be scaled. The Contractor is to report all discrepancies & errors to the Contract Manager prior to works commencing.

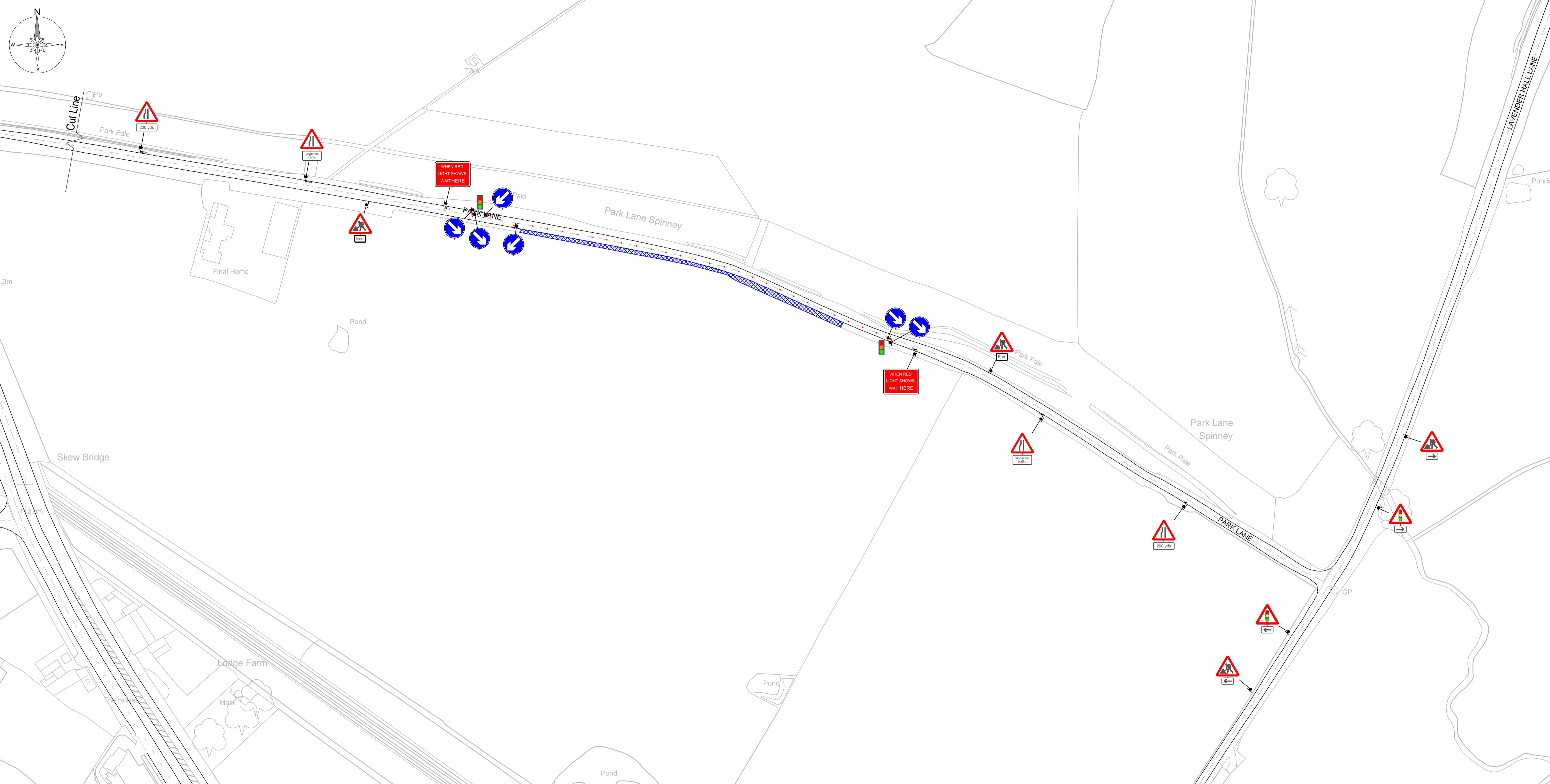

Key:	
	Works Area
	Road Closure
	Diversion Route
	Cone
	Pedestrian Barrier
	Temporary Sign
	Site compound access
	Temporary Traffic Signal
	Stop & Go Board
	Permanent Traffic Signal
	Temporary Ped Signal
	Existing Bus Stop
	3.5T Van
	Indicative HS2 route

Site Information:	
Road Speed	30
Min width of sideways safety zone (S)	1.2m
Min length of longways clearance (L)	30m
Surveyed	N
Road Width	4.90m-5.68m
Site Length	800m
Bus Route	N
Road Type	Single Lane carriageway

Notes:

Desktop survey undertaken from google street view with imagery dated July 2012

Overhead power lines within site

Speed limit to be confirmed (Conflicting speed signage at either end of the road)

There is an access to a residential property(s) within the works area

A road closure has been proposed at the junction with A452 Kenilworth Road to allow works to progress away from the junction before switching to temporary traffic lights.

A lane closure may need to be installed over the top of the closure to provide a safety zone

Due to the proximity of the works with the junctions of Lavender Hall Lane/A452 the traffic lights in these location may need manually controlling to prevent backing up and blocking the road

Refer to design risk assessment and photo schedule for additional information

Proposed Temporary signal timings:

Phase A

Phase B

Red time - 30 seconds.

Green time - 50 seconds.

Timings are indicative only. Operative on site to adjust accordingly to suit traffic flows

Shuttle lane should ideally be between 3.25 & 3.5m or 3.0m as an absolute minimum

Where there is a private road/business and/or side approach within the works, contractor is to refer to drawing TFX SC0025 Detail A to determine a suitable method of control

Traffic Management to be switched for works on the opposite side of the carriageway

EXTENT OF SITE CLEARANCE WORKS

LOCATION MAP

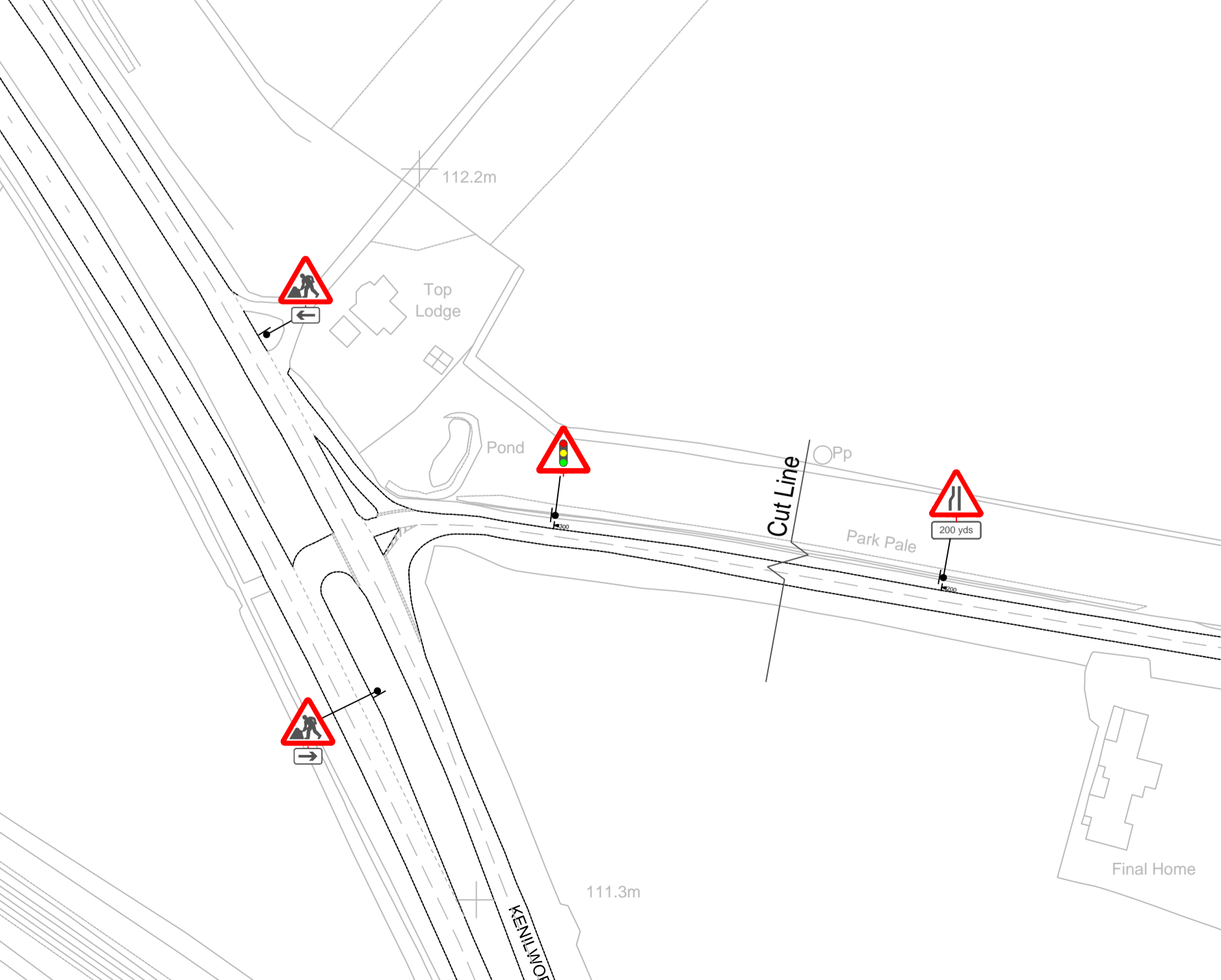
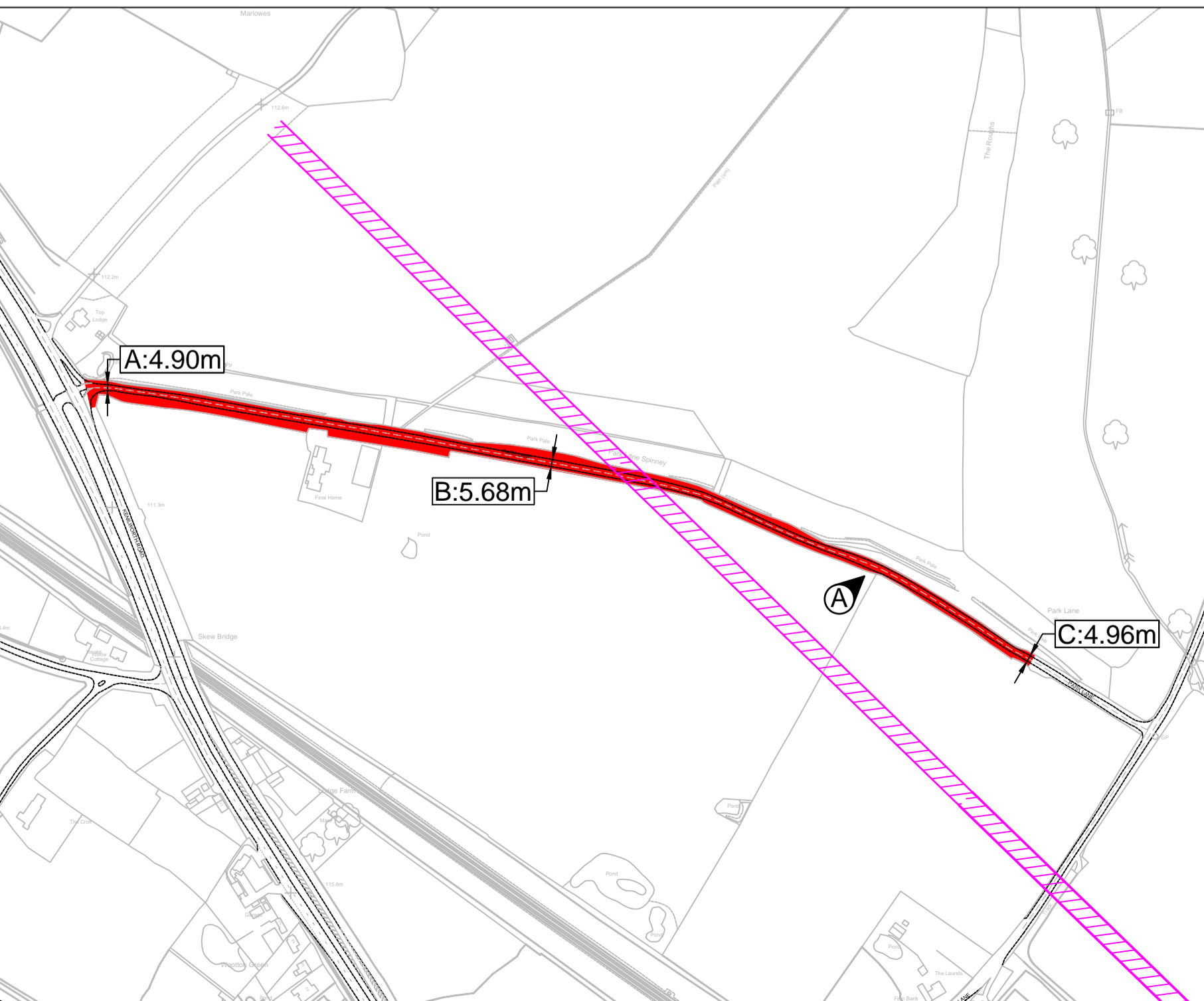

LM
Working in Partnership with
traffix

total traffic & event management solutions
Old Arden Brickworks | Bickenhill | Solihull | West Midlands | B92 0DY
t: +44 (0)800 819 9001 | f: +44 (0)121 75 442507
info@traffix.com | www.traffix.com

Project title:		
Traffic Management Works Package 47 - Site 10		
Drawing title:		
Proposed Two Way Traffic Lights Park Lane Berkswell CV7 7BP		
Date:	Scale:	Paper:
12/10/2018	1:1000	A1
Drawn:	Checked:	Approved:
CM	BNH	MO
Project Number:	Drawing Number:	Revision:
TFX SC0025	1002	-

This drawing is copyright & the property of Traffix & must not be copied in whole or in part without their written permission. Copyright is reserved. © This drawing must not be scaled. The Contractor is to report all discrepancies & errors to the Contract Manager prior to works commencing.