

HS2 FORM TM1

Highway Authority	Solihull Metropolitan Borough Council
Street(s)/USRN(s)	A452 Chester Road, Northway Island
HS2 Consent Reference	THW.AN.SMBC.LMJV.0132
Contractor document reference	1EW04-LMJ-HW-SCH-NS07-049016
Submission Date (to Highway Authority)	16/01/2019
Proposed start date of consent	18/02/2019
Proposed end date of consent	21/02/2019
Consultation end/ requested response date	08/02/2019
Deemed consent date (if required)	12/02/2019

Temporary Interference with the Highway

In accordance with the powers set out in the **High Speed Rail (London - West Midlands) Act 2017**, the Contractor, acting on behalf of and, as agent for the Nominated Undertaker, hereby consults the highway authority and/or requests highway authority consent under Schedule 2, 4 and/or 33 as identified below:

Consultation with the highway authority:	
The temporary interference / works is on a street or location that is listed in Table 3 of Schedule 4 to the Act (Schedule 4 Part 2 paragraph 6)	<input type="checkbox"/>
Consent of the highway authority:	
The temporary interference / works is on a street or location not listed in Table 3 of Schedule 4 of the Act (Schedule 4 Part 2 paragraph 6)	<input checked="" type="checkbox"/>
Trial holes (Schedule 2 only)	<input type="checkbox"/>
Protective provisions (Schedule 33) [mark as appropriate]	
Works to a bridge requiring temporary interference, (Schedule 33 para 6)	<input type="checkbox"/>
Alteration/disturbance to apparatus of the highway authority affixed to or placed under any highway or, access to the apparatus of the Highway Authority, (Schedule 33 Para 9)	<input type="checkbox"/>
Depositing soil or materials or storing plant on the highway (Schedule 33 Para 12)	<input type="checkbox"/>
Erection of scaffolding or screening (or hoarding) in the highway (Schedule 33 Para 12)	<input type="checkbox"/>

Table 1. High level summary (mark as appropriate)		Alteration to apparatus of the highway authority	Deposits of material on the highway	Footway Works only	Peak hours	Works to PRow	Give and Take	Contra-flow	Lane Closure	Portable temporary traffic signals (delete as required) 2-way multiphase	Works to existing or new traffic signals infrastructure	Associated utility works
<input type="checkbox"/>	<input type="checkbox"/>	<input type="checkbox"/>	<input type="checkbox"/>	<input type="checkbox"/>	<input type="checkbox"/>	<input type="checkbox"/>	<input type="checkbox"/>	<input type="checkbox"/>	<input type="checkbox"/>	<input type="checkbox"/>	<input type="checkbox"/>	<input type="checkbox"/>

Table 2. Detailed works description, traffic management phasing and intended programme

Road name	Extent of Temporary Interference	Consent or Consultation	USRN	Grid Ref	ETON reference	TM Phase	TM drawing reference	Description of works	Description of associated traffic management	TM operational hours	Proposed Works Start Date	Estimated Works End Date
A452 (N) Chester Rd	A452/ A446 Split to Northway Island	Consent	35006662	SP 20611 84156 SP 20247 84641		Single Phase	CTM/BDWP493010(2)	Monitoring of a bore hole in the verge	Lane 1 closure on the A452 Chester Road from the A452/ A446 Split to Northway Island	8pm to 6am	18/02/2019	21/02/2019
A452 (S) Chester Road	Approach to Northway Island	Consent	35006662	SP 19738 85436		Single Phase	CTM/BDWP493010(1)	Monitoring of a bore hole in the verge	Lane 2 closure on approach to Northway Island	8pm to 6am	18/02/2019	21/02/2019
A452 Northway Island	Eastern half of Northway Island	Consent	35010156	SP 19871 85391		Single Phase	CTM/BDWP493010(1)	Monitoring of a bore hole in the verge	Inner partial ring closure of Northway Island	8pm to 6am	18/02/2019	21/02/2019

Details of pre-application discussions with the Highway Authority and stakeholders

Date	Details
08/11/2018	Tabled and discussed at the SMBC TLG
Click here to enter a date.	

Details of associated consents/approvals

--

Document references and supporting information

Title	Phase (from Table 2)	eB reference	Version
A452 Traffic Management Drawing	Single		
Northway Island Traffic Management Drawing	Single		

Contractor Signature

This submission is made by the Contractor on behalf of and as agent for the Nominated Undertaker.
 HS2 Ltd authorises the contractor to submit the application for consultation or, as required, consent of the highway authority
[Contractor must obtain acceptance from HS2 before submitting the form to the highway authority]

Contractor	LM-JV Cornerblock, Two Cornwall Street, Birmingham, B3 2DL
Contractor Authorised Signatory	 Richard Coy
Contractor Site Contact Details	Bridgeway Consulting Ltd Centurion Traffic Management Ltd

Highway Authority Response Sheet
To be completed by the Highway Authority and provided as a response to the application

HS2 Consent Reference:	
Street(s):	
Submission Date:	
Response Date:	

Local Highway Authority Response

Highway Authority:	
---------------------------	--

Decision on the application by the highway authority, if consent is required:

Consent granted <input type="checkbox"/>	If consent withheld or consent with comments, state ground(s) below:
Consent granted with comments <input type="checkbox"/>	
Consent withheld <input type="checkbox"/>	
Consultation <input type="checkbox"/>	<i>[Insert comments on consultation]</i>

Signature:  Date: 21.01.19

Name of highway authority's authorised representative: Lisa Pardy.

Grid Reference
SP 20132 85446

005-1-C

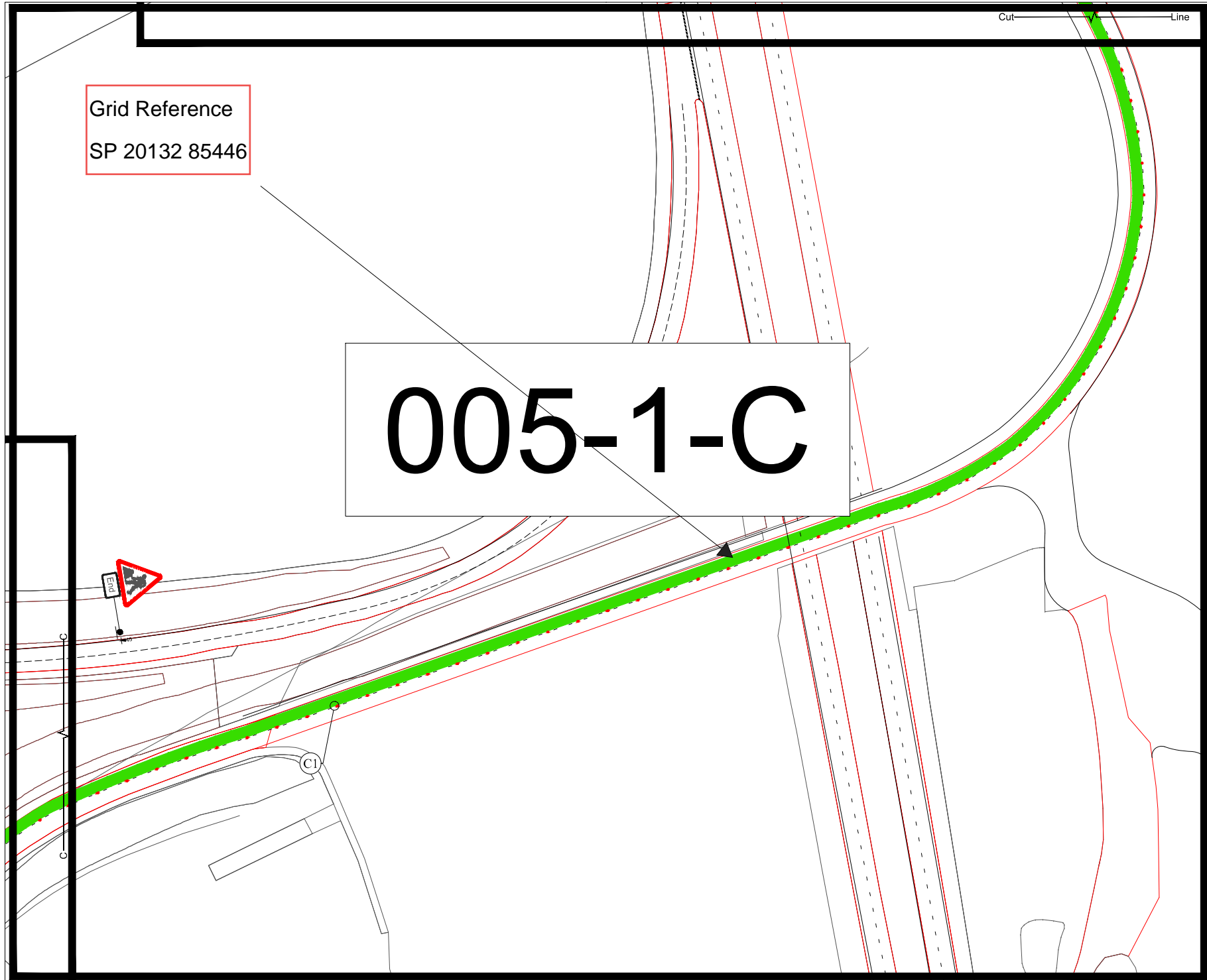

Notes

- All traffic management in accordance with Chapter 8 and New Roads and Street Works Act.

DETAIL B (B)
 Single/Dual carriageway 40mph or less - 450mm traffic cones, spacing 1.5m.
 Single/Dual carriageway 50mph or more - 750mm traffic cones, spacing 1.5m.
 Dual carriageway national speed limit - 750mm traffic cones, spacing 1.5m, relaxation 5m.

- Notes:
 1) During darkness, warning lights to BS EN 12352:2006 should be provided in accordance with Table A1.3 (Appendix 1).
 2) 45° tapers have 1.5m spacing, no relaxations.
 3) On motorways and NSL AP Dualls with hard shoulders, 1m cones will be required for both standard and relaxation works for lead tapers and the facing wall of lane changes.

DETAIL C1 (C1)
 Single/Dual carriageway 40mph or less - 450mm traffic cones.
 Single/Dual carriageway 50mph or more - 750mm traffic cones.

- Notes:
 1) During darkness, warning lights to BS EN 12352:2006 should be provided in accordance with Table A1.3 (Appendix 1).
 2) For relaxation to Detail C1 see Table A1.3 (Appendix 1).

DETAIL D (D)
 Single/Dual carriageway 40mph or less - 450mm traffic cones.
 Single/Dual carriageway 50mph or more - 750mm traffic cones.

- Notes:
 1) During darkness, warning lights to BS EN 12352:2006 should be provided in accordance with Table A1.3 (Appendix 1).
 2) Detail D applies only to relaxation cases.

Works Area

A Minor alterations		LB	Checked	Auth	Date
Row	Details	Drawn	Checked	Auth	Date

Drawing Status	Submittal
----------------	-----------

Centurion Traffic Management Ltd.
 Road Office
 20 Long Park Road
 Solihull
 Leicestershire
 B37 7YU
 Telephone: 0121 711 2200
www.centuriontraffic.com

TMPlans TMPlans is a registered trademark of Centurion Traffic Management Ltd.

LM
 Making the Right Choice

Project Title: **HS2 Survey Works**

Drawing Title: **Traffic Management-
 Solihull Roundabout & A452
 Solihull Parkway Roundabout Inner Ring Closure**

Scale	1:500	Designed	LB	Drawn	LB	Checked	PW	Authorised
Original Size	A1	Date	27/02/18	Date	27/02/18	Date	27/02/18	Date

Drawing Number	Originator	Update	Project Ref. No.
DN	- TMP	- TTM	
B37 7YU	- DR	- CB - 005-1-C	A -
Location	Type	Issue Number	Revision

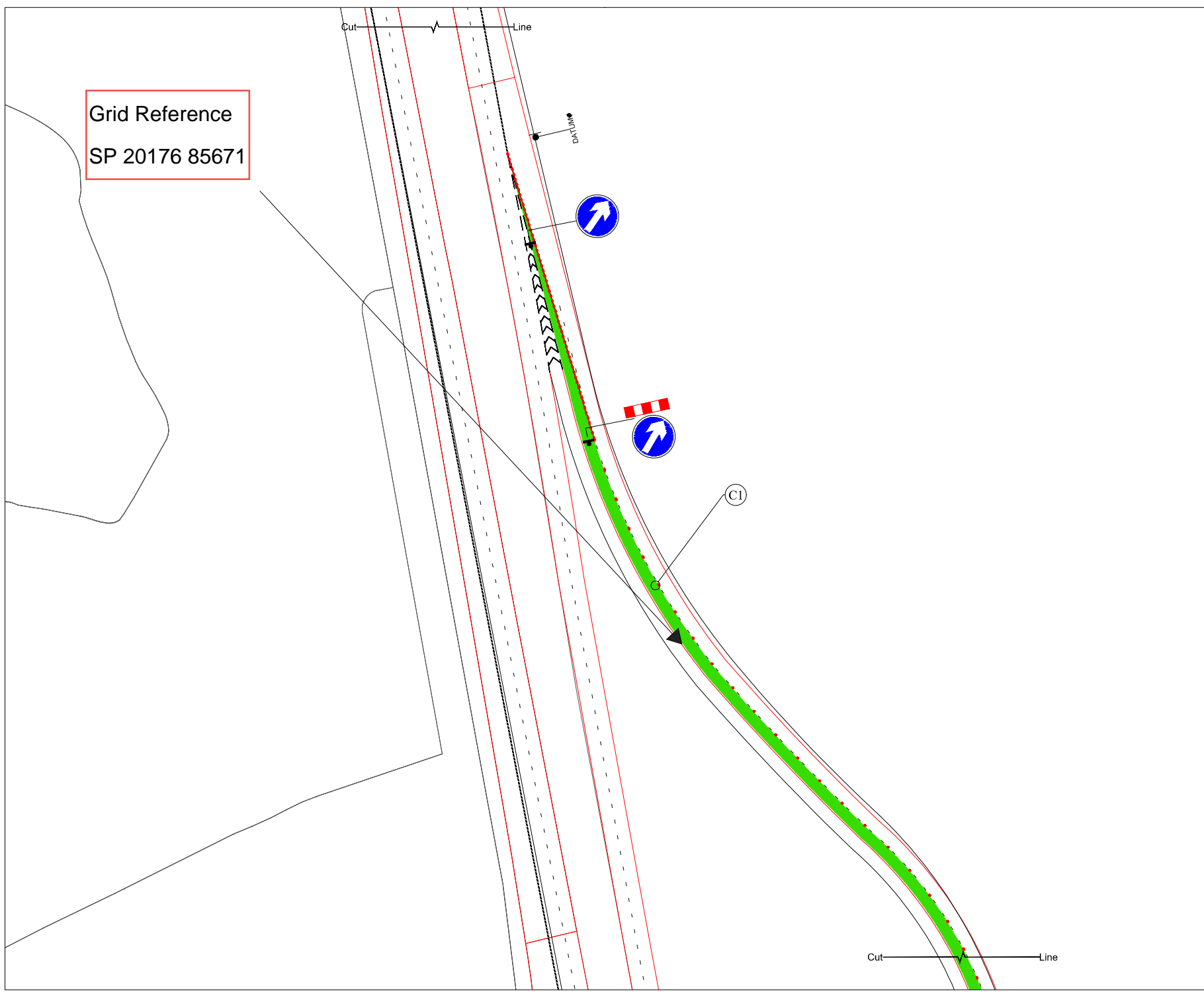

Grid Reference
SP 20176 85671

Notes

- All traffic management in accordance with Chapter 8 and New Roads and Street Works Act.

DETAIL B (B)

Single/Dual carriageway 40mph or less - 450mm traffic cones, spacing 1.5m.
Single/Dual carriageway 50mph or more - 750mm traffic cones, spacing 1.5m.
Dual carriageway national speed limit - 750mm traffic cones, spacing 1.5m, relaxation 5m.

- Notes:
- During darkness, warning lights to BS EN 12352:2006 should be provided in accordance with Table A1.3 (Appendix 1).
 - 45° tapers have 1.5m spacing, no relaxations.
 - On motorways and NSL AP Duals with hard shoulders, 1m cones will be required for both standard and relaxation works for lead tapers and the facing wall of lane changes.

DETAIL C1 (C1)

Single/Dual carriageway 40mph or less - 450mm traffic cones, spacing 8m.
Single/Dual carriageway 50mph or more - 750mm traffic cones, spacing 8m.

- Notes:
- During darkness, warning lights to BS EN 12352:2006 should be provided in accordance with Table A1.3 (Appendix 1).
 - For relaxation to Detail C1 see Table A1.3 (Appendix 1).

DETAIL D (D)

Single/Dual carriageway 40mph or less - 450mm traffic cones, spacing 18m.
Single/Dual carriageway 50mph or more - 750mm traffic cones, spacing 18m.

- Notes:
- During darkness, warning lights to BS EN 12352:2006 should be provided in accordance with Table A1.3 (Appendix 1).
 - Detail D applies only to relaxation cases.

Works Area

A		Minor alterations		LB	Checked	Auth	Date
Rev	Details	Drawn	Checked	Auth	Date		

Drawing Status	Submittal
----------------	-----------

Centurion Traffic Management Ltd.
Head Office
20 Leigh Park Road
Stoke
Leeds
LS21 1EL
Telephone: 0113 271 2200
www.centuriontraffic.com

TMPlans TMPlans is a registered trademark of Centurion Traffic Management Ltd.

LM
Making the Right Choice

Project Title: **HS2 Survey Works**

Drawing Title: **Traffic Management- Solihul Roundabout & A452 Solihul Parkway Roundabout Inner Ring Closure**

Scale	1:500	Designed	LB	Drawn	LB	Checked	PW	Authorised
Original Size	A1	Date	27/02/18	Date	27/02/18	Date	27/02/18	Date

Drawing Number	Original	Update	Project Ref. No.
PW	- TMP	- TTM	
B37 7YU	- DR	- CB - 005-2-C	Revision
Location	Type	Date	Number
			A -

Grid Reference
SP 20077 85989

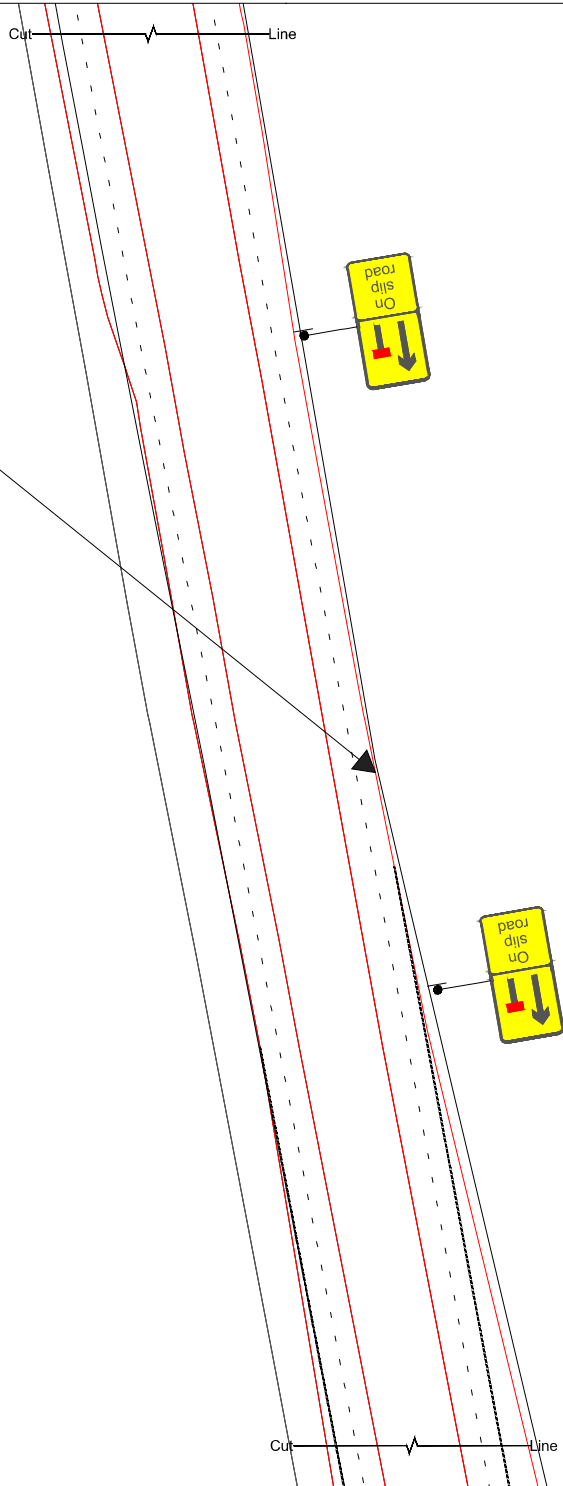

Notes

- All traffic management in accordance with Chapter 8 and New Roads and Street Works Act.

DETAIL B (B)
 Single/Dual carriageway 40mph or less - 450mm traffic cones, spacing 1.5m.
 Single/Dual carriageway 50mph or more - 750mm traffic cones, spacing 1.5m.
 Dual carriageway national speed limit - 750mm traffic cones, spacing 1.5m, relaxation 5m.

- Notes:
 1) During darkness, warning lights to BS EN 12352:2006 should be provided in accordance with Table A1.3 (Appendix 1).
 2) 45° tapers have 1.5m spacing, no relaxations.
 3) On motorways and NSL AP Duals with hard shoulders, 1m cones will be required for both standard and relaxation works for lead tapers and the facing wall of lane changes.

DETAIL C1 (C1)
 Single/Dual carriageway 40mph or less - 450mm traffic cones, spacing 1.5m.
 Single/Dual carriageway 50mph or more - 750mm traffic cones, spacing 1.5m.

- Notes:
 1) During darkness, warning lights to BS EN 12352:2006 should be provided in accordance with Table A1.3 (Appendix 1).
 2) For relaxation to Detail C1 see Table A1.3 (Appendix 1).

DETAIL D (D)
 Single/Dual carriageway 40mph or less - 450mm traffic cones, spacing 1.5m.
 Single/Dual carriageway 50mph or more - 750mm traffic cones, spacing 1.5m.

- Notes:
 1) During darkness, warning lights to BS EN 12352:2006 should be provided in accordance with Table A1.3 (Appendix 1).
 2) Detail D applies only to relaxation cases.

Works Area

A		Minor alterations		LB	Checked	Auth	Date
Rev	Details	Drawn	Checked	Auth	Date		

Drawing Status	Submittal
----------------	-----------

Centurion Traffic Management Ltd.
 Head Office
 20 Sedgefield Road
 Works
 Leeds
 LS10 1EJ
 Telephone: 0113 271 2200
www.centuriontraffic.com

TMPlans
TMPlans is a registered trademark of Centurion Traffic Management Ltd. All rights reserved.

Client
LM
 Making the Right Choice

Project Title
 HS2 Survey Works

Drawing Title
 Traffic Management-
 Solihul Roundabout & A452
 Solihul Parkway Roundabout Inner Ring Closure

Scale	1:500	Designed	LB	Drawn	LB	Checked	PW	Authorised
Original Size	A1	Date	27/02/18	Date	27/02/18	Date	27/02/18	Date

Drawing Number PW	Original	Update	Project Ref. No.
	- TMP	- TTM	
B37 7YU	- DR	- CB - 005-3-C	Revision A -
Location	Type	Date	Number

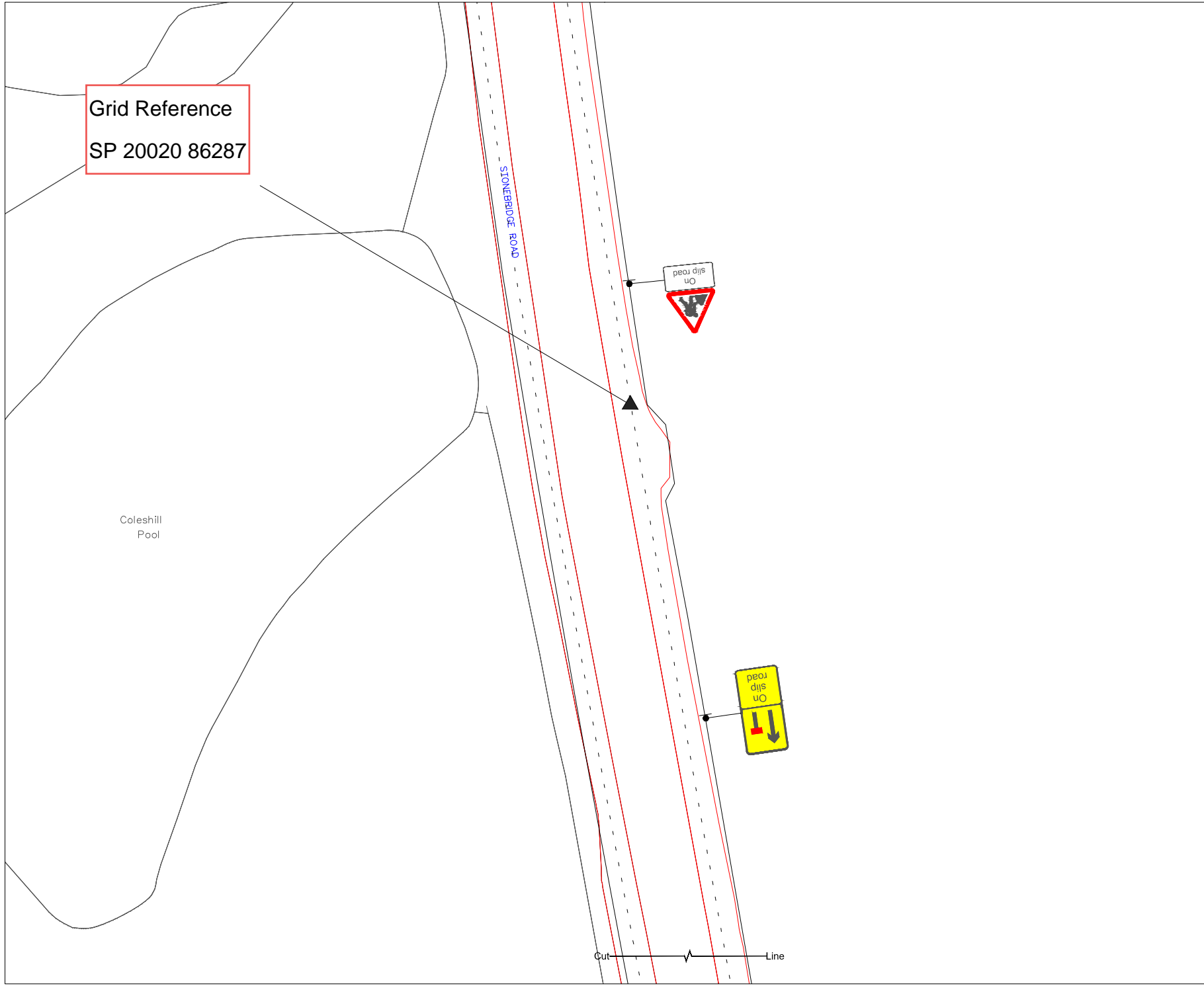

Notes

- All traffic management in accordance with Chapter 8 and New Roads and Street Works Act.

DETAIL B (B)

Single/Dual carriageway 40mph or less - 450mm traffic cones, spacing 1.5m.
 Single/Dual carriageway 50mph or more - 750mm traffic cones, spacing 1.5m.
 Dual carriageway national speed limit - 750mm traffic cones, spacing 1.5m, relaxation 5m.

- Notes:
- During darkness, warning lights to BS EN 12352:2006 should be provided in accordance with Table A1.3 (Appendix 1).
 - 45° tapers have 1.5m spacing, no relaxations.
 - On motorways and NSL AP Duals with hard shoulders, 1m cones will be required for both standard and relaxation works for lead tapers and the facing wall of lane changes.

DETAIL C1 (C1)

Single/Dual carriageway 40mph or less - 450mm traffic cones, spacing 1.5m.
 Single/Dual carriageway 50mph or more - 750mm traffic cones, spacing 1.5m.

- Notes:
- During darkness, warning lights to BS EN 12352:2006 should be provided in accordance with Table A1.3 (Appendix 1).
 - For relaxation to Detail C1 see Table A1.3 (Appendix 1).

DETAIL D (D)

Single/Dual carriageway 40mph or less - 450mm traffic cones, spacing 1.5m.
 Single/Dual carriageway 50mph or more - 750mm traffic cones, spacing 1.5m.

- Notes:
- During darkness, warning lights to BS EN 12352:2006 should be provided in accordance with Table A1.3 (Appendix 1).
 - Detail D applies only to relaxation cases.

Works Area

Rev	Details	Drawn	Checked	Auth	Date
A	Minor alterations			LB	28/02/18

Drawing Status	Submittal
----------------	-----------

Centurion Traffic Management Ltd.
 Head Office
 20 Long Park Road
 Solihul
 Leicestershire
 LE9 1HE
 Telephone: 0121 711 2200
www.centuriontraffic.com

TMPlans TMPlans is a registered trademark of Centurion Traffic Management Ltd.

LM
 Making the Right Choice

Project Title: **HS2 Survey Works**

Drawing Title: **Traffic Management-
 Solihul Roundabout & A452
 Solihul Parkway Roundabout Inner Ring Closure**

Scale	1:500	Designed	LB	Drawn	LB	Checked	PW	Authorised	
Original Size	A1	Date	27/02/18	Date	27/02/18	Date	27/02/18	Date	

Drawing Number	Original	Update	Project Ref. No.
PW	- TMP	- TTM	
B37 7YU	- DR	- CB - 005-4-C	A -
Location	Type	Issue Number	Revision

Grid Reference
SP 19788 85337

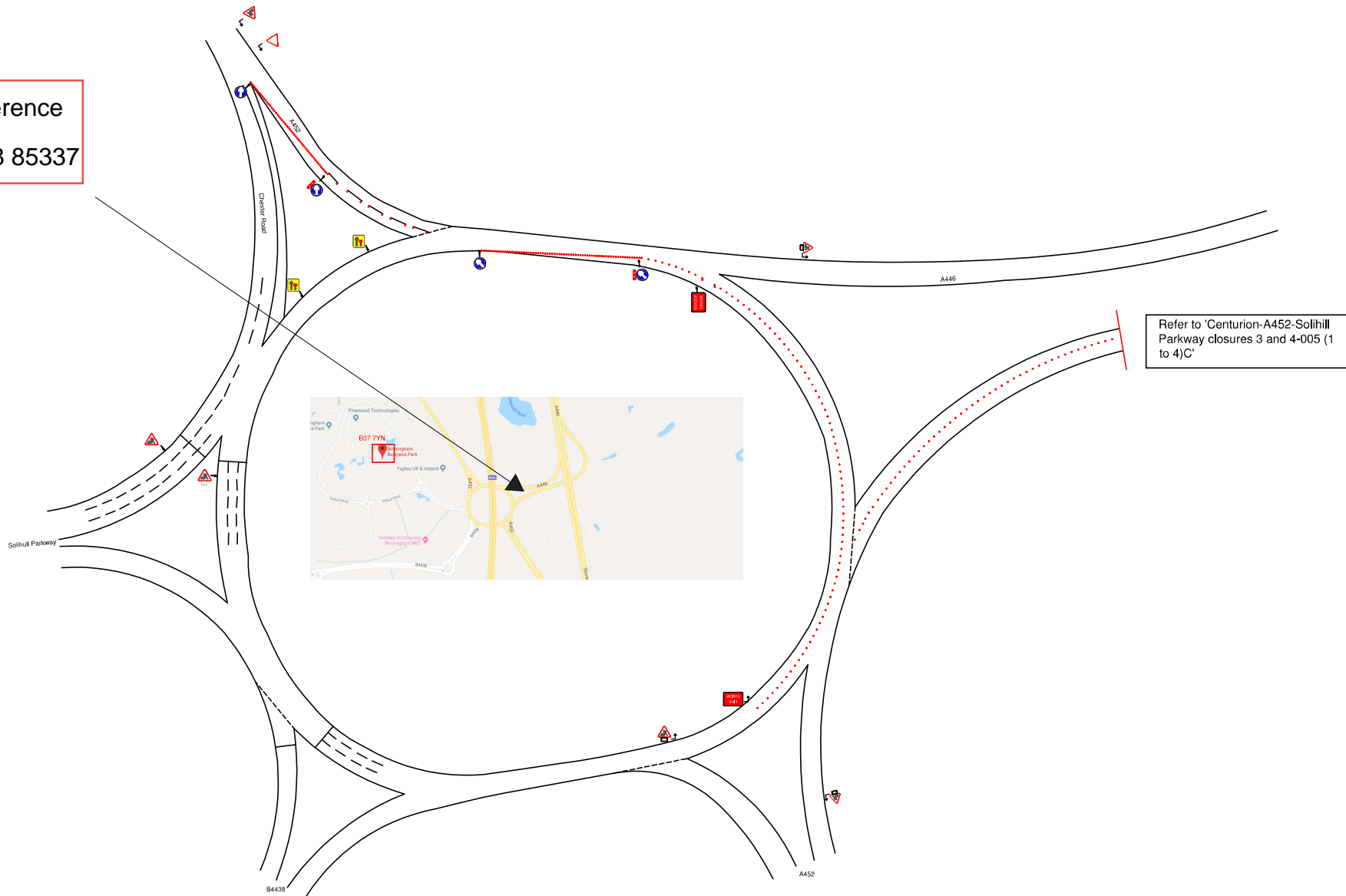

Refer to 'Centurion-A452-Solihull Parkway closures 3 and 4-005 (1 to 4)C'



Centurion Traffic Management
3B, Haigh Park Road
Stourton
Leeds
LS10 1RT
Tel: 0113 277 5360
E-mail: info@centuriontraffic.com
www.centuriontraffic.com

Date: 07/09/18

Scheme: HS2 SURVEY WORKS, BIRMINGHAM

Traffic Management: LANE 2 CLOSURE

Notes
All layouts drawn in accordance with Chapter 8 guidelines.
Drawing to be read in conjunction with relevant method statement and risk assessment.
Please check for amendments before use.

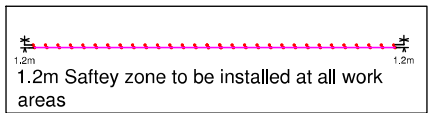
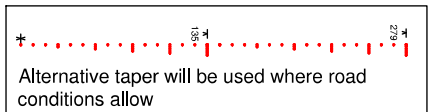

Crown Copyright. All rights reserved.

Drawing No:
CTM/WP493010(1)

Unauthorised reproduction infringes Crown Copyright and may lead to prosecution or civil proceedings.

Scale: NTS	Drawn BD	Authorised / Approved GS
---------------	-------------	--------------------------------



Grid Reference
SP 20559 84255

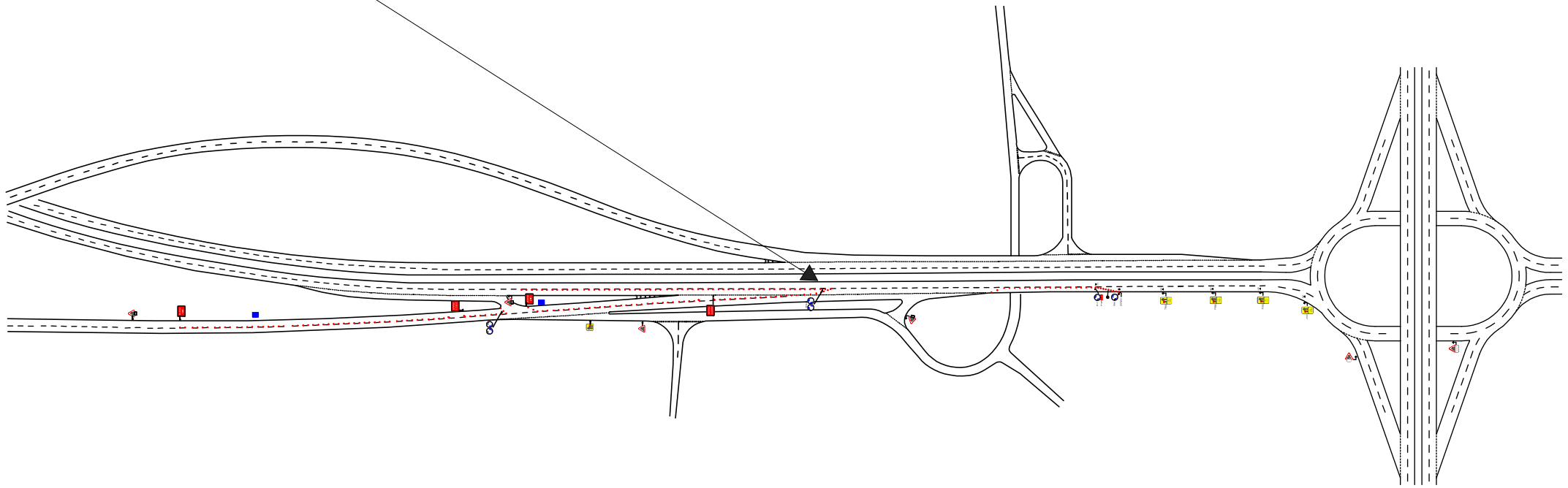

Centurion Traffic Management
3B, Haigh Park Road
Stourton
Leeds
LS10 1RT
Tel: 0113 277 5360
E-mail: info@centuriontraffic.com
www.centuriontraffic.com

Date: 30-10-18

Scheme: HS2 SURVEY WORKS

Traffic Management: LANE 2 CLOSURE

Notes
All layouts drawn in accordance with Chapter 8 guidelines.
Drawing to be read in conjunction with relevant method statement and risk assessment.
Please check for amendments before use.

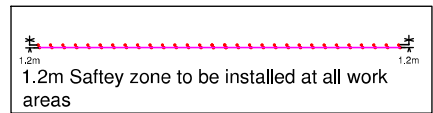
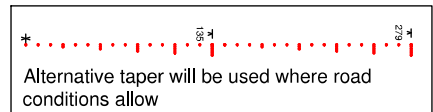

Crown Copyright. All rights reserved.

Drawing No:
CTM/BDWP493010(2)

Unauthorised reproduction infringes Crown Copyright and may lead to prosecution or civil proceedings.

Scale: NTS	Drawn DBC	Authorised / Approved GS
---------------	--------------	--------------------------------