

## HS2 FORM TM1

<b>Highway Authority</b>	Solihull Metropolitan Borough Council
<b>Street(s)/USRN(s)</b>	A452 Chester Road, Northway Island
<b>HS2 Consent Reference</b>	THW.AN.SMBC.LMJV.0147
<b>Contractor document reference</b>	1EW04-LMJ-HW-SCH-N003_NS07-049005
<b>Submission Date (to Highway Authority)</b>	24/04/2019
<b>Proposed start date of consent</b>	02/09/2019
<b>Proposed end date of consent</b>	05/09/2019
<b>Consultation end/ requested response date</b>	Click here to enter a date.
<b>Deemed consent date (if required)</b>	22/05/2019

## Temporary Interference with the Highway

In accordance with the powers set out in the **High Speed Rail (London - West Midlands) Act 2017**, the Contractor, acting on behalf of and, as agent for the Nominated Undertaker, hereby consults the highway authority and/or requests highway authority consent under Schedule 2, 4 and/or 33 as identified below:

<b>Consultation with the highway authority:</b>	
The temporary interference / works is on a street or location that <b>is listed</b> in Table 3 of Schedule 4 to the Act ( <b>Schedule 4 Part 2 paragraph 6</b> )	<input type="checkbox"/>
<b>Consent of the highway authority:</b>	
The temporary interference / works is on a street or location <b>not listed</b> in Table 3 of Schedule 4 of the Act ( <b>Schedule 4 Part 2 paragraph 6</b> )	<input checked="" type="checkbox"/>
<b>Trial holes (Schedule 2 only)</b>	<input type="checkbox"/>
<b>Protective provisions (Schedule 33) [mark as appropriate]</b>	
Works to a bridge requiring temporary interference, ( <b>Schedule 33 para 6</b> )	<input type="checkbox"/>
Alteration/disturbance to apparatus of the highway authority affixed to or placed under any highway or, access to the apparatus of the Highway Authority, ( <b>Schedule 33 Para 9</b> )	<input type="checkbox"/>
Depositing soil or materials or storing plant on the highway ( <b>Schedule 33 Para 12</b> )	<input type="checkbox"/>
Erection of scaffolding or screening (or hoarding) in the highway ( <b>Schedule 33 Para 12</b> )	<input type="checkbox"/>

Table 1. High level summary (mark as appropriate)											
<input type="checkbox"/>	<input type="checkbox"/>	<input type="checkbox"/>	<input type="checkbox"/>	<input type="checkbox"/>	<input type="checkbox"/>	<input type="checkbox"/>	<input type="checkbox"/>	<input type="checkbox"/>	<input type="checkbox"/>	<input type="checkbox"/>	<input type="checkbox"/>
Alteration to apparatus of the highway authority	Deposit of material on the highway	Footway Works only	Peak hours	Works to PRoW	Give and Take	Contra-flow	Lane Closure	<input checked="" type="checkbox"/>	Portable temporary traffic signals (delete as required) 2-way multiphase	Priority working	<input type="checkbox"/>
Trial holes	Erection of scaffolding/hoarding	Works in the carriageway	Off Peak	Street works (NRSWA)	Stop / Go	Signage only	Road Closure	<input type="checkbox"/>	Works to existing or new traffic signals infrastructure	Associated utility works	<input type="checkbox"/>

**Table 2. Detailed works description, traffic management phasing and intended programme**

Road name	Extent of Temporary Interference	Consent or Consultation	USRN	Grid Ref	EToN reference	TM Phase	TM drawing reference	Description of works	Description of associated traffic management	TM operational hours	Proposed Works Start Date	Estimated Works End Date
A452 (N) Chester Rd	A452/A446 Split to Northway Island	Consent	35006662	SP 20611 84156 to SP 20247 84641		Single Phase	CTM/BDW/P493010(2)	Monitoring of a bore hole in the verge	Lane 1 closure on the A452 Chester Road from the A452/A446 Split to Northway Island	8pm to 6am	02/09/2019	05/09/2019
A452 (S) Chester Road	Approach to Northway Island	Consent	35006662	SP 19738 85436		Single Phase	CTM/BDW/P493010(1)	Monitoring of a bore hole in the verge	Lane 2 closure on approach to Northway Island	8pm to 6am	02/09/2019	05/09/2019
A452 Northway Island	Eastern half of Northway Island	Consent	35070156	SP 19871 85391		Single Phase	CTM/BDW/P493010(1)	Monitoring of a bore hole in the verge	Inner partial ring closure of Northway Island	8pm to 6am	02/09/2019	05/09/2019

**Details of pre-application discussions with the Highway Authority and stakeholders**

Date	Details
08/11/2018	Tabled and discussed at the SMBC TLG
Click here to enter a date.	

**Details of associated consents/approvals**

--

**Document references and supporting information**

Title	Phase (from Table 2)	eB reference	Version
A452 Traffic Management Drawing	Single	CTM/BDWP493010(2)	
Northway Island Traffic Management Drawing	Single	CTM/BDWP493010(1)	

**Contractor Signature**

**This submission is made by the Contractor on behalf of and as agent for the Nominated Undertaker.**  
 HS2 Ltd authorises the contractor to submit the application for consultation or, as required, consent of the highway authority  
**[Contractor must obtain acceptance from HS2 before submitting the form to the highway authority]**

<b>Contractor</b>	LM-JV Cornerblock, Two Cornwall Street, Birmingham, B3 2DL
<b>Contractor Authorised Signatory</b>	 Richard Coy
<b>Contractor Site Contact Details</b>	Bridgeway Consulting Ltd Centurion Traffic Management Ltd

## Highway Authority Response Sheet

To be completed by the Highway Authority and provided as a response to the application

<b>HS2 Consent Reference:</b>	
<b>Street(s):</b>	
<b>Submission Date:</b>	
<b>Response Date:</b>	

### Local Highway Authority Response

<b>Highway Authority:</b>	
---------------------------	--

#### Decision on the application by the highway authority, if consent is required:

<b>Consent granted</b> <input checked="" type="checkbox"/>	If consent withheld or consent with comments, state ground(s) below:
<b>Consent granted with comments</b> <input type="checkbox"/>	
<b>Consent withheld</b> <input type="checkbox"/>	
<b>Consultation</b> <input type="checkbox"/>	[Insert comments on consultation]

Signature:  Date: 21.5.19

Name of highway authority's authorised representative: Lisa Parchy

## HS2 FORM TM1

<b>Highway Authority</b>	Solihull Metropolitan Borough Council
<b>Street(s)/USRN(s)</b>	A452 Chester Road, Northway Island
<b>HS2 Consent Reference</b>	THW.AN.SMBC.LMJV.0147
<b>Contractor document reference</b>	1EW04-LMJ-HW-SCH-N003_NS07-049005
<b>Submission Date (to Highway Authority)</b>	24/04/2019
<b>Proposed start date of consent</b>	02/09/2019
<b>Proposed end date of consent</b>	05/09/2019
<b>Consultation end/ requested response date</b>	Click here to enter a date.
<b>Deemed consent date (if required)</b>	22/05/2019

## Temporary Interference with the Highway

In accordance with the powers set out in the **High Speed Rail (London - West Midlands) Act 2017**, the Contractor, acting on behalf of and, as agent for the Nominated Undertaker, hereby consults the highway authority and/or requests highway authority consent under Schedule 2, 4 and/or 33 as identified below:

<b>Consultation with the highway authority:</b>	
The temporary interference / works is on a street or location that <b><u>is listed</u></b> in Table 3 of Schedule 4 to the Act ( <b>Schedule 4 Part 2 paragraph 6</b> )	<input type="checkbox"/>
<b>Consent of the highway authority:</b>	
The temporary interference / works is on a street or location <b><u>not listed</u></b> in Table 3 of Schedule 4 of the Act ( <b>Schedule 4 Part 2 paragraph 6</b> )	<input checked="" type="checkbox"/>
<b>Trial holes (Schedule 2 only)</b>	<input type="checkbox"/>
<b>Protective provisions (Schedule 33)</b> <i>[mark as appropriate]</i>	
Works to a bridge requiring temporary interference, ( <b>Schedule 33 para 6</b> )	<input type="checkbox"/>
Alteration/disturbance to apparatus of the highway authority affixed to or placed under any highway or, access to the apparatus of the Highway Authority, ( <b>Schedule 33 Para 9</b> )	<input type="checkbox"/>
Depositing soil or materials or storing plant on the highway ( <b>Schedule 33 Para 12</b> )	<input type="checkbox"/>
Erection of scaffolding or screening (or hoarding) in the highway ( <b>Schedule 33 Para 12</b> )	<input type="checkbox"/>

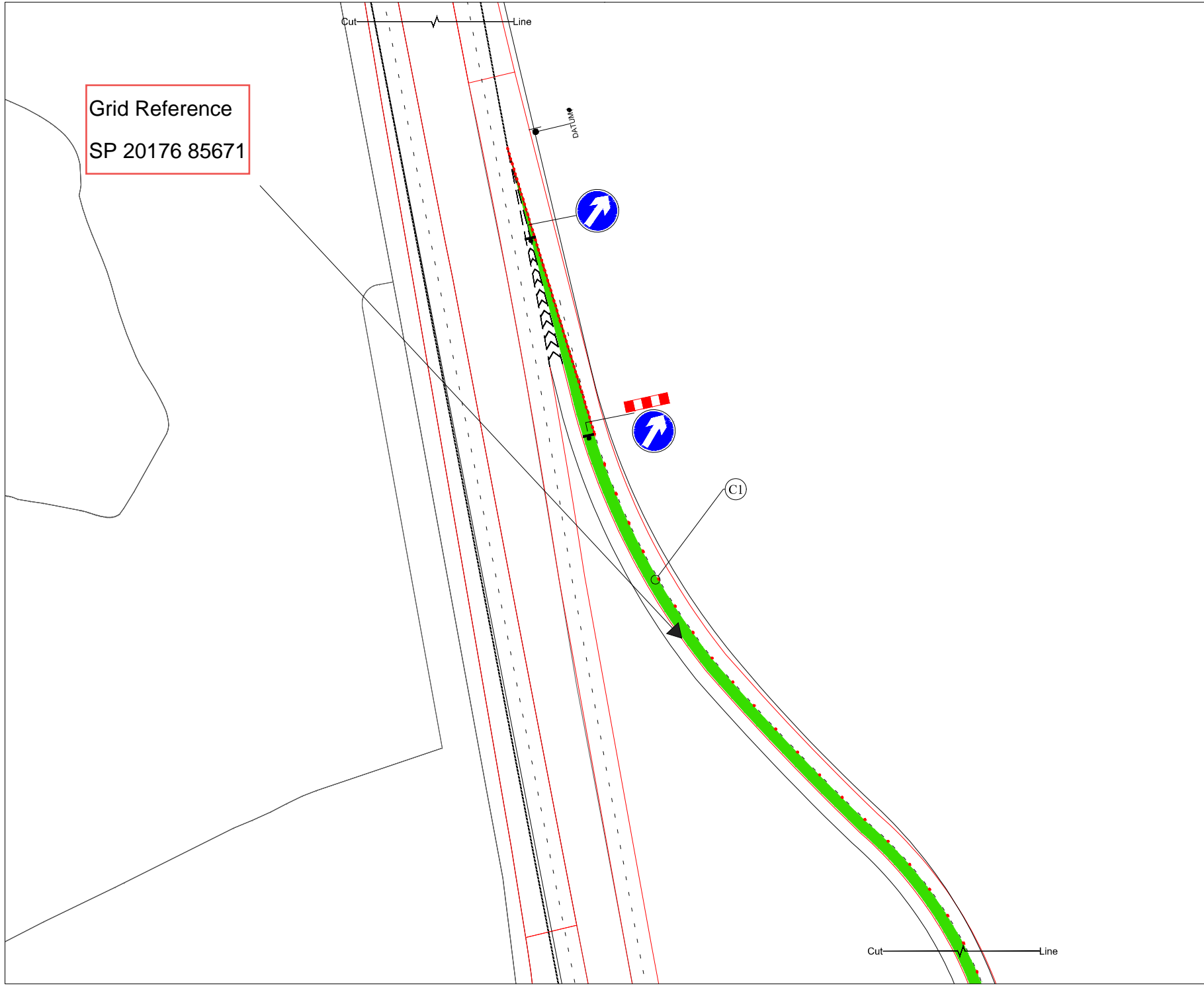

### Notes

- All traffic management in accordance with Chapter 8 and New Roads and Street Works Act.

#### DETAIL B (B)

Single/Dual carriageway 40mph or less - 450mm traffic cones, spacing 1.5m.  
 Single/Dual carriageway 50mph or more - 750mm traffic cones, spacing 1.5m.  
 Dual carriageway national speed limit - 750mm traffic cones, spacing 1.5m, relaxation 5m.

- Notes:
- During darkness, warning lights to BS EN 12352:2006 should be provided in accordance with Table A1.3 (Appendix 1).
  - 45° tapers have 1.5m spacing, no relaxations.
  - On motorways and NSL AP Duals with hard shoulders, 1m cones will be required for both standard and relaxation works for lead tapers and the facing wall of lane changes.

#### DETAIL C1 (C1)

Single/Dual carriageway 40mph or less - 450mm traffic cones, spacing 8m.  
 Single/Dual carriageway 50mph or more - 750mm traffic cones, spacing 8m.

- Notes:
- During darkness, warning lights to BS EN 12352:2006 should be provided in accordance with Table A1.3 (Appendix 1).
  - For relaxation to Detail C1 see Table A1.3 (Appendix 1).

#### DETAIL D (D)

Single/Dual carriageway 40mph or less - 450mm traffic cones, spacing 18m.  
 Single/Dual carriageway 50mph or more - 750mm traffic cones, spacing 18m.

- Notes:
- During darkness, warning lights to BS EN 12352:2006 should be provided in accordance with Table A1.3 (Appendix 1).
  - Detail D applies only to relaxation cases.

Works Area

A		Minor alterations		LB	Checked	Auth	Date
Rev	Details	Drawn	Checked	Auth	Date		

Drawing Status	Submittal
----------------	-----------

Centurion Traffic Management Ltd.  
 Head Office  
 20 Long Park Road  
 Solihull  
 Leicestershire  
 B37 7YU  
 Telephone: 0121 711 2200  
[www.centuriontraffic.com](http://www.centuriontraffic.com)

**TMPlans** TMPlans is a registered trademark of Centurion Traffic Management Ltd.

**LM**  
 Making the Right Choice

Project Title: **HS2 Survey Works**

Drawing Title: **Traffic Management-  
 Solihull Roundabout & A452  
 Solihull Parkway Roundabout Inner Ring Closure**

Scale	1:500	Designed	LB	Drawn	LB	Checked	PW	Authorised
Original Size	A1	Date	27/02/18	Date	27/02/18	Date	27/02/18	Date

Drawing Number	Original	Update	Project Ref. No.
PW	- TMP	- TTM	
B37 7YU	- DR	- CB - 005-2-C	Revision
Location	Type	Date	Number
			A -

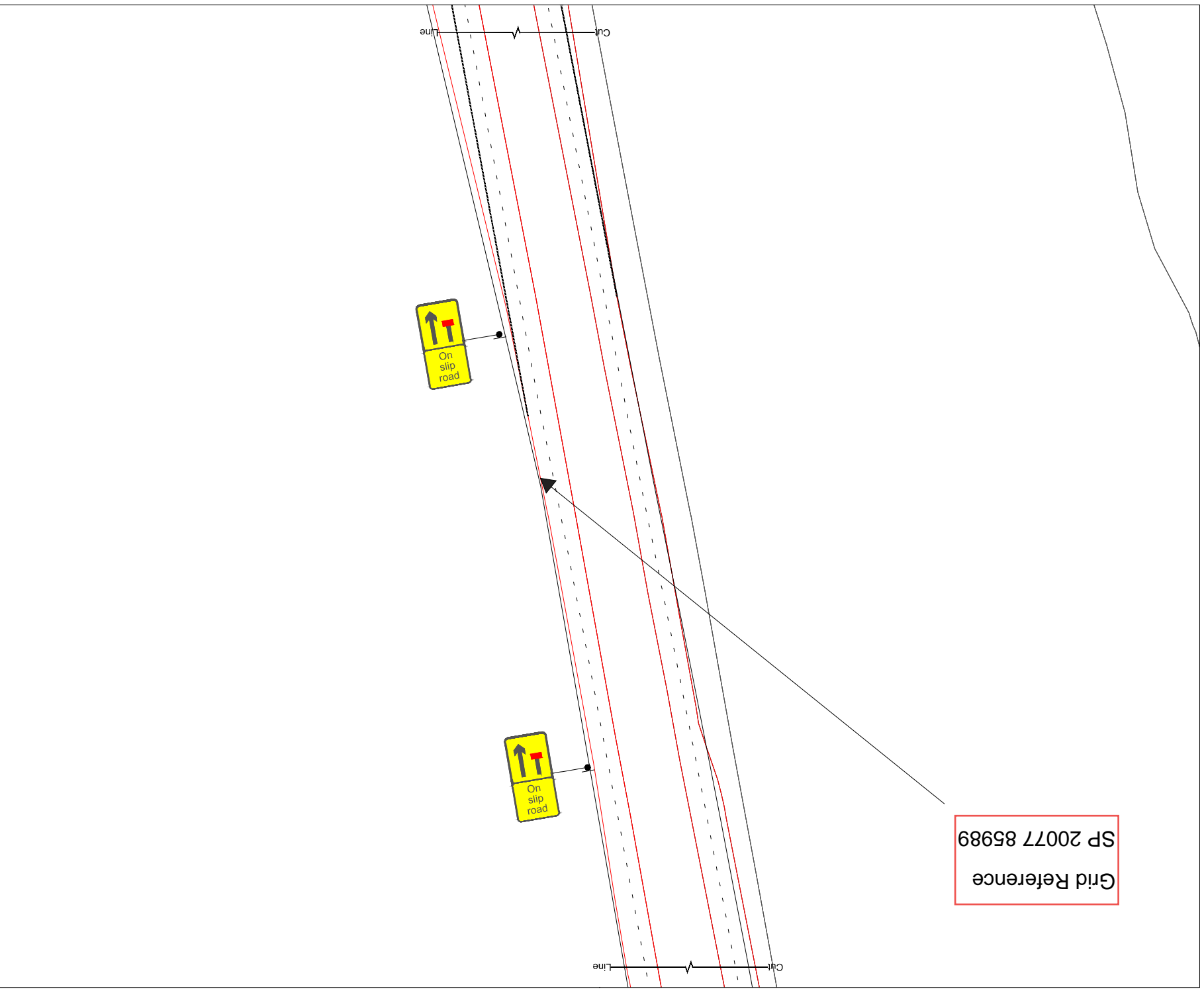

Grid Reference  
SP 20077 85989

**Notes**

1. All traffic management in accordance with Chapter 8 and New Roads and Street Works Act.

**DETAIL B**

Single dual carriageway. Single or more - 750mm traffic cones, spacing 1.5m. Dual carriageway national speed limit - 750mm traffic cones, spacing 1.5m. reduction 5m.

**DETAIL C1**

1) During demolition, warning lights to BS EN 12322-2006 should be provided in accordance with Table A1.3 (Appendix 1).  
2) Off highway lane 1.5m spacing, no vehicles.  
3) On motorway and NLSL APT dual with third shoulders, 1m cones will be required for 15m upstream and 15m downstream.

**DETAIL D**

1) During demolition, warning lights to BS EN 12322-2006 should be provided in accordance with Table A1.3 (Appendix 1).  
2) For relocation to Detail C1 see Table A1.3 (Appendix 1).  
Notes:  
Single dual carriageway. Single or more - 750mm traffic cones.

**Works Area**

Drawing Status					
Rev	Details				
Drawn	Checked				
Appr	Date				
A	Minor alterations	LB			28/02/18

Centurion Traffic Management Ltd.  
 20 South Lane  
 Lutterworth, Leicestershire  
 LE17 7CQ  
 Tel: 01530 217100  
 www.centuriontraffic.com

**TMP**  
 Traffic Management Plans  
 Making the Right Choice

Project Title: H52 Survey Works  
 Drawing Title: Traffic Management - Solihull Roundabout & A452 Solihull Parkway Roundabout Inner Ring Closure

Scale: 1:500  
 Designed: LB  
 Drawn: LB  
 Checked: PW  
 Date: 27/02/18

Client: LM

Project No: A -  
 Drawing No: - TMP - TTM  
 Project Title: B37 7YU - DR - CB - 005-3-C

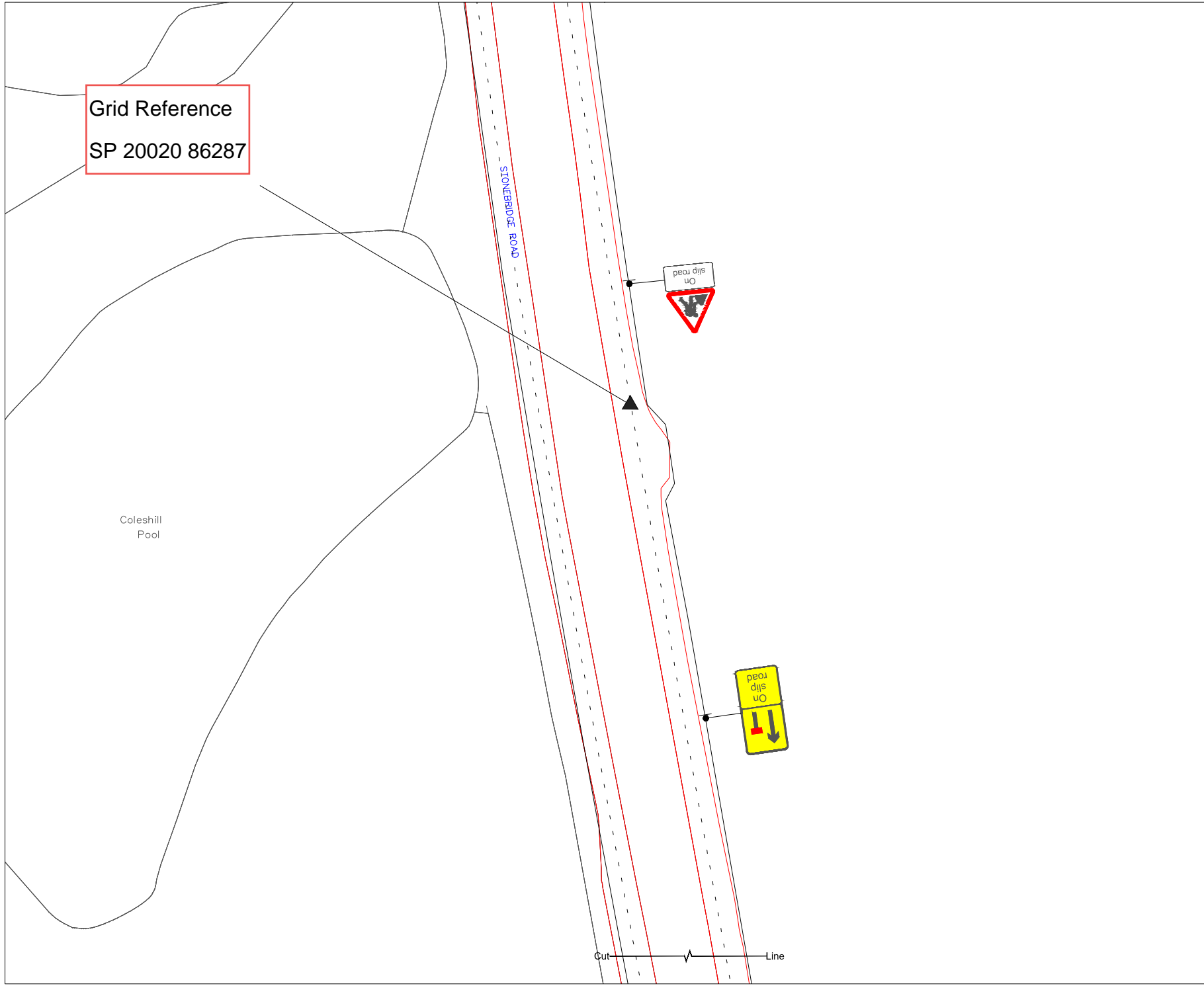

### Notes

- All traffic management in accordance with Chapter 8 and New Roads and Street Works Act.

#### DETAIL B (B)

Single/Dual carriageway 40mph or less - 450mm traffic cones, spacing 1.5m.  
 Single/Dual carriageway 50mph or more - 750mm traffic cones, spacing 1.5m.  
 Dual carriageway national speed limit - 750mm traffic cones, spacing 1.5m, relaxation 5m.

- Notes:
- During darkness, warning lights to BS EN 12352:2006 should be provided in accordance with Table A1.3 (Appendix 1).
  - 45° tapers have 1.5m spacing, no relaxations.
  - On motorways and NSL AP Duals with hard shoulders, 1m cones will be required for both standard and relaxation works for lead tapers and the facing wall of lane changes.

#### DETAIL C1 (C1)

Single/Dual carriageway 40mph or less - 450mm traffic cones, spacing 1.5m.  
 Single/Dual carriageway 50mph or more - 750mm traffic cones, spacing 1.5m.

- Notes:
- During darkness, warning lights to BS EN 12352:2006 should be provided in accordance with Table A1.3 (Appendix 1).
  - For relaxation to Detail C1 see Table A1.3 (Appendix 1).

#### DETAIL D (D)

Single/Dual carriageway 40mph or less - 450mm traffic cones, spacing 1.5m.  
 Single/Dual carriageway 50mph or more - 750mm traffic cones, spacing 1.5m.

- Notes:
- During darkness, warning lights to BS EN 12352:2006 should be provided in accordance with Table A1.3 (Appendix 1).
  - Detail D applies only to relaxation cases.

Works Area

Rev	Details	Drawn	Checked	Auth	Date
A	Minor alterations			LB	28/02/18

Drawing Status	Submittal
----------------	-----------

Centurion Traffic Management Ltd.  
 Head Office  
 20 Long Park Road  
 Solihull  
 Leicestershire  
 B37 7YU  
 Telephone: 0121 711 2200  
[www.centuriontraffic.com](http://www.centuriontraffic.com)

**TMPlans** TMPlans is a registered trademark of Centurion Traffic Management Ltd.

**LM**  
 Making the Right Choice

Project Title: **HS2 Survey Works**

Drawing Title: **Traffic Management-  
 Solihull Roundabout & A452  
 Solihull Parkway Roundabout Inner Ring Closure**

Scale	1:500	Designed	LB	Drawn	LB	Checked	PW	Authorised	
Original Size	A1	Date	27/02/18	Date	27/02/18	Date	27/02/18	Date	

Drawing Number	Originator	Update	Project Ref. No.
B37 7YU	- TMP	- TTM	
Location	Type	Issue	Number
	- DR - CB - 005-4-C		A -



Grid Reference  
SP 19788 85337

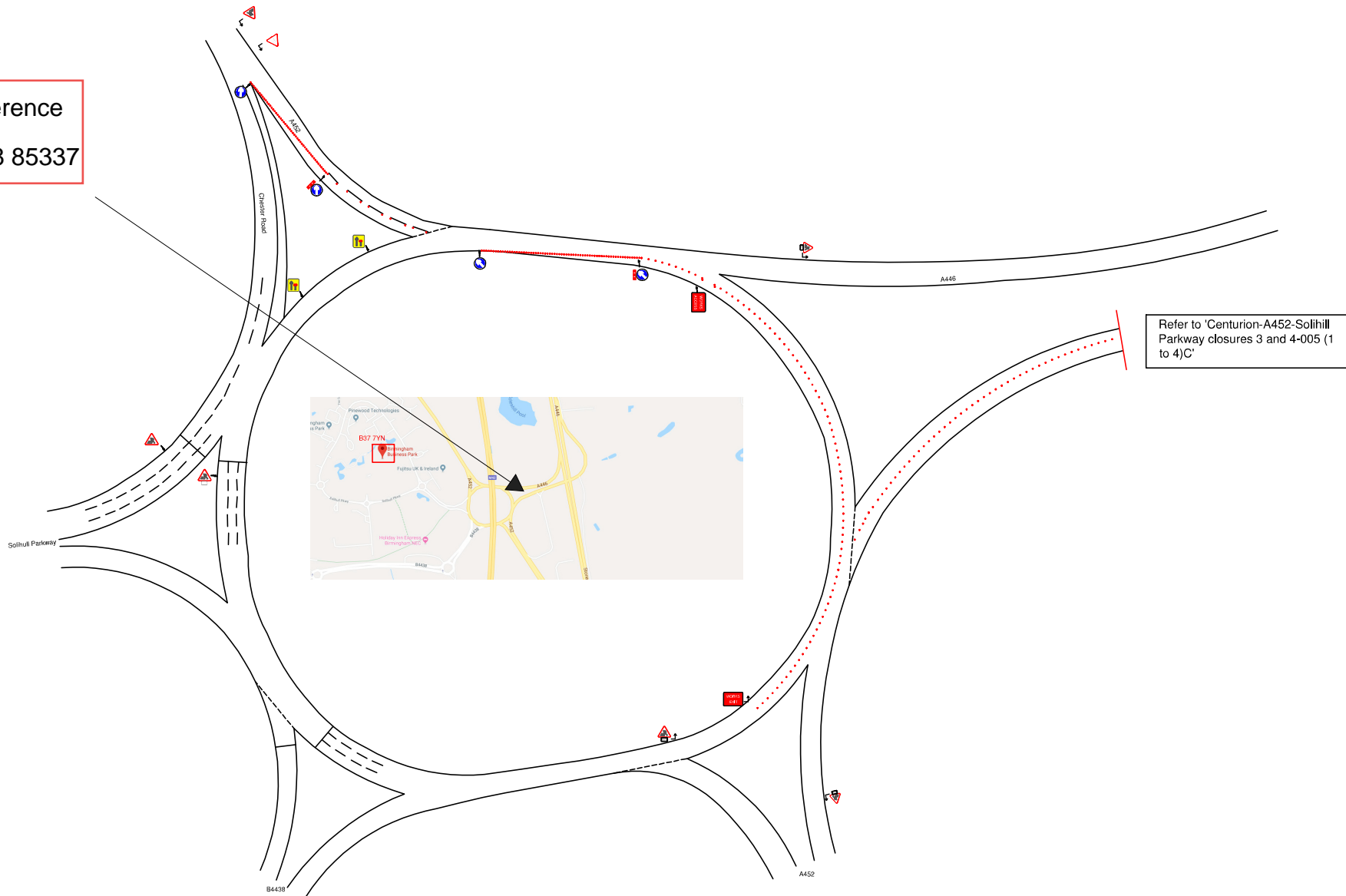

Refer to 'Centurion-A452-Solihull Parkway closures 3 and 4-005 (1 to 4)C'



Centurion Traffic Management  
3B, Haigh Park Road  
Stourton  
Leeds  
LS10 1RT  
Tel: 0113 277 5360  
E-mail: info@centuriontraffic.com  
www.centuriontraffic.com

Date: 07/09/18

Scheme: HS2 SURVEY WORKS, BIRMINGHAM

Traffic Management: LANE 2 CLOSURE

**Notes**  
All layouts drawn in accordance with Chapter 8 guidelines.  
Drawing to be read in conjunction with relevant method statement and risk assessment.  
Please check for amendments before use.

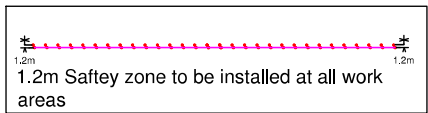
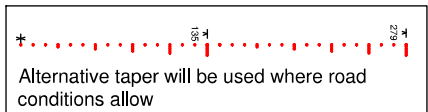

Crown Copyright. All rights reserved.

Drawing No:  
**CTM/WP493010(1)**

Unauthorised reproduction infringes Crown Copyright and may lead to prosecution or civil proceedings.

Scale: NTS	Drawn BD	Authorised / Approved GS
---------------	-------------	--------------------------------



Grid Reference  
SP 20559 84255

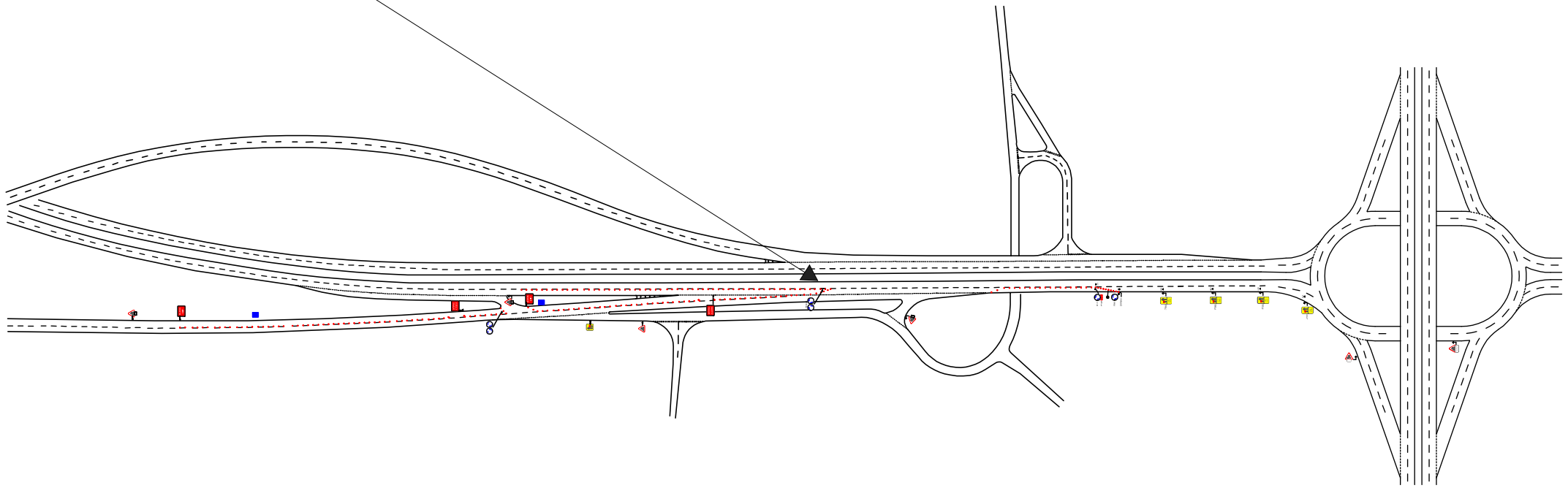

Centurion Traffic Management  
3B, Haigh Park Road  
Stourton  
Leeds  
LS10 1RT  
Tel: 0113 277 5360  
E-mail: info@centuriontraffic.com  
www.centuriontraffic.com

Date: 30-10-18

Scheme: HS2 SURVEY WORKS

Traffic Management: LANE 2 CLOSURE

**Notes**  
All layouts drawn in accordance with Chapter 8 guidelines.  
Drawing to be read in conjunction with relevant method statement and risk assessment.  
Please check for amendments before use.

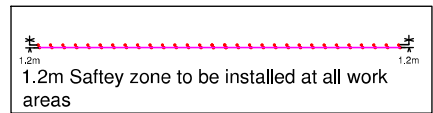
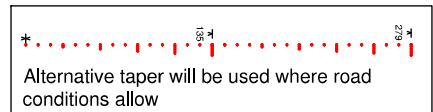

Crown Copyright. All rights reserved.

Drawing No:  
**CTM/BDWP493010(2)**

Unauthorised reproduction infringes Crown Copyright and may lead to prosecution or civil proceedings.

Scale: NTS	Drawn DBC	Authorised / Approved GS
---------------	--------------	--------------------------------