

HS2 FORM TM1

Highway Authority	Solihull Metropolitan Borough Council
Street(s)/USRN(s)	A452 Chester Road, B4438 Bickenhill Parkway
HS2 Consent Reference	THW.AN.SMBC.LMJV.0181
Contractor document reference	1EW04-LMJ-HW-SCH-NS07-060001
Submission Date (to Highway Authority)	27/02/2019
Proposed start date of consent	08/04/2019
Proposed end date of consent	31/12/2020
Consultation end/ requested response date	27/03/2019
Deemed consent date (if required)	Click here to enter a date.

Temporary Interference with the Highway

In accordance with the powers set out in the **High Speed Rail (London - West Midlands) Act 2017**, the Contractor, acting on behalf of and, as agent for the Nominated Undertaker, hereby consults the highway authority and/or requests highway authority consent under Schedule 2, 4 and/or 33 as identified below:

Consultation with the highway authority:	
The temporary interference / works is on a street or location that is listed in Table 3 of Schedule 4 to the Act (Schedule 4 Part 2 paragraph 6)	<input checked="" type="checkbox"/>
Consent of the highway authority:	
The temporary interference / works is on a street or location not listed in Table 3 of Schedule 4 of the Act (Schedule 4 Part 2 paragraph 6)	<input type="checkbox"/>
Trial holes (Schedule 2 only)	<input type="checkbox"/>
Protective provisions (Schedule 33) [mark as appropriate]	
Works to a bridge requiring temporary interference, (Schedule 33 para 6)	<input type="checkbox"/>
Alteration/disturbance to apparatus of the highway authority affixed to or placed under any highway or, access to the apparatus of the Highway Authority, (Schedule 33 Para 9)	<input type="checkbox"/>
Depositing soil or materials or storing plant on the highway (Schedule 33 Para 12)	<input type="checkbox"/>
Erection of scaffolding or screening (or hoarding) in the highway (Schedule 33 Para 12)	<input type="checkbox"/>

Table 1. High level summary <i>(mark as appropriate)</i>	Alteration to apparatus of the highway authority	<input type="checkbox"/>	Deposit of material on the highway	<input type="checkbox"/>	Footway Works only	<input type="checkbox"/>	Peak hours	<input type="checkbox"/>	Works to PRoW	<input type="checkbox"/>	Give and Take	<input type="checkbox"/>	Contra - flow	<input type="checkbox"/>	Lane Closure	<input checked="" type="checkbox"/>	Portable temporary traffic signals (<i>delete as required</i>) 2-way multiphase	<input type="checkbox"/>	Priority working	<input type="checkbox"/>
	Trial holes	<input type="checkbox"/>	Erection of scaffolding/hoarding	<input type="checkbox"/>	Works in the carriageway	<input type="checkbox"/>	Off Peak	<input type="checkbox"/>	Street works (NRSWA)	<input type="checkbox"/>	Stop / Go	<input type="checkbox"/>	Signage only	<input checked="" type="checkbox"/>	Road Closure	<input type="checkbox"/>	Works to existing or new traffic signals infrastructure	<input type="checkbox"/>	Associated utility works	<input type="checkbox"/>

Table 2. Detailed works description, traffic management phasing and intended programme

Road name	Extent of Temporary Interference	Consent or Consultation	USRN	Grid Ref	EToN reference	TM Phase	TM drawing reference	Description of works	Description of associated traffic management	TM operational hours	Proposed Works Start Date	Estimated Works End Date
B4438 Bickenhill Parkway	Northway Island to Holiday Inn Roundabout	Consult	35006577	SP 19718 85247 to SP 18958 85002	NA	Single Phase	009	Construction of works access	Lane closure	9.30am to 3.30pm	15/04/2019	24/05/2019
B4438 Bickenhill Parkway	Northway Island to Holiday Inn Roundabout	Consult	35006577	SP 19718 85247 to SP 18958 85002	NA	Single Phase	1EW04-LMJ_DJV-HW-DSE-NS07-005361	Works access signage	Works access signage	24/7	15/04/2019	31/12/2020
A452 Chester road	A446 to Northway Island	Consult	35006662	SP 20434 84393 to SP 19830 85243	NA	Single Phase	006	Construction of works access	Lane Closure	9.30am to 3.30pm	08/04/2019	31/05/2019
A452 Chester road	A446 to Northway Island	Consult	35006662	SP 20434 84393 to SP 19830 85243	NA	Single Phase	010	Construction of works access	Lane Closure	9.30am to 3.30pm	08/04/2019	29/06/2019
A452 Chester road	A446 to Northway Island	Consult	35006662	SP 20434 84393 to SP 19830 85243	NA	Single Phase	1EW04-LMJ_DJV-HW-DSE-NS07-005362	Construction of works access	Works access signage	24/7	08/04/2019	31/12/2020

Note:
 Either the A452 or A446/A446 combined TM drawing will be installed at any one time.

Error! Reference source not found.

Schedule 4 Part 2 paragraph 6 – Temporary Interference

Schedule 33 Part 1, Schedule 2 Part 1

Form TM 1 - PH1-HS2-CL-TEM-000-000001 [Revision Po4]

HS2

Details of pre-application discussions with the Highway Authority and stakeholders	
Date	Details
18/01/2019	Meeting held between LM & SMBC to discuss works access construction and schedule 17 lorry routes.
14/02/2019	Details tabled at SMBC TLG
Click here to enter a date.	

Details of associated consents/approvals
Schedule 4 part 1 will be submitted separately for the construction of works access.

Document references and supporting information			
Title	Phase (from Table 2)	Drawing reference	Version
B4438 Lane closure		009	
B4438 road signs and posts		1EW04-LMJ_DJV-HW-DSE-NS07-005361	P02
A452 Chester road Lane closure		006	
A452 & A446 combined lane closure		010	
A452 road signs and posts		1EW04-LMJ_DJV-HW-DSE-NS07-005362	P02

Error! Reference source not found.

Schedule 4 Part 2 paragraph 6 – Temporary Interference

Schedule 33 Part 1, Schedule 2 Part 1

Form TM 1 - PH1-HS2-CL-TEM-000-000001 [Revision P04]



Contractor Signature

This submission is made by the Contractor on behalf of and as agent for the Nominated Undertaker.

HS2 Ltd authorises the contractor to submit the application for consultation or, as required, consent of the highway authority

[Contractor must obtain acceptance from HS2 before submitting the form to the highway authority]

Contractor	LM-JV Cornerblock, Two Cornwall Street, Birmingham, B3 2DX
Contractor Authorised Signatory	 Wayne Skells, Traffic Manager
Contractor Site Contact Details	LME

Highway Authority Response Sheet

To be completed by the Highway Authority and provided as a response to the application

HS2 Consent Reference:	
Street(s):	
Submission Date:	
Response Date:	

Local Highway Authority Response	
Highway Authority:	
Decision on the application by the highway authority, if consent is required:	
Consent granted <input type="checkbox"/>	If consent withheld or consent with comments, state ground(s) below:
Consent granted with comments <input type="checkbox"/>	
Consent withheld <input type="checkbox"/>	
Consultation <input checked="" type="checkbox"/>	<p><i>[Insert comments on consultation]</i></p> <p>please make sure Lane closures are only erected off peak for the timings listed within this application. where possible, please use 'solar powered' signs (especially for the 'left turn only' and 'give way' way.</p>
Signature: <u></u>	Date: <u>07.03.19</u>
Name of highway authority's authorised representative: <u>Lisa Pardy</u>	

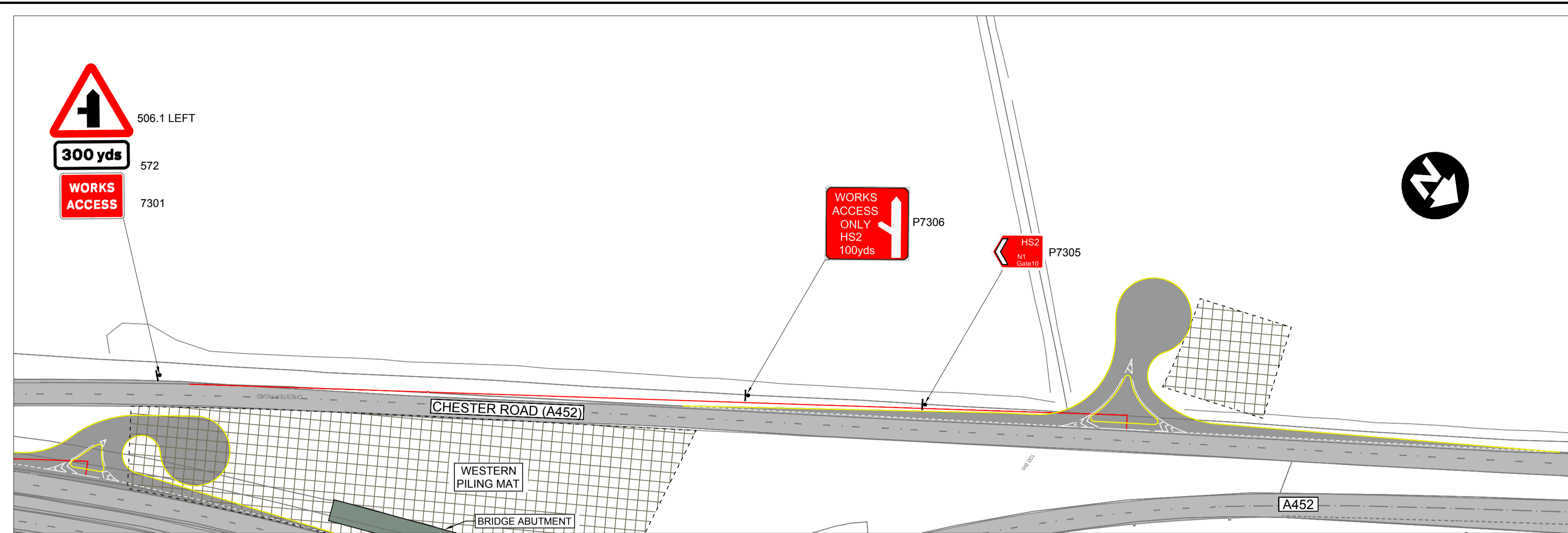

LEGEND	
SET DOWN AREA	
CHESTER ROAD (A452)	
PROPOSED ACCESS ROADS TO COMPOUNDS	
SINGLE AND DOUBLE POSTS	



Signing Project	A446-NB, A446-SB AND A452	SIGN REFERENCE:	TS6
Sign Reference	P7306	Width (mm)	1000
x Height		Height (mm)	1200
Material		Area (m²)	5.05
		Background	Red
		Border	White
		Legend	White

Structural Calculation Details

Signs:
Reference: TS6 - P7306 (VARIATION)
Width: 1200mm, Height: 1000mm
Shape: Rectangle
Orientation: Facing front
Mounted on posts: 1, 2
Mounting height: 2400mm, at post

Posts:
Quantity: 2
Type: 160 x 80 x 5.0 RHS
Spacing: 1440mm
Post 1 Length: 5000mm
Post 2 Length: 5000mm

Base:
Type: Planted
Diameter: 410mm
Depth: 1317mm
Volume: 0.35cu.m
Earth cover: 150mm

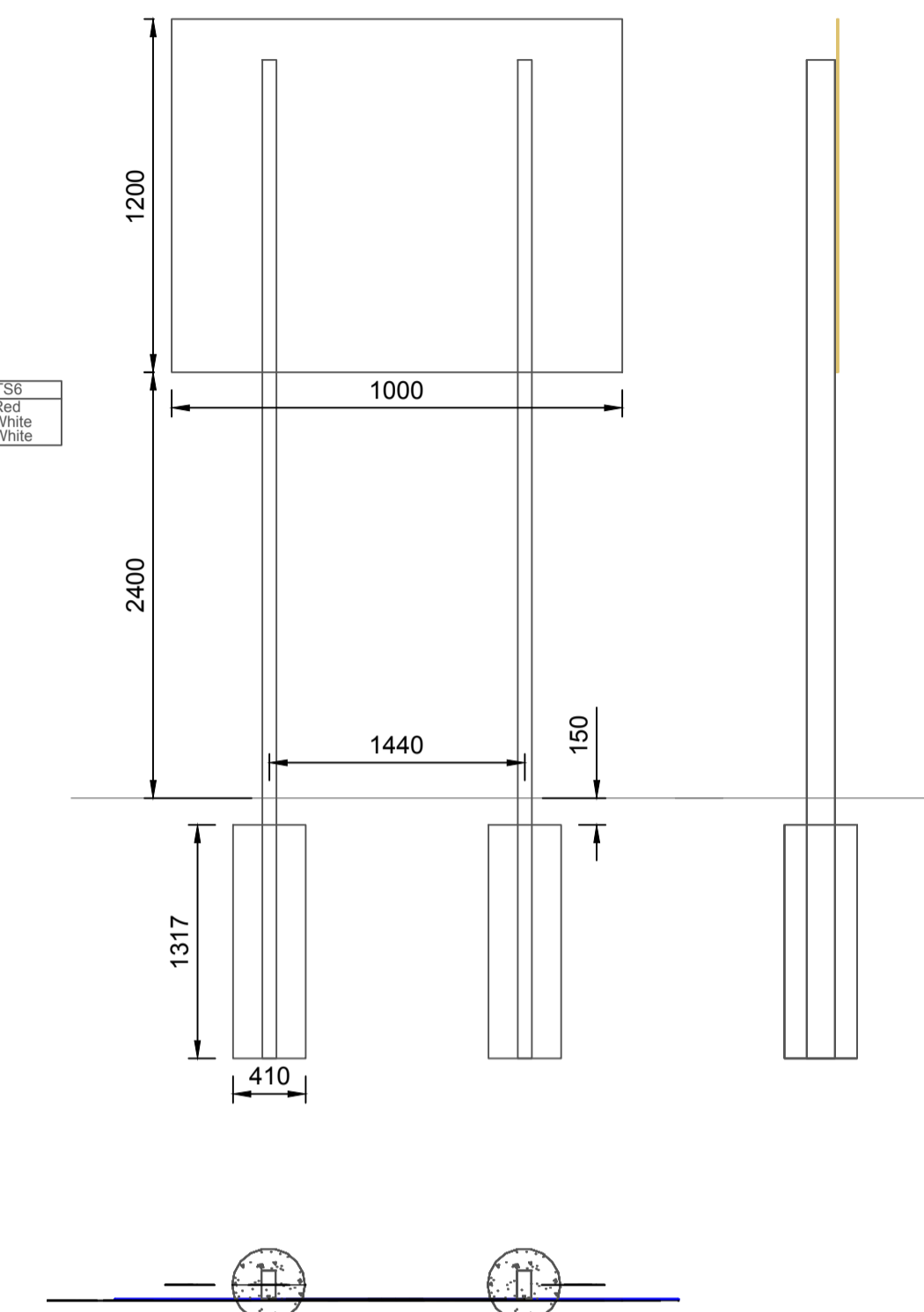

TRAFFIC SIGNS SCHEDULE	
TS6	DIRECTIONAL SIGN (1200 X 1000)
TS6	
TS6	P7603

TRAFFIC SIGNS SCHEDULE			
TS1	DIA 506.1 / SIDE ROAD AHEAD (1020 X 900)		506.1
TS2	DIA 572 / DISTANCE AHEAD TO HAZARD (VARIES)		572
TS3	DIA 511 / WORKS ACCESS		7301
TS6	ROADWORKS DIRECTION (1780 X 475)		P7305

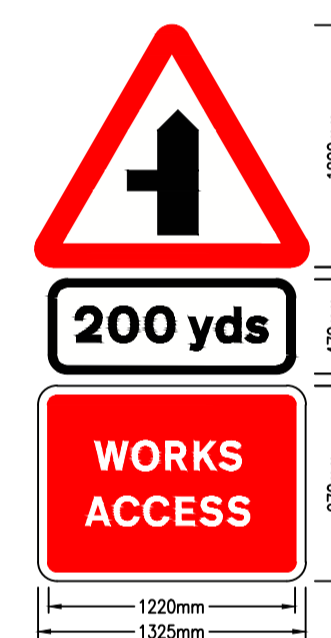

Signing Project	A452 & A446 ACCESS JUNCTIONS	SIGN REFERENCE:	TS1
Sign Reference	Sign: 506.1	Width (mm)	1360
x Height		Height (mm)	1200
Material		Area (m²)	0.96
		Background	White
		Border	Red
		Legend	Black

Signing Project	A452 & A446 ACCESS JUNCTIONS	SIGN REFERENCE:	TS2
Sign Reference	Sign: 572	Width (mm)	1220
x Height		Height (mm)	470
Material		Area (m²)	0.57
		Background	White
		Border	Black
		Legend	Black

Signing Project	A452 & A446 ACCESS JUNCTIONS	SIGN REFERENCE:	TS3
Sign Reference	Sign: 7301	Width (mm)	1325
x Height		Height (mm)	970
Material		Area (m²)	1.29
		Background	Red
		Border	White
		Legend	White

Structural Calculation Details

Signs: TS1
Width: 600mm, Height: 600mm
Shape: Roundel
Orientation: Facing front
Mounted on posts: 1
Mounting height: 1875mm, at post

Signs: TS2 & TS3
Width: 850mm, Height: 360mm
Shape: Rectangle
Orientation: Facing front
Mounted on posts: 1
Mounting height: 1500mm, at post

Posts:
Quantity: 1
Type: 88.8 x 3.2 CHS
Spacing: N/A
Post 1 Length: 4050mm

Base:
Type: Planted
Diameter: 400mm
Depth: 800mm
Volume: 0.10cu.m
Earth cover: 150mm

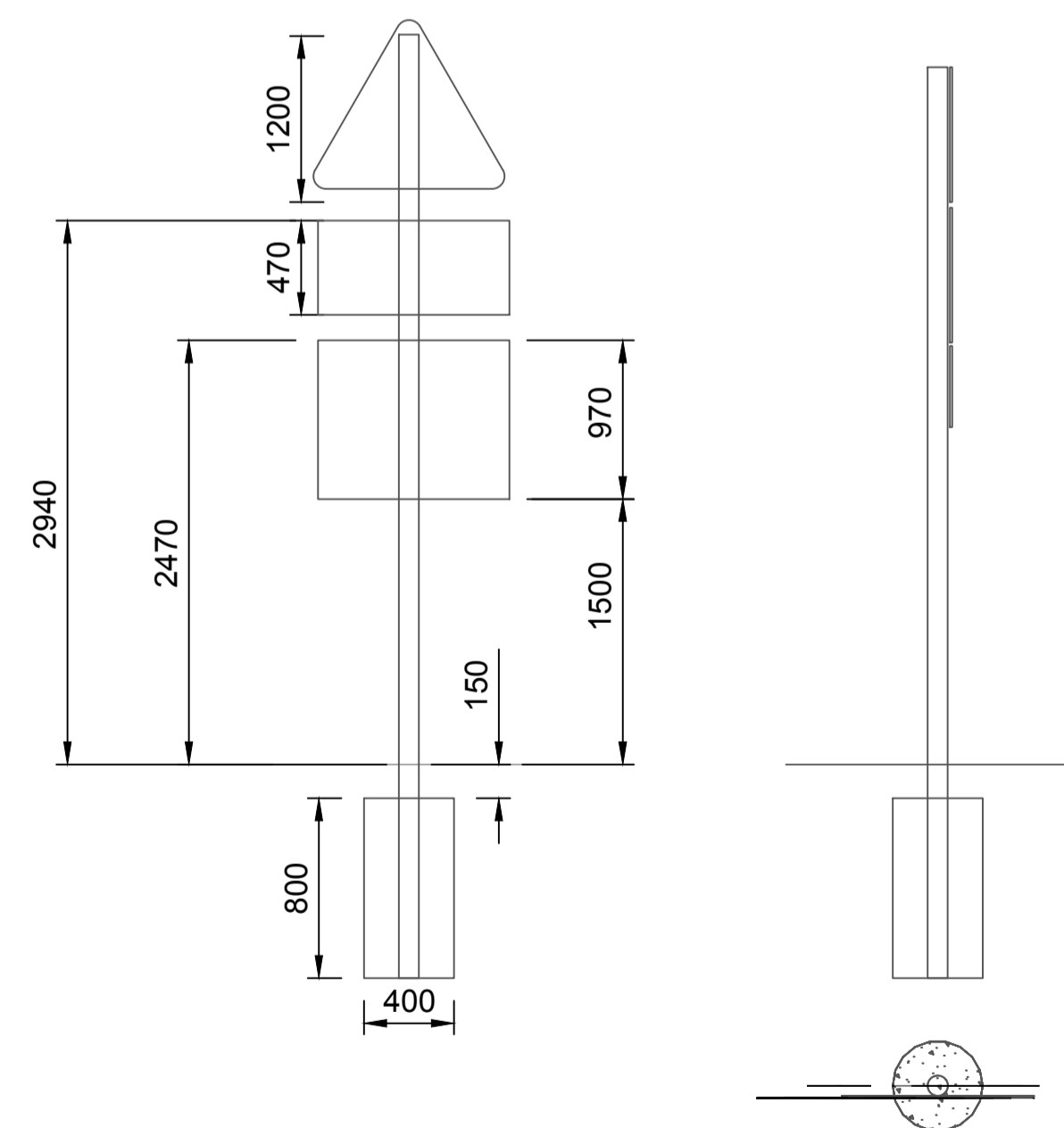

Signing Project	A446-NB, A446-SB AND A452	SIGN REFERENCE:	TS7
Sign Reference	P7305	Width (mm)	1780
x Height		Height (mm)	475
Material		Area (m²)	0.6
		Background	Red
		Border	White
		Legend	White

Structural Calculation Details

Signs:
Reference: TS7 - P7305 (VARIATION)
Width: 1780mm, Height: 475mm
Shape: Rectangle with Directional
Orientation: Facing front
Mounted on posts: 1
Mounting height: 1900mm, at post

Posts:
Quantity: 2
Type: 160 x 80 x 5.0 LHS
Spacing: 1480mm
Post 1 Length: 6594mm
Post 2 Length: 6594mm

Base:
Type: Planted
Diameter: 450mm
Depth: 1400mm
Volume: 0.45cu.m
Earth cover: 150mm

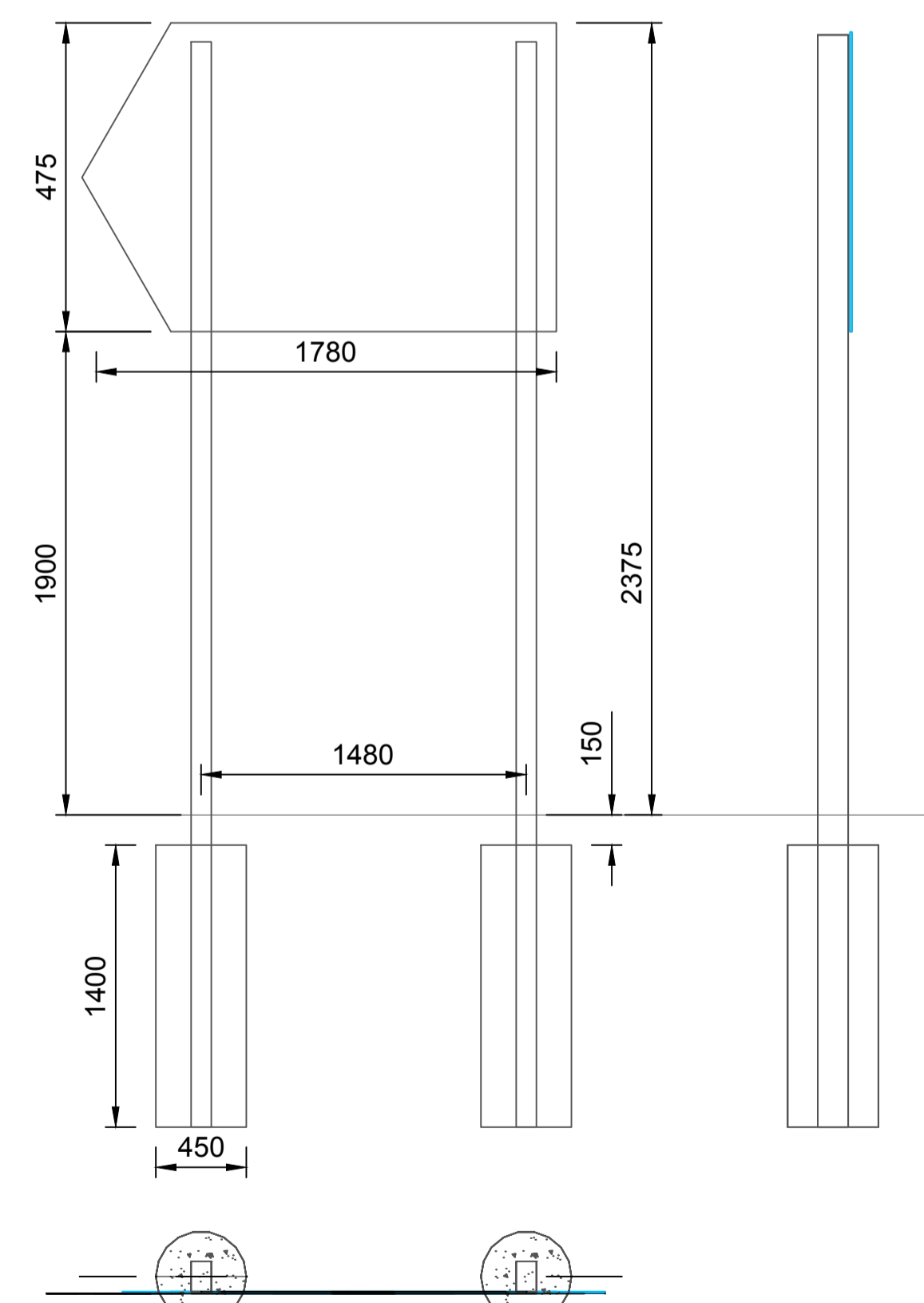

Fit for Approval

Rev	Description	Drawn	Checked	Approved	LM App	HS2 Acc	Scale with caution as distortion can occur.
P02	Fit for Approval	TVS	MMU	LGA	---	---	HS2 accepts no responsibility for any circumstances which arise from the reproduction of this document after alteration, amendment or abbreviation or if it is issued in part or issued incompletely in any way.
P01	Fit for Information	TVS	MMU	LGA	---	---	© Crown Copyright and database right 2017. All rights reserved. Ordnance Survey Licence number: 100049190
							© Crown Copyright material is reproduced with the permission of Land Registry under delegated authority from the Controller of HMSO.
							This material was last updated on 2017 and may not be copied, distributed, sold or published without the formal permission of Land Registry. Only an official copy of a title plan or register obtained from the Land Registry may be used for legal or other official purposes.

Legends/Notes:	

HS2

Registered in England
Registration No. 06791686
Registered office:
2 Snow Hill, Queensway,
Birmingham, B4 6GA

OFFICIAL

Creator/Organiser
LM JV

Suitability Code/Description	Project/Contract		
S4 - Issued for LM Approval	HS2 Phase 1 Enabling Works North		
Design Stage	Discipline/Function		
5 - Detailed Design	Highways		
Drawing Title	Drawn	Checked	Approved
WP005	T.VanStraten	M.Muthen	L.Gamadeku
Birmingham Interchange Station	Date	Scale	Size
Road Signs and Posts	23/02/19	AS SHOWN	A1
A452 Area B	Drawing No.	Rev.	
	1EW04-LMJ_DJV-HW-DSE-NS07-005362	P02	

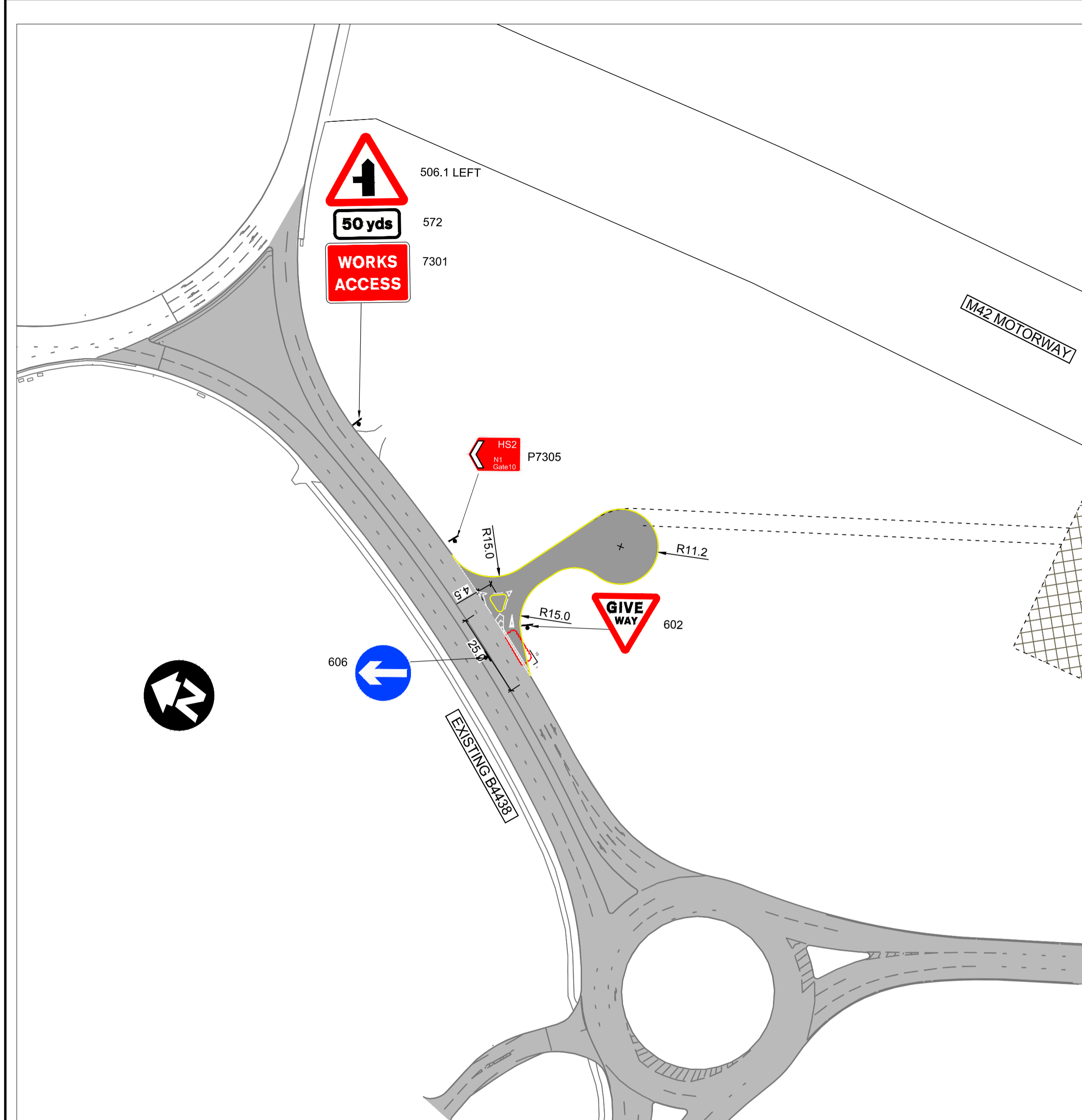

Sign Reference	Width (mm)	Height (mm)	Background	Border	Legend
P7305	1780	475	Red	White	White

Structural Calculation Details

Signs:
 Reference: TS7 - P7305 (VARIATION)
 Width: 1780mm, Height: 475mm
 Shape: Rectangle with Directional
 Orientation: Facing front
 Mounted on posts: 1
 Mounting height: 1900mm, at post

Posts:
 Quantity: 2
 Type: 160 x 80 x 5.0 LHS
 Spacing: 1480mm
 Post 1 Length: 6594mm
 Post 2 Length: 6594mm

Base:
 Type: Planted
 Diameter: 450mm
 Depth: 1400mm
 Volume: 0.45cu.m
 Earth cover: 150mm

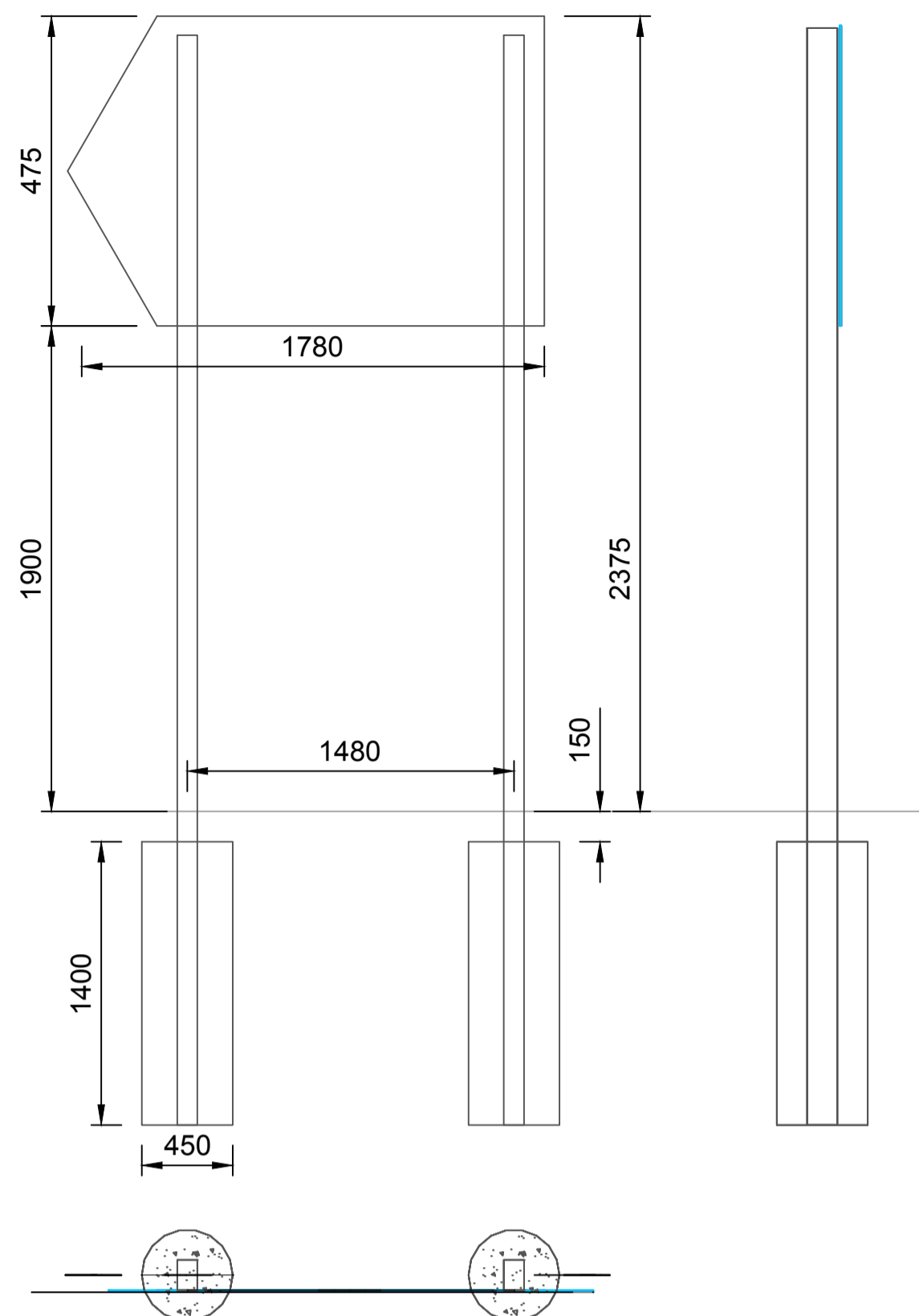

Sign Reference	Width (mm)	Height (mm)	Background	Border	Legend
SIGN: 606	600	600	White	Blue	Black

Structural Calculation Details

Signs:
 Reference: NRS08_1
 Width: 600mm, Height: 600mm
 Shape: Roundel
 Orientation: Facing front
 Mounted on posts: 1
 Mounting height: 1500mm, at post

Posts:
 Quantity: 1
 Type: 48.3 x 3.2 CHS
 Spacing: N/A
 Post 1 Length: 3170mm

Base:
 Type: Planted
 Diameter: 300mm
 Depth: 800mm
 Volume: 0.06cu.m
 Earth cover: 150mm

Illumination:
 Orientation: Facing front
 Light on posts: 1

LEGEND	
B4438 INTERNAL ACCESS RD/PILING MAT	
EXISTING B4438	
PROPOSED ACCESS ROAD TO COMPOUNDS	
SINGLE AND DOUBLE POSTS	

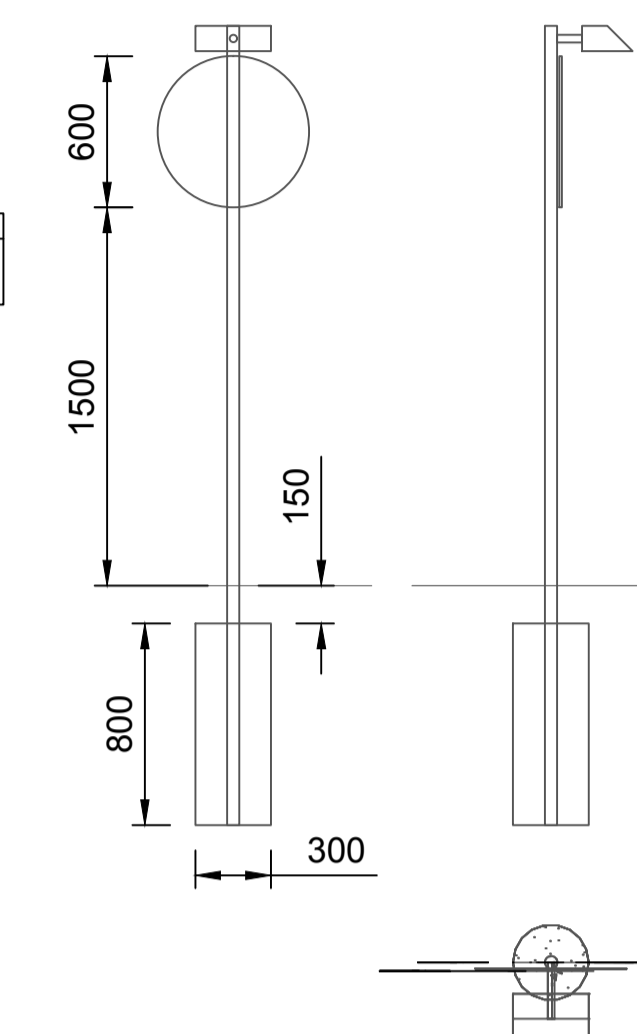

Sign Reference	Width (mm)	Height (mm)	Background	Border	Legend
SIGN: 602	1020	900	White	Red	Black

Structural Calculation Details

Signs:
 Reference: Sign TS4
 Width: 1020mm, Height: 430mm
 Shape: Rectangle
 Orientation: Facing front
 Mounted on posts: 1
 Mounting height: 1500mm, at post

Posts:
 Quantity: 1
 Type: 60.3 x 3.2 CHS
 Spacing: N/A
 Post 1 Length: 3750mm

Base:
 Type: Planted
 Diameter: 400mm
 Depth: 800mm
 Volume: 0.1cu.m
 Earth cover: 100mm

Illumination:
 Orientation: Facing front
 Light on posts: 1

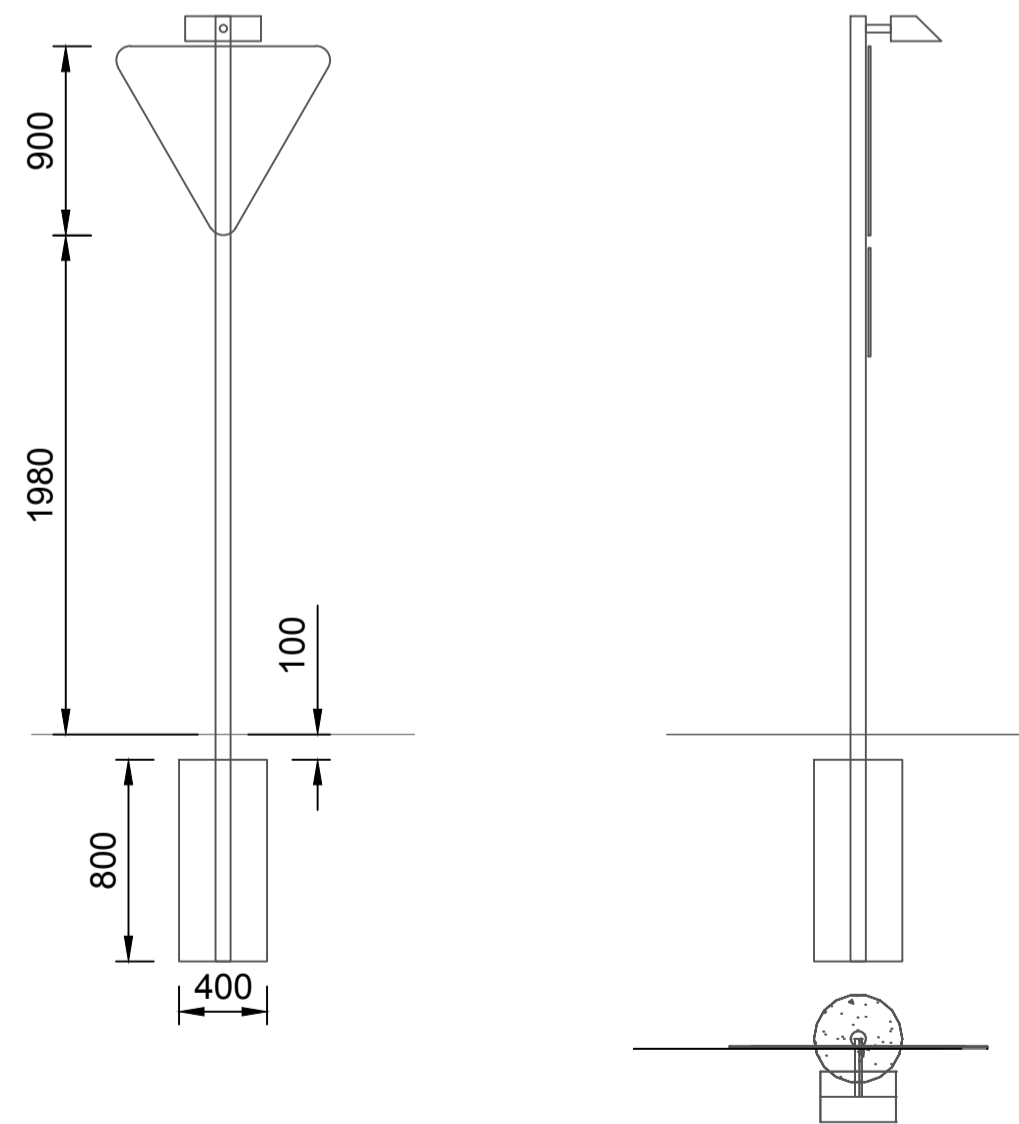

Sign Reference	Width (mm)	Height (mm)	Background	Border	Legend
SIGN: 506.1	1350	1200	White	Red	Black

Sign Reference	Width (mm)	Height (mm)	Background	Border	Legend
SIGN: 572	1250	470	White	Black	Black

Sign Reference	Width (mm)	Height (mm)	Background	Border	Legend
SIGN: 7301	1325	970	Red	White	White

Structural Calculation Details

Signs: TS1
 Width: 600mm, Height: 600mm
 Shape: Roundel
 Orientation: Facing front
 Mounted on posts: 1
 Mounting height: 1875mm, at post

Signs: TS2 & TS3
 Width: 850mm, Height: 360mm
 Shape: Rectangle
 Orientation: Facing front
 Mounted on posts: 1
 Mounting height: 1500mm, at post

Posts:
 Quantity: 1
 Type: 88.9 x 3.2 CHS
 Spacing: N/A
 Post 1 Length: 4050mm

Base:
 Type: Planted
 Diameter: 400mm
 Depth: 800mm
 Volume: 0.10cu.m
 Earth cover: 150mm

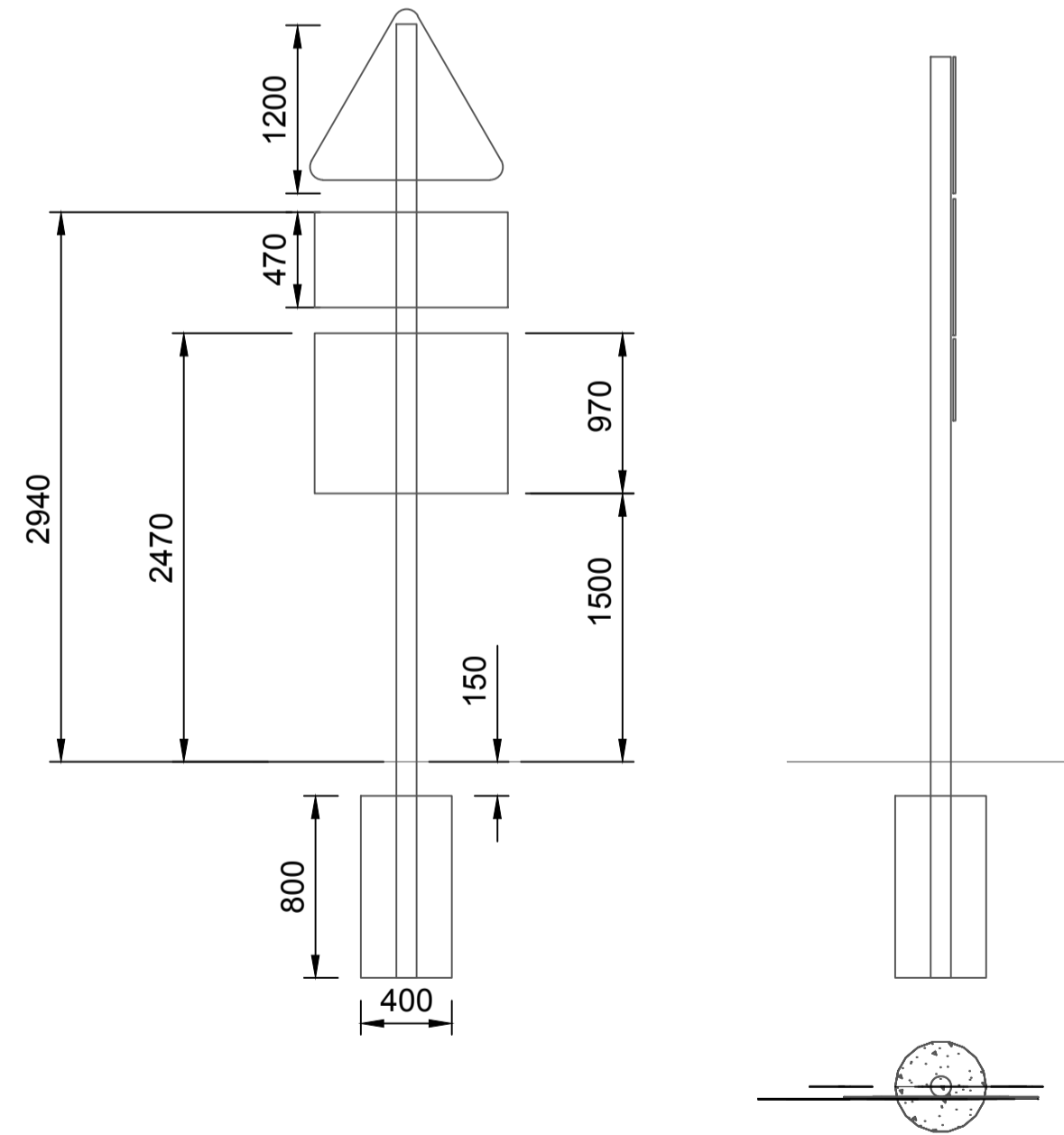

TRAFFIC SIGNS SCHEDULE		
TS1	DIA 506.1 / SIDE ROAD AHEAD (1020 X 900)	506.1
TS2	DIA 572 / DISTANCE AHEAD TO HAZARD (VARIES)	572
TS3	DIA 511 / WORKS ACCESS	7301
TS4	DIA 602 GIVE WAY / 900	602
TS5	DIA 606 / LIMITED MOVEMENT / 900	606

Fit for Approval

Rev	Description	Drawn	Checked	Approved	LM App	HS2 Acc	Scale with caution as distortion can occur.
P02	Fit for Approval	TVS	MMU	LGA			HS2 accepts no responsibility for any circumstances which arise from the reproduction of this document after alteration, amendment or abbreviation or if it is issued in part or issued incompletely in any way.
P01	Fit for Information	TVS	MMU	LGA			© Crown Copyright and database right 2017. All rights reserved. Ordnance Survey Licence number 100049190
							© Crown Copyright material is reproduced with the permission of Land Registry under delegated authority from the Controller of HMSO.
							This material was last updated on 2017 and may not be copied, distributed, sold or published without the formal permission of Land Registry. Only an official copy of a title plan or register obtained from the Land Registry may be used for legal or other official purposes.

Legends/Notes:

Registered in England
 Registration No. 06791686
 Registered office:
 2 Snow Hill, Queensway,
 Birmingham, B4 6GA

OFFICIAL

Creator/Oriinator
 LM JV

Suitability Code/Description	Project/Contract		
S4 - Issued for LM Approval	HS2 Phase 1 Enabling Works North		
Design Stage	Discipline/Function		
5 - Detailed Design	Highways		
Drawing Title	Drawn	Checked	Approved
WP005	T.VanStraten	M.Muthen	L.Gamadeku
Birmingham Interchange Station	Date	Scale	Size
Road Signs and Posts	23/02/19	AS SHOWN	A1
B4438-Area A	Drawing No.	Rev.	
	1EW04-LMJ_DJV-HW-DSE-NS07-005361	P02	

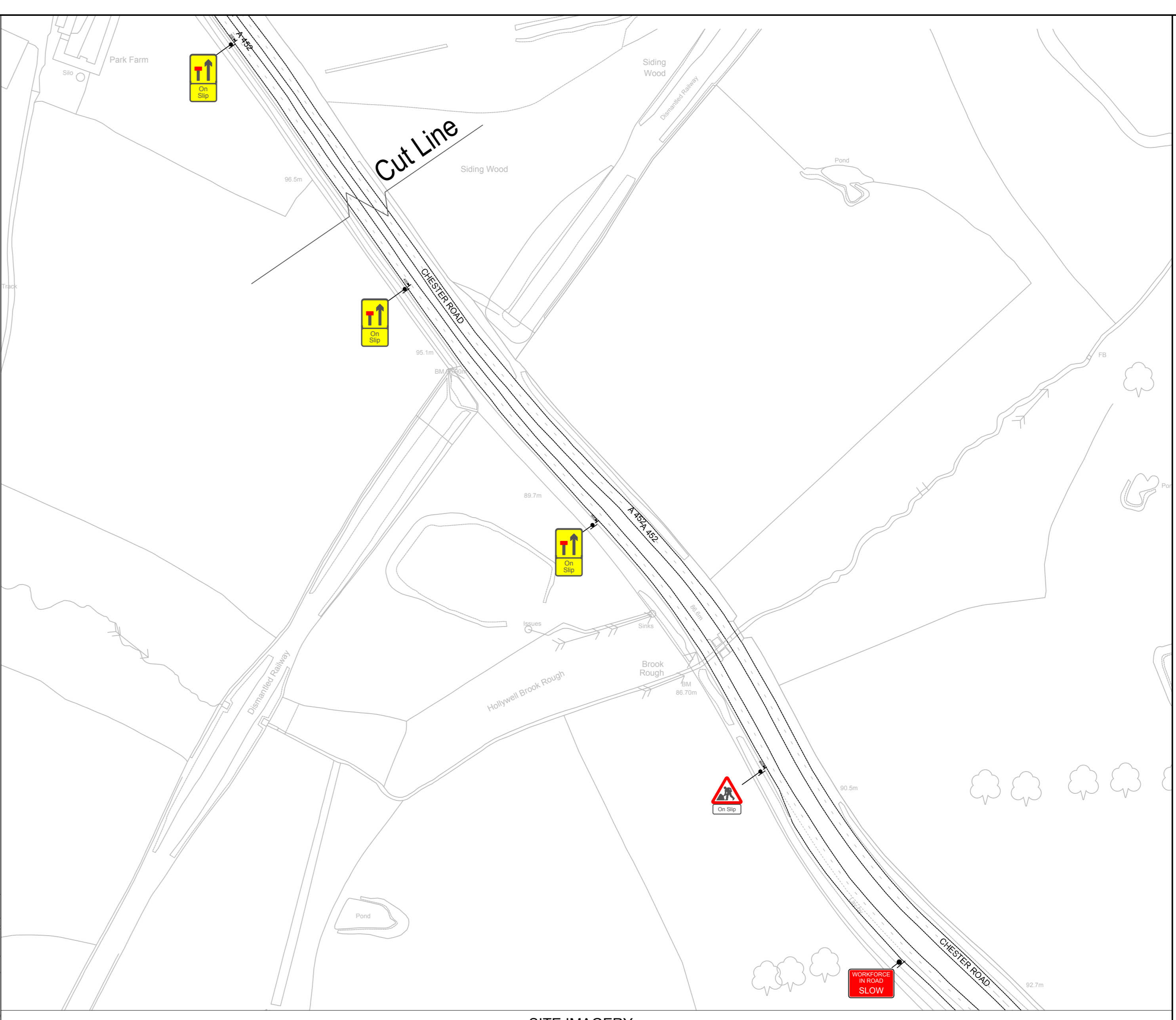
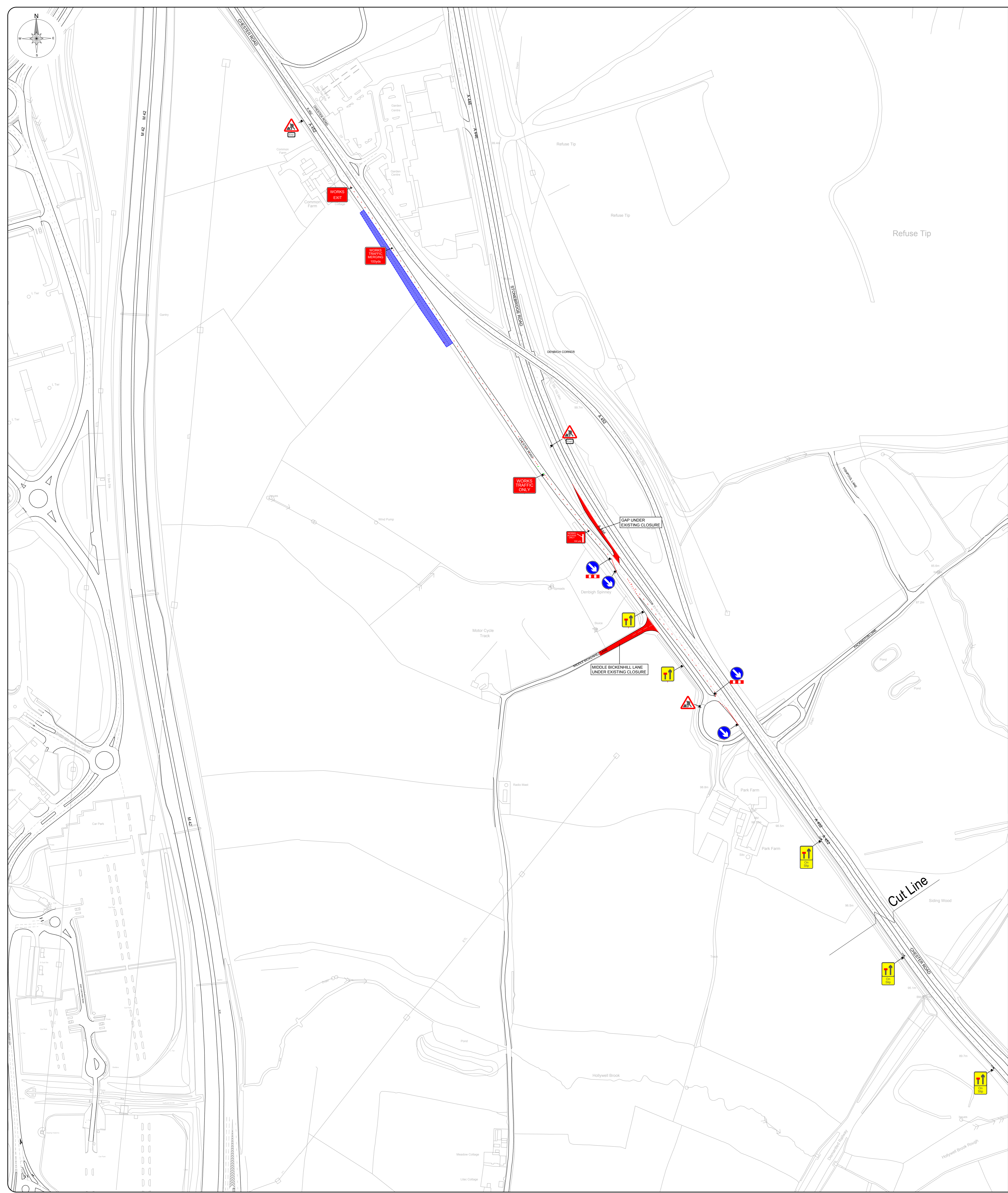

SITE IMAGERY



EXISTING ACCESS POINT



POINT A



POINT B



POINT C

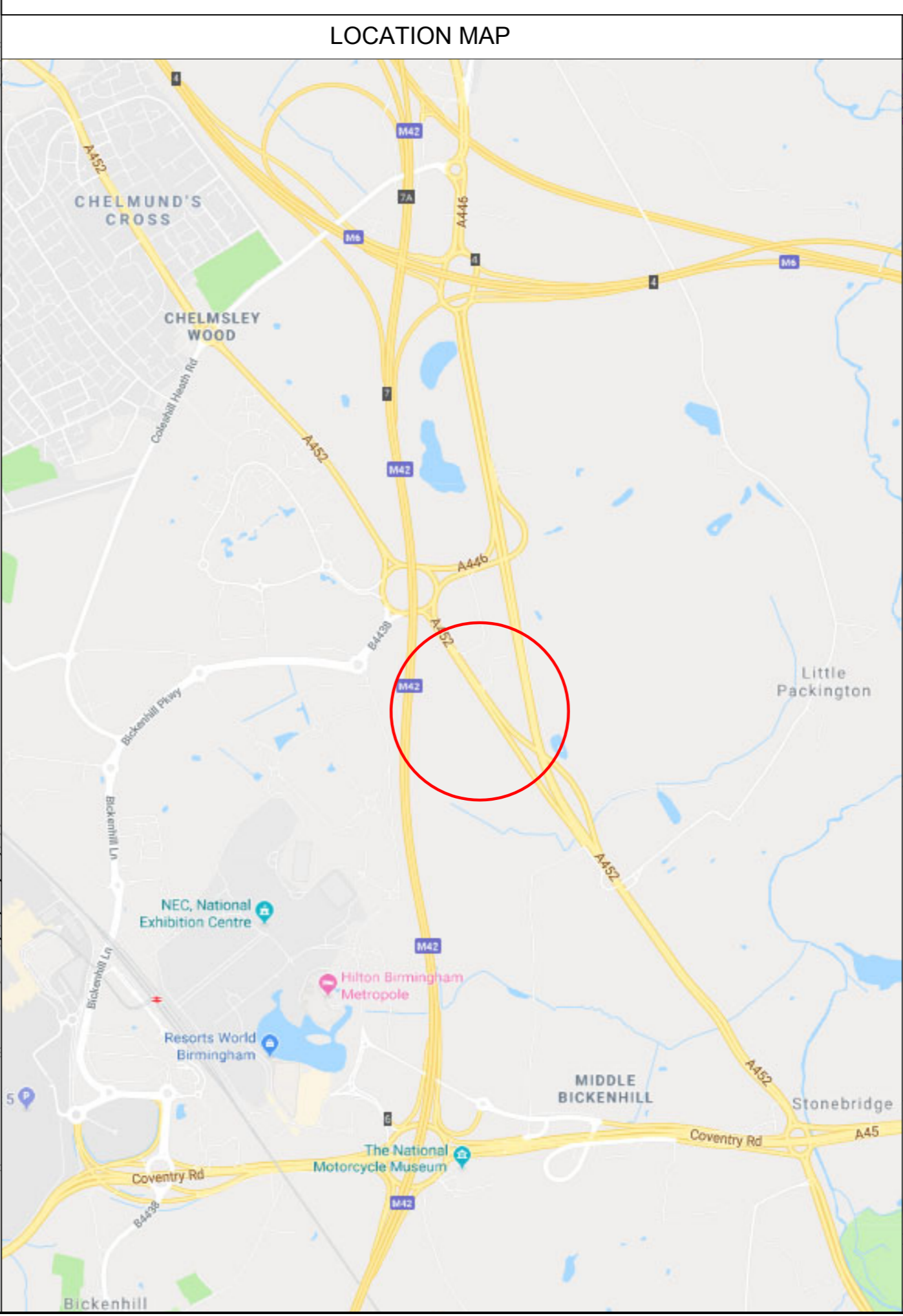

LOCATION MAP

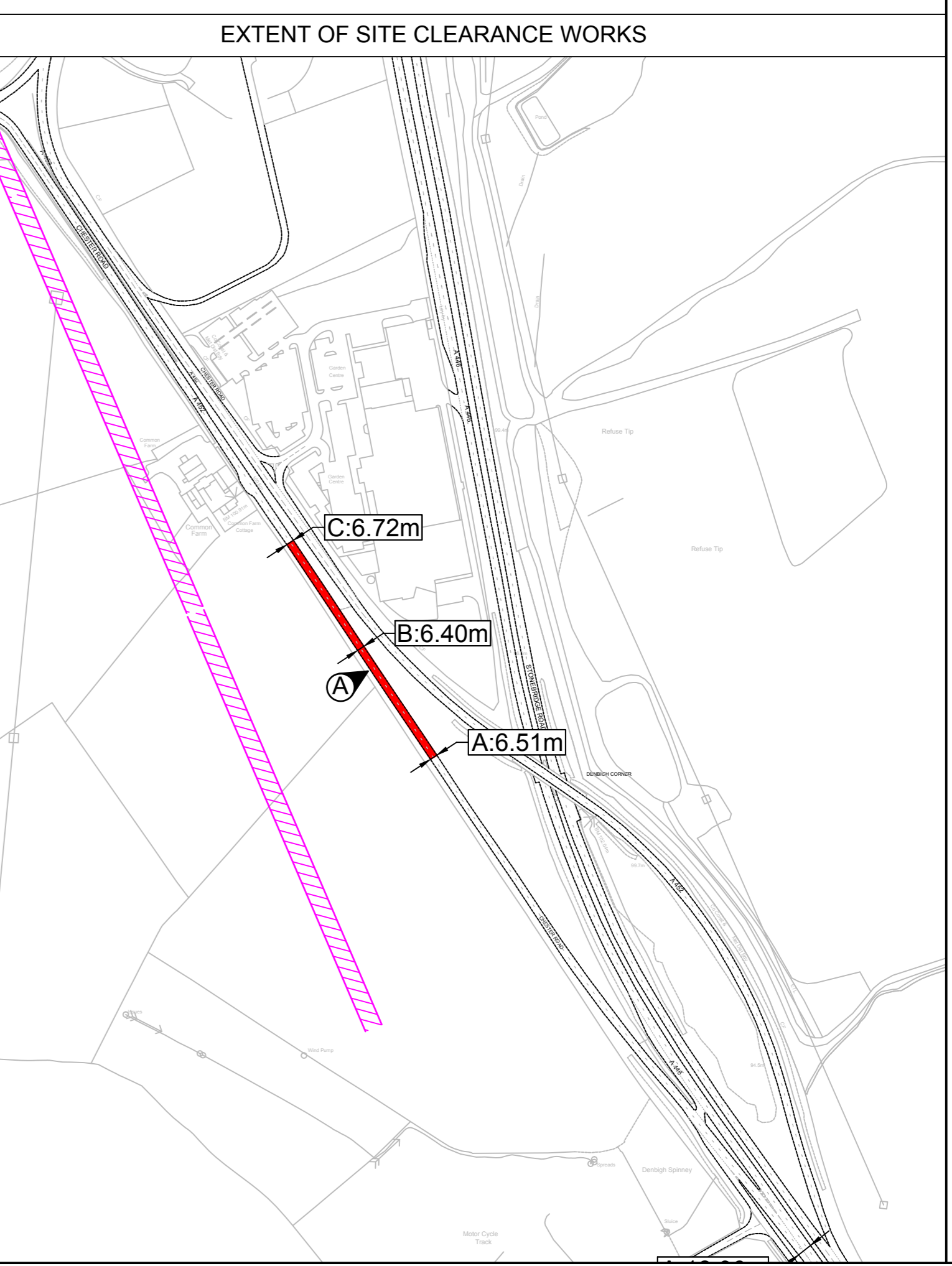

EXTENT OF SITE CLEARANCE WORKS

Key	
	Works Area
	Road Closure
	Clearance Route
	Line
	Proposed Lane
	Temporary Sign
	Access Point
	Temporary Traffic Signal
	Stop & Go Board
	Permanent Traffic Signal
	Temporary Ped Sign
	Working Area Sign
	1.5M Van
	Inclusive H2O route

Site Information	
Road Speed	
Min width of sideways safety zone (S)	1.2m
Min length of longways clearance (L)	100m
Surveyed	N
Road Width	6.40-6.72m
Site Length	220m
Bus Route	N
Road Type	Dual carriageway

Notes

Works have been produced via desktop survey only at this stage using imagery from Google street view dated April 2017.

No traffic counts have been undertaken.

The effect the chosen traffic management has on the network with regards to saturation flow rates etc has not been calculated.

Overhead power lines have been identified where possible, however, it is the contractor's responsibility to check with the power lines or any other potential hazards.

The design of the site access is to be undertaken by others. No work has been undertaken as part of this package to ensure the viability of the proposed access.

Trees are present along the route, a more detailed survey by the removal company will have to be undertaken complete with methodology. This will then need to be checked against the proposed form of TM to ascertain its suitability. If the proposed form of traffic management is not deemed suitable a road closure may need to be implemented.

Site length refers to the overall extent of the clearance works, not the length of the traffic management.

No bus stops are visible on the road, however, buses may still use the road as part of a longer route.

It has been assumed that the closure currently in place on Middle Bickenhill Lane will remain in place and any conflicting signage will need to be temporarily stood down.

Traffic management to be installed to allow a working window between 10:30 & 14:30 for an estimated duration of 12 weeks. Lane closures and subsequent signage to be removed/stood down outside of these hours.

1	25/03/2018	Client Information updated	NO	SHW
2	02/01/2018	Drawing pack meeting 21/01/2018	CM	SHW
3	16/12/2017	Drawing issued to client for proposals	CM	SHW
4	01/01/2018	Contract	CM	SHW

MURPHY
 Working in Partnership with
traffix
 Total traffic & event management solutions
 Old Alder Brookhouse, Chesham | South Street, Maidenhead 2012 01753
 T: +44 (0)1628 819 800 | F: +44 (0)1628 440077
 info@traffix.com | www.traffix.com

Project Information			
Proposed Lane Closures A452 Chester Road Birmingham B46 3HY			
Date:	Scale:	Project:	
16/12/2018	1:2000	AD	
CM	Client:	Approved:	
	BNH	MD	
Project Number:	Drawings Number:	Revision:	
UTX-SC02028	006	C	

This drawing is copyright & the property of Traffic & Event Management Solutions Ltd. It is not to be copied or used in any way without their written permission. Copyright is reserved in this drawing and no part of it may be reproduced or transmitted in any form or by any means electronic or mechanical, including photocopying, recording, or by any information storage and retrieval system.

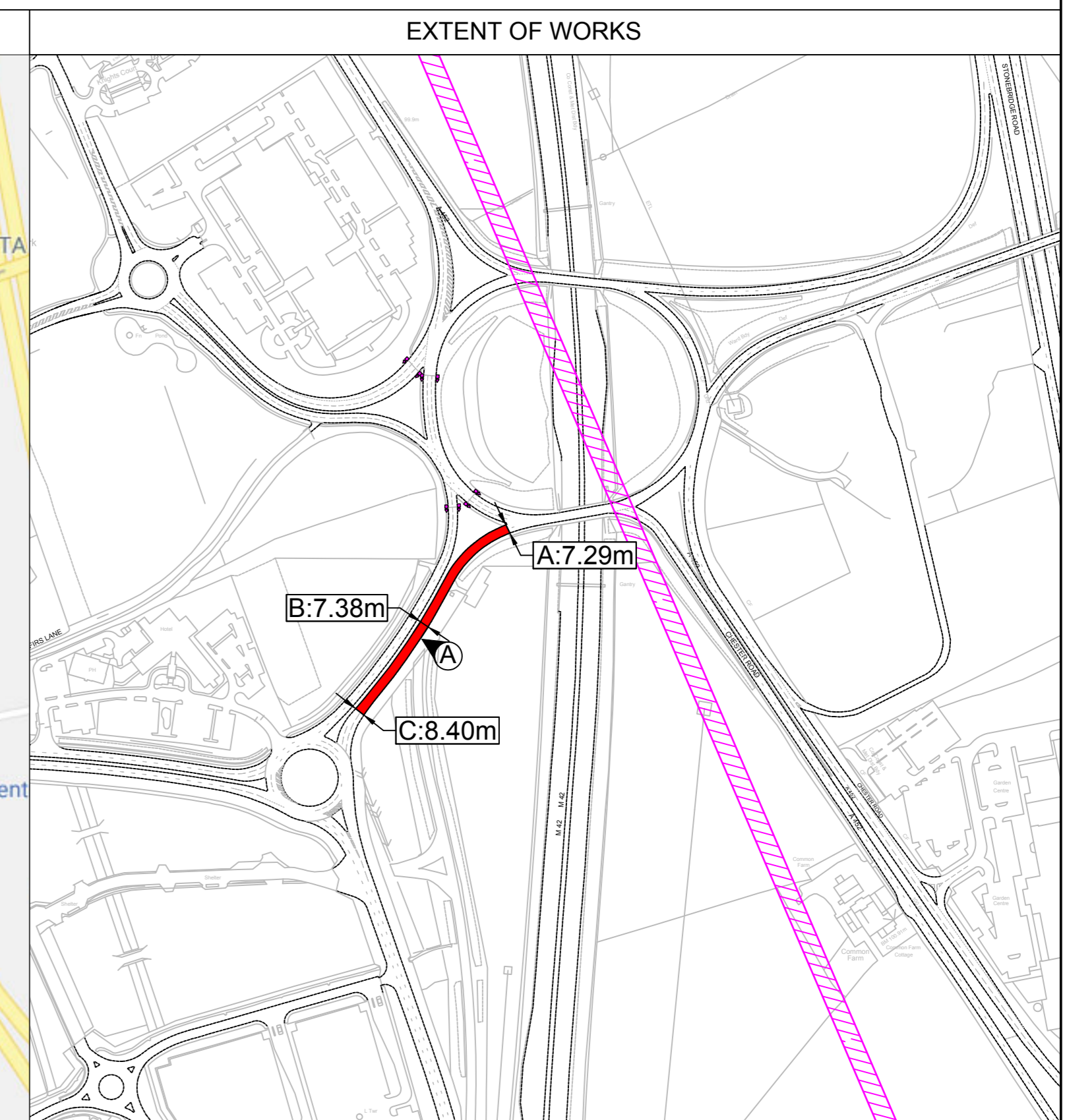
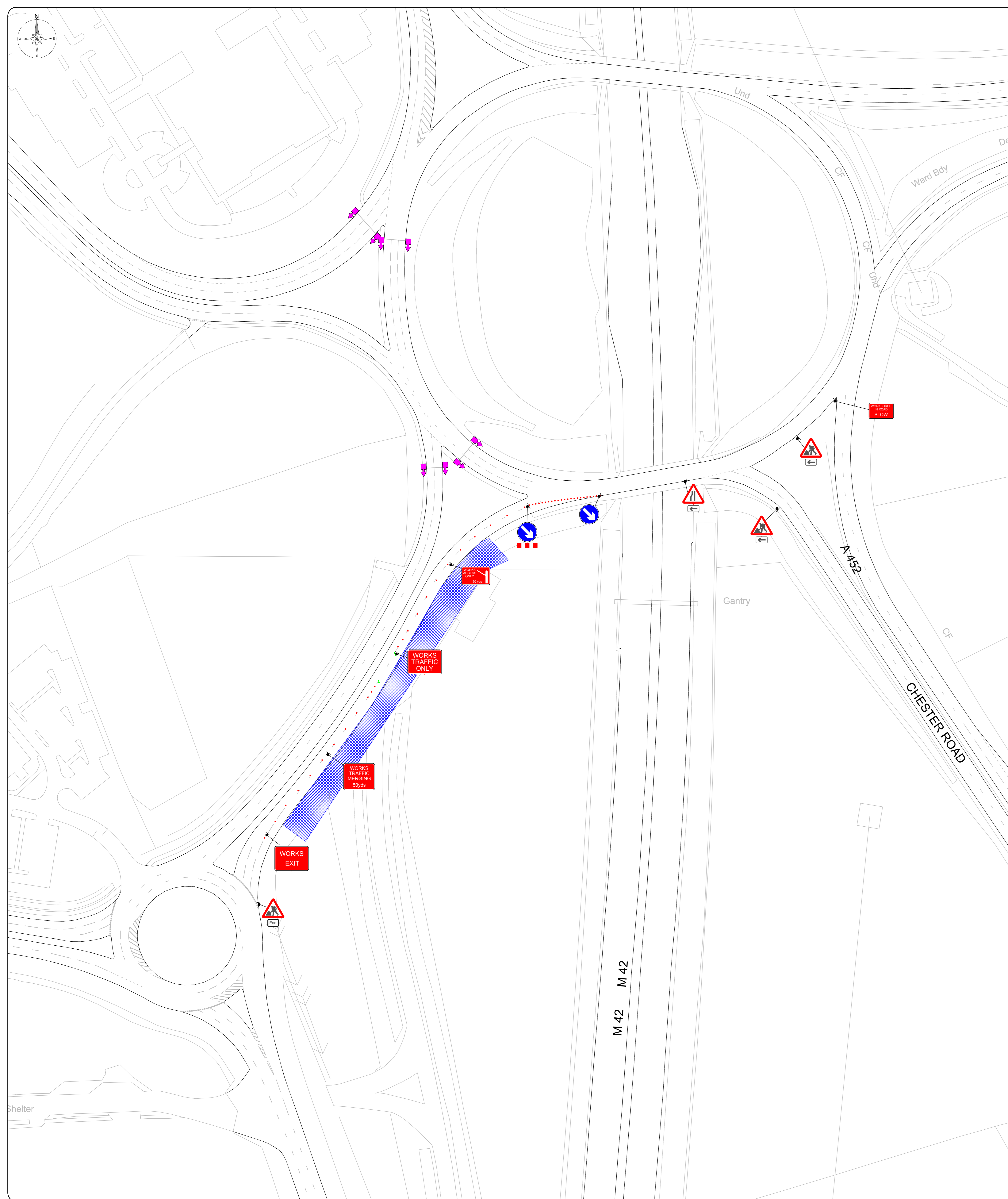

Key

Work Area	Temporary Traffic Signal
Road Closure	Stop & Go Board
Directional Road	Permanent Traffic Signal
Zone	Temporary Traffic Signal
Prohibitor Barrier	Working Bus Stop
Temporary Sign	3.5m Van
Access/egress access	Inclusive H&I route

Site Information

Road Speed	30
Min width of sideways safety zone (S)	0.5m
Min length of longways clearance (L)	15m
Surveyed	N
Road Width	7.29m - 8.40m
Site Length	161m
Bus Route	N
Road Type	Dual carriageway

Notes

Desktop survey undertaken from google street view with imagery dated June 2016.

Overhead power lines in close proximity to site.

Trees are present along the route.

Works to be undertaken during off peak hours only.

The design of the site/compound access is to be undertaken by others. No work has been undertaken as part of this package to ensure to viability of the proposed accesses.

Site length refers to the overall extent of the clearance works, not the length of the traffic management.

If no bus stops are visible on the road it has been assumed that the effected road is not a bus route. However, buses may still use the road as part of a longer route.

A detailed survey by the site clearance contractor to ascertain the suitability of the traffic management. If the proposed form of traffic management is not deemed suitable a road closure may need to be implemented.

Client Information updated	MJ	24/11/19
Design and meeting 21-01-2019	CM	18/01/19
Issue	CM	15/01/19

MURPHY
Working in Partnership with
traffix
Total traffic & event management solutions

Client: Traffic Management
Site: Site Access Works
Project: Proposed Lane Closure
Location: B4438 Northway
Address: Coleshill
Postcode: B46 3HY

Drawn: 17/01/2019	Scale: 1:750	Project: AD
Checked: CM	Checked: BNH	Approved: MJO
Project Number: UTX 3020028	Drawn Number: 009	Revision: B

This drawing is copyright & the property of Traffic & Event Management Solutions Ltd. It is to be used for the project only. It is not to be copied, reproduced or distributed in any form without the written permission. Copyright is reserved. © The drawing must not be scaled. The contractor is responsible for discrepancies & errors to the Contract Manager and to make any necessary changes.