

HIGH SPEED RAIL (LONDON – WEST MIDLANDS) ACT 2017

The contractor acting on behalf of, and as agent for, the nominated undertaker [High Speed Two (HS2) Limited] makes the following application under the High Speed Rail (London – West Midlands) Act 2017 (the 'Act').

Unique reference ID	TWH.AN.SMBC.LMJV.0226		
Provision in the Act	Schedule 4 Part 1 paragraphs 1(7) and 1(10)		
Description	Consent for / approval of new accesses not shown on the deposited plans (location / plans and specifications)		
Nature of works (tick one)	Temporary	<input checked="" type="checkbox"/>	Permanent
Response period (after which the location is to be treated as consented to / the plans and specifications are to be treated as approved if the highway authority fails to notify the nominated undertaker of its decisions)	28 days from the date of submission		
Reference(s) of related application(s) (if any)	TBC		

Note – A temporary interference submission under Schedule 4 Part 2 paragraph 6 of the Act may accompany this form, or be submitted separately.

Highway authority	Solihull Metropolitan Borough Council
Road number (where applicable)	N/A
Road name(s)	Park Lane
Location of access	From Park Lane into the adjacent field 52.404665 Northing, -1.654921 Easting
Description of access	<p>This scheme comprises of the provision of a temporary access junction on Park Lane, to construct the Park Lane Site Compound (currently a green field) for the construction works for HS2 Enabling Works Package 004c.</p> <p>The access junction on Park Lane is in the form of a Left In, Right Out access.</p> <p>It is understood that Park Lane will be closed between this access and Lavender Hall Lane.</p> <p>The access junction is not for use by the general public. It is estimated that the access will be in operation for a period of 6 to 12 months.</p>

Submission checklist <i>[tick as appropriate]</i> (give details in Annex A)					
Plans and specifications (for approval)	Location plan and general arrangement	✓	Supporting documents (for information)	Road Safety Audit report(s) – stages 1 / 2	
	Standard details			Road Safety Audit Response report(s)	
	Site clearance	✓		Road Safety Audit Exception report(s)	
	Fencing (<i>motorway boundary and within highway boundary only</i>)			AiPs for highway structures	
	Road restraint systems			Departures	
	Drainage and service ducts			Public utilities information	
	Earthworks (<i>within highway boundary only</i>)			Environmental information	
	Pavements (<i>including level information</i>)			Third party information	
	Kerbs, footways and paved areas			Health and safety / CDM information	
	Traffic signs and road markings	✓		Quality assurance information (e.g. BBA certificates)	
	Landscape (<i>within highway boundary only</i>)			DMRB design / check certificates	
	Street furniture			Other (please specify)	
	Other (please specify)				

Details of pre-application discussions	
18/03/2018	Meeting with Solihull MBC
	Add visibility constraints on drawings.

Additional comments

The Contractor, having been duly authorised to do so following review and acceptance of the associated documentation by HS2 Ltd, submits this application on behalf of, and as agent for, the nominated undertaker.

Contractor's confirmation of compliance with the Act and Contract requirements	
Signature: 	_____
Date: 13.5.19	_____
Name of Contractor's authorised representative: Mark Roberts	
Name of Contractor: LM JV	

Date of submission 29th May 2019
<i>[Date transmitted if sent electronically, next working day if posted first class]</i>

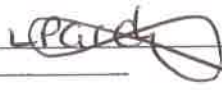
Decisions on the application by the highway authority	
Location – consented to consent withheld <i>[delete as appropriate]</i>	
If consent withheld, state ground(s): further information required as per email sent to Mark Roberts LMJV 21.6.19.	
Plans and specifications – approved approval withheld <i>[delete as appropriate]</i>	
If approval withheld, state ground(s): As above.	
Signature: 	Date: 24.6.19
Name of highway authority's authorised representative: LISA PARDY	

Issued by the Contractor on behalf of the nominated undertaker to	
Highway authority	Paul Tovey, Solihull MBC
HS2 Ltd	Chris Whitworth
Other (please specify)	
<i>[name of organisation]</i>	<i>[name of addressee]</i>

Annex A – Schedule of submitted plans, specifications and supporting documentation

Title	eB reference	Version
Plans (for approval)		
WP004c Park Lane General Arrangement Temporary Accesses	1EW04-LMJ_DJV-HW-DGA-NS01_NL05-004950	P03
WP004c Park Lane Site Clearance Temporary Accesses	1EW04-LMJ_DJV-HW-DGA-NS01_NL05-004970	P03
WP004c Park Lane Swept Paths Temporary Accesses	1EW04-LMJ_DJV-HW-DPL-NS01_NL05-004980	P03
WP004c Park Lane Visibility Splays Temporary Accesses	1EW04-LMJ_DJV-HW-DPL-NS01_NL05-004990	P03
WP004c Park Lane Pavement Temporary Access	1EW04-LMJ_DJV-HW-DPL-NS01_NL05-004991	P04
Specifications (for approval)		
Supporting documentation (for information)		



<p>HS2 High Speed Rail Infrastructure</p>	<p>LM JV</p>	<p>Project Name: HS2 Phase 1 Enabling Works North</p>
		<p>Client: HS2 Ltd</p>
<p>Contract No: S4 - Issued for LM Approval</p>	<p>Contract No: 5 - Detailed Design</p>	<p>Contract No: WPO04</p>
<p>Contract No: A.D04</p>	<p>Contract No: H.R04</p>	<p>Contract No: S.H</p>
<p>Date: 03/05/18</p>	<p>Date: 15/05</p>	<p>Date: A1</p>
<p>Drawing No: E0405-LM-D04-W04-H04-H01-IL05-00020</p>	<p>Drawing No: R04</p>	<p>Drawing No: R04</p>
<p>Location Plan</p>		<p>Project Description: General Arrangement for Temporary Accesses</p>
<p>Notes:</p> <ol style="list-style-type: none"> Do not scale for this drawing - accuracy is critical. Arrangements are indicative and subject to refinement. All works are to be in accordance with the contract documents unless otherwise stated. The drawings are to be used for construction purposes only. They are not to be used for any other purpose. For information of other users of drawings, ENVA-LS-CT-01-01-01, 01-02-01, 01-03-01, 01-04-01, 01-05-01, 01-06-01, 01-07-01, 01-08-01, 01-09-01, 01-10-01, 01-11-01, 01-12-01, 01-13-01, 01-14-01, 01-15-01, 01-16-01, 01-17-01, 01-18-01, 01-19-01, 01-20-01, 01-21-01, 01-22-01, 01-23-01, 01-24-01, 01-25-01, 01-26-01, 01-27-01, 01-28-01, 01-29-01, 01-30-01, 01-31-01, 01-32-01, 01-33-01, 01-34-01, 01-35-01, 01-36-01, 01-37-01, 01-38-01, 01-39-01, 01-40-01, 01-41-01, 01-42-01, 01-43-01, 01-44-01, 01-45-01, 01-46-01, 01-47-01, 01-48-01, 01-49-01, 01-50-01, 01-51-01, 01-52-01, 01-53-01, 01-54-01, 01-55-01, 01-56-01, 01-57-01, 01-58-01, 01-59-01, 01-60-01, 01-61-01, 01-62-01, 01-63-01, 01-64-01, 01-65-01, 01-66-01, 01-67-01, 01-68-01, 01-69-01, 01-70-01, 01-71-01, 01-72-01, 01-73-01, 01-74-01, 01-75-01, 01-76-01, 01-77-01, 01-78-01, 01-79-01, 01-80-01, 01-81-01, 01-82-01, 01-83-01, 01-84-01, 01-85-01, 01-86-01, 01-87-01, 01-88-01, 01-89-01, 01-90-01, 01-91-01, 01-92-01, 01-93-01, 01-94-01, 01-95-01, 01-96-01, 01-97-01, 01-98-01, 01-99-01, 01-100-01. For information of other users of drawings, ENVA-LS-CT-01-01-01, 01-02-01, 01-03-01, 01-04-01, 01-05-01, 01-06-01, 01-07-01, 01-08-01, 01-09-01, 01-10-01, 01-11-01, 01-12-01, 01-13-01, 01-14-01, 01-15-01, 01-16-01, 01-17-01, 01-18-01, 01-19-01, 01-20-01, 01-21-01, 01-22-01, 01-23-01, 01-24-01, 01-25-01, 01-26-01, 01-27-01, 01-28-01, 01-29-01, 01-30-01, 01-31-01, 01-32-01, 01-33-01, 01-34-01, 01-35-01, 01-36-01, 01-37-01, 01-38-01, 01-39-01, 01-40-01, 01-41-01, 01-42-01, 01-43-01, 01-44-01, 01-45-01, 01-46-01, 01-47-01, 01-48-01, 01-49-01, 01-50-01, 01-51-01, 01-52-01, 01-53-01, 01-54-01, 01-55-01, 01-56-01, 01-57-01, 01-58-01, 01-59-01, 01-60-01, 01-61-01, 01-62-01, 01-63-01, 01-64-01, 01-65-01, 01-66-01, 01-67-01, 01-68-01, 01-69-01, 01-70-01, 01-71-01, 01-72-01, 01-73-01, 01-74-01, 01-75-01, 01-76-01, 01-77-01, 01-78-01, 01-79-01, 01-80-01, 01-81-01, 01-82-01, 01-83-01, 01-84-01, 01-85-01, 01-86-01, 01-87-01, 01-88-01, 01-89-01, 01-90-01, 01-91-01, 01-92-01, 01-93-01, 01-94-01, 01-95-01, 01-96-01, 01-97-01, 01-98-01, 01-99-01, 01-100-01. 		

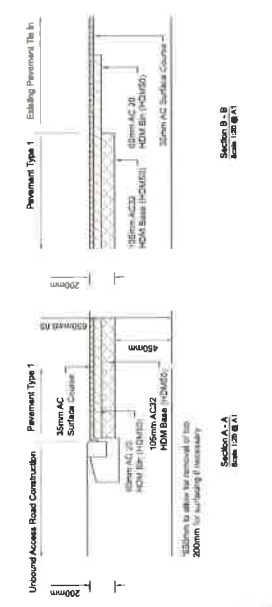
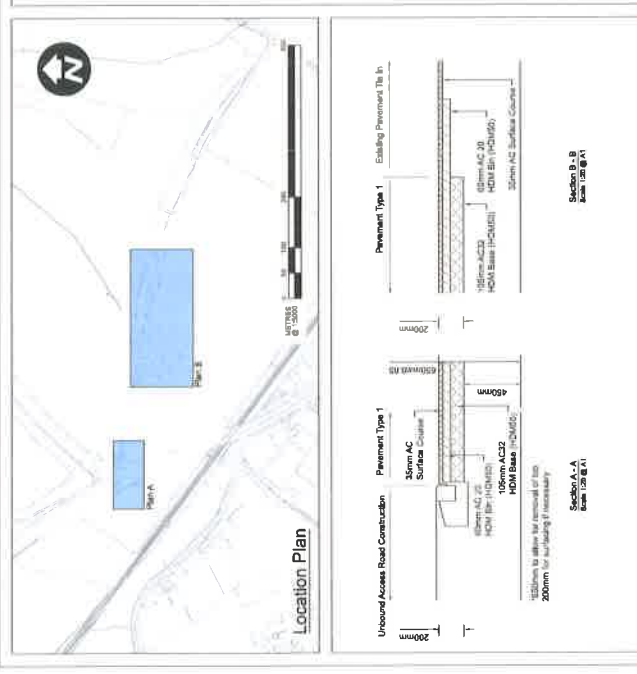

Scale: A - A
1:5000 (A1)

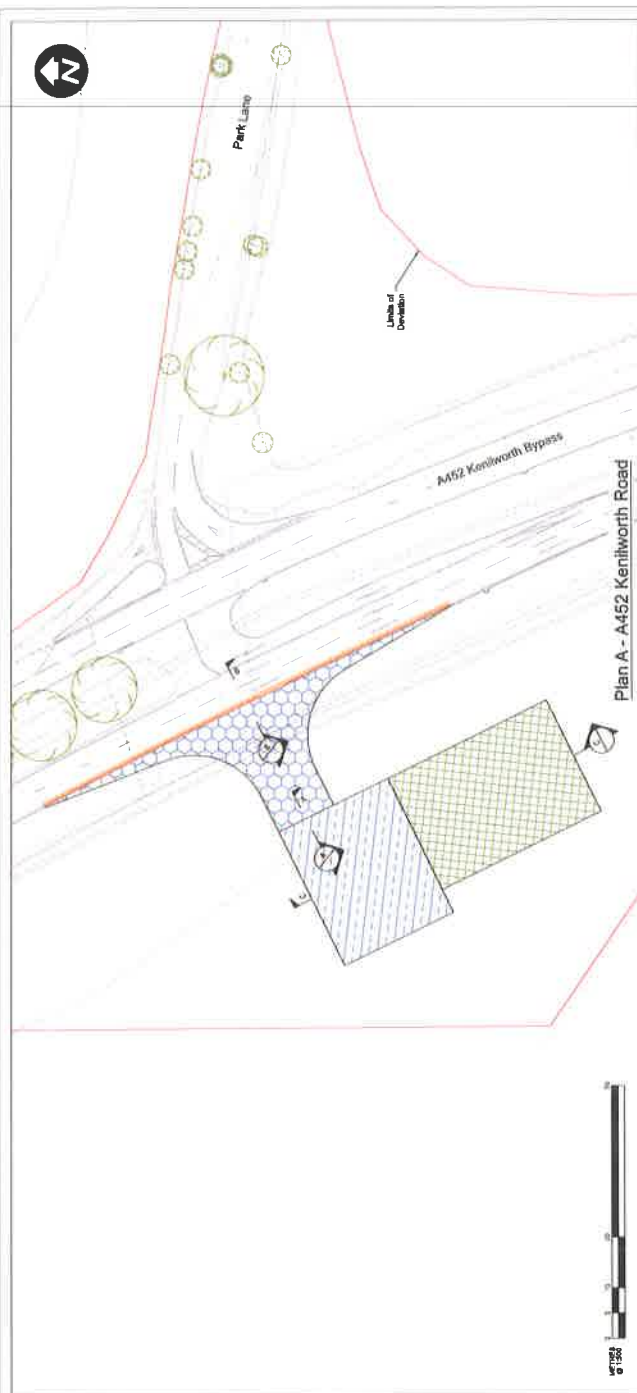

Plan A - A452 Kenilworth Road

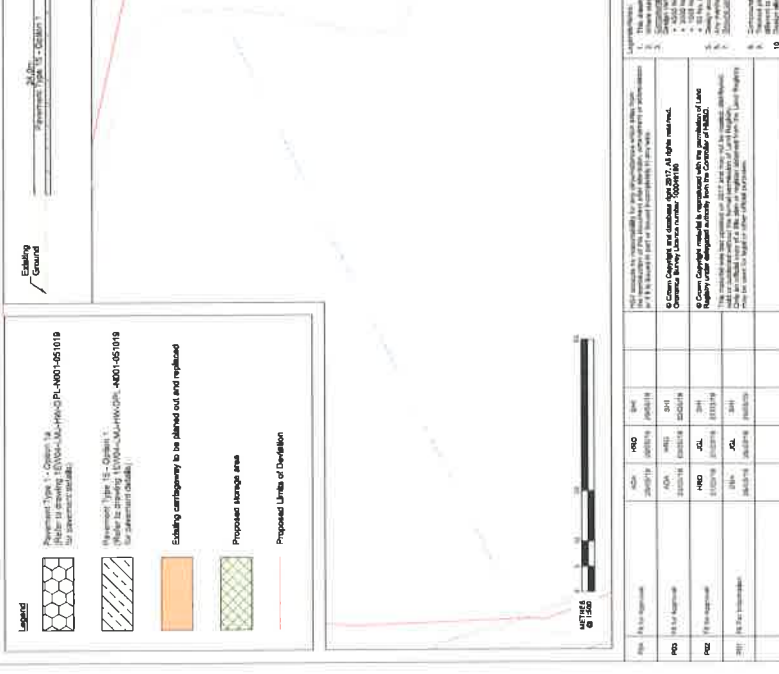

Plan B - Park Lane



Proposed Type 1 - Channel 15
(Refer to drawing 151004-MA-HW-020-01-4001-051019 for pavement details)

Proposed Type 15 - Channel 15
(Refer to drawing 151004-MA-HW-020-01-4001-051019 for pavement details)

Existing carriageway to be finished out and resurfaced

Proposed storage area

Proposed Limits of Diversion

Scale: B - B
1:500 (B1)

Fit for Approval

File No	Issue No	Issue Date	Issue Description	Author	Checked	Approved	Scale
PO	001	20/05/18	PO	LM JV			1:500
PO	002	20/05/18	PO	LM JV			1:500
PO	003	20/05/18	PO	LM JV			1:500
PO	004	20/05/18	PO	LM JV			1:500
PO	005	20/05/18	PO	LM JV			1:500
PO	006	20/05/18	PO	LM JV			1:500
PO	007	20/05/18	PO	LM JV			1:500
PO	008	20/05/18	PO	LM JV			1:500
PO	009	20/05/18	PO	LM JV			1:500
PO	010	20/05/18	PO	LM JV			1:500
PO	011	20/05/18	PO	LM JV			1:500
PO	012	20/05/18	PO	LM JV			1:500
PO	013	20/05/18	PO	LM JV			1:500
PO	014	20/05/18	PO	LM JV			1:500
PO	015	20/05/18	PO	LM JV			1:500
PO	016	20/05/18	PO	LM JV			1:500
PO	017	20/05/18	PO	LM JV			1:500
PO	018	20/05/18	PO	LM JV			1:500
PO	019	20/05/18	PO	LM JV			1:500
PO	020	20/05/18	PO	LM JV			1:500
PO	021	20/05/18	PO	LM JV			1:500
PO	022	20/05/18	PO	LM JV			1:500
PO	023	20/05/18	PO	LM JV			1:500
PO	024	20/05/18	PO	LM JV			1:500
PO	025	20/05/18	PO	LM JV			1:500
PO	026	20/05/18	PO	LM JV			1:500
PO	027	20/05/18	PO	LM JV			1:500
PO	028	20/05/18	PO	LM JV			1:500
PO	029	20/05/18	PO	LM JV			1:500
PO	030	20/05/18	PO	LM JV			1:500
PO	031	20/05/18	PO	LM JV			1:500
PO	032	20/05/18	PO	LM JV			1:500
PO	033	20/05/18	PO	LM JV			1:500
PO	034	20/05/18	PO	LM JV			1:500
PO	035	20/05/18	PO	LM JV			1:500
PO	036	20/05/18	PO	LM JV			1:500
PO	037	20/05/18	PO	LM JV			1:500
PO	038	20/05/18	PO	LM JV			1:500
PO	039	20/05/18	PO	LM JV			1:500
PO	040	20/05/18	PO	LM JV			1:500
PO	041	20/05/18	PO	LM JV			1:500
PO	042	20/05/18	PO	LM JV			1:500
PO	043	20/05/18	PO	LM JV			1:500
PO	044	20/05/18	PO	LM JV			1:500
PO	045	20/05/18	PO	LM JV			1:500
PO	046	20/05/18	PO	LM JV			1:500
PO	047	20/05/18	PO	LM JV			1:500
PO	048	20/05/18	PO	LM JV			1:500
PO	049	20/05/18	PO	LM JV			1:500
PO	050	20/05/18	PO	LM JV			1:500
PO	051	20/05/18	PO	LM JV			1:500
PO	052	20/05/18	PO	LM JV			1:500
PO	053	20/05/18	PO	LM JV			1:500
PO	054	20/05/18	PO	LM JV			1:500
PO	055	20/05/18	PO	LM JV			1:500
PO	056	20/05/18	PO	LM JV			1:500
PO	057	20/05/18	PO	LM JV			1:500
PO	058	20/05/18	PO	LM JV			1:500
PO	059	20/05/18	PO	LM JV			1:500
PO	060	20/05/18	PO	LM JV			1:500
PO	061	20/05/18	PO	LM JV			1:500
PO	062	20/05/18	PO	LM JV			1:500
PO	063	20/05/18	PO	LM JV			1:500
PO	064	20/05/18	PO	LM JV			1:500
PO	065	20/05/18	PO	LM JV			1:500
PO	066	20/05/18	PO	LM JV			1:500
PO	067	20/05/18	PO	LM JV			1:500
PO	068	20/05/18	PO	LM JV			1:500
PO	069	20/05/18	PO	LM JV			1:500
PO	070	20/05/18	PO	LM JV			1:500
PO	071	20/05/18	PO	LM JV			1:500
PO	072	20/05/18	PO	LM JV			1:500
PO	073	20/05/18	PO	LM JV			1:500
PO	074	20/05/18	PO	LM JV			1:500
PO	075	20/05/18	PO	LM JV			1:500
PO	076	20/05/18	PO	LM JV			1:500
PO	077	20/05/18	PO	LM JV			1:500
PO	078	20/05/18	PO	LM JV			1:500
PO	079	20/05/18	PO	LM JV			1:500
PO	080	20/05/18	PO	LM JV			1:500
PO	081	20/05/18	PO	LM JV			1:500
PO	082	20/05/18	PO	LM JV			1:500
PO	083	20/05/18	PO	LM JV			1:500
PO	084	20/05/18	PO	LM JV			1:500
PO	085	20/05/18	PO	LM JV			1:500
PO	086	20/05/18	PO	LM JV			1:500
PO	087	20/05/18	PO	LM JV			1:500
PO	088	20/05/18	PO	LM JV			1:500
PO	089	20/05/18	PO	LM JV			1:500
PO	090	20/05/18	PO	LM JV			1:500
PO	091	20/05/18	PO	LM JV			1:500
PO	092	20/05/18	PO	LM JV			1:500
PO	093	20/05/18	PO	LM JV			1:500
PO	094	20/05/18	PO	LM JV			1:500
PO	095	20/05/18	PO	LM JV			1:500
PO	096	20/05/18	PO	LM JV			1:500
PO	097	20/05/18	PO	LM JV			1:500
PO	098	20/05/18	PO	LM JV			1:500
PO	099	20/05/18	PO	LM JV			1:500
PO	100	20/05/18	PO	LM JV			1:500

HSE
 HSE CONSULTANTS
 100, BRISTOL ROAD
 BIRMINGHAM, B3 7YU, UK
 TEL: 0121 717 1000
 FAX: 0121 717 1001
 WWW.HSECONSULTANTS.CO.UK

OFFICIAL
 LM JV

Fit for Approval

HS2 Phase 1 Enabling Works North

Design Step
 5 - Detailed Design

Design No
 WPO04c

Date
 20/05/18

Scale
 1:500

Author
 A.Dorch

Checked
 H.Roberts

Approved
 S.H.H

Project Name
 Park Lane

Project Location
 Pavement

Project Reference
 Temporary Access

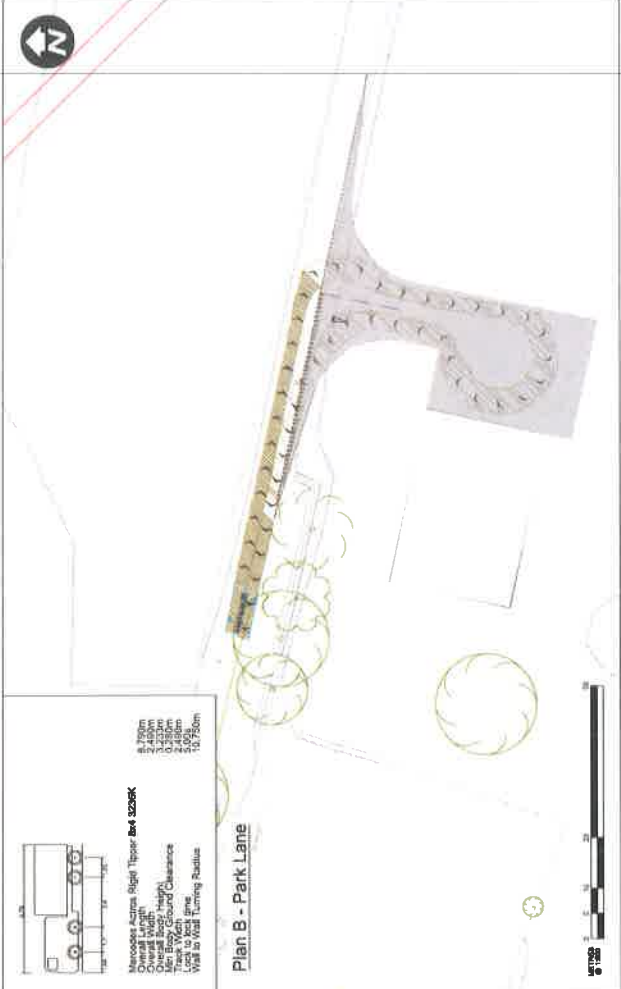

Macroscopic Access Right Type: B4 3226K
 Overall Length: 9.780m
 Overall Width: 3.225m
 Overall Body Height: 2.485m
 Track Width: 2.485m
 Wheel to Wheel Clearance: 1.075m
 Wheel to Wheel Turning Radius: 10.750m

Plan A - A452 Kenilworth Road

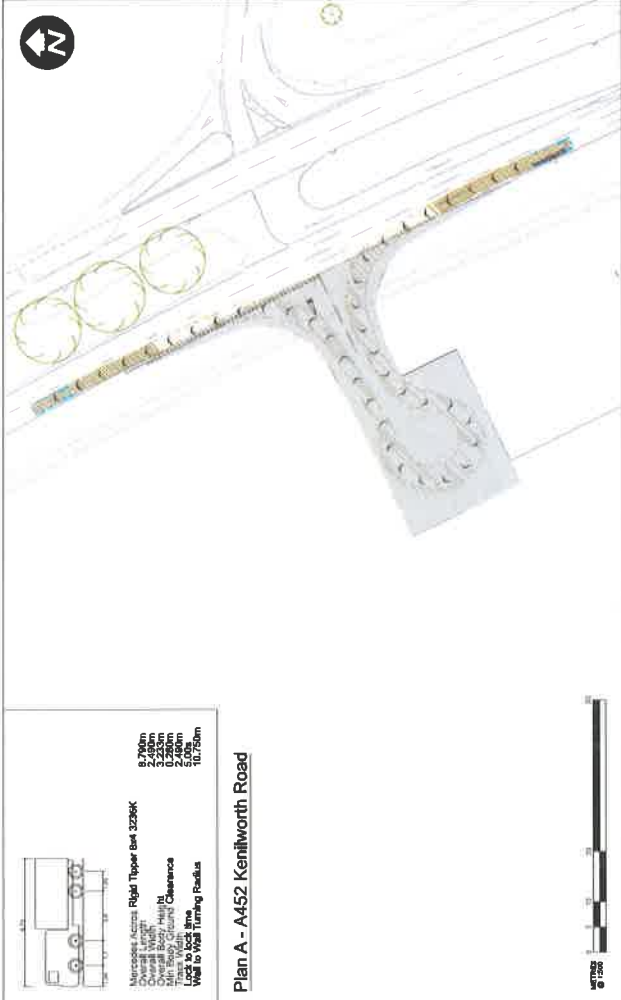

Macroscopic Access Right Type: B4 3226K
 Overall Length: 9.780m
 Overall Width: 3.225m
 Overall Body Height: 2.485m
 Track Width: 2.485m
 Wheel to Wheel Clearance: 1.075m
 Wheel to Wheel Turning Radius: 10.750m

Plan B - Park Lane



FTA Design HO Right Vehicle (1098)
 Overall Length: 10.000m
 Overall Width: 3.245m
 Overall Body Height: 2.470m
 Track Width: 2.470m
 Wheel to Wheel Clearance: 1.075m
 Wheel to Wheel Turning Radius: 11.000m

Plan A - A452 Kenilworth Road

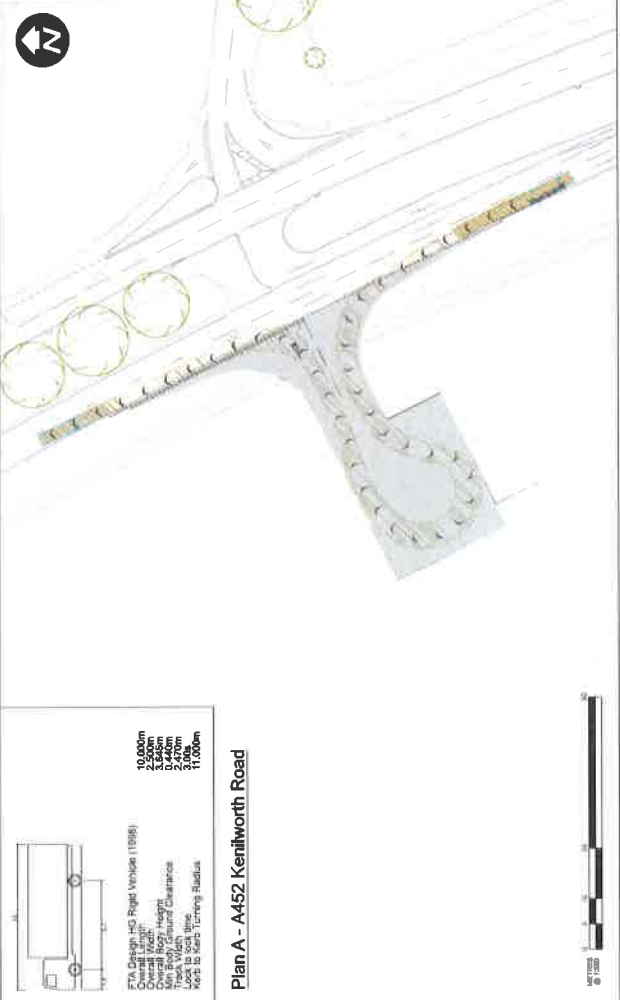

FTA Design HO Right Vehicle (1098)
 Overall Length: 10.000m
 Overall Width: 3.245m
 Overall Body Height: 2.470m
 Track Width: 2.470m
 Wheel to Wheel Clearance: 1.075m
 Wheel to Wheel Turning Radius: 11.000m

Plan B - Park Lane

Fit for Approval

HS2
 High Speed Rail
 Programme for England
 Infrastructure Bill
 Birmingham to Leeds
 Birmingham, UK

OFFICIAL
 LM JV

Project/Contract: **HS2 Phase 1 Enabling Works North**

Drawn/Author: **A.Darsh**

Checked: **H.Roberts**

Scale: **1:500**

Date: **08/05/18**

Sheet: **A1**

Drawing No: **1E050404_GN/HW/HDR_A001_NL0504040**

Revision: **PRG**

Scale: 1:500

North Arrow

Location Plan

1. Do not scale from this drawing - accuracy is limited, drawings are indicative and subject to measurement.

2. All dimensions are in metres unless otherwise stated.

3. All dimensions are to the centre of the line unless otherwise stated.

4. The drawing is to be used in conjunction with all relevant contracts & engineering drawings & specifications.

5. Drawings have been developed from LDMR as all necessary survey work not detailed enough to allow.

6. For information of other roles in drawing: E:\050404_GN\HW\HDR_A001_NL0504040.rvt

Rev	Description	Date	By	Check	Author
001	Issue for approval	23/03/18	AD	HR	AD
002	Issue for approval	23/03/18	AD	HR	AD
003	Issue for approval	23/03/18	AD	HR	AD

HIGH SPEED RAIL (LONDON – WEST MIDLANDS) ACT 2017

The contractor acting on behalf of, and as agent for, the nominated undertaker [High Speed Two (HS2) Limited] makes the following application under the High Speed Rail (London – West Midlands) Act 2017 (the 'Act').

Unique reference ID	TWH.AN.SMBC.LMJV.0227		
Provision in the Act	Schedule 4 Part 1 paragraphs 1(7) and 1(10)		
Description	Consent for / approval of new accesses not shown on the deposited plans (location / plans and specifications)		
Nature of works (tick one)	Temporary	<input checked="" type="checkbox"/>	Permanent
Response period (after which the location is to be treated as consented to / the plans and specifications are to be treated as approved if the highway authority fails to notify the nominated undertaker of its decisions)	28 days from the date of submission		
Reference(s) of related application(s) (if any)	TBC		

Note – A temporary interference submission under Schedule 4 Part 2 paragraph 6 of the Act may accompany this form, or be submitted separately.

Highway authority	Solihull Metropolitan Borough Council
Road number (where applicable)	A452
Road name(s)	Kenilworth Bypass
Location of access	From A452 Kenilworth Bypass into the adjacent field 52.404987 Northing, -1.660091 Easting
Description of access	<p>This scheme comprises of the provision of a temporary access junction on the A452 Kenilworth Bypass, to construct the A452 Site Compound (currently a green field) for the construction works for HS2 Enabling Works Package 004c.</p> <p>The access junction on the A452 Kenilworth Bypass is in the form of a Left In, Left Out access with nearside diverge and merge tapers.</p> <p>The access junction is not for use by the general public. It is estimated that the access will be in operation for a period of 6 to 12 months.</p>

Submission checklist [tick as appropriate] (give details in Annex A)					
Plans and specifications (for approval)	Location plan and general arrangement	✓	Supporting documents (for information)	Road Safety Audit report(s) – stages 1 / 2	
	Standard details			Road Safety Audit Response report(s)	
	Site clearance			Road Safety Audit Exception report(s)	
	Fencing (motorway boundary and within highway boundary only)			AiPs for highway structures	
	Road restraint systems			Departures	
	Drainage and service ducts			Public utilities information	
	Earthworks (within highway boundary only)			Environmental information	
	Pavements (including level information)			Third party information	
	Kerbs, footways and paved areas			Health and safety / CDM information	
	Traffic signs and road markings			Quality assurance information (e.g. BBA certificates)	
	Landscape (within highway boundary only)			DMRB design / check certificates	
	Street furniture			Other (please specify)	
	Other (please specify)				

Details of pre-application discussions	
18/03/2019	Meeting with Solihull
	Add visibility constraints on drawings

Additional comments

The Contractor, having been duly authorised to do so following review and acceptance of the associated documentation by HS2 Ltd, submits this application on behalf of, and as agent for, the nominated undertaker.

Contractor's confirmation of compliance with the Act and Contract requirements	
Signature:	
Date:	13.5.19
Name of Contractor's authorised representative:	Mark Roberts
Name of Contractor:	LM JV

Date of submission 29th May 2019
<i>[Date transmitted if sent electronically, next working day if posted first class]</i>

Decisions on the application by the highway authority	
Location – consented to	<u>consent withheld</u> <i>[delete as appropriate]</i>
If consent withheld, state ground(s):	Further information required as per email sent to Mark Roberts LM JV 21.6.19
Plans and specifications – approved / approval withheld	<i>[delete as appropriate]</i>
If approval withheld, state ground(s):	AS above.
Signature:	
Date:	24.6.19
Name of highway authority's authorised representative:	LISA PARDY

Issued by the Contractor on behalf of the nominated undertaker to	
Highway authority	Paul Tovey, Solihull MBC
HS2 Ltd	Chris Whitworth
Other (please specify)	
<i>[name of organisation]</i>	<i>[name of addressee]</i>

Annex A – Schedule of submitted plans, specifications and supporting documentation

Title	eB reference	Version
Plans (for approval)		
WP004c Park Lane General Arrangement Temporary Accesses	1EW04-LMJ_DJV-HW-DGA-NS01_NL05-004950	P03
WP004c Park Lane Site Clearance Temporary Accesses	1EW04-LMJ_DJV-HW-DGA-NS01_NL05-004970	P03
WP004c Park Lane Swept Paths Temporary Accesses	1EW04-LMJ_DJV-HW-DPL-NS01_NL05-004980	P03
WP004c Park Lane Visibility Splays Temporary Accesses	1EW04-LMJ_DJV-HW-DPL-NS01_NL05-004990	P03
WP004c Park Lane Pavement Temporary Access	1EW04-LMJ_DJV-HW-DPL-NS01_NL05-004991	P04
Specifications (for approval)		
Supporting documentation (for information)		

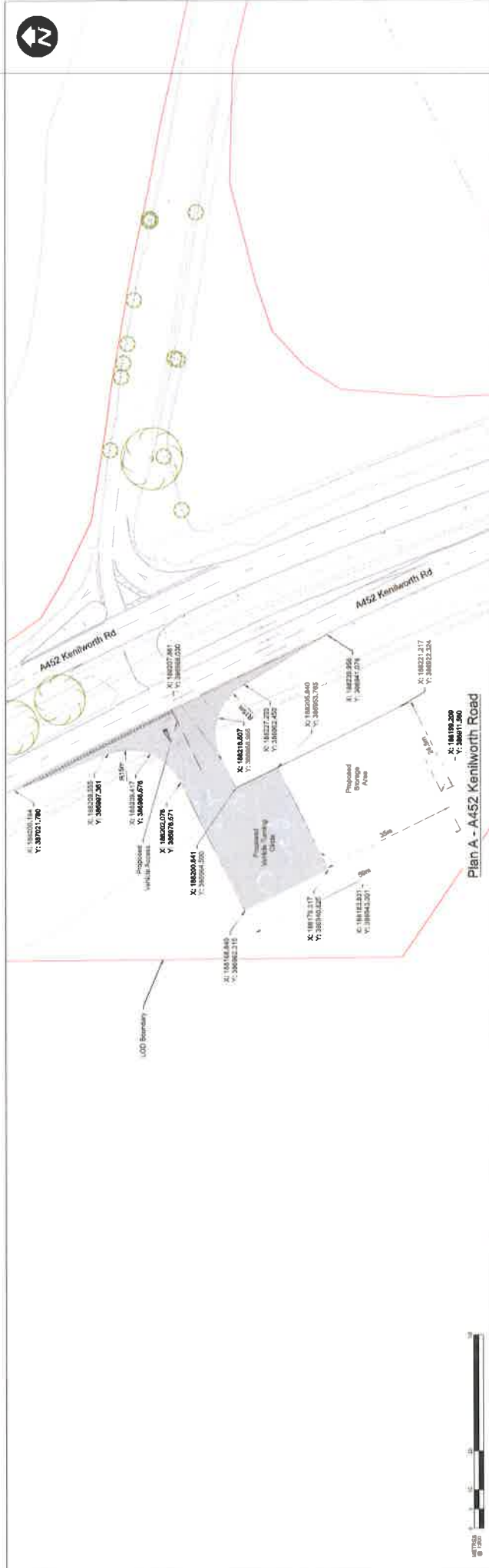

Plan A - A452 Kenilworth Road

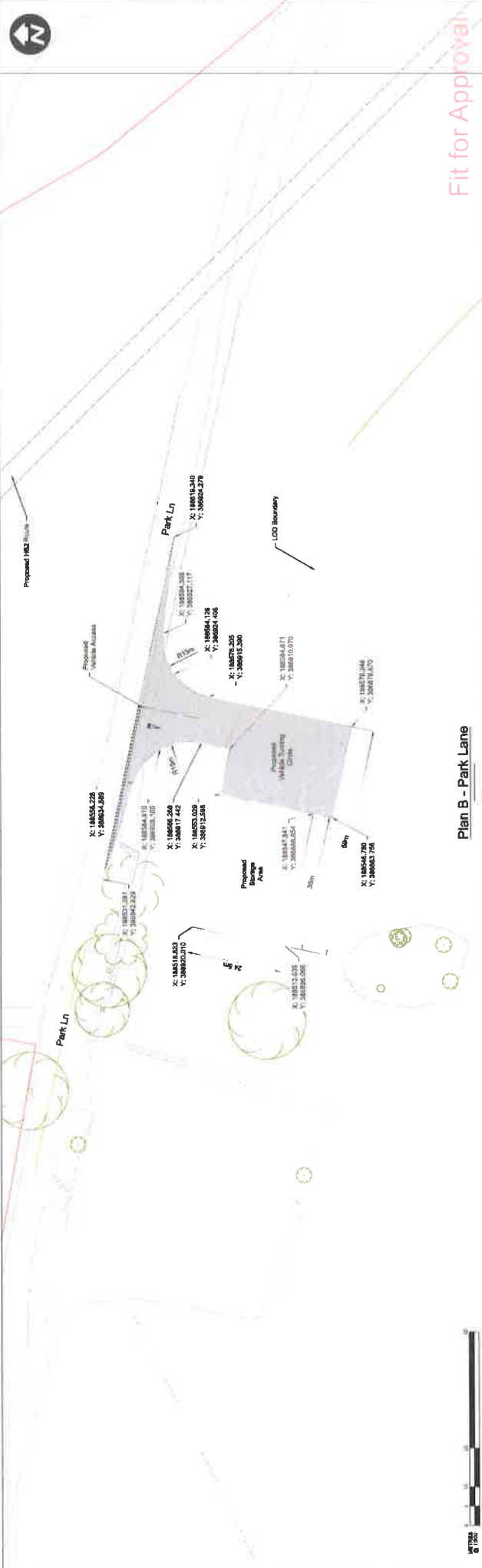

Plan B - Park Lane

Fit for Approval

 <p>Registered in England Registered office: HS2 Infrastructure Birmingham, UK</p> <p>OFFICIAL</p> <p>Location Plan 1:12.5</p>	<p>Project/Contract: HS2 Phase 1 Enabling Works North</p> <p>Drawings/Revision: SA - Issued for LM Approval</p> <p>Drawn By: WPO006</p> <p>Checked By: Park Lane</p> <p>Drawn Date: 03/05/19</p> <p>Scale: 1:500</p> <p>Sheet: A1</p> <p>Drawing Title: TEMPORARY DOCKING/STORAGE/STORAGE</p>
	<p>Author/Issue/Description: SA - Issued for LM Approval</p> <p>Design Stage: 5 - Detailed Design</p> <p>Change No: WPO006</p> <p>Change Description: Park Lane</p> <p>Category: General Arrangement for Temporary Accesses</p>
<p>Do not scale from this drawing - accuracy is limited, drawings are indicative and subject to re-approval</p> <p>All levels are in metres above Ordnance Datum unless otherwise stated.</p> <p>The drawing is to be used in accordance with the contract documents and specifications.</p> <p>For information of utilities refer to drawings: E:\HS2\PHASE1\ENABLING\WORKS\030519\030519_01.dwg</p>	<p>Legend:</p> <ul style="list-style-type: none"> Proposed WH/Office/Storage Proposed Storage Area Proposed HSE Route Proposed WH/Office/Storage Proposed Storage Area Proposed HSE Route Proposed WH/Office/Storage Proposed Storage Area Proposed HSE Route
<p>HS2 is not responsible for any inaccuracies or omissions in this drawing or any information derived therefrom.</p> <p>The drawing is to be used in accordance with the contract documents and specifications.</p> <p>For information of utilities refer to drawings: E:\HS2\PHASE1\ENABLING\WORKS\030519\030519_01.dwg</p>	<p>Author: WPO006</p> <p>Checked: WPO006</p> <p>Drawn: WPO006</p> <p>Scale: 1:500</p> <p>Sheet: A1</p> <p>Drawing Title: TEMPORARY DOCKING/STORAGE/STORAGE</p>

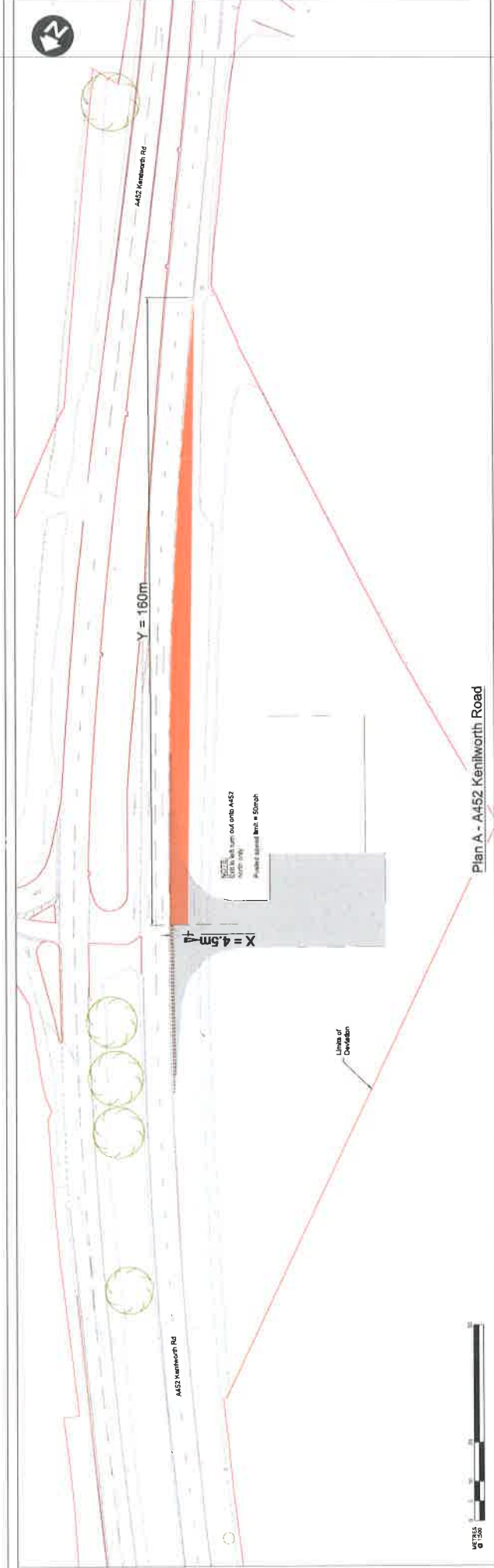

Fit for Approval

<p>Location Map 1:12.5</p>	<p>HS2 High Speed Rail Infrastructure Ltd 2007-1148 Buckingham Palace Buckingham, W1A 3AA</p> <p>OFFICIAL</p> <p>Created by: LM JV</p>	<p>Project Control:</p> <p>HS2 Phase 1 Enabling Works North</p>
		<p>Material: Construction</p> <p>S4 - Issued for LM Approval</p>
<p>Design Issue</p> <p>5 - Detailed Design</p>		<p>Drawn By: A. Clanch</p> <p>Checked: H. Roberts</p> <p>Approved: S. Hill</p> <p>Date: 03/05/18</p> <p>Scale: 1:500</p> <p>Sheet: A1</p>
<p>Proposed Storage Area</p> <p>Proposed Pavement</p> <p>Units of Deviation</p> <p>Visibility Splay</p>		<p>Temporary Accesses</p>
<p>Legend:</p> <p>1. Do not scale from this drawing - accuracy is limited, drawings are indicative and subject to mainmap</p> <p>2. All dimensions in millimetres unless otherwise stated</p> <p>3. All dimensions in metres unless otherwise stated</p> <p>4. This drawing is to be read in conjunction with all relevant drawings & specifications.</p> <p>5. The information is subject to change without notice. (E:\HS2\A1\12\03-18\01_1250-201825 to 25 A1)</p> <p>6. The information is subject to change without notice. (E:\HS2\A1\12\03-18\01_1250-201825 to 25 A1)</p>		
<p>Sheet Description</p> <p>Sheet: 1250-201825 to 25 A1</p> <p>Scale: 1:500</p> <p>Author: LM JV</p> <p>Checked: LM JV</p> <p>Approved: LM JV</p> <p>Date: 03/05/18</p> <p>Sheet: 1250-201825 to 25 A1</p>		

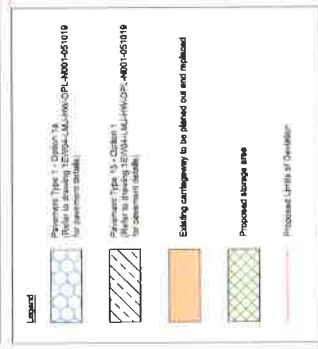
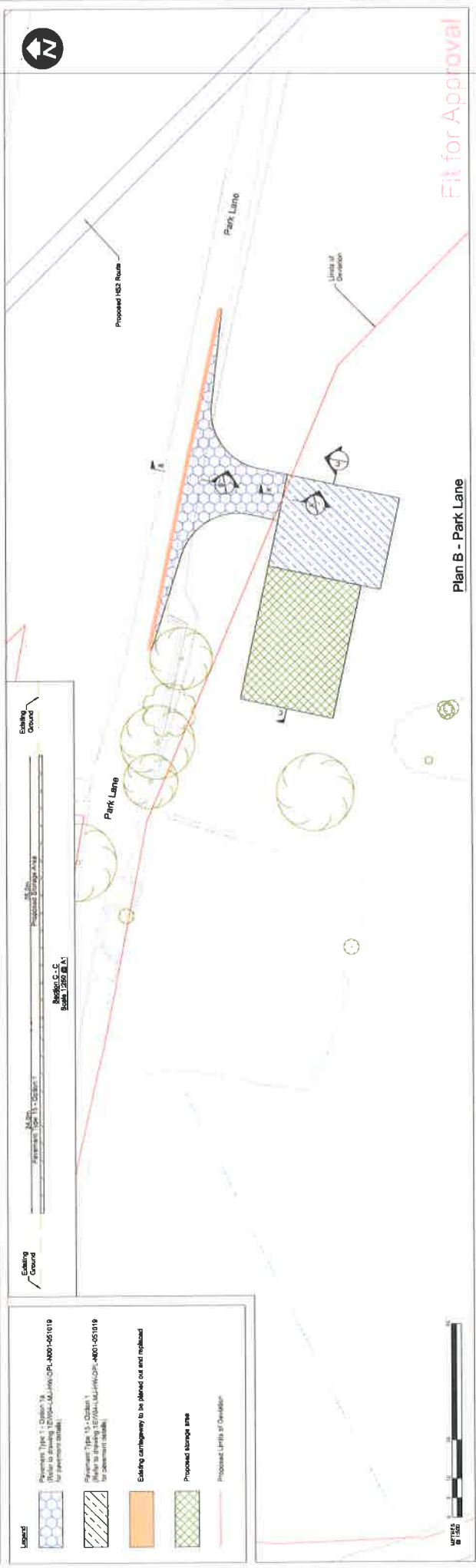
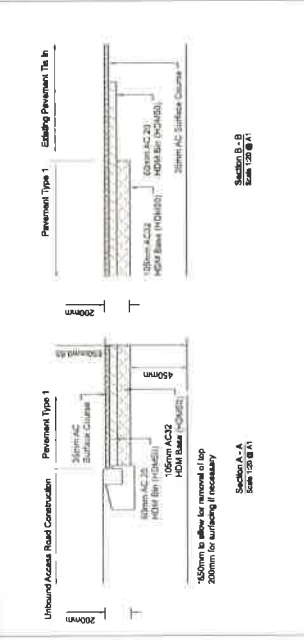
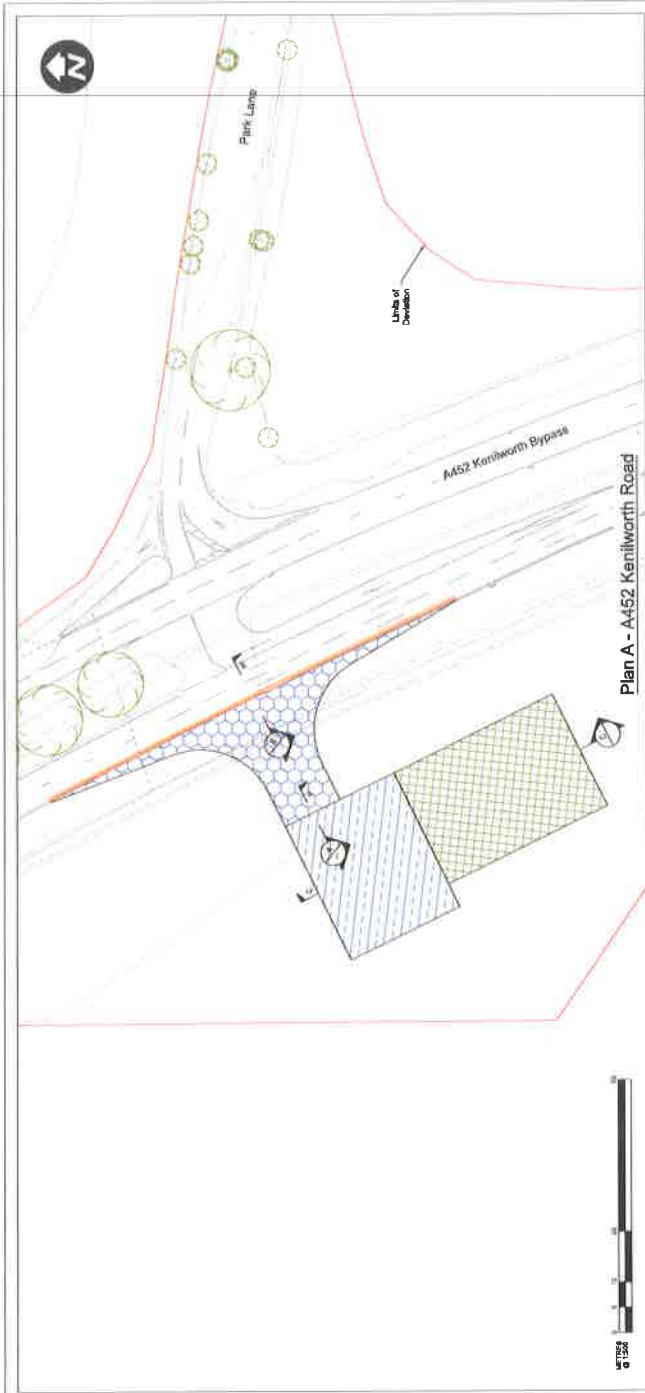

Fit for Approval

Rev	Description	Drawn	Checked	Approved	Date
001	For Approval	WAO	WAO	WAO	20/07/19
002	For Approval	WAO	WAO	WAO	20/07/19
003	For Approval	WAO	WAO	WAO	20/07/19
004	For Approval	WAO	WAO	WAO	20/07/19
005	For Approval	WAO	WAO	WAO	20/07/19
006	For Approval	WAO	WAO	WAO	20/07/19
007	For Approval	WAO	WAO	WAO	20/07/19
008	For Approval	WAO	WAO	WAO	20/07/19
009	For Approval	WAO	WAO	WAO	20/07/19
010	For Approval	WAO	WAO	WAO	20/07/19
011	For Approval	WAO	WAO	WAO	20/07/19
012	For Approval	WAO	WAO	WAO	20/07/19
013	For Approval	WAO	WAO	WAO	20/07/19
014	For Approval	WAO	WAO	WAO	20/07/19
015	For Approval	WAO	WAO	WAO	20/07/19
016	For Approval	WAO	WAO	WAO	20/07/19
017	For Approval	WAO	WAO	WAO	20/07/19
018	For Approval	WAO	WAO	WAO	20/07/19
019	For Approval	WAO	WAO	WAO	20/07/19
020	For Approval	WAO	WAO	WAO	20/07/19
021	For Approval	WAO	WAO	WAO	20/07/19
022	For Approval	WAO	WAO	WAO	20/07/19
023	For Approval	WAO	WAO	WAO	20/07/19
024	For Approval	WAO	WAO	WAO	20/07/19
025	For Approval	WAO	WAO	WAO	20/07/19
026	For Approval	WAO	WAO	WAO	20/07/19
027	For Approval	WAO	WAO	WAO	20/07/19
028	For Approval	WAO	WAO	WAO	20/07/19
029	For Approval	WAO	WAO	WAO	20/07/19
030	For Approval	WAO	WAO	WAO	20/07/19
031	For Approval	WAO	WAO	WAO	20/07/19
032	For Approval	WAO	WAO	WAO	20/07/19
033	For Approval	WAO	WAO	WAO	20/07/19
034	For Approval	WAO	WAO	WAO	20/07/19
035	For Approval	WAO	WAO	WAO	20/07/19
036	For Approval	WAO	WAO	WAO	20/07/19
037	For Approval	WAO	WAO	WAO	20/07/19
038	For Approval	WAO	WAO	WAO	20/07/19
039	For Approval	WAO	WAO	WAO	20/07/19
040	For Approval	WAO	WAO	WAO	20/07/19
041	For Approval	WAO	WAO	WAO	20/07/19
042	For Approval	WAO	WAO	WAO	20/07/19
043	For Approval	WAO	WAO	WAO	20/07/19
044	For Approval	WAO	WAO	WAO	20/07/19
045	For Approval	WAO	WAO	WAO	20/07/19
046	For Approval	WAO	WAO	WAO	20/07/19
047	For Approval	WAO	WAO	WAO	20/07/19
048	For Approval	WAO	WAO	WAO	20/07/19
049	For Approval	WAO	WAO	WAO	20/07/19
050	For Approval	WAO	WAO	WAO	20/07/19
051	For Approval	WAO	WAO	WAO	20/07/19
052	For Approval	WAO	WAO	WAO	20/07/19
053	For Approval	WAO	WAO	WAO	20/07/19
054	For Approval	WAO	WAO	WAO	20/07/19
055	For Approval	WAO	WAO	WAO	20/07/19
056	For Approval	WAO	WAO	WAO	20/07/19
057	For Approval	WAO	WAO	WAO	20/07/19
058	For Approval	WAO	WAO	WAO	20/07/19
059	For Approval	WAO	WAO	WAO	20/07/19
060	For Approval	WAO	WAO	WAO	20/07/19
061	For Approval	WAO	WAO	WAO	20/07/19
062	For Approval	WAO	WAO	WAO	20/07/19
063	For Approval	WAO	WAO	WAO	20/07/19
064	For Approval	WAO	WAO	WAO	20/07/19
065	For Approval	WAO	WAO	WAO	20/07/19
066	For Approval	WAO	WAO	WAO	20/07/19
067	For Approval	WAO	WAO	WAO	20/07/19
068	For Approval	WAO	WAO	WAO	20/07/19
069	For Approval	WAO	WAO	WAO	20/07/19
070	For Approval	WAO	WAO	WAO	20/07/19
071	For Approval	WAO	WAO	WAO	20/07/19
072	For Approval	WAO	WAO	WAO	20/07/19
073	For Approval	WAO	WAO	WAO	20/07/19
074	For Approval	WAO	WAO	WAO	20/07/19
075	For Approval	WAO	WAO	WAO	20/07/19
076	For Approval	WAO	WAO	WAO	20/07/19
077	For Approval	WAO	WAO	WAO	20/07/19
078	For Approval	WAO	WAO	WAO	20/07/19
079	For Approval	WAO	WAO	WAO	20/07/19
080	For Approval	WAO	WAO	WAO	20/07/19
081	For Approval	WAO	WAO	WAO	20/07/19
082	For Approval	WAO	WAO	WAO	20/07/19
083	For Approval	WAO	WAO	WAO	20/07/19
084	For Approval	WAO	WAO	WAO	20/07/19
085	For Approval	WAO	WAO	WAO	20/07/19
086	For Approval	WAO	WAO	WAO	20/07/19
087	For Approval	WAO	WAO	WAO	20/07/19
088	For Approval	WAO	WAO	WAO	20/07/19
089	For Approval	WAO	WAO	WAO	20/07/19
090	For Approval	WAO	WAO	WAO	20/07/19
091	For Approval	WAO	WAO	WAO	20/07/19
092	For Approval	WAO	WAO	WAO	20/07/19
093	For Approval	WAO	WAO	WAO	20/07/19
094	For Approval	WAO	WAO	WAO	20/07/19
095	For Approval	WAO	WAO	WAO	20/07/19
096	For Approval	WAO	WAO	WAO	20/07/19
097	For Approval	WAO	WAO	WAO	20/07/19
098	For Approval	WAO	WAO	WAO	20/07/19
099	For Approval	WAO	WAO	WAO	20/07/19
100	For Approval	WAO	WAO	WAO	20/07/19

HS2
 High Speed Rail
 Infrastructure
 Ltd
 1000 High Street
 Birmingham, B4 7DQ
 UK
 0121 616 1000

OFFICIAL
 Project Manager: LM JV

HS2 Phase 1 Enabling Works North

SA - Issued for LM Approval

5 - Detailed Design

WPO04c
 Park Lane
 Pavement

2005/19
 1:500
 A1

Temporary Access

1. All work shall be in accordance with the relevant British Standards and specifications. The Contractor shall be responsible for ensuring that all work is carried out in accordance with the relevant British Standards and specifications.

2. The Contractor shall be responsible for ensuring that all work is carried out in accordance with the relevant British Standards and specifications.

3. The Contractor shall be responsible for ensuring that all work is carried out in accordance with the relevant British Standards and specifications.

4. The Contractor shall be responsible for ensuring that all work is carried out in accordance with the relevant British Standards and specifications.

5. The Contractor shall be responsible for ensuring that all work is carried out in accordance with the relevant British Standards and specifications.

6. The Contractor shall be responsible for ensuring that all work is carried out in accordance with the relevant British Standards and specifications.

7. The Contractor shall be responsible for ensuring that all work is carried out in accordance with the relevant British Standards and specifications.

8. The Contractor shall be responsible for ensuring that all work is carried out in accordance with the relevant British Standards and specifications.

9. The Contractor shall be responsible for ensuring that all work is carried out in accordance with the relevant British Standards and specifications.

10. The Contractor shall be responsible for ensuring that all work is carried out in accordance with the relevant British Standards and specifications.