

Error! Reference source not found.

Schedule 4 Part 2 paragraph 6 – Temporary Interference

Schedule 33 Part 1, Schedule 2 Part 1

Form TM 1 - PH1-HS2-CL-TEM-000-000001 [Revision Po4]

HS2

HS2 FORM TM1

Highway Authority	Solihull Metropolitan Borough Council
Street(s)/USRN(s)	Waste Lane 35006276
HS2 Consent Reference	THW.AN.SMBC.LMJV.0238
Contractor document reference	1EW04-LMJ-HW-SCH-NS01_NL04-004009
Submission Date (to Highway Authority)	17/06/2019
Proposed start date of works	12/08/2019
Proposed end date of works	16/09/2019
Consultation end/ requested response date	14/07/2019
Deemed consent date (if required)	Click here to enter a date. [28 days from submission date]

Temporary Interference with the Highway

In accordance with the powers set out in the **High Speed Rail (London - West Midlands) Act 2017**, the Contractor, acting on behalf of and, as agent for the Nominated Undertaker, hereby consults the highway authority and/or requests highway authority consent under Schedule 2, 4 and/or 33 as identified below:

Consultation with the highway authority:	
The temporary interference / works is on a street or location that <u>is listed</u> in Table 3 of Schedule 4 to the Act (Schedule 4 Part 2 paragraph 6)	<input checked="" type="checkbox"/>
Consent of the highway authority:	
The temporary interference / works is on a street or location <u>not listed</u> in Table 3 of Schedule 4 of the Act (Schedule 4 Part 2 paragraph 6)	<input type="checkbox"/>
Trial holes (Schedule 2 only)	<input type="checkbox"/>
Protective provisions (Schedule 33) [mark as appropriate]	
Works to a bridge requiring temporary interference, (Schedule 33 para 6)	<input type="checkbox"/>
Alteration/disturbance to apparatus of the highway authority affixed to or placed under any highway or, access to the apparatus of the Highway Authority, (Schedule 33 Para 9)	<input type="checkbox"/>
Depositing soil or materials or storing plant on the highway (Schedule 33 Para 12)	<input type="checkbox"/>
Erection of scaffolding or screening (or hoarding) in the highway (Schedule 33 Para 12)	<input type="checkbox"/>

Error! Reference source not found.

Schedule 4 Part 2 paragraph 6 – Temporary Interference

Schedule 33 Part 1, Schedule 2 Part 1

Form TM 1 - PH1-HS2-CL-TEM-000-000001 [Revision Po4]



Table 1. High level summary <i>(mark as appropriate)</i>	Alteration to apparatus of the highway authority	<input type="checkbox"/>	Deposit of material on the highway	<input type="checkbox"/>	Footway Works only	<input type="checkbox"/>	Peak hours	<input type="checkbox"/>	Works to PRow	<input type="checkbox"/>	Give and Take	<input type="checkbox"/>	Contra - flow	<input type="checkbox"/>	Lane Closure	<input type="checkbox"/>	Portable temporary traffic signals (<i>delete as required</i>) 2-way multiphase	<input checked="" type="checkbox"/>	Priority working	<input type="checkbox"/>	Narrowing of Lane	<input type="checkbox"/>
	Trial holes	<input type="checkbox"/>	Erection of scaffolding/hoarding	<input type="checkbox"/>	Works in the carriageway	<input type="checkbox"/>	Off Peak	<input type="checkbox"/>	Street works (NRSWA)	<input type="checkbox"/>	Stop / Go	<input type="checkbox"/>	Signage only	<input type="checkbox"/>	Road Closure	<input type="checkbox"/>	Works to existing or new traffic signals infrastructure	<input type="checkbox"/>	Associated utility works	<input type="checkbox"/>	Other	<input type="checkbox"/>

Table 2. Detailed works description, traffic management phasing and intended programme

Row No.	Road name	Extent of Temporary Interference	Consent or Consultation	USRN	Grid Ref	EToN reference	TM Phase	TM drawing reference	Description of works	Description of associated traffic management	TM operational hours	Proposed Works Start Date	Estimated Works End Date
1.	Waste Lane	Old Waste Lane to Kenilworth Green Way	Consultation	35006276	SP256765	NA	Single Phase	13395.002 13395.003	Creation of site access	2-way portable traffic signals	8am to 6pm	12/08/2019	16/09/2019

Details of pre-application discussions with the Highway Authority and stakeholders

Date	Details
13/06/2019	Details discussed at SBMC TLG
Click here to enter a date.	
Click here to enter a date.	

Details of associated consents/approvals

--

Document references and supporting information

Title	Phase (from Table 2)	Reference	Version
2 way traffic signals		13395.002	
2 way traffic signals		13395.003	

Contractor Signature

This submission is made by the Contractor on behalf of and as agent for the Nominated Undertaker.
 HS2 Ltd authorises the contractor to submit the application for consultation or, as required, consent of the highway authority
[Contractor must obtain acceptance from HS2 before submitting the form to the highway authority]

Contractor	LM-JV Cornerblock, Two Cornwall Street, Birmingham, B3 2DX
Contractor Authorised Signatory	 Wayne Skells, Traffic Manager – 07784 168617
Contractor Site Contact Details	Adrian Grocott Project Manager Buckingham Group Contracting Limited – 07582 999059

Highway Authority Response Sheet

To be completed by the Highway Authority and provided as a response to the application

HS2 Consent Reference:	
Street(s):	
Submission Date:	
Response Date:	

Local Highway Authority Response

Highway Authority:	
---------------------------	--

Decision on the application by the highway authority, if consent is required:

Consent granted <input type="checkbox"/>	<i>If consent withheld or consent with comments, state ground(s) below:</i>
Consent granted with comments <input type="checkbox"/>	
Consent withheld <input type="checkbox"/>	
Consultation <input type="checkbox"/>	<i>[Insert comments on consultation]</i>

Signature: _____ Date: _____

Name of highway authority's authorised representative: _____

Vehicle Actuated phase timings

Phase 1: B4101 WASTE LANE NB	Red	15s	→
	Green	45s	
Phase 2: B4101 WASTE LANE SB	Red	15s	←
	Green	45s	

Please note: Timings may only be adjusted by a qualified operative to suit changing traffic conditions if required.

KEY

- Sign
- Cone
- ▨ Work area
- ▨ Closed area
- ↑ Traffic light head
- PH1 Traffic light phase

DETAIL B

Single/Dual carriageway 40mph or less - 450mm traffic cones, spacing 1.5m.
 Single/Dual carriageway 50mph or more - 750mm traffic cones, spacing 1.5m.
 Dual carriageway national speed limit - 750mm traffic cones, spacing 1.5m, relaxation 3m.

Notes:
 1) During darkness, warning lights to BS EN 12352:2006 should be provided in accordance with Table A1.3 (Appendix 1).
 2) 45° tapered cones have 1.5m spacing, no relaxations.
 3) On motorways and NSL AP roads with hard shoulders, 1m cones will be required for both standard and relaxation works for lead tapers and the facing wall of lane changes.

DETAIL C1

Single/Dual carriageway 40mph or less - 450mm traffic cones, spacing 1.5m.
 Single/Dual carriageway 50mph or more - 750mm traffic cones, spacing 1.5m.

Notes:
 1) During darkness, warning lights to BS EN 12352:2006 should be provided in accordance with Table A1.3 (Appendix 1).
 2) For relaxation to Detail C1 see Table A1.3 (Appendix 1).

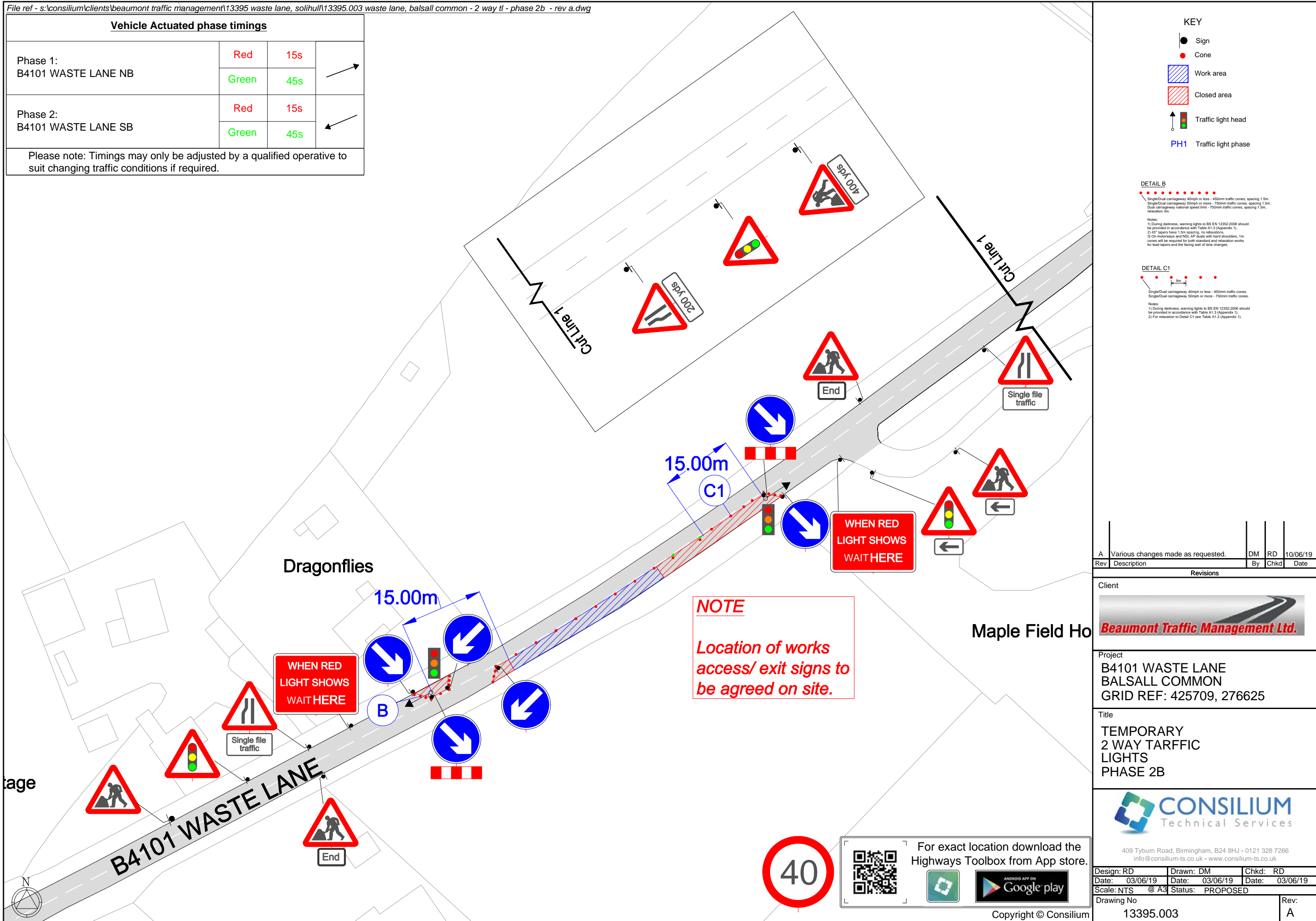

NOTE
 Location of works access/ exit signs to be agreed on site.

Rev	Description	By	Chkd	Date
A	Various changes made as requested.	DM	RD	10/06/19

Client

Project
 B4101 WASTE LANE
 BALSALL COMMON
 GRID REF: 425709, 276625

Title
 TEMPORARY
 2 WAY TRAFFIC
 LIGHTS
 PHASE 2B

409 Tyburn Road, Birmingham, B24 8JU - 0121 328 7266
 info@consilium-ts.co.uk - www.consilium-ts.co.uk

Design: RD	Drawn: DM	Chkd: RD
Date: 03/06/19	Date: 03/06/19	Date: 03/06/19
Scale: NTS @ A3	Status: PROPOSED	
Drawing No	13395.003	Rev: A

For exact location download the Highways Toolbox from App store.

Vehicle Actuated phase timings

Phase 1: B4101 WASTE LANE NB	Red	15s	→
	Green	45s	
Phase 2: B4101 WASTE LANE SB	Red	15s	←
	Green	45s	
Please note: Timings may only be adjusted by a qualified operative to suit changing traffic conditions if required.			

KEY

- Sign
- Cone
- ▨ Work area
- ▨ Closed area
- ↑ Traffic light head
- PH1 Traffic light phase

DETAIL B

Single/Dual carriageway 40mph or less - 450mm traffic cones, spacing 1.5m.
 Single/Dual carriageway 50mph or more - 750mm traffic cones, spacing 1.5m.
 Dual carriageway national speed limit - 750mm traffic cones, spacing 1.5m, relaxation 3m.

Notes:
 1) During darkness, warning lights to BS EN 12352:2006 should be provided in accordance with Table A1.3 (Appendix 1).
 2) 45° tapered cones have 1.5m spacing, no relaxations.
 3) On motorways and NSL/AP roads with hard shoulders, 1m cones will be required for both standard and relaxation works for least tapers and the facing wall of lane changes.

DETAIL C1

Single/Dual carriageway 40mph or less - 450mm traffic cones, spacing 1.5m.
 Single/Dual carriageway 50mph or more - 750mm traffic cones, spacing 1.5m.

Notes:
 1) During darkness, warning lights to BS EN 12352:2006 should be provided in accordance with Table A1.3 (Appendix 1).
 2) For relaxation to Detail C1 see Table A1.3 (Appendix 1).

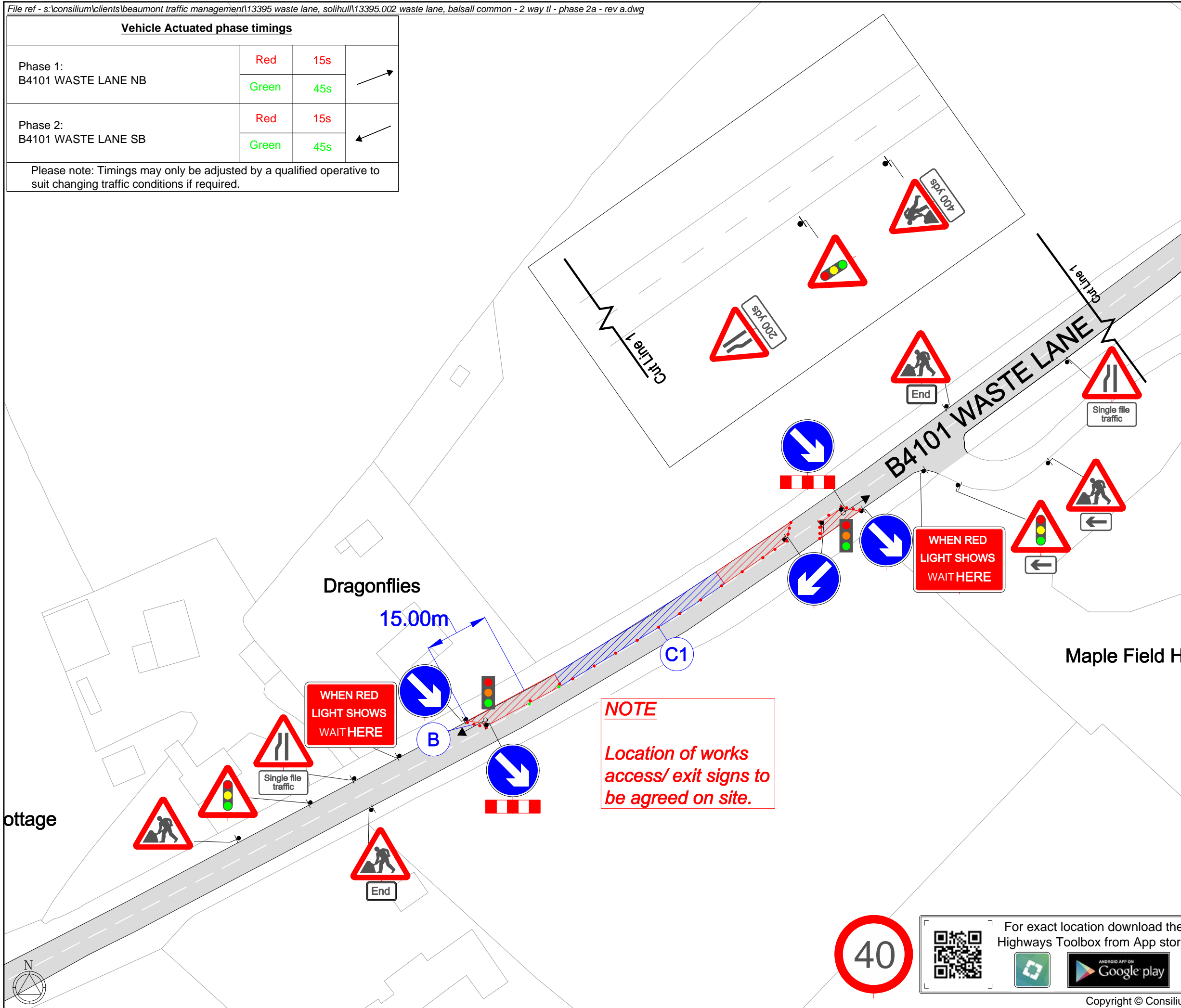

Dragonflies

15.00m

WHEN RED LIGHT SHOWS WAIT HERE

NOTE
 Location of works access/ exit signs to be agreed on site.

Maple Field Ho



For exact location download the Highways Toolbox from App store.

Rev	Description	By	Chkd	Date
A	Various changes made as requested.	DM	RD	10/06/19

Client
Beaumont Traffic Management Ltd.

Project
 B4101 WASTE LANE
 BALSALL COMMON
 GRID REF: 425709, 276625

Title
 TEMPORARY
 2 WAY TRAFFIC
 LIGHTS
 PHASE 2A

CONSILIUM
 Technical Services
 409 Tyburn Road, Birmingham, B24 8JU - 0121 328 7266
 info@consilium-ts.co.uk - www.consilium-ts.co.uk

Design: RD	Drawn: DM	Chkd: RD
Date: 03/06/19	Date: 03/06/19	Date: 03/06/19
Scale: NTS @ A3	Status: PROPOSED	
Drawing No 13395.002	Rev: A	