

HS2 FORM TM1

Highway Authority	Solihull Metropolitan Borough Council
Street(s)/USRN(s)	A452, Bickenhill Parkway, Bickenhill Lane, Airport Way, Coventry Road, Packington Lane
HS2 Consent Reference	THW.AN.SMBC.LMJV.0248
Contractor document reference	1EW04-LMJ-HW-SCH-NS07-106009 C02
Submission Date (to Highway Authority)	26/06/2019
Proposed start date of works	11/09/2019
Proposed end date of works	12/09/2019
Consultation end/ requested response date	24/07/2019
Deemed consent date (if required)	24/07/2019

Temporary Interference with the Highway

In accordance with the powers set out in the **High Speed Rail (London - West Midlands) Act 2017**, the Contractor, acting on behalf of and, as agent for the Nominated Undertaker, hereby consults the highway authority and/or requests highway authority consent under Schedule 2, 4 and/or 33 as identified below:

Consultation with the highway authority:	
The temporary interference / works is on a street or location that <u>is listed</u> in Table 3 of Schedule 4 to the Act (Schedule 4 Part 2 paragraph 6)	<input type="checkbox"/>
Consent of the highway authority:	
The temporary interference / works is on a street or location <u>not listed</u> in Table 3 of Schedule 4 of the Act (Schedule 4 Part 2 paragraph 6)	<input checked="" type="checkbox"/>
Trial holes (Schedule 2 only)	<input type="checkbox"/>
Protective provisions (Schedule 33) [mark as appropriate]	
Works to a bridge requiring temporary interference, (Schedule 33 para 6)	<input type="checkbox"/>
Alteration/disturbance to apparatus of the highway authority affixed to or placed under any highway or, access to the apparatus of the Highway Authority, (Schedule 33 Para 9)	<input type="checkbox"/>
Depositing soil or materials or storing plant on the highway (Schedule 33 Para 12)	<input type="checkbox"/>
Erection of scaffolding or screening (or hoarding) in the highway (Schedule 33 Para 12)	<input type="checkbox"/>

Table 1. High level summary <i>(mark as appropriate)</i>	Alteration to apparatus of the highway authority	<input type="checkbox"/>	Deposit of material on the highway	<input type="checkbox"/>	Footway Works only	<input type="checkbox"/>	Peak hours	<input type="checkbox"/>	Works to PRow	<input type="checkbox"/>	Give and Take	<input type="checkbox"/>	Contra - flow	<input type="checkbox"/>	Lane Closure	<input checked="" type="checkbox"/>	Portable temporary traffic signals (<i>delete as required</i>) 2-way multiphase	<input type="checkbox"/>	Priority working	<input type="checkbox"/>	Narrowing of Lane	<input type="checkbox"/>
	Trial holes	<input type="checkbox"/>	Erection of scaffolding/hoarding	<input type="checkbox"/>	Works in the carriageway	<input type="checkbox"/>	Off Peak	<input type="checkbox"/>	Street works (NRSWA)	<input type="checkbox"/>	Stop / Go	<input type="checkbox"/>	Signage only	<input checked="" type="checkbox"/>	Road Closure	<input checked="" type="checkbox"/>	Works to existing or new traffic signals infrastructure	<input type="checkbox"/>	Associated utility works	<input type="checkbox"/>	Other	<input type="checkbox"/>

Table 2. Detailed works description, traffic management phasing and intended programme

Row No.	Road name	Extent of Temporary Interference	Consent or Consultation	USRN	Grid Ref	EToN reference	TM Phase	TM drawing reference	Description of works	Description of associated traffic management	TM operational hours	Proposed Works Start Date	Estimated Works End Date
1	A452	Molands roundabout to Stonebridge roundabout	Consent	35010030	SP217823	NA	Single Phase	001	Gas main diversion	Northbound Lane closure	8pm to 6am	11/09/2019	12/09/2019
2	Coventry Road	A45 to Airport Way	Consent	35000845	SP186828	NA	Choose an item.	002	Gas main diversion	Northbound A452/A446 diversion route	8pm to 6am	11/09/2019	12/09/2019
3	Airport Way	Coventry Road to Bickenhill Lane	Consent	35005471	SP185832	NA	Choose an item.	002	Gas main diversion	Northbound A452/A446 diversion route	8pm to 6am	11/09/2019	12/09/2019
4	Bickenhill Lane	Airport Way to Bickenhill Parkway	Consent	35005490	SP185838	NA	Choose an item.	002	Gas main diversion	Northbound A452/A446 diversion route	8pm to 6am	11/09/2019	12/09/2019
5	Bickenhill Parkway	Bickenhill Lane to Northway Island	Consent	35006577	SP192850	NA	Single Phase	002	Gas main diversion	Northbound A452/A446 diversion route	8pm to 6am	11/09/2019	12/09/2019
6	Packington Lane	A452 to Middle Bickenhill Lane	Consent	35004552	SP205841	NA	Single Phase	002	Gas main diversion	Northbound A452/A446 diversion route	8pm to 6am	11/09/2019	12/09/2019
7	A452	A446 to Northway Island	Consent	35006662	SP203844	NA	Single Phase	003	Gas main diversion & Barrier installation	Northbound Lane closure	24/7	11/09/2019	18/10/2019

Details of pre-application discussions with the Highway Authority and stakeholders

Date	Details
13/06/2019	Details discussed at SMBC TLG
Click here to enter a date.	
Click here to enter a date.	

Details of associated consents/approvals

Schedule 4 part 2 #247 & 249

Document references and supporting information

Title	Phase (from Table 2)	Reference	Version
Northbound Lane closure		001	
Northbound A452/A446 diversion route		002	
Northbound A452/A446 diversion route		002	
Northbound A452/A446 diversion route		002	
Northbound A452/A446 diversion route		002	
Gas main diversion & Barrier installation		003	

Contractor Signature

This submission is made by the Contractor on behalf of and as agent for the Nominated Undertaker.
 HS2 Ltd authorises the contractor to submit the application for consultation or, as required, consent of the highway authority
[Contractor must obtain acceptance from HS2 before submitting the form to the highway authority]

Contractor	LM-JV Cornerblock, Two Cornwall Street, Birmingham, B3 2DX
-------------------	--

Contractor Authorised Signatory	 Wayne Skells, Traffic Manager
--	--

Contractor Site Contact Details	
--	--

Highway Authority Response Sheet

To be completed by the Highway Authority and provided as a response to the application

HS2 Consent Reference:	
Street(s):	
Submission Date:	
Response Date:	

Local Highway Authority Response

Highway Authority:	
---------------------------	--

Decision on the application by the highway authority, if consent is required:

Consent granted <input type="checkbox"/>	<i>If consent withheld or consent with comments, state ground(s) below:</i>
Consent granted with comments <input type="checkbox"/>	
Consent withheld <input type="checkbox"/>	
Consultation <input type="checkbox"/>	<i>[Insert comments on consultation]</i>

Signature: _____ Date: _____

Name of highway authority's authorised representative: _____

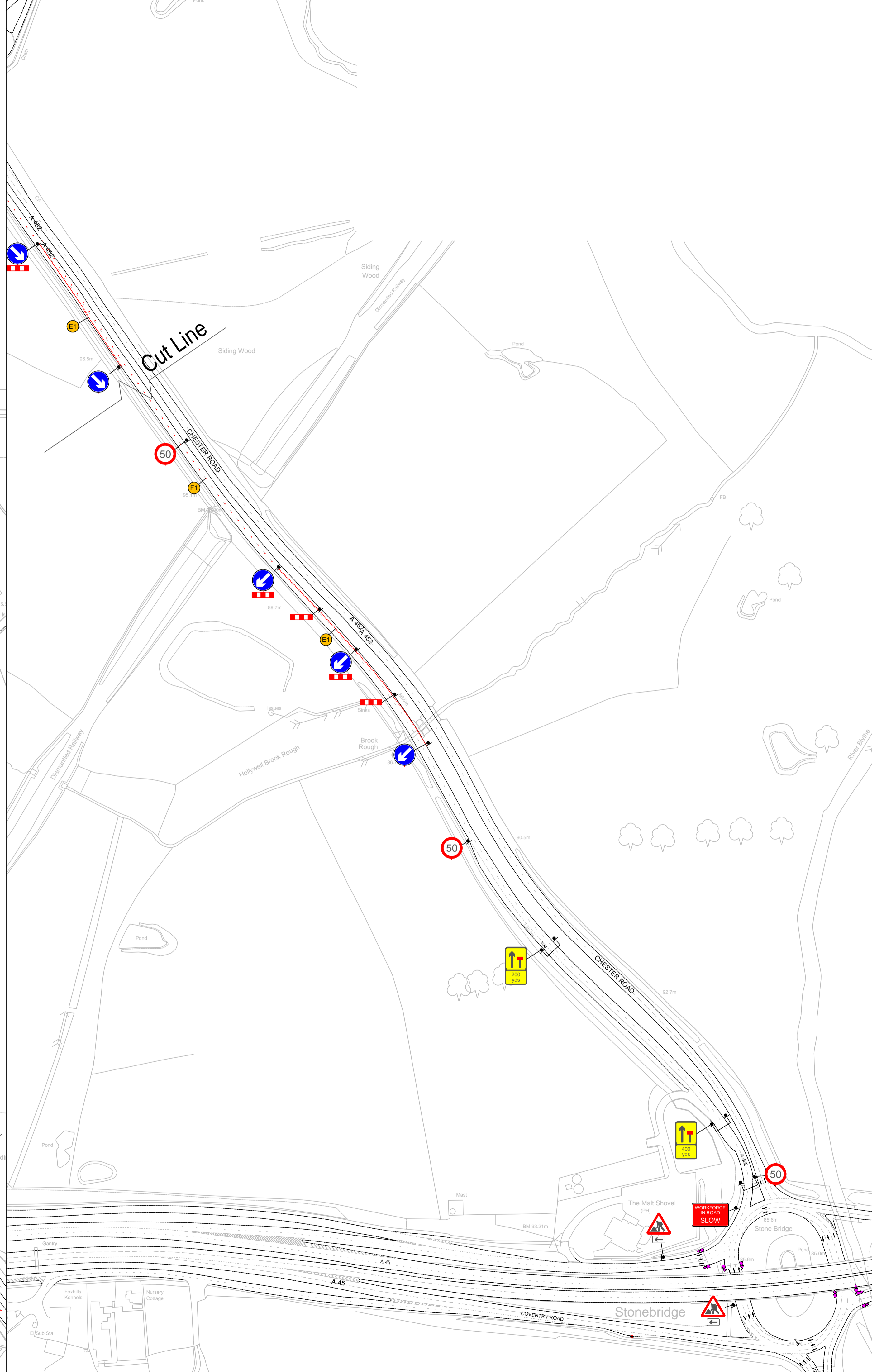
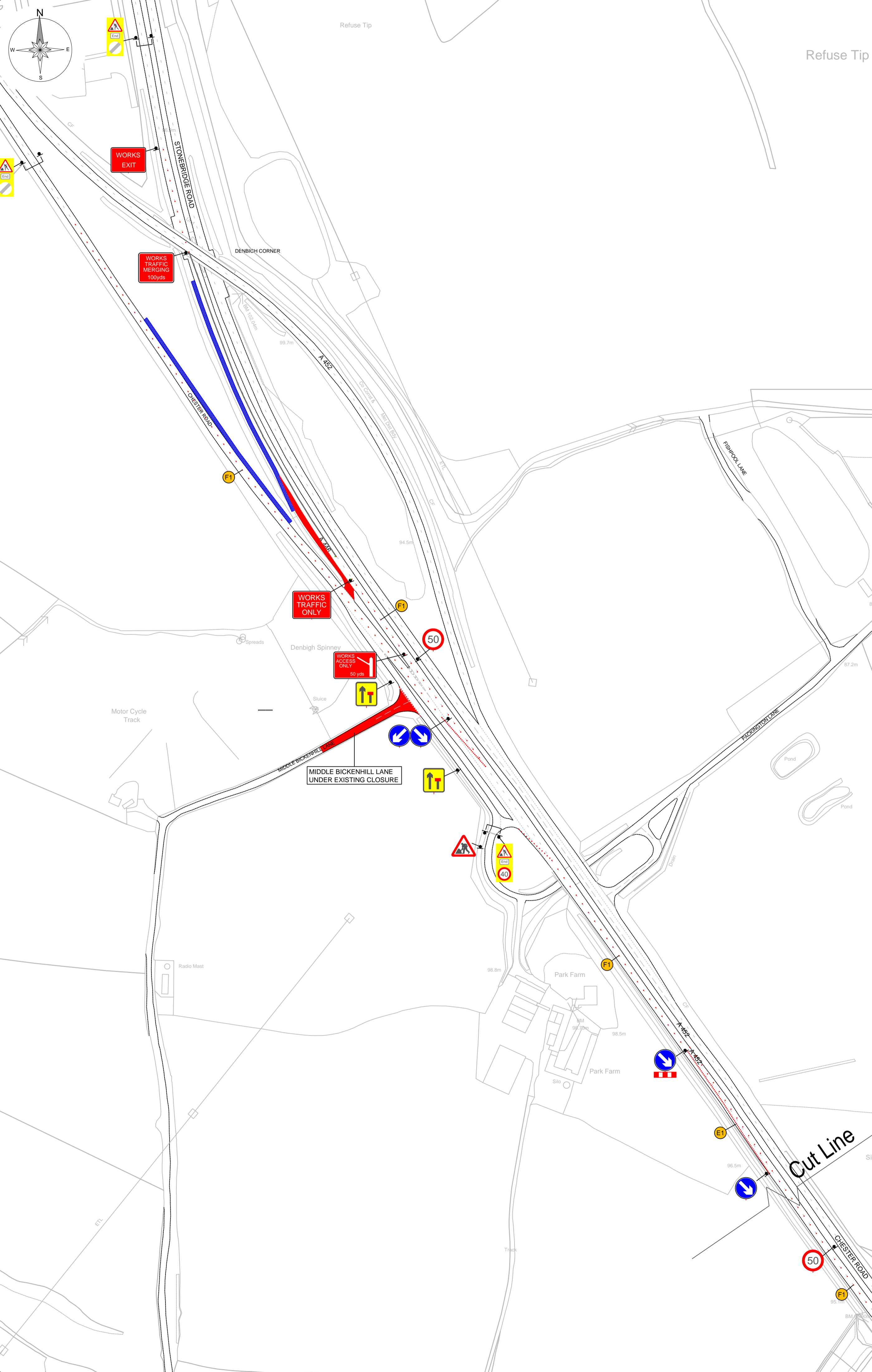

Key:	
	Line of Works
	Works Area
	Road Closure
	Diversion Route
	Cone
	Pedestrian Barrier
	Temporary Sign
	Temporary Traffic Signal
	Stop & Go Board
	Permanent Traffic Signal
	Temporary Ped Signal
	Existing Bus Stop
	3.5T Van

Notes:	
Min width of sideways safety zone (S)	1.2m
Min length of longways clearance (L)	100m
A452 Chester Road	

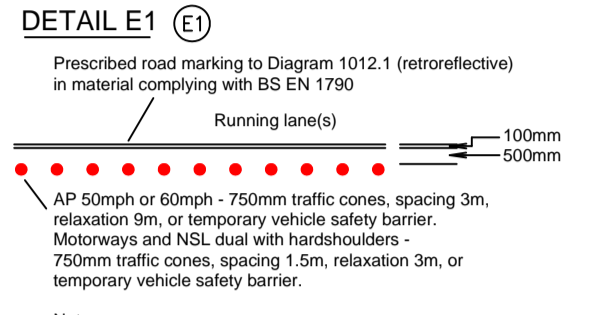

Notes:
 1) During darkness, warning lights to BS EN 12352:2006 should be provided in accordance with Table A1.3 (Appendix 1).
 2) On motorway and NSL AP duals with hard shoulders, 1m cones will be required for both standard and relaxation works for lead tapers and the facing wall of lane changes.

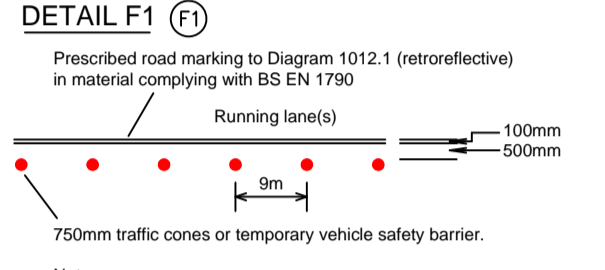

Notes:
 1) During darkness, warning lights to BS EN 12352:2006 should be provided in accordance with Table A1.3 (Appendix 1).

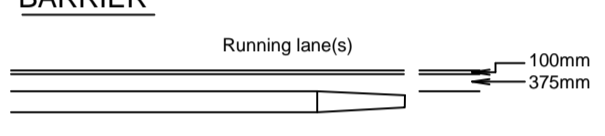

Rev	Date	Comments	By
A	05/07/2019	Additional works area added	CM

MURPHY
 LAND & MARINE
 Working in Partnership with
traffix
 total traffic & event management solutions
 Old Arden Brickworks | Bickenhill | Solihull | West Midlands | B92 0DY
 t +44 (0)900 819 9001 | f +44 (0)1675 442507
 info@traffixuk.com | www.traffixuk.com

Project title:			
Traffic Management			
Gas Main Diversion Works			
Proposed Road Closure Diversion			
A452 Chester Road Lane One Closure			
Bickenhill			
B92 0DY			
Date:	Scale:	Paper:	
17/06/2019	1:2000	A1	
Drawn:	Checked:	Approved:	
CM	BNH	SM	
Project Number:	Drawing Number:	Revision:	
TFX SC0035	003	A	

This drawing is copyright & the property of Traffic & must not be copied in whole or in part without their written permission. Copyright is reserved. © This drawing must not be scaled.
 The Contractor is to report all discrepancies & errors to the Contract Manager prior to works commencing.