

HS2 FORM TM1

Highway Authority	Solihull Metropolitan Borough Council
Street(s)/USRN(s)	A452 35006662
HS2 Consent Reference	THW.AN.SMBC.LMJV.0252
Contractor document reference	1EW04-LMJ-HW-SCH-N003-060005
Submission Date (to Highway Authority)	05/07/2019
Proposed start date of works	29/07/2019
Proposed end date of works	24/08/2019
Consultation end/ requested response date	26/07/2019
Deemed consent date (if required)	01/08/2019

Temporary Interference with the Highway

In accordance with the powers set out in the **High Speed Rail (London - West Midlands) Act 2017**, the Contractor, acting on behalf of and, as agent for the Nominated Undertaker, hereby consults the highway authority and/or requests highway authority consent under Schedule 2, 4 and/or 33 as identified below:

Consultation with the highway authority:	
The temporary interference / works is on a street or location that <u>is listed</u> in Table 3 of Schedule 4 to the Act (Schedule 4 Part 2 paragraph 6)	<input checked="" type="checkbox"/>
Consent of the highway authority:	
The temporary interference / works is on a street or location <u>not listed</u> in Table 3 of Schedule 4 of the Act (Schedule 4 Part 2 paragraph 6)	<input type="checkbox"/>
Trial holes (Schedule 2 only)	<input type="checkbox"/>
Protective provisions (Schedule 33) [mark as appropriate]	
Works to a bridge requiring temporary interference, (Schedule 33 para 6)	<input type="checkbox"/>
Alteration/disturbance to apparatus of the highway authority affixed to or placed under any highway or, access to the apparatus of the Highway Authority, (Schedule 33 Para 9)	<input type="checkbox"/>
Depositing soil or materials or storing plant on the highway (Schedule 33 Para 12)	<input type="checkbox"/>
Erection of scaffolding or screening (or hoarding) in the highway (Schedule 33 Para 12)	<input type="checkbox"/>

Table 1. High level summary <i>(mark as appropriate)</i>	Alteration to apparatus of the highway authority	<input type="checkbox"/>	Deposit of material on the highway	<input type="checkbox"/>	Footway Works only	<input type="checkbox"/>	Peak hours	<input type="checkbox"/>	Works to PRow	<input type="checkbox"/>	Give and Take	<input type="checkbox"/>	Contra - flow	<input type="checkbox"/>	Lane Closure	<input checked="" type="checkbox"/>	Portable temporary traffic signals (<i>delete as required</i>) 2-way multiphase	<input type="checkbox"/>	Priority working	<input type="checkbox"/>	Narrowing of Lane	<input type="checkbox"/>
	Trial holes	<input type="checkbox"/>	Erection of scaffolding/hoarding	<input type="checkbox"/>	Works in the carriageway	<input type="checkbox"/>	Off Peak	<input type="checkbox"/>	Street works (NRSWA)	<input type="checkbox"/>	Stop / Go	<input type="checkbox"/>	Signage only	<input type="checkbox"/>	Road Closure	<input checked="" type="checkbox"/>	Works to existing or new traffic signals infrastructure	<input type="checkbox"/>	Associated utility works	<input type="checkbox"/>	Other (Barrier placed on verge)	<input checked="" type="checkbox"/>

Table 2. Detailed works description, traffic management phasing and intended programme

Row No.	Road name	Extent of Temporary Interference	Consent or Consultation	USRN	Grid Ref	EToN reference	TM Phase	TM drawing reference	Description of works	Description of associated traffic management	TM operational hours	Proposed Works Start Date	Estimated Works End Date
1	A452	Northway Island to Stonebridge Island	Consultation	35006662	SP204845	NA	Phase 1	E002	Ground preparation for temporary barrier installation	Southbound Lane closure	9.30am to 3.30pm	29/07/2019	02/08/2019
2	A452	Northway Island to Stonebridge Island	Consultation	35006662	SP204845	NA	Phase 2	E003	Temporary barrier installation	Southbound Road closure	8pm to 6am	19/08/2019	24/08/2019

Details of pre-application discussions with the Highway Authority and stakeholders

Date	Details
11/04/2019	Details and locations tabled at TLG
09/05/2019	Details and locations tabled at TLG
13/06/2019	Details and locations tabled at TLG

Details of associated consents/approvals

--

Document references and supporting information

Title	Phase (from Table 2)	Reference	Version
A452 Southbound Lane closure	1	E002	A
A452 Southbound Road closure	2	E003	A
A452 Temporary Barrier not on carriageway			

Contractor Signature

This submission is made by the Contractor on behalf of and as agent for the Nominated Undertaker.
 HS2 Ltd authorises the contractor to submit the application for consultation or, as required, consent of the highway authority
[Contractor must obtain acceptance from HS2 before submitting the form to the highway authority]

Contractor	LM-JV Cornerblock, Two Cornwall Street, Birmingham, B3 2DX
-------------------	--

Contractor Authorised Signatory	 Wayne Skells, Traffic Manager
---	--

Contractor Site Contact Details	LM – Richard Coy – 07446 941874
---	---------------------------------

Highway Authority Response Sheet

To be completed by the Highway Authority and provided as a response to the application

HS2 Consent Reference:	
Street(s):	
Submission Date:	
Response Date:	

Local Highway Authority Response

Highway Authority:	
---------------------------	--

Decision on the application by the highway authority, if consent is required:

Consent granted <input type="checkbox"/>	<i>If consent withheld or consent with comments, state ground(s) below:</i>
Consent granted with comments <input type="checkbox"/>	
Consent withheld <input type="checkbox"/>	
Consultation <input type="checkbox"/>	<i>[Insert comments on consultation]</i>

Signature: _____ Date: _____

Name of highway authority's authorised representative: _____

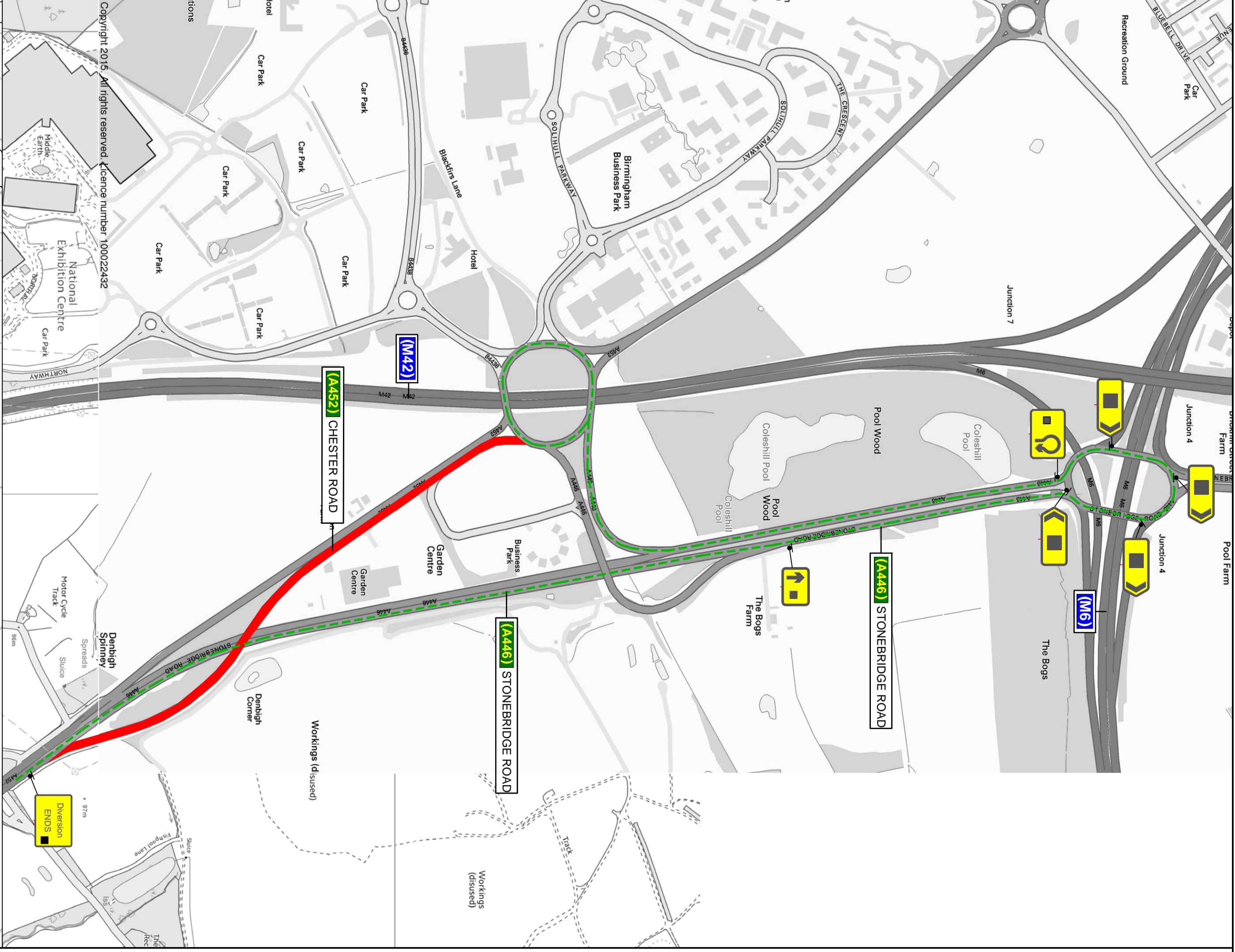
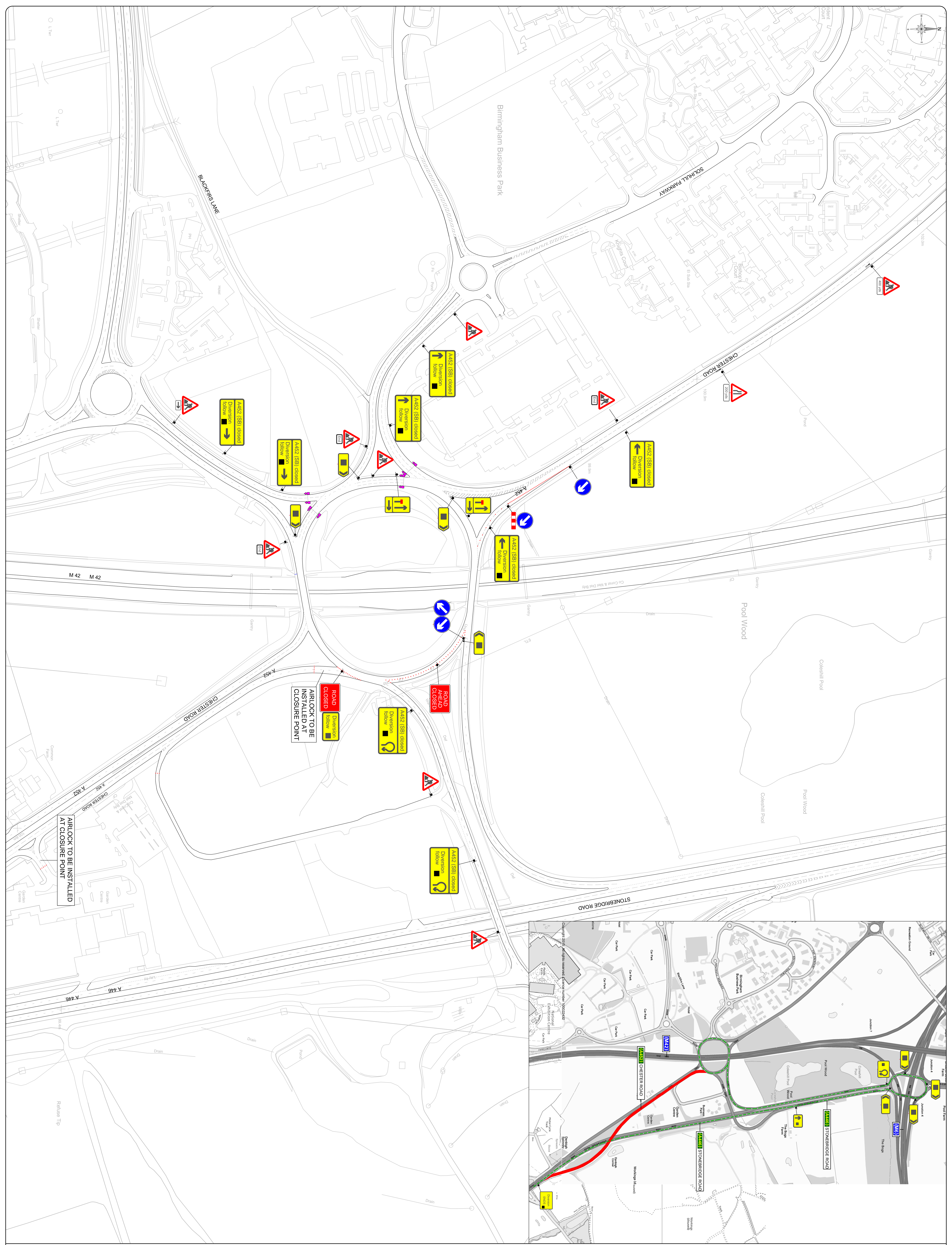

Signs	
	Temporary Traffic Sign
	Blue & White Sign
	Red & White Sign
	Yellow Diamond Sign
	Blue Circular Sign
	Yellow Rectangular Sign
	Red Rectangular Sign
	Blue Rectangular Sign
	Yellow Rectangular Sign with Black Border
	Red Rectangular Sign with White Border
	Blue Rectangular Sign with White Border
	Yellow Rectangular Sign with Black Border and Text
	Red Rectangular Sign with White Border and Text
	Blue Rectangular Sign with White Border and Text
	Yellow Rectangular Sign with Black Border and Text
	Red Rectangular Sign with White Border and Text
	Blue Rectangular Sign with White Border and Text

Notes	
Min width of signage (width zone S)	1.2m
Min width of signage (width zone U)	100m
Min width of signage (width zone L)	100m
Min width of signage (width zone M)	100m
Min width of signage (width zone N)	100m
Min width of signage (width zone O)	100m
Min width of signage (width zone P)	100m
Min width of signage (width zone Q)	100m
Min width of signage (width zone R)	100m
Min width of signage (width zone S)	100m
Min width of signage (width zone T)	100m
Min width of signage (width zone U)	100m
Min width of signage (width zone V)	100m
Min width of signage (width zone W)	100m
Min width of signage (width zone X)	100m
Min width of signage (width zone Y)	100m
Min width of signage (width zone Z)	100m

Working in Partnership with	
	expanded
	traffix

Traffic Management	
Project Reference	Proposed Road Closure Diversion
Client	Local Council
Contract Reference	Proposed Road Closure Diversion
Contract Value	£100,000
Contract Start	1st Nov 2024
Contract End	31st Dec 2024
Contract Status	Active
Contract Manager	John Smith
Contract Location	Birmingham Business Park
Contract Description	Proposed Road Closure Diversion
Contract Reference	Proposed Road Closure Diversion
Contract Value	£100,000
Contract Start	1st Nov 2024
Contract End	31st Dec 2024
Contract Status	Active
Contract Manager	John Smith
Contract Location	Birmingham Business Park
Contract Description	Proposed Road Closure Diversion

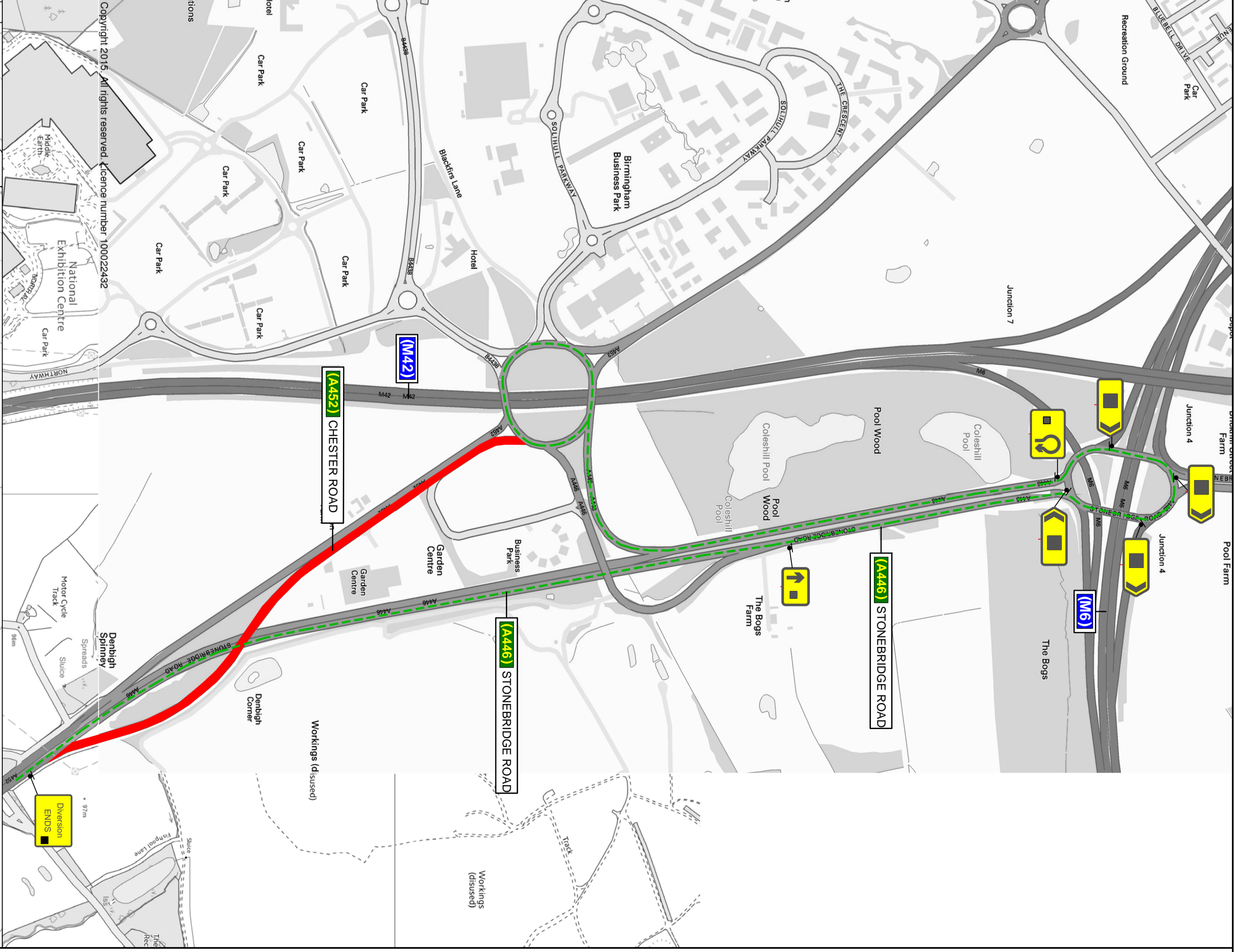
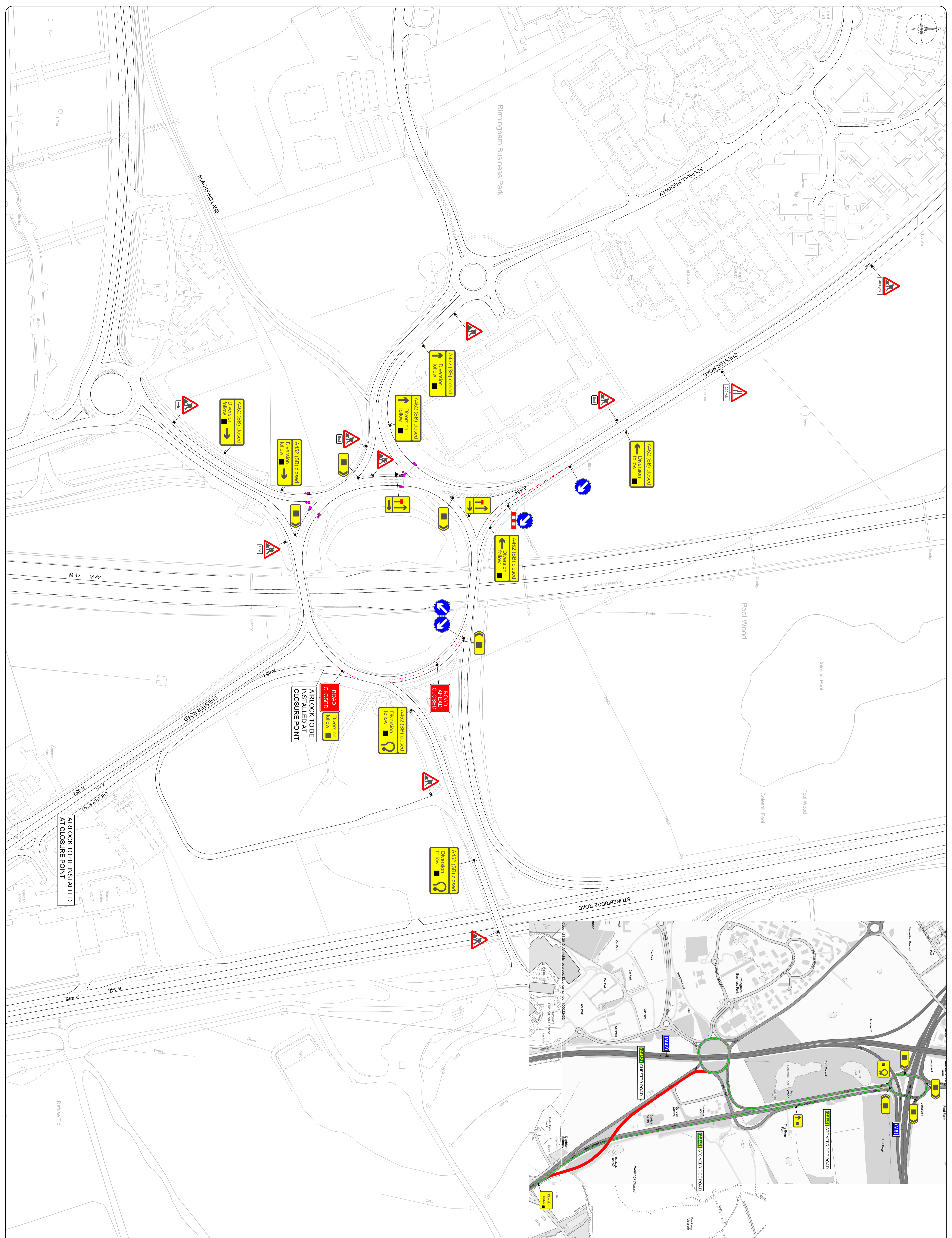

Working in Partnership with	
Traffic Management Bridge Installation Proposed Road Closure Diversion A462 Chester Road (SB)	
DATE 04/03/2018	SCALE 1:1000
CLIENT Network Rail	PROJECT NO. 140000
CONTRACT NO. 04/03/2018	DATE 04/03/2018
PROJECT NO. 140000	SCALE 1:1000
CLIENT Network Rail	PROJECT NO. 140000
CONTRACT NO. 04/03/2018	DATE 04/03/2018

This drawing is intended for use by Network Rail in connection with the proposed project. It is not to be used for any other purpose without the written consent of Network Rail. Network Rail reserves the right to amend this drawing without notice.

TRAFFIX 0121 754 6666 www.traffix.co.uk	PROJECT NO. 140000	SCALE 1:1000	DATE 04/03/2018
--	------------------------------	------------------------	---------------------------

TRAFFIX is a leading provider of traffic management solutions, offering a range of services including traffic management planning, site management, and traffic control.

TRAFFIX 0121 754 6666 www.traffix.co.uk	PROJECT NO. 140000	SCALE 1:1000	DATE 04/03/2018
--	------------------------------	------------------------	---------------------------

TRAFFIX is a leading provider of traffic management solutions, offering a range of services including traffic management planning, site management, and traffic control.