

## HS2 FORM TM1

<b>Highway Authority</b>	Solihull Metropolitan Borough Council
<b>Street(s)/USRN(s)</b>	A452 Chester Road, Northway Island
<b>HS2 Consent Reference</b>	THW.AN.SMBC.LMJV.0315
<b>Contractor document reference</b>	1EW04-LMJ-HW-SCH-NS07-N003-049006
<b>Submission Date (to Highway Authority)</b>	08/10/2019
<b>Proposed start date of consent</b>	25/11/2019
<b>Proposed end date of consent</b>	27/11/2019
<b>Consultation end/ requested response date</b>	01/11/2019
<b>Deemed consent date (if required)</b>	05/11/2019

## Temporary Interference with the Highway

In accordance with the powers set out in the **High Speed Rail (London - West Midlands) Act 2017**, the Contractor, acting on behalf of and, as agent for the Nominated Undertaker, hereby consults the highway authority and/or requests highway authority consent under Schedule 2, 4 and/or 33 as identified below:

<b>Consultation with the highway authority:</b>	
The temporary interference / works is on a street or location that <b>is listed</b> in Table 3 of Schedule 4 to the Act ( <b>Schedule 4 Part 2 paragraph 6</b> )	<input type="checkbox"/>
<b>Consent of the highway authority:</b>	
The temporary interference / works is on a street or location <b>not listed</b> in Table 3 of Schedule 4 of the Act ( <b>Schedule 4 Part 2 paragraph 6</b> )	<input checked="" type="checkbox"/>
<b>Trial holes (Schedule 2 only)</b>	<input type="checkbox"/>
<b>Protective provisions (Schedule 33)</b> <i>[mark as appropriate]</i>	
Works to a bridge requiring temporary interference, ( <b>Schedule 33 para 6</b> )	<input type="checkbox"/>
Alteration/disturbance to apparatus of the highway authority affixed to or placed under any highway or, access to the apparatus of the Highway Authority, ( <b>Schedule 33 Para 9</b> )	<input type="checkbox"/>
Depositing soil or materials or storing plant on the highway ( <b>Schedule 33 Para 12</b> )	<input type="checkbox"/>
Erection of scaffolding or screening (or hoarding) in the highway ( <b>Schedule 33 Para 12</b> )	<input type="checkbox"/>

<b>Table 1. High level summary</b> <i>(mark as appropriate)</i>	Alteration to apparatus of the highway authority	<input type="checkbox"/>	Deposit of material on the highway	<input type="checkbox"/>	Footway Works only	<input type="checkbox"/>	Peak hours	<input type="checkbox"/>	Works to PRow	<input type="checkbox"/>	Give and Take	<input type="checkbox"/>	Contra - flow	<input type="checkbox"/>	Lane Closure	<input checked="" type="checkbox"/>	Portable temporary traffic signals ( <i>delete as required</i> ) 2-way multiphase	<input type="checkbox"/>	Priority working	<input type="checkbox"/>
	Trial holes	<input type="checkbox"/>	Erection of scaffolding/hoarding	<input type="checkbox"/>	Works in the carriageway	<input type="checkbox"/>	Off Peak	<input checked="" type="checkbox"/>	Street works (NRSWA)	<input type="checkbox"/>	Stop / Go	<input type="checkbox"/>	Signage only	<input type="checkbox"/>	Road Closure	<input type="checkbox"/>	Works to existing or new traffic signals infrastructure	<input type="checkbox"/>	Associated utility works	<input type="checkbox"/>

**Table 2. Detailed works description, traffic management phasing and intended programme**

Road name	Extent of Temporary Interference	Consent or Consultation	USRN	Grid Ref	EToN reference	TM Phase	TM drawing reference	Description of works	Description of associated traffic management	TM operational hours	Proposed Works Start Date	Estimated Works End Date
A452 (N) Chester Rd	A452/ A446 Split to Northway Island	Consent	35006662	SP 20611 84156 to SP 20247 84641		Single Phase	CTM/BDWP493010(2)	Monitoring of a bore hole in the verge	Lane 1 closure on the A452 Chester Road from the A452/ A446 Split to Northway Island	8pm to 6am	25/11/2019	27/11/2019
A452 (S) Chester Road	Approach to Northway Island	Consent	35006662	SP 19738 85436		Single Phase	CTM/BDWP493010(1)	Monitoring of a bore hole in the verge	Lane 2 closure on approach to Northway Island	8pm to 6am	25/11/2019	27/11/2019
A452 Northway Island	Eastern half of Northway Island	Consent	35010156	SP 19871 85391		Single Phase	CTM/BDWP493010(1)	Monitoring of a bore hole in the verge	Inner partial ring closure of Northway Island	8pm to 6am	25/11/2019	27/11/2019

**Details of pre-application discussions with the Highway Authority and stakeholders**

Date	Details
08/11/2018	Tabled and discussed at the SMBC TLG
Click here to enter a date.	

**Details of associated consents/approvals**

--

**Document references and supporting information**

Title	Phase (from Table 2)	eB reference	Version
A452 Traffic Management Drawing	Single	CTM/BDWP493010(2)	
Northway Island Traffic Management Drawing	Single	CTM/BDWP493010(1)	

**Contractor Signature**

**This submission is made by the Contractor on behalf of and as agent for the Nominated Undertaker.**  
 HS2 Ltd authorises the contractor to submit the application for consultation or, as required, consent of the highway authority  
*[Contractor must obtain acceptance from HS2 before submitting the form to the highway authority]*

<b>Contractor</b>	LM-JV Cornerblock, Two Cornwall Street, Birmingham, B3 2DL
<b>Contractor Authorised Signatory</b>	 <i>Richard Coy</i>
<b>Contractor Site Contact Details</b>	Bridgeway Consulting Ltd Centurion Traffic Management Ltd

## Highway Authority Response Sheet

*To be completed by the Highway Authority and provided as a response to the application*

<b>HS2 Consent Reference:</b>	
<b>Street(s):</b>	
<b>Submission Date:</b>	
<b>Response Date:</b>	

### Local Highway Authority Response

**Highway Authority:** \_\_\_\_\_

**Decision on the application by the highway authority, if consent is required:**

<b>Consent granted</b> <input type="checkbox"/>	If consent withheld or consent with comments, state ground(s) below:
<b>Consent granted with comments</b> <input type="checkbox"/>	
<b>Consent withheld</b> <input type="checkbox"/>	
<b>Consultation</b> <input type="checkbox"/>	<i>[Insert comments on consultation]</i>

Signature: \_\_\_\_\_ Date: \_\_\_\_\_

Name of highway authority's authorised representative: \_\_\_\_\_

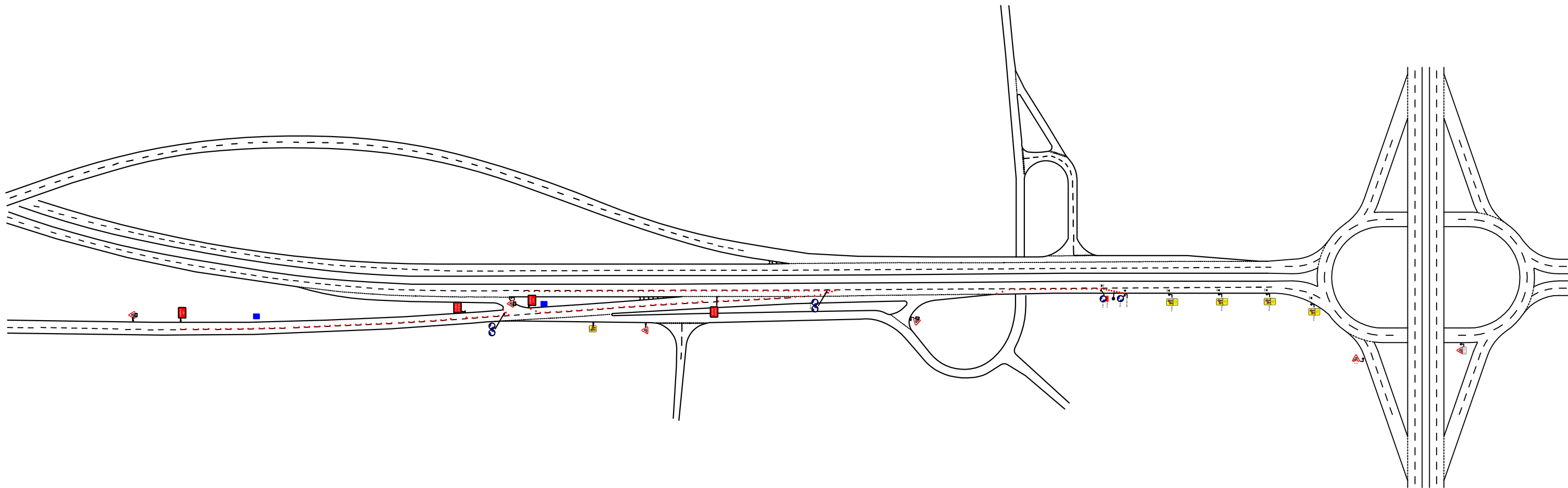

Centurion Traffic Management  
 3B, Haigh Park Road  
 Stourton  
 Leeds  
 LS10 1RT

Tel: 0113 277 5360  
 E-mail: info@Centuriontraffic.com  
 www.Centuriontraffic.com

Date: 30-10-18

Scheme: HS2 SURVEY WORKS

Traffic Management: LANE 2 CLOSURE

**Notes**

All layouts drawn in accordance with Chapter 8 guidelines.

Drawing to be read in conjunction with relevant method statement and risk assessment.

Please check for amendments before use.

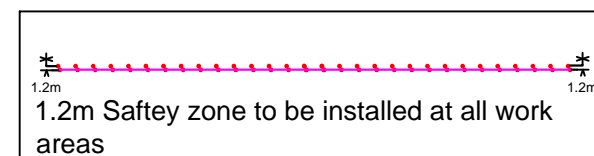
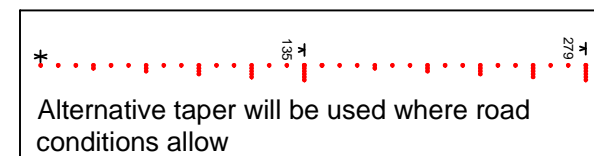

Crown Copyright. All rights reserved.

**Drawing No:**  
 CTM/BDWP493010(2)

Unauthorised reproduction infringes Crown Copyright and may lead to prosecution or civil proceedings.

Scale:  
 NTS

Drawn  
 DBC

Authorised /  
 Approved  
 GS

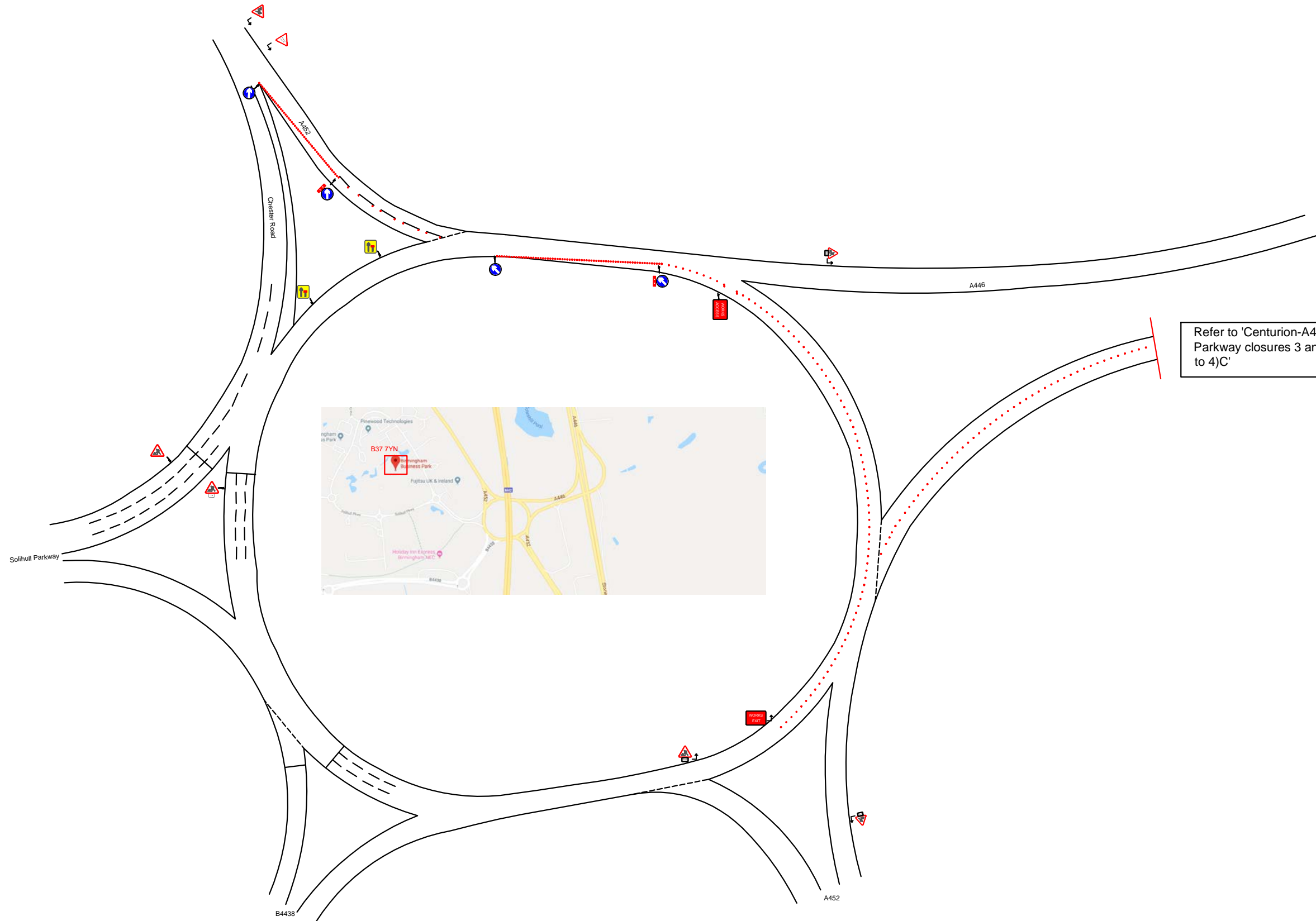

Refer to 'Centurion-A452-Solihull Parkway closures 3 and 4-005 (1 to 4)C'



Centurion Traffic Management  
 3B, Haigh Park Road  
 Stourton  
 Leeds  
 LS10 1RT  
 Tel: 0113 277 5360  
 E-mail: info@Centuriontraffic.com  
 www.Centuriontraffic.com

Date: 07/09/18

Scheme: HS2 SURVEY WORKS, BIRMINGHAM

Traffic Management: LANE 2 CLOSURE

**Notes**

All layouts drawn in accordance with Chapter 8 guidelines.

Drawing to be read in conjunction with relevant method statement and risk assessment.

Please check for amendments before use.

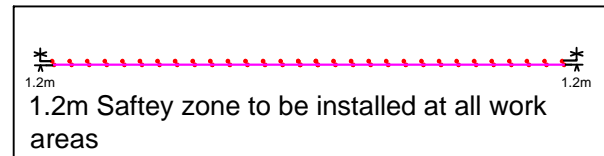
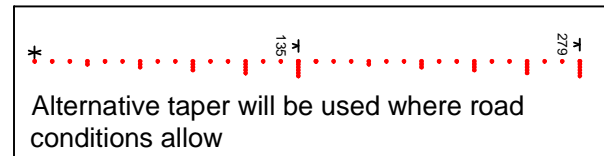

Crown Copyright. All rights reserved.

**Drawing No:**  
 CTM/WP493010(1)

Unauthorised reproduction infringes Crown Copyright and may lead to prosecution or civil proceedings.

Scale: NTS	Drawn BD	Authorised / Approved GS
---------------	-------------	--------------------------------

