

HS2 FORM TM1

Highway Authority	Solihull Metropolitan Borough Council
Street(s)/USRN(s)	A452 Chester Road, Northway Island
HS2 Consent Reference	THW.AN.SMBC.LMJV.0316
Contractor document reference	1EW04-LMJ-HW-SCH-NS07-N003-049007
Submission Date (to Highway Authority)	08/10/2019
Proposed start date of consent	16/12/2019
Proposed end date of consent	18/12/2019
Consultation end/ requested response date	01/11/2019
Deemed consent date (if required)	05/11/2019

Temporary Interference with the Highway

In accordance with the powers set out in the **High Speed Rail (London - West Midlands) Act 2017**, the Contractor, acting on behalf of and, as agent for the Nominated Undertaker, hereby consults the highway authority and/or requests highway authority consent under Schedule 2, 4 and/or 33 as identified below:

Consultation with the highway authority:	
The temporary interference / works is on a street or location that <u>is listed</u> in Table 3 of Schedule 4 to the Act (Schedule 4 Part 2 paragraph 6)	<input type="checkbox"/>
Consent of the highway authority:	
The temporary interference / works is on a street or location <u>not listed</u> in Table 3 of Schedule 4 of the Act (Schedule 4 Part 2 paragraph 6)	<input checked="" type="checkbox"/>
Trial holes (Schedule 2 only)	<input type="checkbox"/>
Protective provisions (Schedule 33) <i>[mark as appropriate]</i>	
Works to a bridge requiring temporary interference, (Schedule 33 para 6)	<input type="checkbox"/>
Alteration/disturbance to apparatus of the highway authority affixed to or placed under any highway or, access to the apparatus of the Highway Authority, (Schedule 33 Para 9)	<input type="checkbox"/>
Depositing soil or materials or storing plant on the highway (Schedule 33 Para 12)	<input type="checkbox"/>
Erection of scaffolding or screening (or hoarding) in the highway (Schedule 33 Para 12)	<input type="checkbox"/>

Table 1. High level summary <i>(mark as appropriate)</i>	Alteration to apparatus of the highway authority	<input type="checkbox"/>	Deposit of material on the highway	<input type="checkbox"/>	Footway Works only	<input type="checkbox"/>	Peak hours	<input type="checkbox"/>	Works to PRow	<input type="checkbox"/>	Give and Take	<input type="checkbox"/>	Contra - flow	<input type="checkbox"/>	Lane Closure	<input checked="" type="checkbox"/>	Portable temporary traffic signals (<i>delete as required</i>) 2-way multiphase	<input type="checkbox"/>	Priority working	<input type="checkbox"/>
	Trial holes	<input type="checkbox"/>	Erection of scaffolding/hoarding	<input type="checkbox"/>	Works in the carriageway	<input type="checkbox"/>	Off Peak	<input checked="" type="checkbox"/>	Street works (NRSWA)	<input type="checkbox"/>	Stop / Go	<input type="checkbox"/>	Signage only	<input type="checkbox"/>	Road Closure	<input type="checkbox"/>	Works to existing or new traffic signals infrastructure	<input type="checkbox"/>	Associated utility works	<input type="checkbox"/>

Table 2. Detailed works description, traffic management phasing and intended programme

Road name	Extent of Temporary Interference	Consent or Consultation	USRN	Grid Ref	EToN reference	TM Phase	TM drawing reference	Description of works	Description of associated traffic management	TM operational hours	Proposed Works Start Date	Estimated Works End Date
A452 (N) Chester Rd	A452/ A446 Split to Northway Island	Consent	35006662	SP 20611 84156 to SP 20247 84641		Single Phase	CTM/BDWP493010(2)	Monitoring of a bore hole in the verge	Lane 1 closure on the A452 Chester Road from the A452/ A446 Split to Northway Island	8pm to 6am	16/12/2019	18/12/2019
A452 (S) Chester Road	Approach to Northway Island	Consent	35006662	SP 19738 85436		Single Phase	CTM/BDWP493010(1)	Monitoring of a bore hole in the verge	Lane 2 closure on approach to Northway Island	8pm to 6am	16/12/2019	18/12/2019
A452 Northway Island	Eastern half of Northway Island	Consent	35010156	SP 19871 85391		Single Phase	CTM/BDWP493010(1)	Monitoring of a bore hole in the verge	Inner partial ring closure of Northway Island	8pm to 6am	16/12/2019	18/12/2019

Details of pre-application discussions with the Highway Authority and stakeholders

Date	Details
08/11/2018	Tabled and discussed at the SMBC TLG
Click here to enter a date.	

Details of associated consents/approvals

--

Document references and supporting information

Title	Phase (from Table 2)	eB reference	Version
A452 Traffic Management Drawing	Single	CTM/BDWP493010(2)	
Northway Island Traffic Management Drawing	Single	CTM/BDWP493010(1)	

Contractor Signature

This submission is made by the Contractor on behalf of and as agent for the Nominated Undertaker.
 HS2 Ltd authorises the contractor to submit the application for consultation or, as required, consent of the highway authority
[Contractor must obtain acceptance from HS2 before submitting the form to the highway authority]

Contractor	LM-JV Cornerblock, Two Cornwall Street, Birmingham, B3 2DL
Contractor Authorised Signatory	 Richard Coy
Contractor Site Contact Details	Bridgeway Consulting Ltd Centurion Traffic Management Ltd

Highway Authority Response Sheet

To be completed by the Highway Authority and provided as a response to the application

HS2 Consent Reference:	
Street(s):	
Submission Date:	
Response Date:	

Local Highway Authority Response

Highway Authority:	
---------------------------	--

Decision on the application by the highway authority, if consent is required:

Consent granted <input type="checkbox"/>	If consent withheld or consent with comments, state ground(s) below:
Consent granted with comments <input type="checkbox"/>	
Consent withheld <input type="checkbox"/>	
Consultation <input type="checkbox"/>	<i>[Insert comments on consultation]</i>

Signature: _____	Date: _____
Name of highway authority's authorised representative: _____	

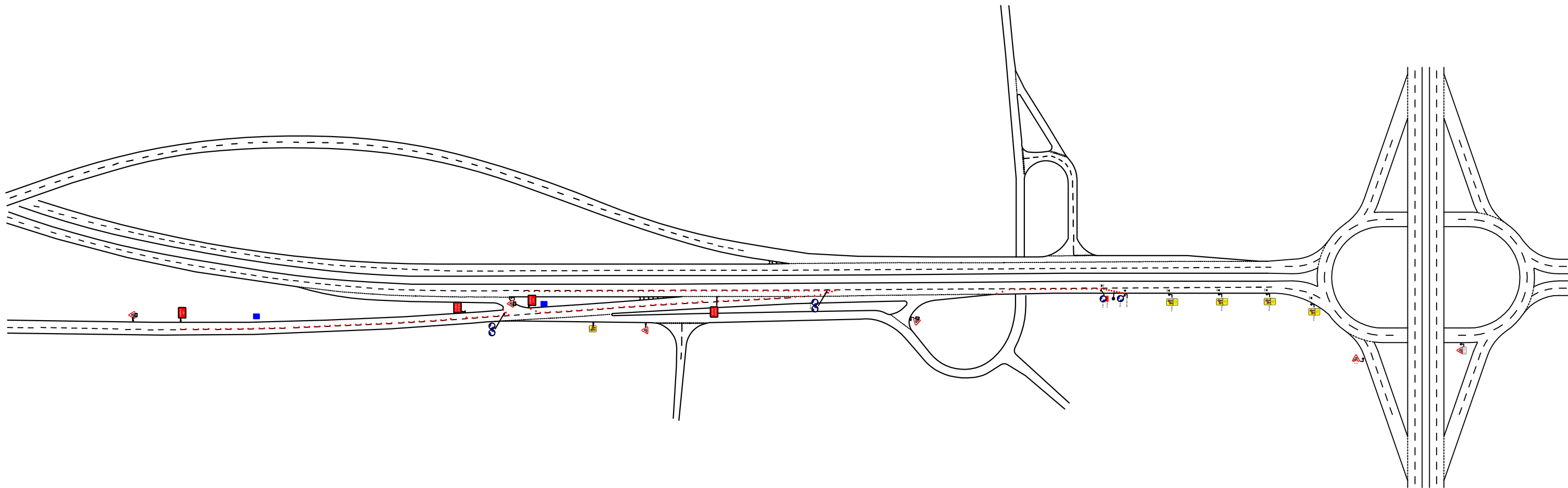

Centurion Traffic Management
 3B, Haigh Park Road
 Stourton
 Leeds
 LS10 1RT

Tel: 0113 277 5360
 E-mail: info@Centuriontraffic.com
 www.Centuriontraffic.com

Date: 30-10-18

Scheme: HS2 SURVEY WORKS

Traffic Management: LANE 2 CLOSURE

Notes

All layouts drawn in accordance with Chapter 8 guidelines.

Drawing to be read in conjunction with relevant method statement and risk assessment.

Please check for amendments before use.

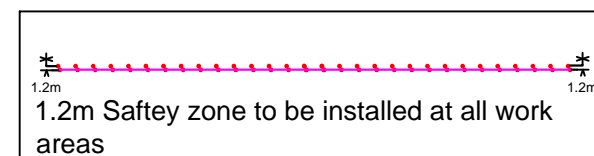
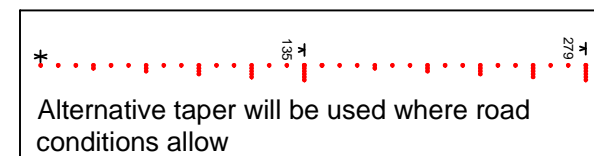

Crown Copyright. All rights reserved.

Drawing No:
 CTM/BDWP493010(2)

Unauthorised reproduction infringes Crown Copyright and may lead to prosecution or civil proceedings.

Scale:
 NTS

Drawn
 DBC

Authorised /
 Approved
 GS

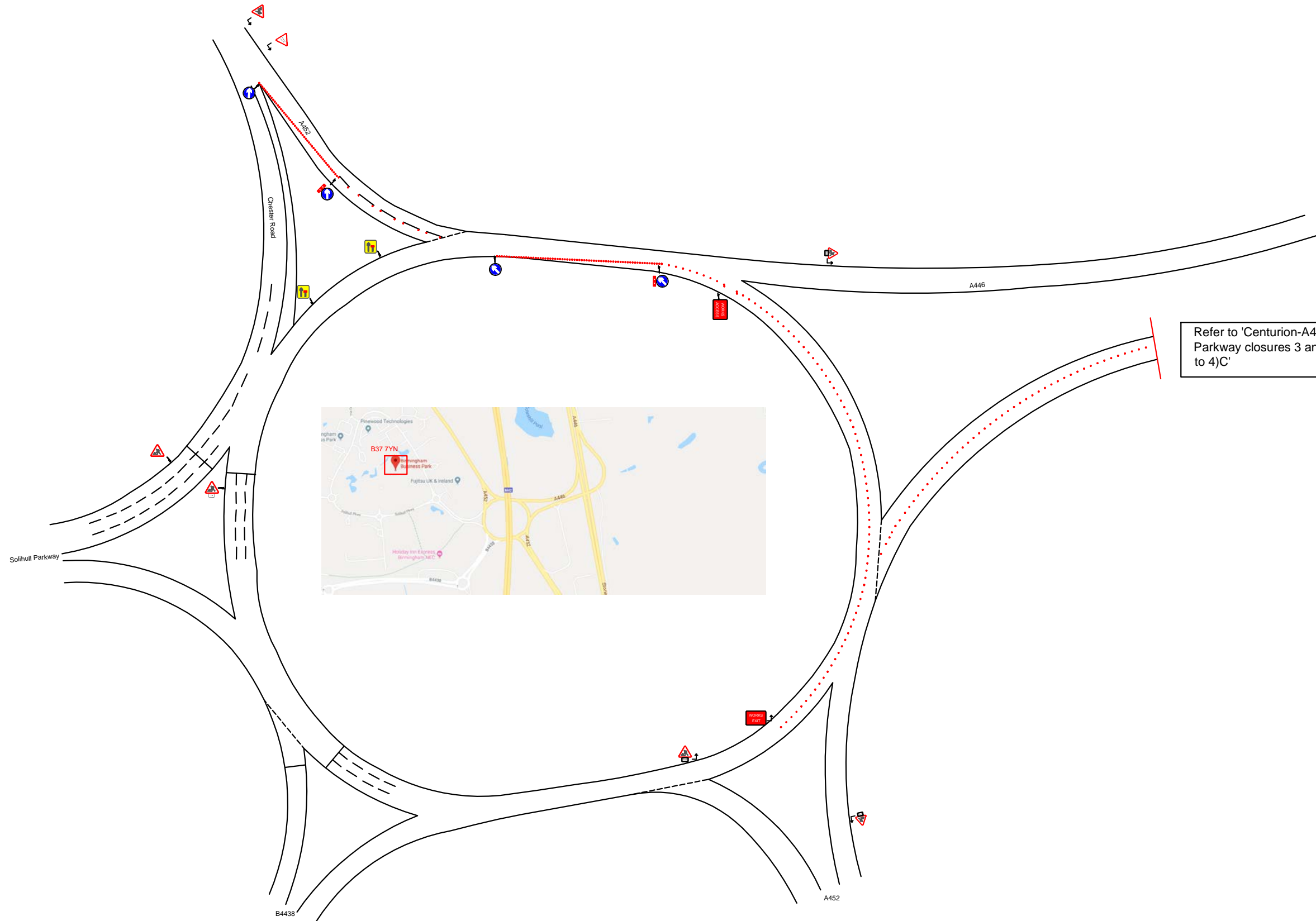

Refer to 'Centurion-A452-Solihull Parkway closures 3 and 4-005 (1 to 4)C'



Centurion Traffic Management
 3B, Haigh Park Road
 Stourton
 Leeds
 LS10 1RT
 Tel: 0113 277 5360
 E-mail: info@Centuriontraffic.com
 www.Centuriontraffic.com

Date: 07/09/18

Scheme: HS2 SURVEY WORKS, BIRMINGHAM

Traffic Management: LANE 2 CLOSURE

Notes

All layouts drawn in accordance with Chapter 8 guidelines.

Drawing to be read in conjunction with relevant method statement and risk assessment.

Please check for amendments before use.

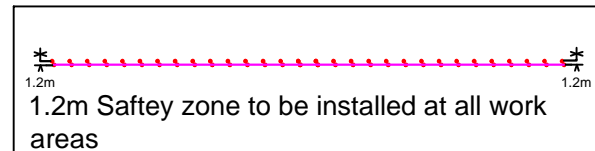
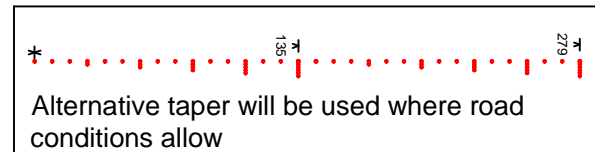

Crown Copyright. All rights reserved.

Drawing No:
 CTM/WP493010(1)

Unauthorised reproduction infringes Crown Copyright and may lead to prosecution or civil proceedings.

Scale:
 NTS

Drawn
 BD

Authorised /
 Approved
 GS

