

HS2 FORM TM1

Highway Authority	Solihull Metropolitan Borough Council
Street(s)/USRN(s)	A452 Southbound
HS2 Consent Reference	1EW04-LMJ-HW-SCH-N003-060010
Contractor document reference	THW.AN.SMBC.LMJV.331 Rev 1
Submission Date (to Highway Authority)	21/10/2019
Proposed start date of works	04/11/2019
Proposed end date of works	08/11/2019
Consultation end/ requested response date	31/10/2019
Deemed consent date (if required)	Click here to enter a date.

Temporary Interference with the Highway

In accordance with the powers set out in the **High Speed Rail (London - West Midlands) Act 2017**, the Contractor, acting on behalf of and, as agent for the Nominated Undertaker, hereby consults the highway authority and/or requests highway authority consent under Schedule 2, 4 and/or 33 as identified below:

Consultation with the highway authority:	
The temporary interference / works is on a street or location that <u>is listed</u> in Table 3 of Schedule 4 to the Act (Schedule 4 Part 2 paragraph 6)	<input checked="" type="checkbox"/>
Consent of the highway authority:	
The temporary interference / works is on a street or location <u>not listed</u> in Table 3 of Schedule 4 of the Act (Schedule 4 Part 2 paragraph 6)	<input type="checkbox"/>
Trial holes (Schedule 2 only)	<input type="checkbox"/>
Protective provisions (Schedule 33) [mark as appropriate]	
Works to a bridge requiring temporary interference, (Schedule 33 para 6)	<input type="checkbox"/>
Alteration/disturbance to apparatus of the highway authority affixed to or placed under any highway or, access to the apparatus of the Highway Authority, (Schedule 33 Para 9)	<input type="checkbox"/>
Depositing soil or materials or storing plant on the highway (Schedule 33 Para 12)	<input type="checkbox"/>
Erection of scaffolding or screening (or hoarding) in the highway (Schedule 33 Para 12)	<input type="checkbox"/>

Table 1. High level summary (mark as appropriate)		Alteration to apparatus of the highway authority	Deposit of material on the highway	Footway Works only	Peak hours	Works to PRoW	Give and Take	Contra-flow	Lane Closure	Portable temporary traffic signals (delete as required) 2-way	Priority working	Narrowing of Lane
	Trial holes	<input type="checkbox"/>	Erection of scaffolding/hoarding	<input type="checkbox"/>	<input type="checkbox"/>	<input type="checkbox"/>	Stop/Go	<input type="checkbox"/>	Road Closure	Works to existing or new traffic signals infrastructure	Associated utility works	<input checked="" type="checkbox"/>

Table 2. Detailed works description, traffic management phasing and intended programme													
Row No.	Road name	Extent of Temporary Interference	Consent or Consultation	USRN	Grid Ref	EToN reference	TM Phase	TM drawing reference	Description of works	Description of associated traffic management	TM operational hours	Proposed Works Start Date	Estimated Works End Date
1	A452 Southbound	From Birmingham Business Park Roundabout to the merge with the A446(S)	Consult	35006662	SP 19352 85960 to SP 19352 85960		Single Phase	TFX SC0024 E002	Continued work to the bases installed for the Barrierguard 800 fitted to the verge previously	Off peak lane 2 closure	9.30am to 3.30pm	04/11/2019	08/11/2019
2							Choose an item.					Click here to enter a date.	Click here to enter a date.
3							Choose an item.					Click here to enter a date.	Click here to enter a date.
4							Choose an item.					Click here to enter a date.	Click here to enter a date.
5							Choose an item.					Click here to enter a date.	Click here to enter a date.
Notes.													
This closure was previously installed for the purpose of installing the bases required for the barrier. Additional work is required on a couple of bases as the height is not sufficient for the barrier.													

Details of pre-application discussions with the Highway Authority and stakeholders

Date	Details
Click here to enter a date.	There have not been any pre-application discussions for this closure.
31/10/2019	Met with SMBC to discuss the additional dates
Click here to enter a date.	

Details of associated consents/approvals

Schedule 4 Part 2 #252 relates to the Barrierguard 800

Document references and supporting information

Title	Phase (from Table 2)	Reference	Version
A452 Southbound Lane 2 Closure		TFX SC0024 E002	Rev A

Contractor Signature

This submission is made by the Contractor on behalf of and as agent for the Nominated Undertaker.
 HS2 Ltd authorises the contractor to submit the application for consultation or, as required, consent of the highway authority
[Contractor must obtain acceptance from HS2 before submitting the form to the highway authority]

Contractor	LM-JV Cornerblock, Two Cornwall Street, Birmingham, B3 2DX
Contractor Authorised Signatory	 Wayne Skells, Traffic Manager
Contractor Site Contact Details	TSCO: 07943 813777

Highway Authority Response Sheet

To be completed by the Highway Authority and provided as a response to the application

HS2 Consent Reference:	
Street(s):	
Submission Date:	
Response Date:	

Local Highway Authority Response

Highway Authority:

Decision on the application by the highway authority, if consent is required:

Consent granted <input type="checkbox"/>	<i>If consent withheld or consent with comments, state ground(s) below:</i>
Consent granted with comments <input type="checkbox"/>	
Consent withheld <input type="checkbox"/>	
Consultation <input checked="" type="checkbox"/>	<i>[Insert comments on consultation]</i>

Signature:  Date: 1/11/19

Name of highway authority's authorised representative: Lisa Pardy

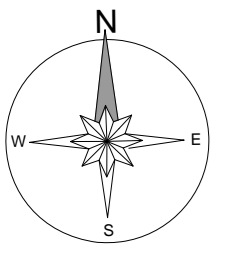

Key	
	Line of Works
	Works Area
	Heat Closure
	Division Phase
	Cone
	Pedestrian Barrier
	Temporary Sign
	Temporary Traffic Signal Stop & Go Board
	Temporary Traffic Signal Permanent Traffic Signal
	Temporary Ped Signal
	Ending Red Stop
	1.5M Van

Notes:	
Min width of sideways safety zone (S)	1.2m
Min length of longways clearance (L)	100m
A452 Chester Road	

WORKS ACCESS
Signs to be positioned as required to suit the conditions.

WORKS ACCESS

WORKS ACCESS

WORKFORCE IN ROAD
Signs to be positioned as required to suit the conditions.

WORKFORCE IN ROAD

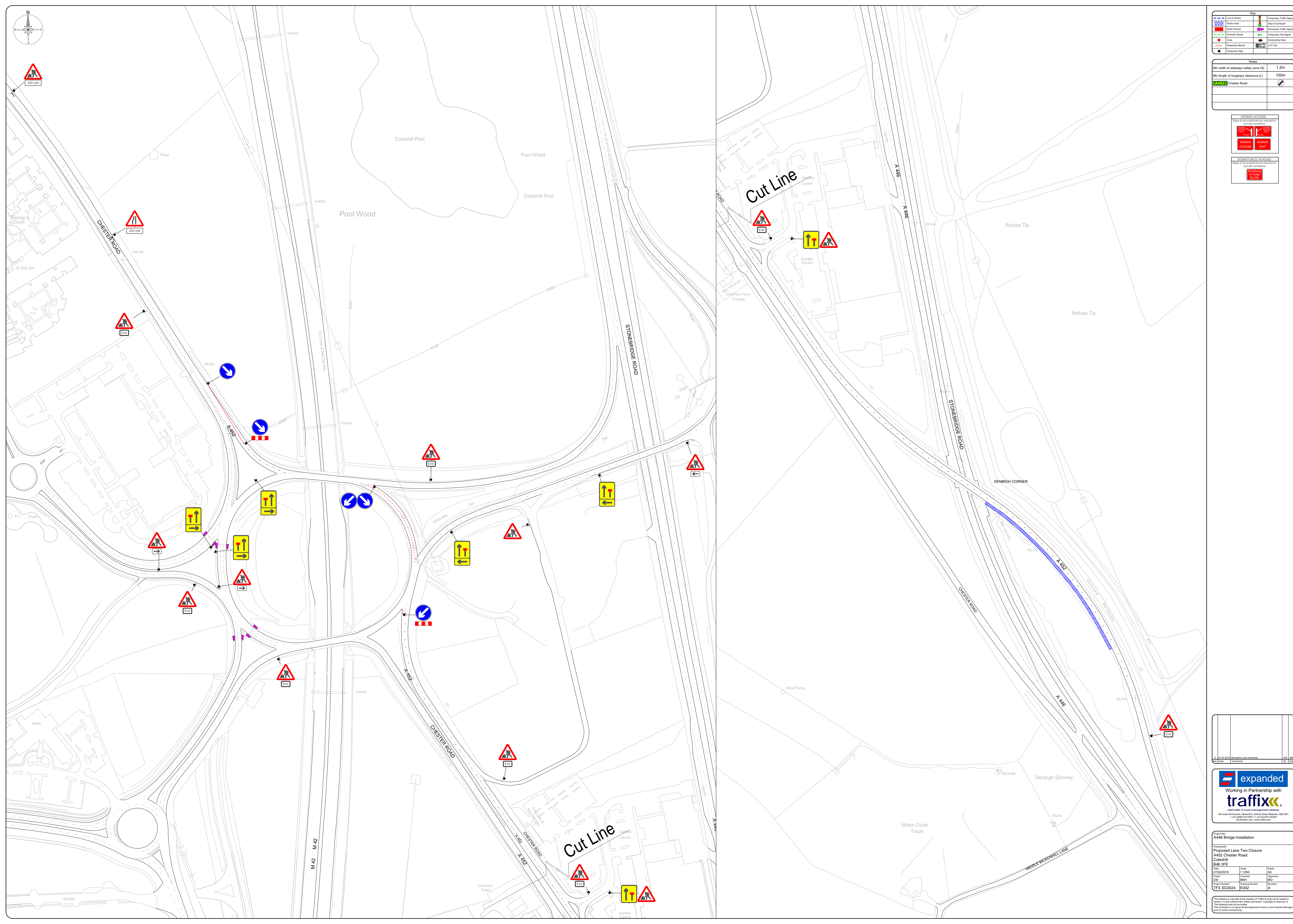

10/02/2019	Revised to suit comments	CU	24
08/02/2019	Comments	CU	23

expanded
Working in Partnership with
traffix
Total traffic & event management solutions
Old Alden Business Centre | Olden | South West Midlands B80 0DY
t +44 (0)1827 819 800 | f +44 (0)1827 82007
info@traffix.com | www.traffix.com

Project Name: A446 Bridge Installation			
Drawing Title: Proposed Lane Two Closure			
Location: A452 Chester Road			
Location: Coleshill			
Scale: B46 3FE			
Date: 27/02/2019	Scale: 1:1250	Project: AD	
Drawn: CM	Checked: BRH	Approved: MD	
Project Number: UFX SC0024	Drawing Number: EX02	Revision: A	

This drawing is copyright & the property of Traffic & must not be copied or altered in any way without the written permission. Copyright is reserved. ©
The drawing must not be scaled.
The Contractor is responsible for all discrepancies & errors to the Contract Manager and to the client.