

## HS2 FORM TM1

|  |   |
|--|---|
| <b>Highway Authority</b>                         | Solihull Metropolitan Borough Council       |
| <b>Street(s)/USRN(s)</b>                         | Solihull Parkway                            |
| <b>HS2 Consent Reference</b>                     | THW.AN.SMBC.LMJV.348                        |
| <b>Contractor document reference</b>             | TBC   |
| <b>Submission Date (to Highway Authority)</b>    | 22/11/2019                                  |
| <b>Proposed start date of works</b>              | 07/12/2019                                  |
| <b>Proposed end date of works</b>                | 15/12/2019                                  |
| <b>Consultation end/ requested response date</b> | 06/12/2019                                  |
| <b>Deemed consent date (if required)</b>         | <a href="#">Click here to enter a date.</a> |

## Temporary Interference with the Highway

In accordance with the powers set out in the **High Speed Rail (London - West Midlands) Act 2017**, the Contractor, acting on behalf of and, as agent for the Nominated Undertaker, hereby consults the highway authority and/or requests highway authority consent under Schedule 2, 4 and/or 33 as identified below:

|   |                                     |
|---|-------------------------------------|
| <b>Consultation with the highway authority:</b>   |                                     |
| The temporary interference / works is on a street or location that <b>is listed</b> in Table 3 of Schedule 4 to the Act ( <b>Schedule 4 Part 2 paragraph 6</b> )                        | <input checked="" type="checkbox"/> |
| <b>Consent of the highway authority:</b>  |                                     |
| The temporary interference / works is on a street or location <b>not listed</b> in Table 3 of Schedule 4 of the Act ( <b>Schedule 4 Part 2 paragraph 6</b> )                            | <input type="checkbox"/>            |
| <b>Trial holes (Schedule 2 only)</b>  | <input type="checkbox"/>            |
| <b>Protective provisions (Schedule 33) [mark as appropriate]</b>  |                                     |
| Works to a bridge requiring temporary interference, ( <b>Schedule 33 para 6</b> )   | <input type="checkbox"/>            |
| Alteration/disturbance to apparatus of the highway authority affixed to or placed under any highway or, access to the apparatus of the Highway Authority, ( <b>Schedule 33 Para 9</b> ) | <input type="checkbox"/>            |
| Depositing soil or materials or storing plant on the highway ( <b>Schedule 33 Para 12</b> )   | <input type="checkbox"/>            |
| Erection of scaffolding or screening (or hoarding) in the highway ( <b>Schedule 33 Para 12</b> )  | <input type="checkbox"/>            |

Error! Reference source not found.

Schedule 4 Part 2 paragraph 6 – Temporary Interference

Schedule 33 Part 1, Schedule 2 Part 1

Form TM 1 - PH1-HS2-CL-TEM-000-000001 [Revision Po4]

|  |  |                                     |                                    |                          |                          |                          |            |                                     |                      |                          |               |                          |               |                                     |              |                                     |  |                          |                          |                          |                   |                          |
|--|--|-------------------------------------|------------------------------------|--------------------------|--------------------------|--------------------------|------------|-------------------------------------|----------------------|--------------------------|---------------|--------------------------|---------------|-------------------------------------|--------------|-------------------------------------|--|--------------------------|--------------------------|--------------------------|-------------------|--------------------------|
| <b>Table 1.<br/>High level<br/>summary<br/>(mark as appropriate)</b> | Alteration to apparatus of the highway authority | <input type="checkbox"/>            | Deposit of material on the highway | <input type="checkbox"/> | Footway Works only       | <input type="checkbox"/> | Peak hours | <input checked="" type="checkbox"/> | Works to PRoW        | <input type="checkbox"/> | Give and Take | <input type="checkbox"/> | Contra - flow | <input type="checkbox"/>            | Lane Closure | <input type="checkbox"/>            | Portable temporary traffic signals ( <i>delete as required</i> ) | <input type="checkbox"/> | Priority working         | <input type="checkbox"/> | Narrowing of Lane | <input type="checkbox"/> |
|  | Trial holes                                      | <input checked="" type="checkbox"/> | Erection of scaffolding/ hoarding  | <input type="checkbox"/> | Works in the carriageway | <input type="checkbox"/> | Off Peak   | <input checked="" type="checkbox"/> | Street works (NRSWA) | <input type="checkbox"/> | Stop / Go     | <input type="checkbox"/> | Signage only  | <input checked="" type="checkbox"/> | Road Closure | <input checked="" type="checkbox"/> | Works to existing or new traffic signals infrastructure          | <input type="checkbox"/> | Associated utility works | <input type="checkbox"/> | Other             | <input type="checkbox"/> |

**Table 2. Detailed works description, traffic management phasing and intended programme**

| Row No. | Road name        | Extent of Temporary Interference | Consent or Consultation | USRN     | Grid Ref                       | ETo N reference | TM Phase | TM drawing reference | Description of works                                     | Description of associated traffic management | TM operational hours                                 | Proposed Works Start Date | Estimated Works End Date |
|---------|------------------|----------------------------------|-------------------------|----------|--------------------------------|-----------------|----------|----------------------|--|--|--|---------------------------|--------------------------|
| 1.      | Solihull Parkway | Northway Island to BBP land      | Consult                 | 35002856 | 419681:285284 to 419564:285321 | N/A             | 1        | 031                  | Trial holes – locate existing utilities and record depth | Road closure                                 | 8am 7 <sup>th</sup> Dec to 8pm 8 <sup>th</sup> Dec   | 07/12/2019                | 08/12/2019               |
| 2.      | Northway Island  | Northway Island full roundabout  | Consult                 | 35010156 | 419681:285284 to 419746:285231 | N/A             | 1        | 031                  | Diversion Route  | Associated diversion                         | 8am 7 <sup>th</sup> Dec to 8pm 8 <sup>th</sup> Dec   | 07/12/2019                | 08/12/2019               |
| 3.      | B4438            | Northway Island to Progress Way  | Consult                 | 35006577 | 419746:285231 to 418928:285017 | N/A             | 1        | 031                  | Diversion Route  | Associated diversion                         | 8am 7 <sup>th</sup> Dec to 8pm 8 <sup>th</sup> Dec   | 07/12/2019                | 08/12/2019               |
| 4.      | Solihull Parkway | Northway Island to BBP land      | Consult                 | 35002856 | 419681:285284 to 419564:285321 | N/A             | 1        | 031                  | Trial holes – locate existing utilities and record depth | Road closure                                 | 8am 14 <sup>th</sup> Dec to 8pm 15 <sup>th</sup> Dec | 14/12/2019                | 15/12/2019               |
| 5.      | Northway Island  | Northway Island full roundabout  | Consult                 | 35010156 | 419681:285284 to 419746:285231 | N/A             | 1        | 031                  | Diversion Route  | Associated diversion                         | 8am 14 <sup>th</sup> Dec to 8pm 15 <sup>th</sup> Dec | 14/12/2019                | 15/12/2019               |
| 6.      | B4438            | Northway Island to Progress Way  | Consult                 | 35006577 | 419746:285231 to 418928:285017 | N/A             | 1        | 031                  | Diversion Route  | Associated diversion                         | 8am 14 <sup>th</sup> Dec to 8pm 15 <sup>th</sup> Dec | 14/12/2019                | 15/12/2019               |

### Details of pre-application discussions with the Highway Authority and stakeholders

| Date       | Details            |
|------------|--------------------|
| 14/11/2019 | Tabled at SMBC TLG |
|            |                    |

### Details of associated consents/approvals

|  |
|--|
|  |
|--|

### Document references and supporting information

| Title   | Phase<br>(from<br>Table 2) | Reference | Version |
|---|----------------------------|-----------|---------|
| TFX SC0029 31 - Trial Holes - BIS Island Solihull Road Closure A0 | 1                          | N/A       | 1       |
|   |                            |           |         |
|   |                            |           |         |

### Contractor Signature

**This submission is made by the Contractor on behalf of and as agent for the Nominated Undertaker.**  
 HS2 Ltd authorises the contractor to submit the application for consultation or, as required, consent of the highway authority  
*[Contractor must obtain acceptance from HS2 before submitting the form to the highway authority]*

|  |   |
|--|---|
| <b>Contractor</b>                          | LM-JV<br>Cornerblock,<br>Two Cornwall Street,<br>Birmingham,<br>B3 2DX              |
| <b>Contractor<br/>Authorised Signatory</b> |  |
| <b>Contractor Site Contact<br/>Details</b> | BIS TSCO – 07943 813777   |

## Highway Authority Response Sheet

To be completed by the Highway Authority and provided as a response to the application

|                               |  |
|-------------------------------|--|
| <b>HS2 Consent Reference:</b> |  |
| <b>Street(s):</b>             |  |
| <b>Submission Date:</b>       |  |
| <b>Response Date:</b>         |  |

### Local Highway Authority Response

|                           |  |
|---------------------------|--|
| <b>Highway Authority:</b> |  |
|---------------------------|--|

#### Decision on the application by the highway authority, if consent is required:

|   |   |
|---|---|
| <b>Consent granted</b> <input type="checkbox"/>               | <i>If consent withheld or consent with comments, state ground(s) below:</i>   |
| <b>Consent granted with comments</b> <input type="checkbox"/> |   |
| <b>Consent withheld</b> <input type="checkbox"/>              |   |
| <b>Consultation</b> <input checked="" type="checkbox"/>       | <p><i>[Insert comments on consultation]</i><br/>                 Please send a copy of BBPs consultation for our records.<br/>                 Please notify SMBC of any changes in dates or TM in live time.</p> |

Signature:  Date: 22.11.19

Name of highway authority's authorised representative: Lisa Pardy



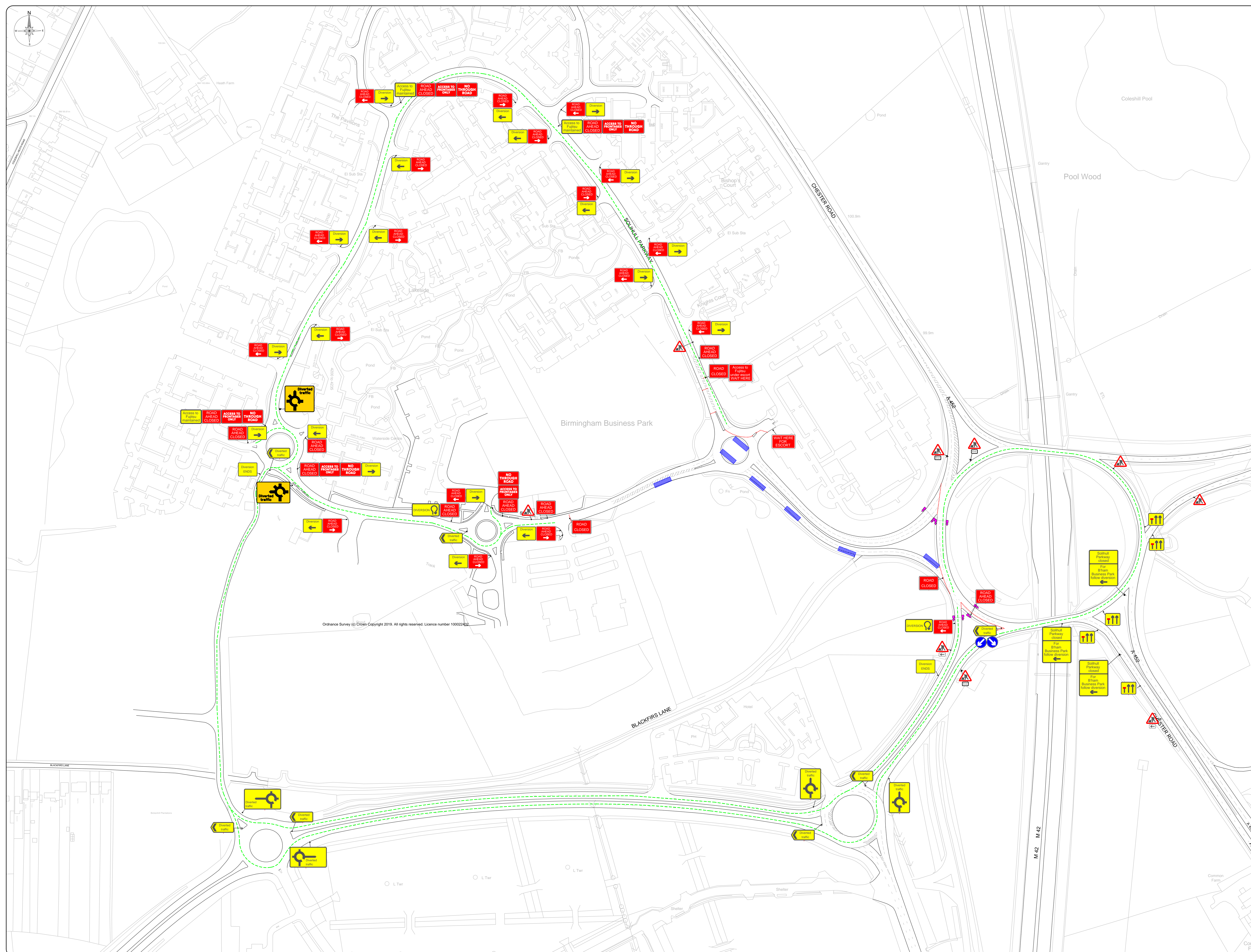

Ordnance Survey (c) Crown Copyright 2019. All rights reserved. Licence number 100022432

| Key |                          |
|-----|--------------------------|
|     | Works Area               |
|     | Road Closure             |
|     | Diversion Route          |
|     | Zone                     |
|     | Temporary Sign           |
|     | Permanent Traffic Signal |
|     | Temporary Traffic Signal |
|     | Ending the Zone          |
|     | Temporary Sign           |
|     | Prohibition Sign         |

Site Information

|                                       |           |
|---------------------------------------|-----------|
| Surveyed                              | Y         |
| Road Width                            | 7.1-11.9m |
| Min width of sideways safety zone (S) | 1.2m      |
| Min length of longways clearance (L)  | 100m      |
| Solihull Parkway                      |           |
| A452                                  |           |
| A446                                  |           |

Notes

Notes

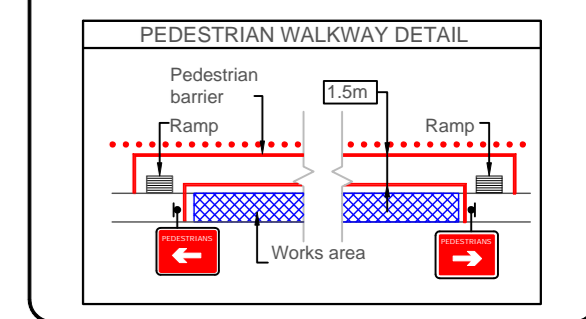

| Date | Comments | By |
|------|----------|----|
|      |          |    |

**MURPHY**  
LAND & MARINE  
Working in Partnership with  
**traffix**  
Great traffic & event management solutions  
Old Aylesford Business Park, Old Aylesford (Solihull) Street Midlands | B92 0DY  
+44 (0)121 879 8711 | Fax: (0)121 879 8707  
info@traffix.com | www.traffix.com

Project: WPE2 - Trail Holes

| Proposed Road Closure Solihull Parkway Solihull B37 7YU |                |         |        |
|---|----------------|---------|--------|
| Date  | Scale          | Project | Author |
| 31/10/2019  | 1:1000         | AD      | AD     |
| MO  | Checked        | BNH     | DM     |
| TPX 302029  | Drawing Number | 1       | Reason |

This drawing is copyright & the property of Traffic & must not be copied or altered in any way without the written permission. Copyright is reserved. © The drawing must not be used. The contractor is to report all discrepancies & errors to the Contract Manager and to make corrections.