

## HS2 FORM TM1

<b>Highway Authority</b>	Solihull Metropolitan Borough Council
<b>Street(s)/USRN(s)</b>	Northway Island
<b>HS2 Consent Reference</b>	THW.AN.SMBC.LMJV.377 <b>Rev3</b>
<b>Contractor document reference</b>	
<b>Submission Date (to Highway Authority)</b>	23/12/2019
<b>Proposed start date of works</b>	03/02/2020
<b>Proposed end date of works</b>	13/03/2020
<b>Consultation end/ requested response date</b>	13/01/2020
<b>Deemed consent date (if required)</b>	N/A

## Temporary Interference with the Highway

In accordance with the powers set out in the **High Speed Rail (London - West Midlands) Act 2017**, the Contractor, acting on behalf of and, as agent for the Nominated Undertaker, hereby consults the highway authority and/or requests highway authority consent under Schedule 2, 4 and/or 33 as identified below:

<b>Consultation with the highway authority:</b>	
The temporary interference / works is on a street or location that <b><u>is listed</u></b> in Table 3 of Schedule 4 to the Act ( <b>Schedule 4 Part 2 paragraph 6</b> )	<input checked="" type="checkbox"/>
<b>Consent of the highway authority:</b>	
The temporary interference / works is on a street or location <b><u>not listed</u></b> in Table 3 of Schedule 4 of the Act ( <b>Schedule 4 Part 2 paragraph 6</b> )	<input type="checkbox"/>
<b>Trial holes (Schedule 2 only)</b>	<input type="checkbox"/>
<b>Protective provisions (Schedule 33) [mark as appropriate]</b>	
Works to a bridge requiring temporary interference, ( <b>Schedule 33 para 6</b> )	<input type="checkbox"/>
Alteration/disturbance to apparatus of the highway authority affixed to or placed under any highway or, access to the apparatus of the Highway Authority, ( <b>Schedule 33 Para 9</b> )	<input type="checkbox"/>
Depositing soil or materials or storing plant on the highway ( <b>Schedule 33 Para 12</b> )	<input type="checkbox"/>
Erection of scaffolding or screening (or hoarding) in the highway ( <b>Schedule 33 Para 12</b> )	<input type="checkbox"/>

Error! Reference source not found.

Schedule 4 Part 2 paragraph 6 – Temporary Interference

Schedule 33 Part 1, Schedule 2 Part 1

Form TM 1 - PH1-HS2-CL-TEM-000-000001 [Revision Po4]



<b>Table 1. High level summary</b> <i>(mark as appropriate)</i>	Alteration to apparatus of the highway authority	<input type="checkbox"/>	Deposit of material on the highway	<input type="checkbox"/>	Footway Works only	<input type="checkbox"/>	Peak hours	<input type="checkbox"/>	Works to PRow	<input type="checkbox"/>	Give and Take	<input type="checkbox"/>	Contra - flow	<input type="checkbox"/>	Lane Closure	<input checked="" type="checkbox"/>	Portable temporary traffic signals <i>(delete as required)</i>	<input type="checkbox"/>	Priority working	<input type="checkbox"/>	Narrowing of Lane	<input type="checkbox"/>
	Trial holes	<input type="checkbox"/>	Erection of scaffolding/hoarding	<input type="checkbox"/>	Works in the carriageway	<input type="checkbox"/>	Off Peak	<input checked="" type="checkbox"/>	Street works (NRSWA)	<input type="checkbox"/>	Stop / Go	<input type="checkbox"/>	Signage only	<input checked="" type="checkbox"/>	Road Closure	<input type="checkbox"/>	Works to existing or new traffic signals infrastructure	<input type="checkbox"/>	Associated utility works	<input type="checkbox"/>	Other.	<input type="checkbox"/>

**Table 2. Detailed works description, traffic management phasing and intended programme**

Row No.	Road name	Extent of Temporary Interference	Consent or Consultation	USRN	Grid Ref	EToN reference	TM Phase	TM drawing reference	Description of works	Description of associated traffic management	TM operational hours	Proposed Works Start Date	Estimated Works End Date
1.	Northway Island	Northway Island	Consult	35010156	SP197852	N/A	Phase 1	4001	Vegetation clearance	Ring management and associated signage	0930-1530	03/02/2020	13/03/2020
2.	Northway Island	Northway Island	Consult	35010156	SP197852	N/A	Phase 2	4004	Vegetation clearance	Ring management and associated signage	0930-1530	03/02/2020	13/03/2020
3.	Northway Island/A452	Northway Island to Middle Bickenhill Lane	Consult	35010156	SP197852	N/A	Phase 3	HMW(TM)-C2440-2502	Vegetation clearance	Ring management and associated signage	0930-1530	03/02/2020	13/03/2020
4.	<b>B4438 Bickenhill Parkway</b>	<b>Northway Island to Bickenhill Parkway Island</b>	<b>Consult</b>	<b>35006577</b>	<b>SP195850</b>	<b>N/A</b>	<b>Phase 4</b>	<b>001</b>	<b>Vegetation clearance</b>	<b>Ring management and associated signage</b>	<b>0930-1530</b>	<b>03/02/2020</b>	<b>13/03/2020</b>

**Note: These phases will not run at the same time, changes to TM will be made based on on site progress**

Error! Reference source not found.

Schedule 4 Part 2 paragraph 6 – Temporary Interference

Schedule 33 Part 1, Schedule 2 Part 1

Form TM 1 - PH1-HS2-CL-TEM-000-000001 [Revision Po4]

# HS2

## Details of pre-application discussions with the Highway Authority and stakeholders

Date	Details
14/11/2019	WP70 discussed at TLG
06/01/2020	Sch4 review meeting to take place with SMBC

## Details of associated consents/approvals

THW.AN.HE.LMJV.376 – HE lane closures

## Document references and supporting information

Title	Phase (from Table 2)	Reference	Version
Proposed Lane closure Biddles Loop	1	TFX SC0043 4001	-
Proposed Lane closure Biddles Loop	2	TFX SC0043 4004	-
Propose indicative detail for managing pedestrians	For info	TFX SC0043 D002	
Cluster E	3	HMW(TM)-C2440-2502	
Proposed ring management Northway/BBP	4	TFX 20541 001	-

## Contractor Signature

**This submission is made by the Contractor on behalf of and as agent for the Nominated Undertaker.**

HS2 Ltd authorises the contractor to submit the application for consultation or, as required, consent of the highway authority

***[Contractor must obtain acceptance from HS2 before submitting the form to the highway authority]***

<b>Contractor</b>	LM-JV Cornerblock, Two Cornwall Street, Birmingham, B3 2DX
<b>Contractor Authorised Signatory</b>	
<b>Contractor Site Contact Details</b>	HS2 helpdesk – 08081 434 434

## Highway Authority Response Sheet

*To be completed by the Highway Authority and provided as a response to the application*

<b>HS2 Consent Reference:</b>	
<b>Street(s):</b>	
<b>Submission Date:</b>	
<b>Response Date:</b>	

### Local Highway Authority Response

<b>Highway Authority:</b>	
---------------------------	--

**Decision on the application by the highway authority, if consent is required:**

<b>Consent granted</b> <input type="checkbox"/>	<i>If consent withheld or consent with comments, state ground(s) below:</i>
<b>Consent granted with comments</b> <input type="checkbox"/>	
<b>Consent withheld</b> <input type="checkbox"/>	
<b>Consultation</b> <input type="checkbox"/>	<i>[Insert comments on consultation]</i>

Signature: \_\_\_\_\_ Date: \_\_\_\_\_

Name of highway authority's authorised representative: \_\_\_\_\_

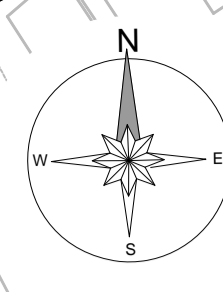

PEDESTRIAN MANAGEMENT TO BE INSTALLED AND MANAGED TO SUIT SITE CONDITIONS IN ACCORDANCE WITH CURRENT LEGISLATION & CODES OF PRACTICE BY THE CONTRACTOR UNLESS OTHERWISE STATED

Key:	
	Line of Works
	Works Area
	Road Closure
	Diversion Route
	Cone
	Pedestrian Barrier
	Temporary Sign
	Temporary Traffic Signal
	Stop & Go Board
	Permanent Traffic Signal
	Temporary Ped Signal
	Existing Bus Stop
	3.5T Van

Notes:		
Min width of sideways safety zone (S)	1.2m	0.5m
Min length of longways clearance (L)	100m	15m
A446/A452 Island		
Solihull Parkway		
B4438		
Northway		

**WORKFORCE IN ROAD**  
Signs to be positioned as required to suit site conditions

**WORKS ACCESS**  
Signs to be positioned as required to suit site conditions

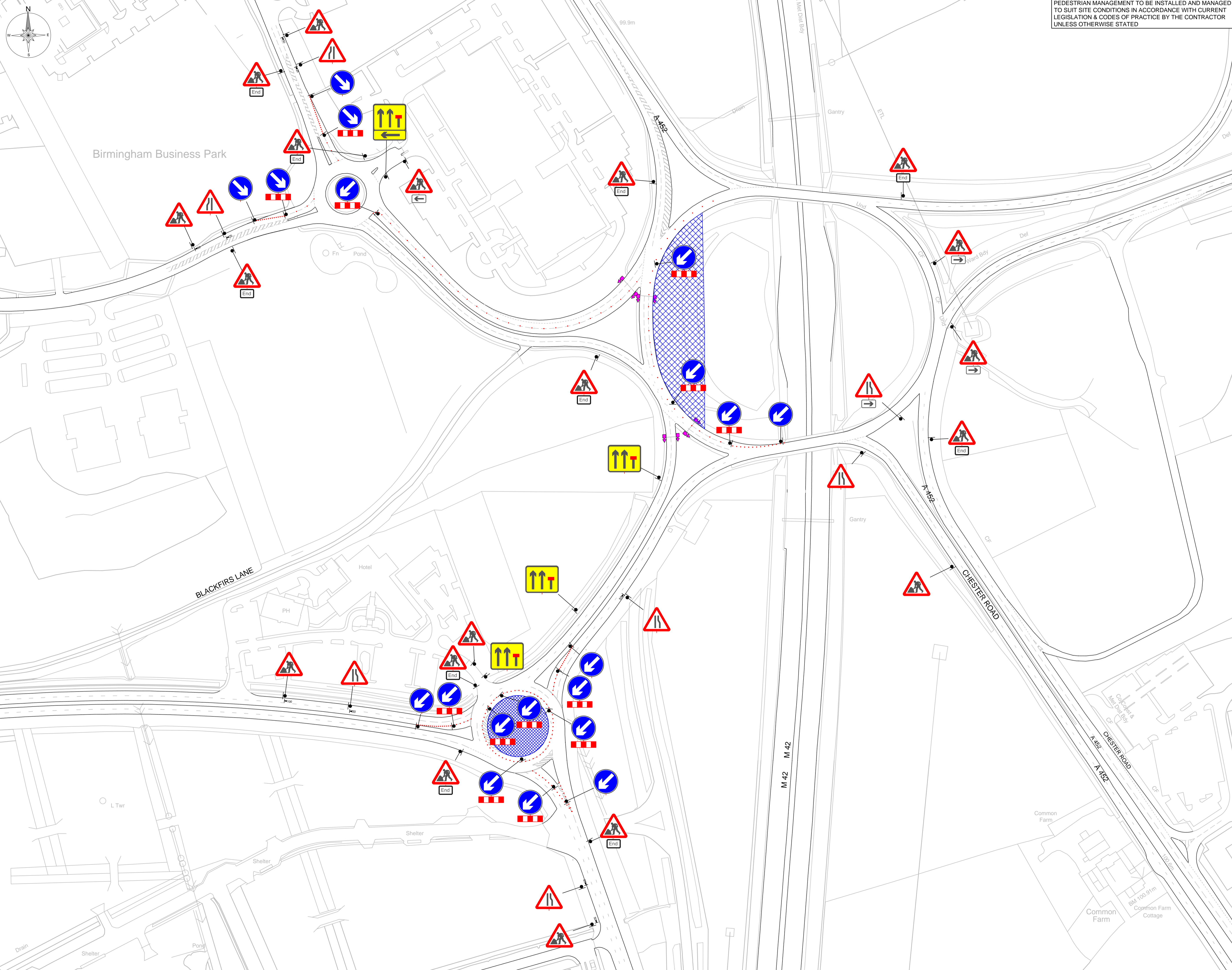

Rev	Date	Comments	By	Chk

Working in Partnership with **traffix**

total traffic & event management solutions  
Old Arden Brickworks | Bickenhill | Solihull (West Midlands) | B92 0DY  
t +44 (0)900 819 9001 | f +44 (0)121 75 442507  
info@traffix.com | www.traffix.com

Project title:		
Traffic Management		
Drawing title: Proposed Ring Management Northway/Birmingham Business Park Bickenhill B40 1QA		
Date: 09/01/2019	Scale: 1:1250	Paper: A1
Drawn: CM	Checked: BNH	Approved: MM
Project Number: TFX 20541	Drawing Number: 001	Revision: -

This drawing is copyright & the property of Traffix & must not be copied in whole or in part without their written permission. Copyright is reserved. © This drawing must not be scaled. The Contractor is to report all discrepancies & errors to the Contract Manager prior to works commencing.