

Error! Reference source not found.

Schedule 4 Part 2 paragraph 6 – Temporary Interference

Schedule 33 Part 1, Schedule 2 Part 1

Form TM 1 - PH1-HS2-CL-TEM-000-000001 [Revision Po4]

# HS2

## HS2 FORM TM1

Highway Authority	Solihull Metropolitan Borough Council
Street(s)/USRN(s)	Lavender Hall Lane
HS2 Consent Reference	THW.AN.SMBC.LMJV.386 <b>Rev1</b>
Contractor document reference	
Submission Date (to Highway Authority)	24/12/2019
Proposed start date of works	<b>27/01/2020</b>
Proposed end date of works	<b>14/02/2020</b>
Consultation end/ requested response date	17/01/2020
Deemed consent date (if required)	N/A

## Temporary Interference with the Highway

In accordance with the powers set out in the **High Speed Rail (London - West Midlands) Act 2017**, the Contractor, acting on behalf of and, as agent for the Nominated Undertaker, hereby consults the highway authority and/or requests highway authority consent under Schedule 2, 4 and/or 33 as identified below:

<b>Consultation with the highway authority:</b>	
The temporary interference / works is on a street or location that <b>is listed</b> in Table 3 of Schedule 4 to the Act ( <b>Schedule 4 Part 2 paragraph 6</b> )	<input checked="" type="checkbox"/>
<b>Consent of the highway authority:</b>	
The temporary interference / works is on a street or location <b>not listed</b> in Table 3 of Schedule 4 of the Act ( <b>Schedule 4 Part 2 paragraph 6</b> )	<input type="checkbox"/>
<b>Trial holes (Schedule 2 only)</b>	<input type="checkbox"/>
<b>Protective provisions (Schedule 33) [mark as appropriate]</b>	
Works to a bridge requiring temporary interference, ( <b>Schedule 33 para 6</b> )	<input type="checkbox"/>
Alteration/disturbance to apparatus of the highway authority affixed to or placed under any highway or, access to the apparatus of the Highway Authority, ( <b>Schedule 33 Para 9</b> )	<input type="checkbox"/>
Depositing soil or materials or storing plant on the highway ( <b>Schedule 33 Para 12</b> )	<input type="checkbox"/>
Erection of scaffolding or screening (or hoarding) in the highway ( <b>Schedule 33 Para 12</b> )	<input type="checkbox"/>

Error! Reference source not found.

Schedule 4 Part 2 paragraph 6 – Temporary Interference

Schedule 33 Part 1, Schedule 2 Part 1

Form TM 1 - PH1-HS2-CL-TEM-000-000001 [Revision Po4]



<b>Table 1. High level summary</b> <i>(mark as appropriate)</i>	Alteration to apparatus of the highway authority	<input type="checkbox"/>	Deposit of material on the highway	<input type="checkbox"/>	Footway Works only	<input type="checkbox"/>	Peak hours	<input type="checkbox"/>	Works to PRow	<input type="checkbox"/>	Give and Take	<input type="checkbox"/>	Contra - flow	<input type="checkbox"/>	Lane Closure	<input type="checkbox"/>	Portable temporary traffic signals ( <i>delete as required</i> ) 2WTTL and 3WTTL	<input checked="" type="checkbox"/>	Priority working	<input type="checkbox"/>	Narrowing of Lane	<input type="checkbox"/>
	Trial holes	<input type="checkbox"/>	Erection of scaffolding/ hoarding	<input type="checkbox"/>	Works in the carriageway	<input type="checkbox"/>	Off Peak	<input checked="" type="checkbox"/>	Street works (NRSWA)	<input type="checkbox"/>	Stop / Go	<input type="checkbox"/>	Signage only	<input checked="" type="checkbox"/>	Road Closure	<input type="checkbox"/>	Works to existing or new traffic signals infrastructure	<input type="checkbox"/>	Associated utility works	<input type="checkbox"/>	Other.	<input type="checkbox"/>

**Table 2. Detailed works description, traffic management phasing and intended programme**

Row No.	Road name	Extent of Temporary Interference	Consent or Consultation	USRN	Grid Ref	EToN reference	TM Phase	TM drawing reference	Description of works	Description of associated traffic management	TM operational hours	Proposed Works Start Date	Estimated Works End Date
1.	Lavender Hall Lane	Within Act limits	Consult	35005828	SP239781 to SP241785	N/A	All phases	2001 2002 2003 2004 2005 D001 D002	Vegetation clearance	2/3WTTL and associated signage	0930-1530	27/01/2020	14/02/2020

**Note: Phases will run consecutively based on progression of works on site.**

**Details of pre-application discussions with the Highway Authority and stakeholders**

Date	Details
06/01/2020	Sch4 review with SMBC at SMBC offices

**Details of associated consents/approvals**

--

**Document references and supporting information**

Title	Phase (from Table 2)	Reference	Version
Proposed two way temporary traffic lights Lavender Hall Lane	1	TFX SC0043 2001	-
Proposed three way temporary traffic lights Lavender Hall Lane	2	TFX SC0043 2002	-
Proposed three way temporary traffic lights Lavender Hall Lane	3	TFX SC0043 2003	-
Proposed two way temporary traffic lights Lavender Hall Lane	4	TFX SC0043 2004	-
Proposed two way temporary traffic lights Lavender Hall Lane	5	TFX SC0043 2005	-
Indicative egress detail	1-5	TFX SC0043 D001	-
Indicative pedestrian management detail	1-5	TFX SC0043 D002	-

**Contractor Signature**

**This submission is made by the Contractor on behalf of and as agent for the Nominated Undertaker.**  
 HS2 Ltd authorises the contractor to submit the application for consultation or, as required, consent of the highway authority  
***[Contractor must obtain acceptance from HS2 before submitting the form to the highway authority]***

<b>Contractor</b>	LM-JV Cornerblock, Two Cornwall Street, Birmingham, B3 2DX
-------------------	--

<b>Contractor Authorised Signatory</b>	
--	---

Error! Reference source not found.

Schedule 4 Part 2 paragraph 6 – Temporary Interference

Schedule 33 Part 1, Schedule 2 Part 1

Form TM 1 - PH1-HS2-CL-TEM-000-000001 [Revision Po4]



<b>Contractor Site Contact Details</b>	HS2 helpdesk – 08081 434 434
--	------------------------------

## Highway Authority Response Sheet

*To be completed by the Highway Authority and provided as a response to the application*

<b>HS2 Consent Reference:</b>	
<b>Street(s):</b>	
<b>Submission Date:</b>	
<b>Response Date:</b>	

### Local Highway Authority Response

<b>Highway Authority:</b>	
---------------------------	--

#### Decision on the application by the highway authority, if consent is required:

<b>Consent granted</b> <input type="checkbox"/>	<i>If consent withheld or consent with comments, state ground(s) below:</i>
<b>Consent granted with comments</b> <input type="checkbox"/>	
<b>Consent withheld</b> <input type="checkbox"/>	
<b>Consultation</b> <input checked="" type="checkbox"/>	<p>To avoid too much disruption within the same area can you please amend this application to commence from 31/01/2020 when the works on Truggist Lane are due to commence.</p> <p>Lights to be manually controlled where possible.</p> <p>Any changes in TM or dates to be notified to SMBC in a timely manner.</p>

Signature: \_\_\_\_\_ LParidy \_\_\_\_\_ Date: \_\_\_\_\_ 17/01/2020 \_\_\_\_\_

Name of highway authority's authorised representative: \_\_\_\_\_ Lisa Paridy \_\_\_\_\_

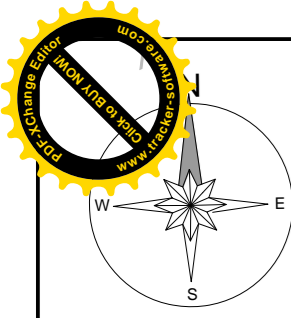

Local Authority: Solihull Metropolitan Council  
 NSG: Lavender Hall Lane, Berkswell, Solihull  
 USRN: 35005828

Desktop survey undertaken from google street view with imagery dated July 2018

Overhead power lines within site & Part of the route is tree lined

There is a speed change from 30 - 40 mph

Limited space of verge to install approach signage

There are ongoing works as part of a larger scheme currently taking place on Park Lane. Site survey should be undertaken prior to works stating to see what existing traffic management will be in place

There are accesses to properties within the works area

Key:

	Line of Works		Temporary Traffic Signal
	Works Area		Stop & Go Board
	Road Closure		Permanent Traffic Signal
	Diversion Route		Temporary Ped Signal
	Cone		Existing Bus Stop
	Pedestrian Barrier		3.5T Van
	Temporary Sign		

Notes:

Min width of sideways safety zone (S)	0.5m
Min length of longways clearance (L)	15m
Lavender Hall Lane	

**NOTES**

Vehicle Actuated (VA)  
 Temporary Traffic Light Phase Timings

Phase	Red Time	Green Time
A	20 seconds.	45 seconds.
B	20 seconds.	45 seconds.

Timings may be adjusted on site to suit traffic flow/conditions if required by a suitably qualified operative

Shuttle lane should ideally be between 3.25 & 3.5m or 3.0m as an absolute minimum

Where there is a private road/business and/or side approach within the works, contractor is to refer to drawing TFX SC0043 D001 for method of control

Pedestrians/cyclists will need managing in accordance with drawing TFX SC0043 D002

Operative to access site to ensure the installation complies with all current legislation and any issues should be immediately reported to the relevant contracts manager.

**Traffic Management to be switched for works on the opposite side of the carriageway**

Rev	Date	Comments	By	Chk

**THREE SHIRES LTD**  
 ENVIRONMENTAL EXCELLENCE

Working in Partnership with

**traffix**

total traffic & event management solutions

Old Arden Brickworks | Bickenhill | Solihull | West Midlands | B92 0DY  
 t +44 (0)800 819 9001 | f +44 (0)1675 442507  
 info@traffixuk.com | www.traffixuk.com

Project title:  
**Traffic Management**

Drawing title:  
**Proposed Two Way Temporary Traffic Lights  
 Lavender Hall Lane  
 Berkswell  
 CV7 7BN**

Date: 19-12-2019	Scale: NTS	Paper: A2
Drawn: CM	Checked: BNH	Approved: MM
Project Number: TFX SC0043	Drawing Number: 2005	Revision: -

This drawing is copyright & the property of Traffix & must not be copied in whole or in part without their written permission. Copyright is reserved. © This drawing must not be scaled. The Contractor is to report all discrepancies & errors to the Contract Manager prior to works commencing.

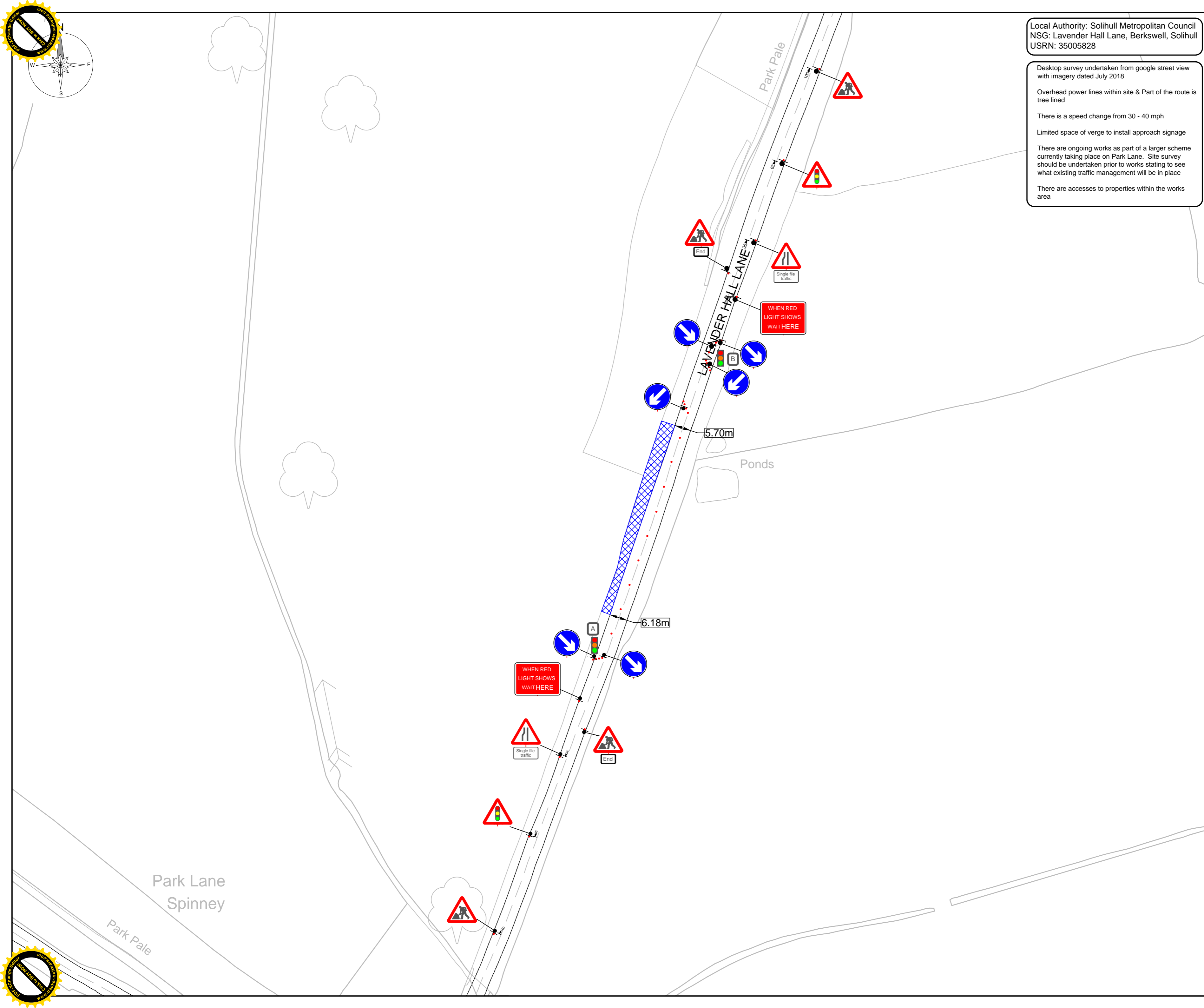
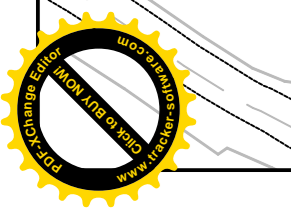



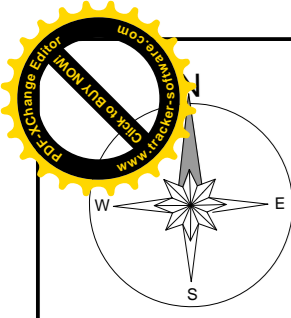

Local Authority: Solihull Metropolitan Council  
 NSG: Lavender Hall Lane, Berkswell, Solihull  
 USRN: 35005828

Desktop survey undertaken from google street view with imagery dated July 2018

Overhead power lines within site & Part of the route is tree lined

There is a speed change from 30 - 40 mph

Limited space of verge to install approach signage

There are ongoing works as part of a larger scheme currently taking place on Park Lane. Site survey should be undertaken prior to works stating to see what existing traffic management will be in place

There are accesses to properties within the works area

Key:

	Line of Works		Temporary Traffic Signal
	Works Area		Stop & Go Board
	Road Closure		Permanent Traffic Signal
	Diversion Route		Temporary Ped Signal
	Cone		Existing Bus Stop
	Pedestrian Barrier		3.5T Van
	Temporary Sign		

Notes:

Min width of sideways safety zone (S)	0.5m	0.5m
Min length of longways clearance (L)	0.5m	15m
Lavender Hall Lane		

**NOTES**

Vehicle Actuated (VA)  
 Temporary Traffic Light Phase Timings

Phase	Red Time	Green Time
A	20 seconds.	45 seconds.
B	20 seconds.	45 seconds.

Timings may be adjusted on site to suit traffic flow/conditions if required by a suitably qualified operative

Shuttle lane should ideally be between 3.25 & 3.5m or 3.0m as an absolute minimum

Where there is a private road/business and/or side approach within the works, contractor is to refer to drawing TFX SC0043 D001 for method of control

Pedestrians/cyclists will need managing in accordance with drawing TFX SC0043 D002

Operative to access site to ensure the installation complies with all current legislation and any issues should be immediately reported to the relevant contracts manager.

**Traffic Management to be switched for works on the opposite side of the carriageway**

Rev	Date	Comments	By	Chk

**THREE SHIRES LTD**  
 ENVIRONMENTAL EXCELLENCE

Working in Partnership with  
**traffix**

total traffic & event management solutions

Old Arden Brickworks | Bickenhill | Solihull | West Midlands | B92 0DY  
 t +44 (0)800 819 9001 | f +44 (0)1675 442507  
 info@traffixuk.com | www.traffixuk.com

Project title:  
**Traffic Management**

Drawing title:  
**Proposed Two Way Temporary Traffic Lights  
 Lavender Hall Lane  
 Berkswell  
 CV7 7BN**

Date: 19-12-2019	Scale: NTS	Paper: A2
Drawn: CM	Checked: BNH	Approved: MM
Project Number: TFX SC0043	Drawing Number: 2001	Revision: -

This drawing is copyright & the property of Traffix & must not be copied in whole or in part without their written permission. Copyright is reserved. © This drawing must not be scaled. The Contractor is to report all discrepancies & errors to the Contract Manager prior to works commencing.

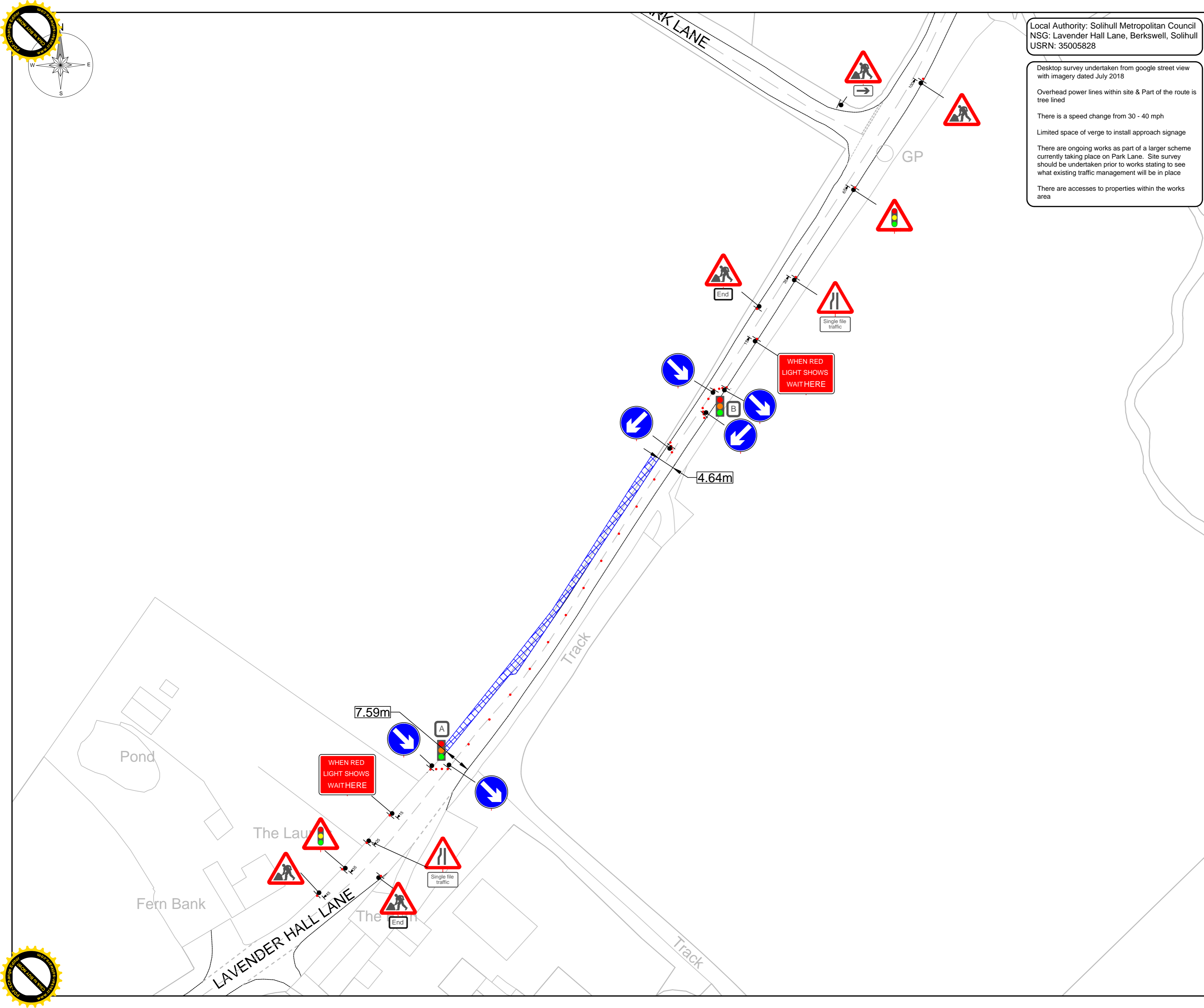



Local Authority: Solihull Metropolitan Council  
 NSG: Lavender Hall Lane, Berkswell, Solihull  
 USRN: 35005828

Desktop survey undertaken from google street view with imagery dated July 2018

Overhead power lines within site & Part of the route is tree lined

There is a speed change from 30 - 40 mph

Limited space of verge to install approach signage

There are ongoing works as part of a larger scheme currently taking place on Park Lane. Site survey should be undertaken prior to works stating to see what existing traffic management will be in place

There are accesses to properties within the works area

Key:

	Line of Works		Temporary Traffic Signal
	Works Area		Stop & Go Board
	Road Closure		Permanent Traffic Signal
	Diversion Route		Temporary Ped Signal
	Cone		Existing Bus Stop
	Pedestrian Barrier		3.5T Van
	Temporary Sign		

Notes:

Min width of sideways safety zone (S)	0.5m	1.2m
Min length of longways clearance (L)	0.5m	30m
Lavender Hall Lane		
Park Lane		

NOTES

Vehicle Actuated (VA)  
 Temporary Traffic Light Phase Timings

Phase	Red Time	Green Time
A	20 seconds.	45 seconds.
B	20 seconds.	45 seconds.
C	20 seconds.	45 seconds.

Timings may be adjusted on site to suit traffic flow/conditions if required by a suitably qualified operative

Shuttle lane should ideally be between 3.25 & 3.5m or 3.0m as an absolute minimum

Where there is a private road/business and/or side approach within the works, contractor is to refer to drawing TFX SC0043 D001 for method of control

Pedestrians/cyclists will need managing in accordance with drawing TFX SC0043 D002

Operative to access site to ensure the installation complies with all current legislation and any issues should be immediately reported to the relevant contracts manager.

**Traffic Management to be switched for works on the opposite side of the carriageway**

Rev	Date	Comments	By	Chk

**THREE SHIRES LTD**  
 ENVIRONMENTAL EXCELLENCE

Working in Partnership with  
**traffix**

total traffic & event management solutions

Old Arden Brickworks | Bickenhill | Solihull | West Midlands | B92 0DY  
 t +44 (0)800 819 9001 | f +44 (0)1675 442507  
 info@traffixuk.com | www.traffixuk.com

Project title:  
**Traffic Management**

Drawing title:  
**Proposed Three Way Temporary Traffic Lights  
 Lavender Hall Lane  
 Berkswell  
 CV7 7BN**

Date: 19-12-2019	Scale: NTS	Paper: A2
Drawn: CM	Checked: BNH	Approved: MM
Project Number: TFX SC0043	Drawing Number: 2002	Revision: -

This drawing is copyright & the property of Traffix & must not be copied in whole or in part without their written permission. Copyright is reserved. ©  
 This drawing must not be scaled.  
 The Contractor is to report all discrepancies & errors to the Contract Manager prior to works commencing.

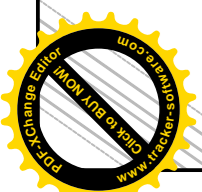
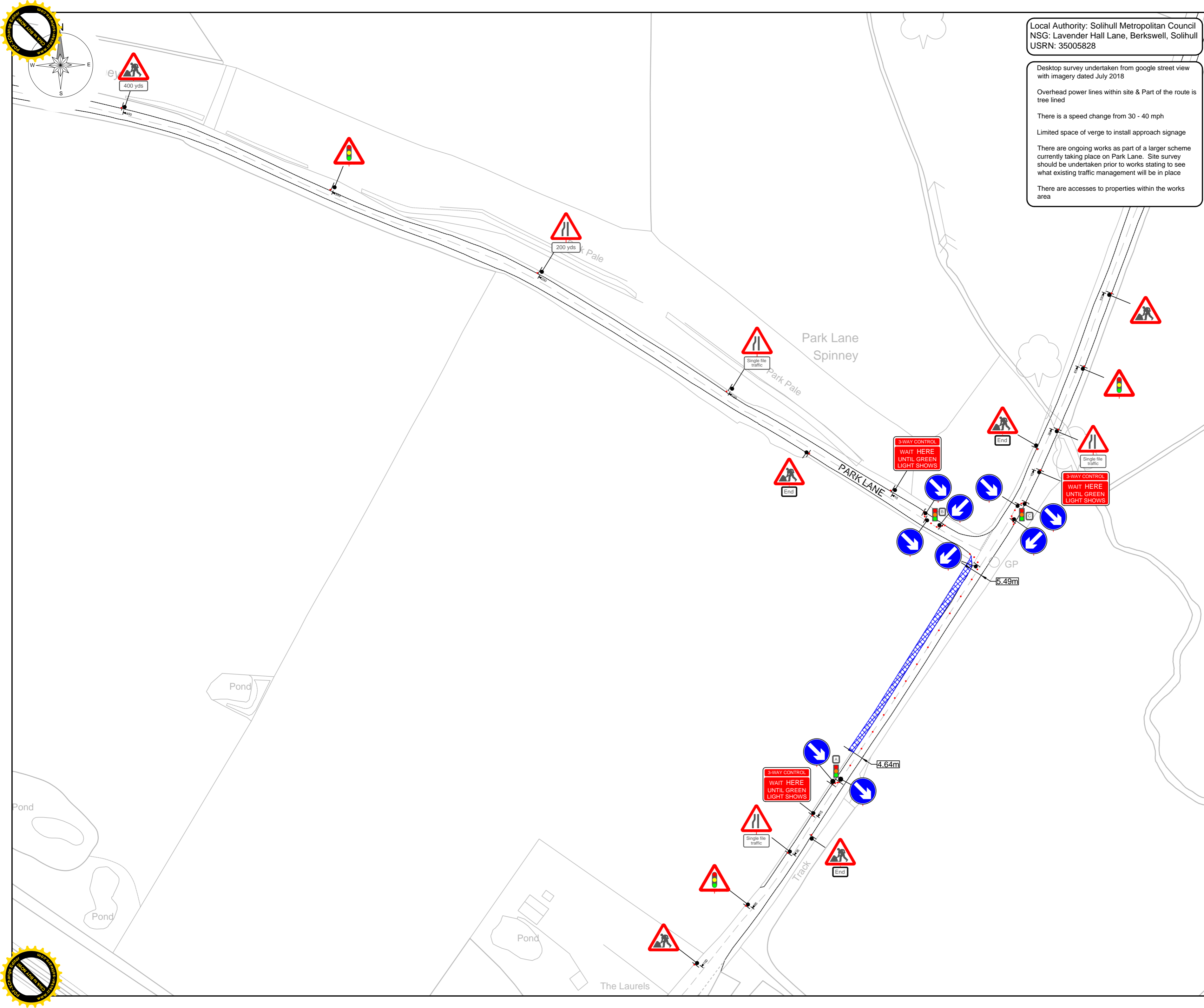





Local Authority: Solihull Metropolitan Council  
 NSG: Lavender Hall Lane, Berkswell, Solihull  
 USRN: 35005828

Desktop survey undertaken from google street view with imagery dated July 2018

Overhead power lines within site & Part of the route is tree lined

There is a speed change from 30 - 40 mph

Limited space of verge to install approach signage

There are ongoing works as part of a larger scheme currently taking place on Park Lane. Site survey should be undertaken prior to works stating to see what existing traffic management will be in place

There are accesses to properties within the works area

Key:

	Line of Works		Temporary Traffic Signal
	Works Area		Stop & Go Board
	Road Closure		Permanent Traffic Signal
	Diversion Route		Temporary Ped Signal
	Cone		Existing Bus Stop
	Pedestrian Barrier		3.5T Van
	Temporary Sign		

Notes:

Min width of sideways safety zone (S)	0.5m	1.2m
Min length of longways clearance (L)	0.5m	30m
Lavender Hall Lane		
Park Lane		

NOTES

Vehicle Actuated (VA)  
 Temporary Traffic Light Phase Timings

Phase	Red Time	Green Time
A	20 seconds.	45 seconds.
B	20 seconds.	45 seconds.
C	20 seconds.	45 seconds.

Timings may be adjusted on site to suit traffic flow/conditions if required by a suitably qualified operative

Shuttle lane should ideally be between 3.25 & 3.5m or 3.0m as an absolute minimum

Where there is a private road/business and/or side approach within the works, contractor is to refer to drawing TFX SC0043 D001 for method of control

Pedestrians/cyclists will need managing in accordance with drawing TFX SC0043 D002

Operative to access site to ensure the installation complies with all current legislation and any issues should be immediately reported to the relevant contracts manager.

**Traffic Management to be switched for works on the opposite side of the carriageway**

Rev	Date	Comments	By	Chk

**THREE SHIRES LTD**  
 ENVIRONMENTAL EXCELLENCE

Working in Partnership with  
**traffix**

total traffic & event management solutions

Old Arden Brickworks | Bickenhill | Solihull | West Midlands | B92 0DY  
 t +44 (0)800 819 9001 | f +44 (0)1675 442507  
 info@traffixuk.com | www.traffixuk.com

Project title:  
**Traffic Management**

Drawing title:  
**Proposed Three Way Temporary Traffic Lights  
 Lavender Hall Lane  
 Berkswell  
 CV7 7BN**

Date: 19-12-2019	Scale: NTS	Paper: A2
Drawn: CM	Checked: BNH	Approved: MM
Project Number: TFX SC0043	Drawing Number: 2003	Revision: -

This drawing is copyright & the property of Traffix & must not be copied in whole or in part without their written permission. Copyright is reserved. © This drawing must not be scaled.  
 The Contractor is to report all discrepancies & errors to the Contract Manager prior to works commencing.

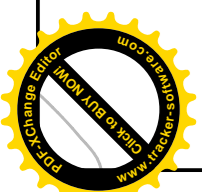
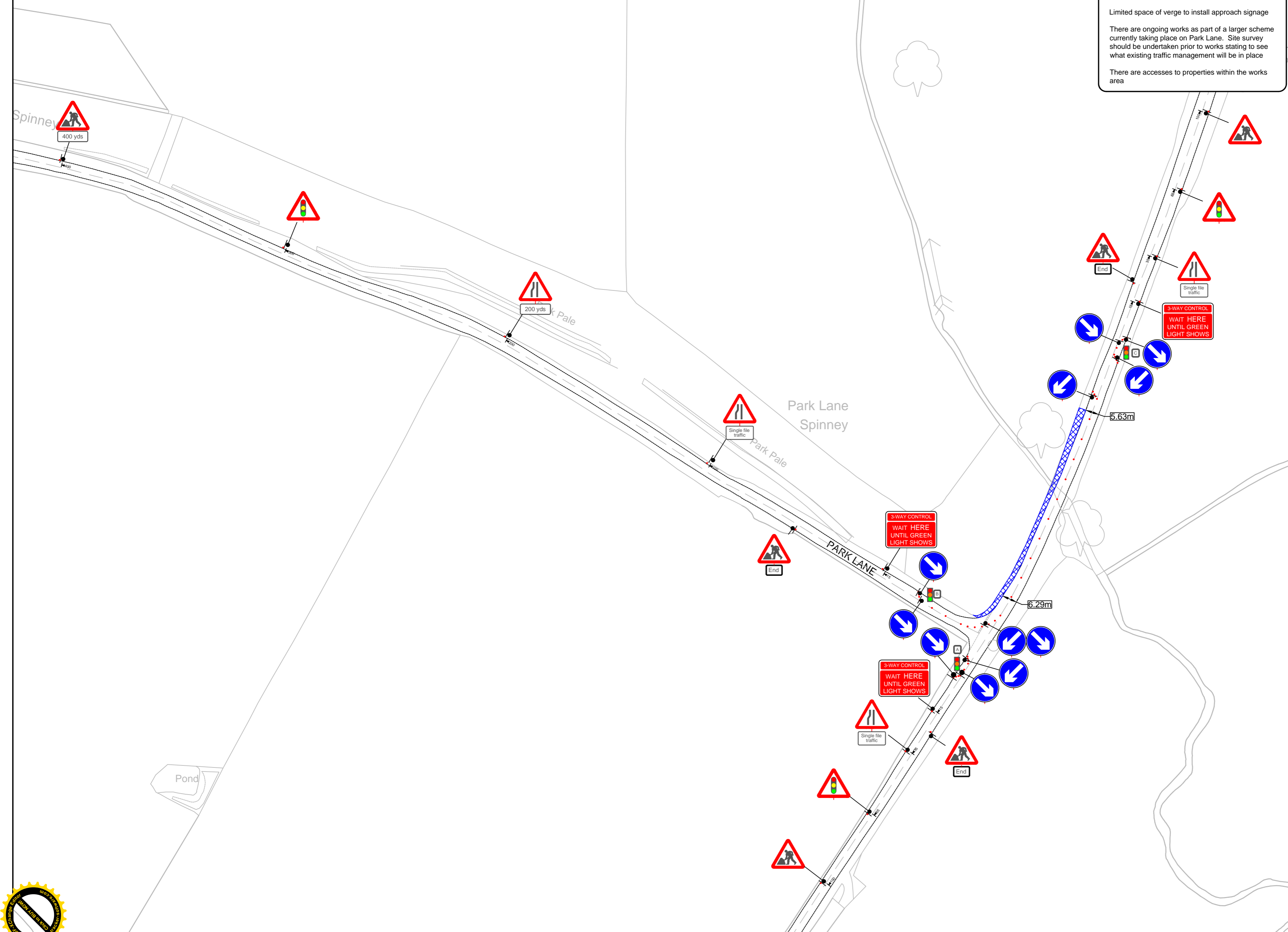

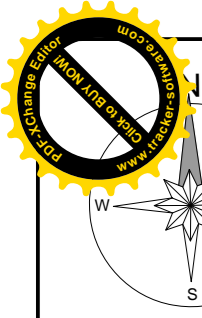

Local Authority: Solihull Metropolitan Council  
 NSG: Lavender Hall Lane, Berkswell, Solihull  
 USRN: 35005828

Desktop survey undertaken from google street view with imagery dated July 2018

Overhead power lines within site & Part of the route is tree lined

There is a speed change from 30 - 40 mph

Limited space of verge to install approach signage

There are ongoing works as part of a larger scheme currently taking place on Park Lane. Site survey should be undertaken prior to works stating to see what existing traffic management will be in place

There are accesses to properties within the works area

Key:

	Line of Works		Temporary Traffic Signal
	Works Area		Stop & Go Board
	Road Closure		Permanent Traffic Signal
	Diversion Route		Temporary Ped Signal
	Cone		Existing Bus Stop
	Pedestrian Barrier		3.5T Van
	Temporary Sign		

Notes:

Min width of sideways safety zone (S)	0.5m
Min length of longways clearance (L)	15m
Lavender Hall Lane	40

**NOTES**

Vehicle Actuated (VA)  
 Temporary Traffic Light Phase Timings

Phase	Red Time	Green Time
A	20 seconds.	45 seconds.
B	20 seconds.	45 seconds.

Timings may be adjusted on site to suit traffic flow/conditions if required by a suitably qualified operative

Shuttle lane should ideally be between 3.25 & 3.5m as an absolute minimum

Where there is a private road/business and/or side approach within the works, contractor is to refer to drawing TFX SC0043 D001 for method of control

Pedestrians/cyclists will need managing in accordance with drawing TFX SC0043 D002

Operative to access site to ensure the installation complies with all current legislation and any issues should be immediately reported to the relevant contracts manager.

**Traffic Management to be switched for works on the opposite side of the carriageway**

Rev	Date	Comments	By	Chk

**THREE SHIRES LTD**  
 ENVIRONMENTAL EXCELLENCE

Working in Partnership with  
**traffix**

total traffic & event management solutions

Old Arden Brickworks | Bickenhill | Solihull | West Midlands | B92 0DY  
 t +44 (0)800 819 9001 | f +44 (0)1675 442507  
 info@traffixuk.com | www.traffixuk.com

Project title:  
**Traffic Management**

Drawing title:  
**Proposed Two Way Temporary Traffic Lights  
 Lavender Hall Lane  
 Berkswell  
 CV7 7BN**

Date: 19-12-2019	Scale: NTS	Paper: A2
Drawn: CM	Checked: BNH	Approved: MM
Project Number: TFX SC0043	Drawing Number: 2004	Revision: -

This drawing is copyright & the property of Traffix & must not be copied in whole or in part without their written permission. Copyright is reserved. ©  
 This drawing must not be scaled.  
 The Contractor is to report all discrepancies & errors to the Contract Manager prior to works commencing.

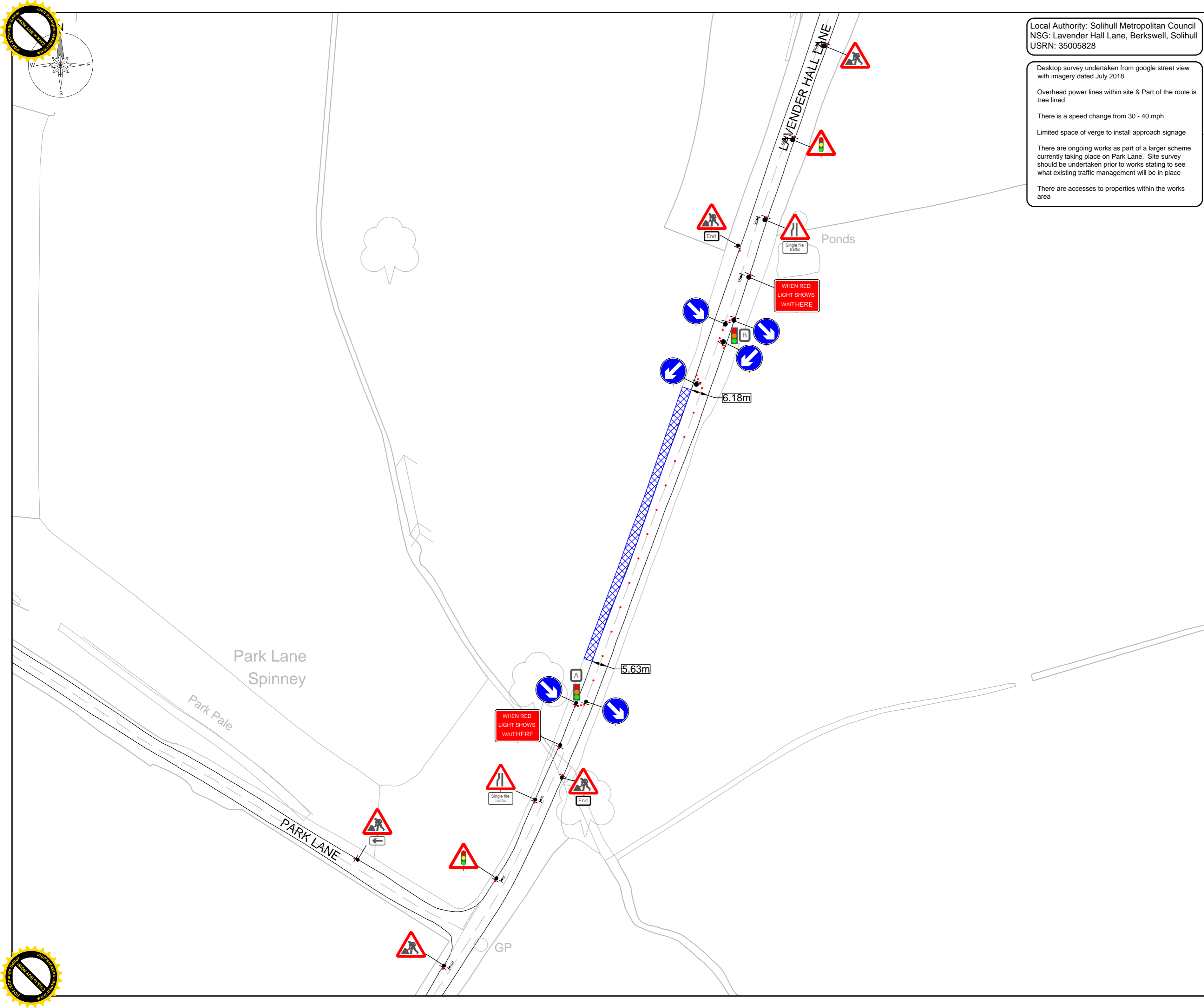

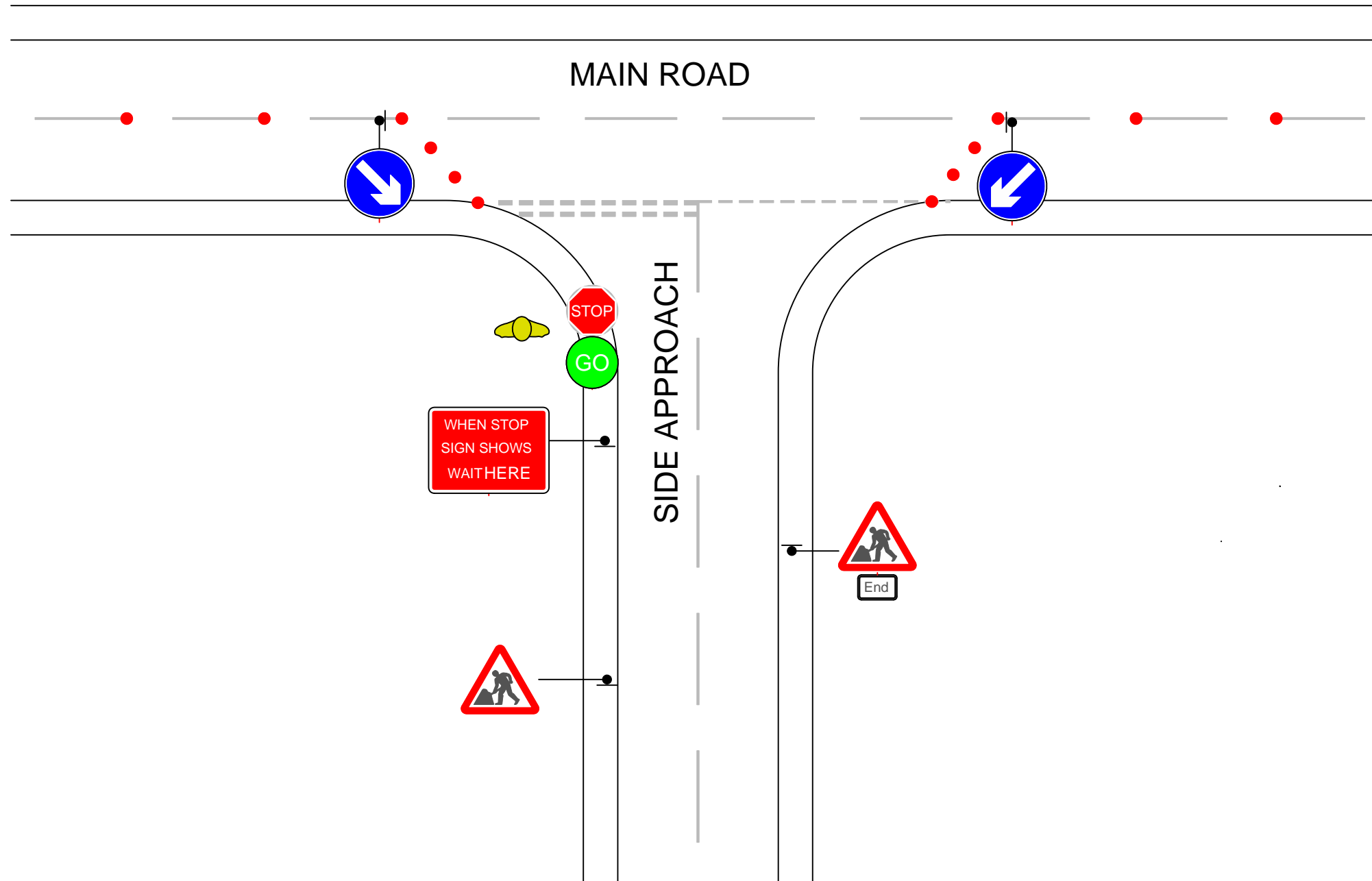
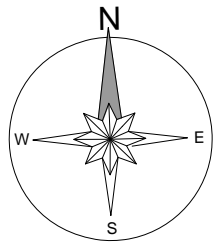

### Man on site

Side approach to be manned at all times and controlled via stop/go boards. When a vehicle is present, operatives to turn temp signals to all red and release the traffic from the side approach when safe to do so

Key:			
	Line of Works		Temporary Traffic Signal
	Works Area		Stop & Go Board
	Road Closure		Permanent Traffic Signal
	Diversion Route		Temporary Ped Signal
	Cone		Existing Bus Stop
	Pedestrian Barrier		3.5T Van
	Temporary Sign		

Notes:	
Min width of sideways safety zone (S)	
Min length of longways clearance (L)	

Rev	Date	Comments	By	Chk

Working in Partnership with

**traffix**

total traffic & event management solutions

Old Arden Brickworks | Bickenhill | Solihull | West Midlands | B92 0DY  
 t +44 (0)800 819 9001 | f +44 (0)1675 442507  
 info@traffixuk.com | www.traffixuk.com

Project title: Traffic Management		
Drawing title: Proposed Indicative Detail For Controlling Egress From a Private Road/Business		
Date: 19-12-2019	Scale: NTS	Paper: A3
Drawn: CM	Checked: BNH	Approved: MM
Project Number: TFX SC0043	Drawing Number: D001	Revision: -

This drawing is copyright & the property of Traffix & must not be copied in whole or in part without their written permission. Copyright is reserved. © This drawing must not be scaled. The Contractor is to report all discrepancies & errors to the Contract Manager prior to works commencing.

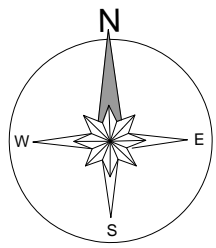

Key:			
	Line of Works		Temporary Traffic Signal
	Works Area		Stop & Go Board
	Road Closure		Permanent Traffic Signal
	Diversion Route		Temporary Ped Signal
	Cone		Existing Bus Stop
	Pedestrian Barrier		3.5T Van
	Temporary Sign		

Notes:	
Min width of sideways safety zone (S)	
Min length of longways clearance (L)	

Rev	Date	Comments	By	Chk

Working in Partnership with

## traffix

total traffic & event management solutions

Old Arden Brickworks | Bickenhill | Solihull | West Midlands | B92 0DY  
 t +44 (0)800 819 9001 | f +44 (0)1675 442507  
 info@traffixuk.com | www.traffixuk.com

Project title: Traffic Management		
Drawing title: Proposed Indicative Detail For Managing Pedestrians		
Date: 19-12-2019	Scale: NTS	Paper: A3
Drawn: CM	Checked: BNH	Approved: MM
Project Number: TFX SC0043	Drawing Number: D002	Revision: -

This drawing is copyright & the property of Traffix & must not be copied in whole or in part without their written permission. Copyright is reserved. © This drawing must not be scaled. The Contractor is to report all discrepancies & errors to the Contract Manager prior to works commencing.

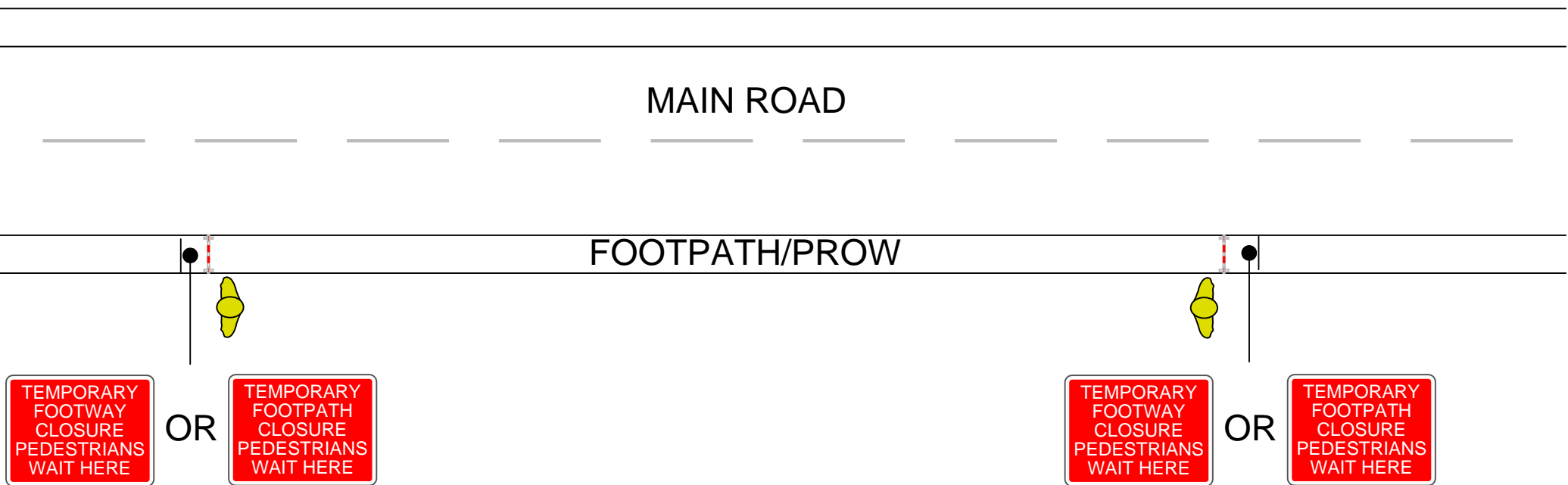

### Pedestrian Marshalls

Operatives with radio communications shall be positioned at each closure point to act as spotters on site.

As pedestrian(s) approach, the works on site are to stop and the site made safe.

The pedestrian(s) are to then be safely escorted through the works.