

HS2 FORM TM1

Highway Authority	Solihull Metropolitan Borough Council
Street(s)/USRN(s)	Middle Bickenhill Lane/USRN 35004549
HS2 Consent Reference	THW.AN.SMBC.NG.ZF113.ID33.P2 v0.0
HS2 Ltd document reference (version)	
Submission Date	11/01/2019
Proposed start date of consent	21/01/2019
Proposed end date of consent (including contingency)	31/12/2019
Consultation end date <i>[mark as appropriate]</i>	18/01/2019
Deemed consent date <i>[mark as appropriate]</i>	N/A

Temporary Highway Interference

In accordance with the powers set out in the High Speed Rail (London - West Midlands) Act 2017, the Nominated Undertaker hereby consults the highway authority and/or requests highway authority consent under Schedule 2, 4 and/or 33 as identified below:

Consultation with the highway authority:	
The temporary interference/works is on a street or location listed in Table 3 of Schedule 4 to the Act	<input checked="" type="checkbox"/>
Consent of the highway authority:	
The temporary interference/works is at a location, not listed in Table 3 of Schedule 4 of the Act	<input type="checkbox"/>
Trial holes (Schedule 2 only)	<input type="checkbox"/>
Protective provisions (Schedule 33) <i>[mark as appropriate]</i>	<input type="checkbox"/>
Works to a bridge requiring temporary interference, (Schedule 33 para 6)	<input type="checkbox"/>
Alteration/disturbance to apparatus of the highway authority affixed to or placed under any highway. or, access to the apparatus of the Highway Authority, (Schedule 33 Para 9)	<input type="checkbox"/>
Depositing soil or materials or storing plant on the highway (Schedule 33 Para 12)	<input type="checkbox"/>
Erection of scaffolding or screening (or hoarding) in the highway (Schedule 33 Para 12)	<input type="checkbox"/>

Table 1. Summary <i>(mark as appropriate)</i>	Alteration to apparatus of the highway authority	<input type="checkbox"/>	Deposit of material on the highway	<input type="checkbox"/>	Footway Works only	<input type="checkbox"/>	Peak hours	<input checked="" type="checkbox"/>	Give and Take	<input type="checkbox"/>	Lane Closure	<input type="checkbox"/>	Portable temporary traffic signals (delete as required) 2-way	<input type="checkbox"/>	Priority working	<input type="checkbox"/>
	Trial holes	<input type="checkbox"/>	Erection of scaffolding/hoarding	<input type="checkbox"/>	Works in the carriageway	<input type="checkbox"/>	Off Peak	<input checked="" type="checkbox"/>	Stop /Go	<input type="checkbox"/>	Road Closure	<input type="checkbox"/>	Works to existing or new signal installations	<input type="checkbox"/>	Associated utility works	<input checked="" type="checkbox"/>

Table 2. Works description, traffic management phasing and intended programme

Road name	Extent of Temporary Interference	USRN	Grid Ref	EToN reference	TM Phase	TM drawing reference	Description of works	Description of associated traffic management	TM operational hours	Proposed Works Start Date	Estimated Works End Date
Middle Bickenhill Lane	Site access traffic management	35004 549	42027 8E 28415 8N	TBC	Phase 1	ZF112-ZF113R- ZF113-ZF113A- ZF114-SA	Construction traffic is to leave the highway and access the towers on private land via Middle Bickenhill Lane which is now permanently closed to public traffic.	Signage on Packington Lane on temporary A-frames to be placed prior to the site access (Middle Bickenhill Lane) and left in place until the programmed end of the National Grid ZF Overhead Line works.	24 Hours	21/01/2019	31/12/2019

Details of pre-application discussions	
Date	Details
On-going	Attendance and presentation at Solihull Traffic Liaison Group Meetings
On-going	Liaison with HS2 Assistant Traffic Manager, Peter Atkins/Saskia Wearden
25.10.2018	Meeting with Solihull Highway Authority (Dave Keeney/Andy Wilkins)
Details of associated consents/approvals	
<ul style="list-style-type: none"> Babcock Local Traffic Management Plan and technical appendices to HS2 	

Title	Phase (from Table 1)	eB reference	Version
Site access traffic management drawing on Packington Lane Drawing REF: ZF112-ZF113R-ZF113-ZF113A-ZF114-SA	1		

Contractor Signature	
This submission is made by the Contractor on behalf of the Nominated Undertaker HS2 Ltd authorises the contractor to submit the application for consultation or, as required, consent of the highway authority <i>[The Contractor must obtain a Code 1 acceptance from the HS2 Area Traffic Manager before submitting this form to the highway authority]</i>	
Contractor National Grid	Judith Vokes Consents Officer National Grid Tel. 07584 204 369 <u>Judith.vokes@nationalgrid.com</u>
Contractor Authorised Signatory	

Highway Authority Response Sheet

HS2 Consent Reference:	THW.AN.SMBC.NG.ZF113.ID33.P2 v0.0
Street(s):	Middle Bickenhill Lane
Submission Date:	11/01/2019
Response Date:	**/**/**

Local Highway Authority Response (THW.AN.SMBC.NG.ZF113.ID33.P2 v0.0)	
Highway Authority:	Solihull Metropolitan Borough Council
Decision on the application by the highway authority, if consent is required:	
Consent granted <input type="checkbox"/>	If consent withheld or consent with comments, state ground(s) below:
Consent granted with comments <input type="checkbox"/>	
Consent withheld <input type="checkbox"/>	
Consultation <input checked="" type="checkbox"/>	<i>[Insert comments on consultation]</i>
Signature: <u></u> Date: <u>14.01.19</u>	
Name of highway authority's authorised representative: <u>Lisa Pardy</u>	

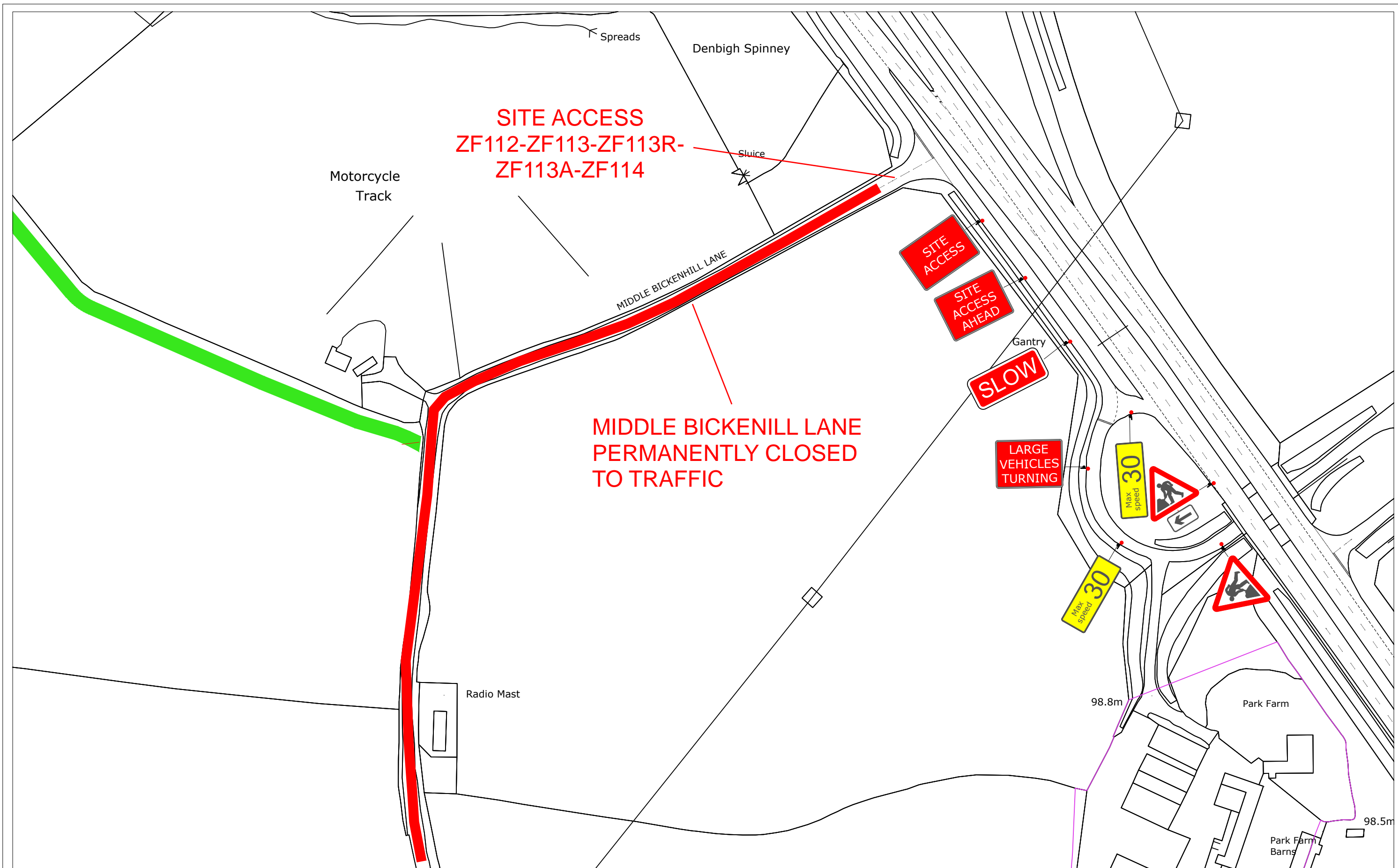

SITE ACCESS
ZF112-ZF113-ZF113R-
ZF113A-ZF114

MIDDLE BICKENILL LANE
PERMANENTLY CLOSED
TO TRAFFIC

A LUX
PLANT TRAFFIC CONTROL & MANAGEMENT
 A-Plant Lux Traffic Control & Management
 Kemble Airfield Enterprise Park
 Cirencester Road
 Kemble
 GL7 6BQ
 Telephone : 01666 822000
 Fax: 0845 0047105

<p>DETAIL A</p> <p>Running lane(s)</p> <p>Hard Shoulder</p> <p>Verge</p> <p>NOTES: 1) During darkness, a single road danger lamp complying with regulation 55 should be provided. 2) Traffic cones should conform to diagram 7101.1 and to BS EN 13422.</p>	<p>DETAIL B</p> <p>Traffic cones (1.5m spacing)</p> <p>N.B Road Danger Lamps complying with Regulation 55 should be provided during darkness</p> <p>DETAIL D</p> <p>750mm or 1m high traffic cones</p> <p>N.B Road Danger Lamps complying with Regulation 55 should be provided during darkness</p>	<p>Running lanes</p> <p>3.7m maximum</p> <p>3.25m desirable minimum</p> <p>3.0m absolute minimum</p> <p>All signs will be 750mm and will be held in place with two sandbags</p> <p>DETAIL C2</p> <p>Traffic cones (3m spacing)</p> <p>N.B Road Danger Lamps complying with Regulation 55 should be provided during darkness</p>
--	---	---

<p>DRAWING DESCRIPTION</p> <p>SITE ACCESS POINT TWR ZF112 - ZF114</p> <p>MIDDLE BICKENHILL ROAD COLESHILL BIRMINGHAM B46 3HX</p> <p>X: 419860 Y: 284706</p> <p>CLIENT DETAILS</p> <p>BABCOCK NETWORKS</p>	<p>DO WORK AT</p> <p>PURPOSE OF WORKS</p> <p>SITE ACCESS</p>	<p>PEAK TIMES</p> <p>DRAWN BY</p> <p>RPW</p>	<p>WEEKEND</p> <p>REP / DEPOT</p> <p>RPW/222</p>	<p>OFF PEAK</p> <p>AMMEND No</p> <p>02</p>	<p>NIGHT</p> <p>SCALE</p> <p>NOT TO SCALE</p>	<p>DATE</p> <p>10/01/19</p>	<p>SHEET NO</p> <p>1 of 1</p>
	<p>PERMANENT LIGHTS AFFECT SITE?</p> <p>PEDESTRIAN CROSSING AFFECTED?</p> <p>BUS ROUTES / STOPS AFFECTED?</p>	<p>X</p> <p>X</p> <p>X</p>	<p>ZF112-ZF113R-ZF113-ZF113A-ZF114-SA</p>				