

Tinsley-Evans, Emma (Places Directorate - Solihull MBC)

From: GEO [geo@fishergerman.co.uk]
Sent: 12 April 2013 13:46
To: Tinsley-Evans, Emma (Places Directorate - Solihull MBC)
Cc: Tinsley-Evans, Emma (Places Directorate - Solihull MBC)
Subject: GEO LS-130412-JR-832-TZD
Attachments: LS-130412-JR-832-TZD.pdf

Follow Up Flag: Follow up
Flag Status: Flagged

Emma (Places Directorate - Solihull MBC) Tinsley-Evans,

Please find attached for ref LS-130412-JR-832-TZD

Geo Networks Limited

For and on behalf of Fisher German LLP
0845 095 6910



PO Box 9198 - Ashby de la Zouch - Leicestershire - LE65 9BU

This e-mail message is confidential and for the use of the addressee only. If the message is received by anyone other than the addressee it must be deleted. Internet e-mails are not secure and Fisher German does not accept responsibility for changes made to the message. Fisher German LLP is a limited liability partnership. Registered Number: OC317554. SAVE PAPER - Please do not print this e-mail unless absolutely necessary

This email has been scanned by the Symantec Email Security.cloud service.
For more information please visit <http://www.symanteccloud.com>

Our Ref: LS-130412-JR-832-TZD /AFF/GCP/NS

Your Ref: The Haven

Date: 12-04-2013

For the attention of Ms Emma Tinsley
Solihull Metropolitan Borough Council
Council House
Manor Square
Solihull
West Midlands
B91 3QB

FISHER GERMAN LLP
PO BOX 9198
ASHBY DE LA ZOUCH
LEICESTERSHIRE LE65 9BU

Telephone 0845 095 6910

Fax 0845 862 0874

Email: geo@fishergerman.co.uk

www.fishergerman.co.uk

Dear Sirs/Madam

Geo Network Limited

Your Ref: The Haven

Thank you for your enquiry dated: 12-04-2013. We can confirm that our client's apparatus, (being Geo's Network) may be affected by your proposals as indicated on the attached plan(s). The plan(s) supplied are intended for general guidance only and should not be relied upon for excavation or construction purposes. No guarantee is given regarding the accuracy of the information provided and in order to verify the accurate location of the apparatus in conjunction with your proposals you should contact Geo's Mark up Service to arrange a site visit. Their contact details are:

Geo Network Limited
NOC, Magdalene House
Compass Point Business Park
Stocks Bridge Way
St. Ives
Cambridgeshire
PE27 5JL

Tel Number 0845 601 8215
Fax Number 0845 621 0053
email geosupport@noc.geo-uk.net

When contacting Geo's Mark up Service, **please quote the Enquiry Ref given at the top of this letter**, which is specific to this enquiry. Please note that you should contact Geo's Mark up Service within **28 days** of the date of this letter in order to validate this enquiry otherwise it will become void. Geo's Mark up Service will be able to provide guidance on the required procedures for working in the vicinity of Geo's Network. To reiterate you should not undertake any work or activity without first contacting Geo's Mark up Service for advice and, if required, supervision. Please note that implementation of any unapproved work that affects Geo's Network may result in serious consequences in terms of health and safety, expense and other attendant liabilities. In such cases it is the perpetrator of the act, together with any other promoting organisation, that shall be held fully accountable for any resulting damage. Should you require any further assistance regarding this letter please contact the undersigned or alternatively, you can contact Geo's Mark up Service via the details provided above.

Yours faithfully

FISHER GERMAN LLP

Enc Location Plan
CC Magdalene



Fisher German LLP is a limited liability partnership. Registered in England and Wales. Registered Number: OC317554.
Registered Office: 40 High Street, Market Harborough, Leicestershire LE16 7NX.
A list of members' names is available for inspection at the Market Harborough office.
Regulated by RICS.



IMPORTANT WARNING

Information regarding the location of Geo Plant is given for your assistance and is intended for general guidance only. No guarantee is given of its accuracy.

It should not be relied upon in the event of excavations or other works being made near to Geo Plant which may exist at various depths and may deviate from the marked route.

FOR FURTHER INFORMATION PLEASE CONTACT

FISHER GERMAN ON 0845 0956910

REFERENCE NOS.....

DATE: APRIL 2013

SCALE: NOT TO SCALE

— = GEO FIBRE OPTIC CABLE



Reproduced by permission of Ordnance Survey on behalf of HMSO. Crown Copyright and database right 2009. All rights reserved. Ordnance Survey Licence number 0100049487



Own Your Network

Approximate position only
Contact Mark Up Services
Prior to works.

**GEO NETWORKS
LIMITED**

LOCATION PLAN

"This plan must not be copied or reproduced without prior written consent from the office of origin."



Fisher German LLP
PO Box 9198
Ashby de la Zouch
LE65 9BU
Tel: 0845 0956910
Fax: 0845 8620874
geo@fishergerman.co.uk

THIS DRAWING IS PROTECTED BY COPYRIGHT. IT MAY NOT BE REPRODUCED OR TRANSMITTED IN ANY FORM OR BY ANY MEANS WITHOUT WRITTEN PERMISSION FROM FISHER GERMAN LLP.
FISHER GERMAN LLP IS LIMITED LIABILITY LIMITED PARTNERSHIP REGISTERED IN ENGLAND AND WALES. REGISTERED NUMBER: 0037954

Tinsley-Evans, Emma (Places Directorate - Solihull MBC)

From: Tinsley-Evans, Emma (Places Directorate - Solihull MBC)
Sent: 18 April 2013 15:13
To: 'geosupport@noc.geo-uk.net'
Cc: 'GEO'
Subject: GEO LS-130412-JR-832-TZD/AFF/GCP/NS
Attachments: LS-130412-JR-832-TZD.pdf

Dear Sir/ Madam,

Ref: GEO LS-130412-JR-832-TZD/AFF/GCP/NS

I recently received the attached from you in response to a consultation that Solihull Council is undertaking.

It appears that GEO's apparatus may be affected by a site that the Council is proposing to allocate for future Gypsy and Traveller use. You commented in a previous round of consultation that the presence of GEO apparatus in this location would not necessarily prevent the site being taken forward, but if there were any works on the approach road to this site then we would need to let you know in advance, in order to arrange for your plant protection officer to meet up with us to discuss your network protection.

I would be grateful if you could confirm whether this is still the case and that the presence of GEO apparatus in this location would not prevent deliverability of this site.

I look forward to hearing from you.

Kind regards,

Emma

*Emma Tinsley
Principal Planning Officer
Spatial Planning Team
Solihull MBC*

*Tel: 0121 704 6428
Fax: 0121 704 6575
Email: etinsley@solihull.gov.uk*

From: GEO [<mailto:geo@fishergerman.co.uk>]
Sent: 12 April 2013 13:46
To: Tinsley-Evans, Emma (Places Directorate - Solihull MBC)
Cc: Tinsley-Evans, Emma (Places Directorate - Solihull MBC)
Subject: GEO LS-130412-JR-832-TZD

Emma (Places Directorate - Solihull MBC) Tinsley-Evans,

Please find attached for ref LS-130412-JR-832-TZD

Geo Networks Limited

For and on behalf of Fisher German LLP
0845 095 6910



This e-mail message is confidential and for the use of the addressee only. If the message is received by anyone other than the addressee it must be deleted. Internet e-mails are not secure and Fisher German does not accept responsibility for changes made to the message. Fisher German LLP is a limited liability partnership. Registered Number: OC317554. SAVE PAPER - Please do not print this e-mail unless absolutely necessary.

This email has been scanned by the Symantec Email Security.cloud service.
For more information please visit <http://www.symanteccloud.com>

Tinsley-Evans, Emma (Places Directorate - Solihull MBC)

From: Geo Noc [geosupport@noc.geo-uk.net]
Sent: 21 April 2013 22:03
To: Tinsley-Evans, Emma (Places Directorate - Solihull MBC)
Cc: Geo Noc
Subject: RE: GEO LS-130412-JR-832-TZD/AFF/GCP/NS

Hello Emma

Can you please supply the previous information you was supplied from ourselves at Geo, as I am unable to find this information on our logging system. On receipt we would have provided a 5 digit number starting with SDE ***** and the Fisher German reference for that time. We can then view what you have been advised.

But on viewing the information you have provided this does still seem to be the case, where the only part we would be at risk is if any works are to be undertaken within the main entrance to the site or any works in the footpath/verge along Catherine De Barnes Lane.

Please provide the information requested if further correspondence is required.

Kind Regards

Kelly Bond

Geo NOC
Tel: 0845 601 8215
Fax: 0845 621 0053
Email: geosupport@noc.geo-uk.net

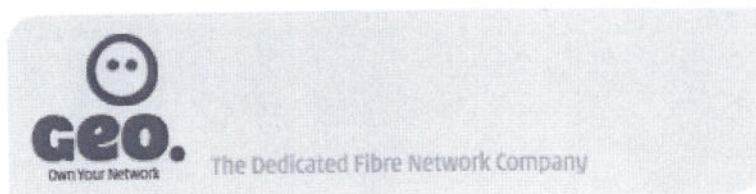

From: Tinsley-Evans, Emma (Places Directorate - Solihull MBC) [<mailto:etinsley@solihull.gov.uk>]
Sent: 18 April 2013 15:13
To: Geo Noc
Cc: 'GEO'
Subject: GEO LS-130412-JR-832-TZD/AFF/GCP/NS

Dear Sir/ Madam,

Ref: [GEO LS-130412-JR-832-TZD/AFF/GCP/NS](#)

I recently received the attached from you in response to a consultation that Solihull Council is undertaking.

It appears that GEO's apparatus may be affected by a site that the Council is proposing to allocate for future Gypsy and Traveller use. You commented in a previous round of consultation that the presence of GEO apparatus in this location would not necessarily prevent the site being taken forward, but if there were any works on the approach

road to this site then we would need to let you know in advance, in order to arrange for your plant protection officer to meet up with us to discuss your network protection.

I would be grateful if you could confirm whether this is still the case and that the presence of GEO apparatus in this location would not prevent deliverability of this site.

I look forward to hearing from you.

Kind regards,

Emma

Emma Tinsley
Principal Planning Officer
Spatial Planning Team
Solihull MBC

Tel: 0121 704 6428

Fax: 0121 704 6575

Email: etinsley@solihull.gov.uk

From: GEO [<mailto:geo@fishergerman.co.uk>]

Sent: 12 April 2013 13:46

To: Tinsley-Evans, Emma (Places Directorate - Solihull MBC)

Cc: Tinsley-Evans, Emma (Places Directorate - Solihull MBC)

Subject: GEO LS-130412-JR-832-TZD

Emma (Places Directorate - Solihull MBC) Tinsley-Evans,

Please find attached for ref LS-130412-JR-832-TZD

Geo Networks Limited

For and on behalf of Fisher German LLP

0845 095 6910



PO Box 9198 - Ashby de la Zouch - Leicestershire - LE65 9BU

This e-mail message is confidential and for the use of the addressee only. If the message is received by anyone other than the addressee it must be deleted. Internet e-mails are not secure and Fisher German does not accept responsibility for changes made to the message. Fisher German LLP is a limited liability partnership. Registered Number: OC317554. **SAVE PAPER** - Please do not print this e-mail unless absolutely necessary

This email has been scanned by the Symantec Email Security.cloud service.
For more information please visit <http://www.symanteccloud.com>

DISCLAIMER:

'This e-mail and files transmitted with it are confidential. If you are not the intended recipient, please notify the sender immediately and delete the message. Any views or opinions presented are solely those of the author and do not necessarily represent those of Solihull Council unless explicitly

Tinsley-Evans, Emma (Places Directorate - Solihull MBC)

From: Tinsley-Evans, Emma (Places Directorate - Solihull MBC)
Sent: 22 April 2013 08:59
To: 'Geo Noc'
Subject: RE: GEO LS-130412-JR-832-TZD/AFF/GCP/NS
Attachments: RE: GEO Networks Ltd Response***Our reference SDE41778

Hi Kelly,

Thank you for the reply.

Please find attached the email that was sent from GEO last time.

Best wishes,

Emma

From: Geo Noc [mailto:geosupport@noc.geo-uk.net]
Sent: 21 April 2013 22:03
To: Tinsley-Evans, Emma (Places Directorate - Solihull MBC)
Cc: Geo Noc
Subject: RE: GEO LS-130412-JR-832-TZD/AFF/GCP/NS

Hello Emma

Can you please supply the previous information you was supplied from ourselves at Geo, as I am unable to find this information on our logging system. On receipt we would have provided a 5 digit number starting with SDE ***** and the Fisher German reference for that time. We can then view what you have been advised.

But on viewing the information you have provided this does still seem to be the case, where the only part we would be at risk is if any works are to be undertaken within the main entrance to the site or any works in the footpath/verge along Catherine De Barnes Lane.

Please provide the information requested if further correspondence is required.

Kind Regards

Kelly Bond

Geo NOC
Tel: 0845 601 8215
Fax: 0845 621 0053
Email: geosupport@noc.geo-uk.net



From: Tinsley-Evans, Emma (Places Directorate - Solihull MBC) [mailto:etinsley@solihull.gov.uk]
Sent: 18 April 2013 15:13
To: Geo Noc
Cc: 'GEO'
Subject: GEO LS-130412-JR-832-TZD/AFF/GCP/NS

Dear Sir/ Madam,

Ref: GEO LS-130412-JR-832-TZD/AFF/GCP/NS

I recently received the attached from you in response to a consultation that Solihull Council is undertaking.

It appears that GEO's apparatus may be affected by a site that the Council is proposing to allocate for future Gypsy and Traveller use. You commented in a previous round of consultation that the presence of GEO apparatus in this location would not necessarily prevent the site being taken forward, but if there were any works on the approach road to this site then we would need to let you know in advance, in order to arrange for your plant protection officer to meet up with us to discuss your network protection.

I would be grateful if you could confirm whether this is still the case and that the presence of GEO apparatus in this location would not prevent deliverability of this site.

I look forward to hearing from you.

Kind regards,

Emma

*Emma Tinsley
Principal Planning Officer
Spatial Planning Team
Solihull MBC*

*Tel: 0121 704 6428
Fax: 0121 704 6575
Email: etinsley@solihull.gov.uk*

From: GEO [mailto:geo@fishergerman.co.uk]
Sent: 12 April 2013 13:46
To: Tinsley-Evans, Emma (Places Directorate - Solihull MBC)
Cc: Tinsley-Evans, Emma (Places Directorate - Solihull MBC)
Subject: GEO LS-130412-JR-832-TZD

Emma (Places Directorate - Solihull MBC) Tinsley-Evans,

Please find attached for ref LS-130412-JR-832-TZD

Geo Networks Limited

For and on behalf of Fisher German LLP
0845 095 6910



PO Box 9198 - Ashby de la Zouch - Leicestershire - LE65 9BU

Tinsley-Evans, Emma (Places Directorate - Solihull MBC)

From: Geo Noc [geosupport@noc.geo-uk.net]
Sent: 10 October 2012 19:25
To: Tinsley-Evans, Emma (Places Directorate - Solihull MBC); 'GEO'
Cc: Geo Noc; 'Catherine.Kinnane@fishergerman.co.uk'
Subject: RE: GEO Networks Ltd Response***Our reference SDE41778

Good evening Emma

We have reviewed your request and have found the following:-

417110, 282490 Old Damson Lane. OK no issues

418610, 284860 The Warren, Bickenhill Lane, Marston Green. OK but please see screenshot attached

411720, 277000 The Uplands, Dickens Heath Road. OK no issues

418510, 282520 The Haven, Catherine-de-Barnes Lane. OK but please see screenshot attached. If you are conducting any works on the approach road to this site then please let us know in advance and we can arrange for our plant protection officer to meet up with yourself or your engineers to discuss our network protection.

If you have any questions or concerns please contact us on the number or email address after the screenshots.

Geo.

418610 284860

All Network Data

Enter a site, customer, circuit or other name



Done

Geo.

418510 282520

All Network Data

Enter a site, customer, circuit or other name

Map Options Reporting General Documents



Done

Best regards
Paul Morgan

Geo NOC
Tel: 0845 601 8215
Fax: 0845 621 0053
Email: geosupport@noc.geo-uk.net



 Please consider the environment - think before you print.

From: Tinsley-Evans, Emma (Places Directorate - Solihull MBC) [<mailto:etinsley@solihull.gov.uk>]
Sent: 09 October 2012 14:41
To: 'GEO'
Cc: Geo Noc; 'Catherine.Kinnane@fishergerman.co.uk'
Subject: FW: GEO Networks Ltd Response

Good afternoon,

I recently received the attached from you in response to a recent consultation that Solihull Council undertook.

It appears that GEO's apparatus may be affected by some of the proposals and I would be grateful if you could explain what this means in practice, what the next steps would be and whether it would prevent any site allocations being taken forward.

Many thanks,

Emma Tinsley
Principal Planning Officer
Spatial Planning Team
Solihull MBC
Tel: 0121 704 6428
Fax: 0121 704 6575
Email: etinsley@solihull.gov.uk

From: GEO [<mailto:Geo.NetworksLimited@fishergerman.co.uk>]
Sent: 05 September 2012 12:56
To: Tinsley-Evans, Emma (Places Directorate - Solihull MBC)
Cc: Geo Noc; Catherine Kinnane
Subject: GEO Networks Ltd Response

For your attention,

Regards.

Geo Networks Limited

For and on behalf of Fisher German LLP
0845 095 6910



PO Box 9198 - Ashby de la Zouch - Leicestershire - LE65 9BU

This e-mail message is confidential and for the use of the addressee only. If the message is received by anyone other than the addressee it must be deleted. Internet e-mails are not secure and Fisher German does not accept responsibility for changes made to the message. Fisher German LLP is a limited liability partnership. Registered Number: OC317554. SAVE PAPER - Please do not print this e-mail unless absolutely necessary

This email has been scanned by the Symantec Email Security.cloud service.
For more information please visit <http://www.symanteccloud.com>

DISCLAIMER:

'This e-mail and files transmitted with it are confidential. If you are not the intended recipient, please notify the sender immediately and delete the message. Any views or opinions presented are solely those of the author and do not necessarily represent those of Solihull Council unless explicitly stated otherwise. Solihull Council may monitor the contents of e-mail sent and received via its network for the purposes of ensuring compliance with its policies and procedures. The contents of e-mails may have to be disclosed to third parties following a request under legislation such as the Data Protection Act 1998 or the Freedom of Information Act 2000.'

Click [here](#) to report this email as spam. **_SPAMREPORTEND**

This message has been scanned for viruses by [BlackSpider MailControl](#)

Tinsley-Evans, Emma (Places Directorate - Solihull MBC)

From: Tinsley-Evans, Emma (Places Directorate - Solihull MBC)
Sent: 21 May 2013 07:51
To: 'geosupport@noc.geo-uk.net'
Subject: FW: GEO LS-130412-JR-832-TZD/AFF/GCP/NS
Attachments: RE: GEO Networks Ltd Response***Our reference SDE41778

FAO Kelly Bond

Hello Kelly,

Just wondering if you have had chance to consider information in the emails below.

Best wishes,

Emma

From: Tinsley-Evans, Emma (Places Directorate - Solihull MBC)
Sent: 22 April 2013 08:59
To: 'Geo Noc'
Subject: RE: GEO LS-130412-JR-832-TZD/AFF/GCP/NS

Hi Kelly,

Thank you for the reply.

Please find attached the email that was sent from GEO last time.

Best wishes,

Emma

From: Geo Noc [mailto:geosupport@noc.geo-uk.net]
Sent: 21 April 2013 22:03
To: Tinsley-Evans, Emma (Places Directorate - Solihull MBC)
Cc: Geo Noc
Subject: RE: GEO LS-130412-JR-832-TZD/AFF/GCP/NS

Hello Emma

Can you please supply the previous information you was supplied from ourselves at Geo, as I am unable to find this information on our logging system. On receipt we would have provided a 5 digit number starting with SDE ***** and the Fisher German reference for that time. We can then view what you have been advised.

But on viewing the information you have provided this does still seem to be the case, where the only part we would be at risk is if any works are to be undertaken within the main entrance to the site or any works in the footpath/verge along Catherine De Barnes Lane.

Please provide the information requested if further correspondence is required.

Kind Regards

Kelly Bond

Geo NOC

Tel: 0845 601 8215

Fax: 0845 621 0053

Email: geosupport@noc.geo-uk.net



 Please consider the environment - think before you print.

From: Tinsley-Evans, Emma (Places Directorate - Solihull MBC) [<mailto:etinsley@solihull.gov.uk>]
Sent: 18 April 2013 15:13
To: Geo Noc
Cc: 'GEO'
Subject: GEO LS-130412-JR-832-TZD/AFF/GCP/NS

Dear Sir/ Madam,

Ref: GEO LS-130412-JR-832-TZD/AFF/GCP/NS

I recently received the attached from you in response to a consultation that Solihull Council is undertaking.

It appears that GEO's apparatus may be affected by a site that the Council is proposing to allocate for future Gypsy and Traveller use. You commented in a previous round of consultation that the presence of GEO apparatus in this location would not necessarily prevent the site being taken forward, but if there were any works on the approach road to this site then we would need to let you know in advance, in order to arrange for your plant protection officer to meet up with us to discuss your network protection.

I would be grateful if you could confirm whether this is still the case and that the presence of GEO apparatus in this location would not prevent deliverability of this site.

I look forward to hearing from you.

Kind regards,

Emma

*Emma Tinsley
Principal Planning Officer
Spatial Planning Team
Solihull MBC*

Tel: 0121 704 6428

Fax: 0121 704 6575

Email: etinsley@solihull.gov.uk

From: GEO [<mailto:geo@fishergerman.co.uk>]
Sent: 12 April 2013 13:46

To: Tinsley-Evans, Emma (Places Directorate - Solihull MBC)
Cc: Tinsley-Evans, Emma (Places Directorate - Solihull MBC)
Subject: GEO LS-130412-JR-832-TZD

Emma (Places Directorate - Solihull MBC) Tinsley-Evans,

Please find attached for ref LS-130412-JR-832-TZD

Geo Networks Limited

For and on behalf of Fisher German LLP
0845 095 6910



PO Box 9198 - Ashby de la Zouch - Leicestershire - LE65 9BU

This e-mail message is confidential and for the use of the addressee only. If the message is received by anyone other than the addressee it must be deleted. Internet e-mails are not secure and Fisher German does not accept responsibility for changes made to the message. Fisher German LLP is a limited liability partnership. Registered Number: OC317554. SAVE PAPER - Please do not print this e-mail unless absolutely necessary

This email has been scanned by the Symantec Email Security.cloud service.
For more information please visit <http://www.symanteccloud.com>

DISCLAIMER:

'This e-mail and files transmitted with it are confidential. If you are not the intended recipient, please notify the sender immediately and delete the message. Any views or opinions presented are solely those of the author and do not necessarily represent those of Solihull Council unless explicitly stated otherwise. Solihull Council may monitor the contents of e-mail sent and received via its network for the purposes of ensuring compliance with its policies and procedures. The contents of e-mails may have to be disclosed to third parties following a request under legislation such as the Data Protection Act 1998 or the Freedom of Information Act 2000.'

Click [here](#) to report this email as spam. **_SPAMREPORTEND**

This message has been scanned for viruses by [BlackSpider MailControl](#)

Tinsley-Evans, Emma (Places Directorate - Solihull MBC)

From: Geo Noc [geosupport@noc.geo-uk.net]
Sent: 21 May 2013 13:12
To: Tinsley-Evans, Emma (Places Directorate - Solihull MBC); Geo Noc
Subject: RE: GEO LS-130412-JR-832-TZD/AFF/GCP/NS
Attachments: LOT_12_AB_15-02-02-SHEET05_PDF.pdf

Good afternoon Emma

As per our previous explanation yes the only issue we have is the site on Catherine De Barnes lane. At this location our network runs down the verge bordering the site and across the entrance. Please see the attached documentation.

Best regards
Paul Morgan
NOC Engineer

Geo NOC
Tel: 0845 601 8215
Fax: 0845 621 0053
Email: geosupport@noc.geo-uk.net



From: Tinsley-Evans, Emma (Places Directorate - Solihull MBC) [mailto:etinsley@solihull.gov.uk]
Sent: 21 May 2013 07:51
To: Geo Noc
Subject: FW: GEO LS-130412-JR-832-TZD/AFF/GCP/NS

FAO Kelly Bond

Hello Kelly,

Just wondering if you have had chance to consider information in the emails below.

Best wishes,

Emma

From: Tinsley-Evans, Emma (Places Directorate - Solihull MBC)
Sent: 22 April 2013 08:59
To: 'Geo Noc'
Subject: RE: GEO LS-130412-JR-832-TZD/AFF/GCP/NS

Hi Kelly,

Thank you for the reply.

Please find attached the email that was sent from GEO last time.

Best wishes,

Emma

From: Geo Noc [<mailto:geosupport@noc.geo-uk.net>]
Sent: 21 April 2013 22:03
To: Tinsley-Evans, Emma (Places Directorate - Solihull MBC)
Cc: Geo Noc
Subject: RE: GEO LS-130412-JR-832-TZD/AFF/GCP/NS

Hello Emma

Can you please supply the previous information you was supplied from ourselves at Geo, as I am unable to find this information on our logging system. On receipt we would have provided a 5 digit number starting with SDE ***** and the Fisher German reference for that time. We can then view what you have been advised.

But on viewing the information you have provided this does still seem to be the case, where the only part we would be at risk is if any works are to be undertaken within the main entrance to the site or any works in the footpath/verge along Catherine De Barnes Lane.

Please provide the information requested if further correspondence is required.

Kind Regards

Kelly Bond

Geo NOC
Tel: 0845 601 8215
Fax: 0845 621 0053
Email: geosupport@noc.geo-uk.net



From: Tinsley-Evans, Emma (Places Directorate - Solihull MBC) [<mailto:etinsley@solihull.gov.uk>]
Sent: 18 April 2013 15:13
To: Geo Noc
Cc: 'GEO'
Subject: GEO LS-130412-JR-832-TZD/AFF/GCP/NS

Tinsley-Evans, Emma (Places Directorate - Solihull MBC)

From: Geo Noc [geosupport@noc.geo-uk.net]
Sent: 21 May 2013 13:16
To: Tinsley-Evans, Emma (Places Directorate - Solihull MBC); Geo Noc
Subject: RE: GEO LS-130412-JR-832-TZD/AFF/GCP/NS***SDE52223
Attachments: LOT_12_AB_15-02-02-SHEET05_PDF.pdf

Good afternoon Emma

Sorry meant to tell you this search now has reference of SDE52223

As per our previous explanation yes the only issue we have is the site on Catherine De Barnes lane. At this location our network runs down the verge bordering the site and across the entrance. Please see the attached documentation.

Best regards
Paul Morgan
NOC Engineer

Geo NOC
Tel: 0845 601 8215
Fax: 0845 621 0053
Email: geosupport@noc.geo-uk.net

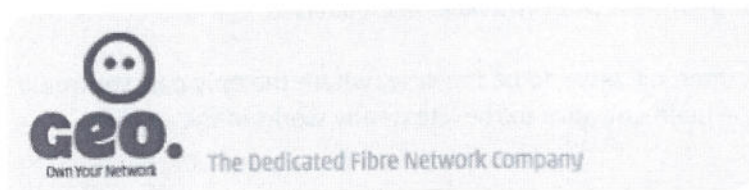

From: Tinsley-Evans, Emma (Places Directorate - Solihull MBC) [mailto:etinsley@solihull.gov.uk]
Sent: 21 May 2013 07:51
To: Geo Noc
Subject: FW: GEO LS-130412-JR-832-TZD/AFF/GCP/NS

FAO Kelly Bond

Hello Kelly,

Just wondering if you have had chance to consider information in the emails below.

Best wishes,

Emma

From: Tinsley-Evans, Emma (Places Directorate - Solihull MBC)
Sent: 22 April 2013 08:59

To: 'Geo Noc'
Subject: RE: GEO LS-130412-JR-832-TZD/AFF/GCP/NS

Hi Kelly,

Thank you for the reply.

Please find attached the email that was sent from GEO last time.

Best wishes,

Emma

From: Geo Noc [<mailto:geosupport@noc.geo-uk.net>]
Sent: 21 April 2013 22:03
To: Tinsley-Evans, Emma (Places Directorate - Solihull MBC)
Cc: Geo Noc
Subject: RE: GEO LS-130412-JR-832-TZD/AFF/GCP/NS

Hello Emma

Can you please supply the previous information you was supplied from ourselves at Geo, as I am unable to find this information on our logging system. On receipt we would have provided a 5 digit number starting with SDE ***** and the Fisher German reference for that time. We can then view what you have been advised.

But on viewing the information you have provided this does still seem to be the case, where the only part we would be at risk is if any works are to be undertaken within the main entrance to the site or any works in the footpath/verge along Catherine De Barnes Lane.

Please provide the information requested if further correspondence is required.

Kind Regards

Kelly Bond

Geo NOC
Tel: 0845 601 8215
Fax: 0845 621 0053
Email: geosupport@noc.geo-uk.net



From: Tinsley-Evans, Emma (Places Directorate - Solihull MBC) [<mailto:etinsley@solihull.gov.uk>]
Sent: 18 April 2013 15:13

186K FIBRE OPTIC NETWORK
SOUTH LOOP - SECTION 1

LOT_NO_12

Ref.No.

Scale: 1:250

Date: 06.06.01

05 OF 40

Revision	Date	Comments	Check	Signature
0	06.06.01			
1	06.11.01	CDM DETAILS ADDED		

186K Limited.
This map is reproduced from the Ordnance Survey material with permission on behalf of the Controller of Her Majesty's Stationery Office Crown Copyright. All rights reserved.

Scale 1:250

AS BUILT

END_START_LOT

RURAL_STD_AB	RIVER_CROSS_AB
RURAL_NON_STD_AB	STRUCTURE_CROSS_AB
FOOTPATH_STD_AB	GAS_MAIN_ABANDONED_AB
FOOTPATH_NON_STD_AB	GAS_OIL_UTIL_AB
VERGE_STD_AB	ELECTRIC_UTIL_AB
VERGE_NON_STD_AB	DRAIN_UTIL_AB
ROAD_STD_AB	JOINT_BOXES_AB
ROAD_NON_STD_AB	JOINT_BOXES_PLASTIC_AB
TRACK_STD_AB	INTER_BOXES_AB
TRACK_NON_STD_AB	INTER_BOXES_PLASTIC_AB
DRILLING_AB	

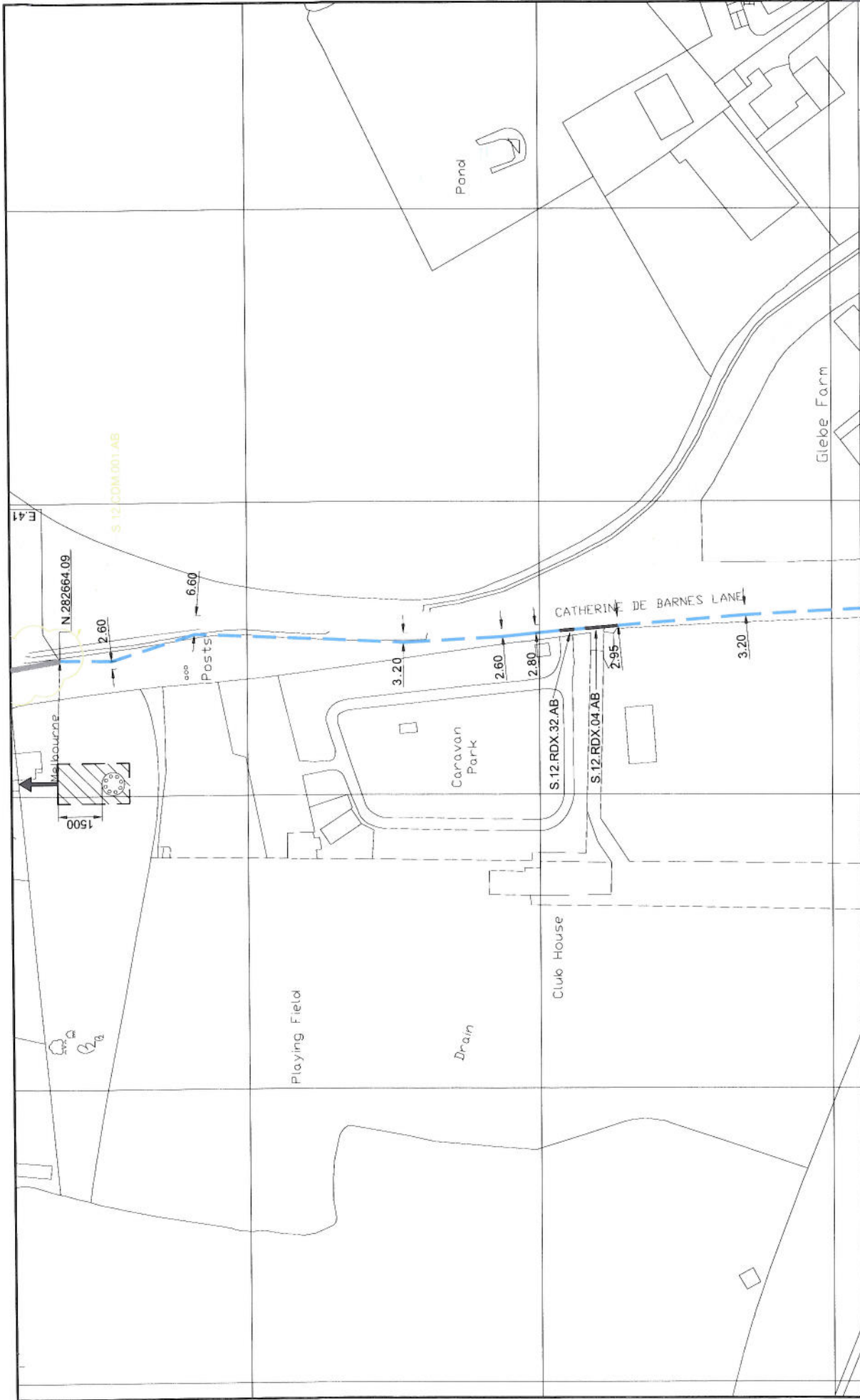

S.12.CDM.001.AB

N.282664.09

2.60

6.60

3.20

2.60

2.80

2.95

3.20

CATHERINE DE BARNES LANE

Club House

Caravan Park

Playing Field

Drain

Pond

Glebe Farm

1500

1500

1500

1500

1500

1500

1500

1500

1500

1500

1500

1500

1500

1500

1500

1500

1500

1500

1500

1500

1500

1500

1500